

FIGURE 1
PAVEMENT ELEVATIONS

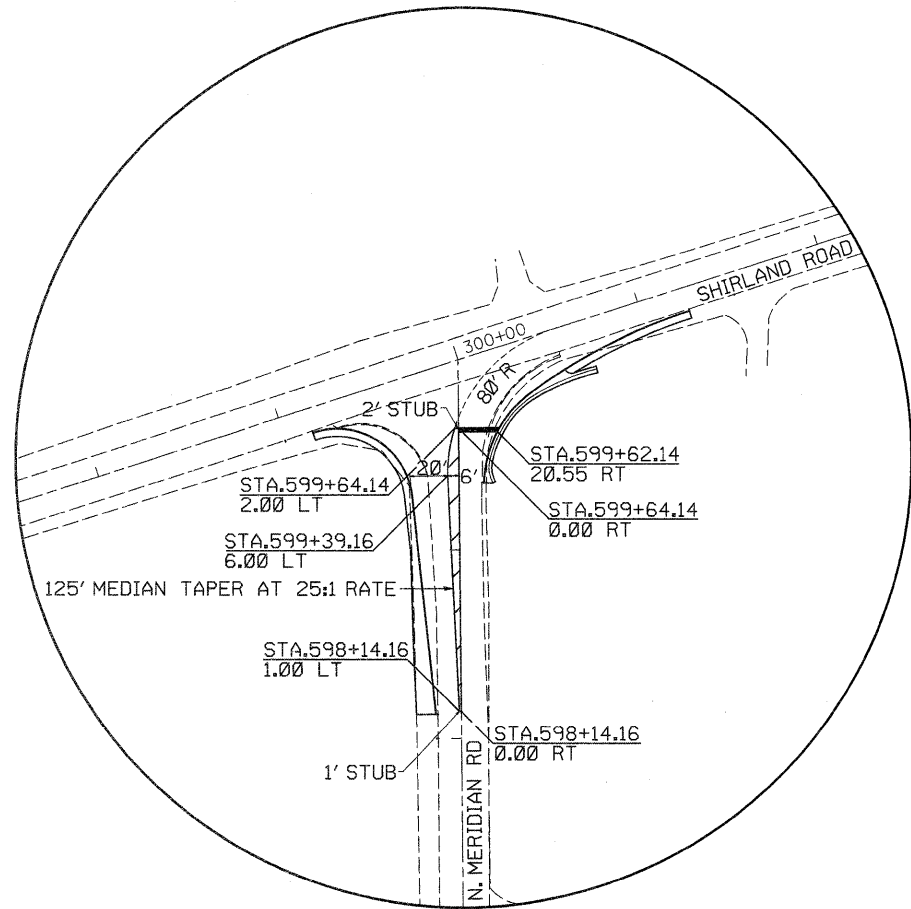
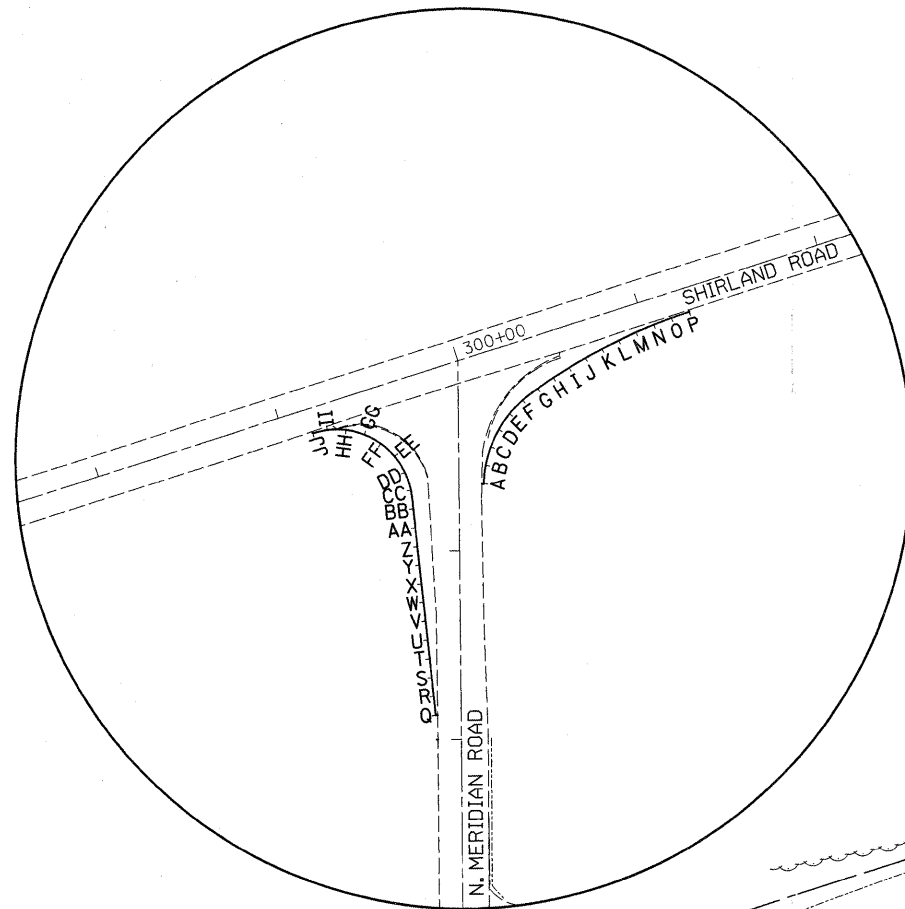
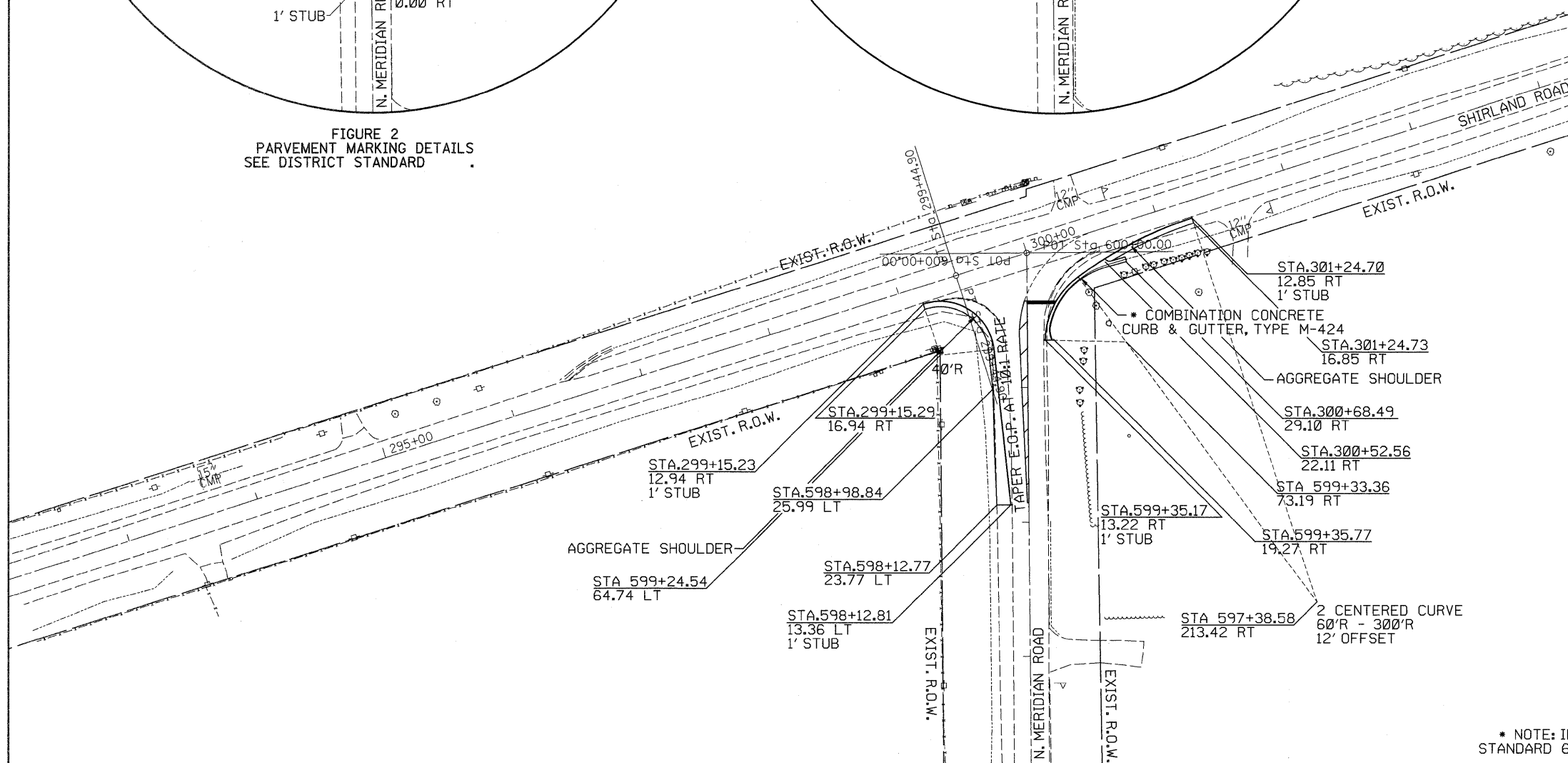

FIGURE 2
PAVEMENT MARKING DETAILS
SEE DISTRICT STANDARD



LETTER	STATION	OFFSET	ELEVATIONS
A	599+35.17	13.24	820.21
B	599+15.10	14.17	820.19
C	599+54.70	17.37	820.10
D	599+63.70	21.45	819.95
E	300+17.66	34.91	819.75
F	300+26.47	30.21	819.52
G	300+35.90	26.87	819.28
H	300+45.48	24.01	819.02
I	300+55.15	21.47	818.76
J	300+64.90	19.25	818.48
K	300+74.72	17.36	818.19
L	300+84.59	15.79	817.90
M	300+94.52	14.56	817.61
N	301+04.72	13.64	817.32
O	301+14.70	13.08	817.03
P	301+24.70	12.85	816.73
Q	598+12.82	13.35	818.79
R	598+22.77	14.34	818.89
S	598+32.72	15.34	819.02
T	598+42.67	16.33	819.14
U	598+52.62	17.33	819.22
V	598+62.57	18.32	819.28
W	598+72.52	19.32	819.34
X	598+82.47	20.31	819.40
Y	598+92.42	21.31	819.46
Z	599+02.37	22.30	819.52
AA	599+12.32	23.30	819.58
BB	599+22.27	24.29	819.64
CC	599+32.20	25.46	819.77
DD	599+41.67	28.57	820.11
EE	599+50.08	33.93	820.61
FF	599+56.91	41.21	821.19
GG	299+40.97	21.80	821.78
HH	299+32.48	16.55	822.28
II	299+22.96	13.57	822.64
JJ	299+15.23	12.94	822.86



* NOTE: INLET & OUTLET SHALL BE DONE ACCORDING TO STATE STANDARD 606201 EXCEPT CURB SHALL BE M-4.24 INSTEAD OF B-6.24