

STATE OF ILLINOIS
DEPARTMENT OF TRANSPORTATION

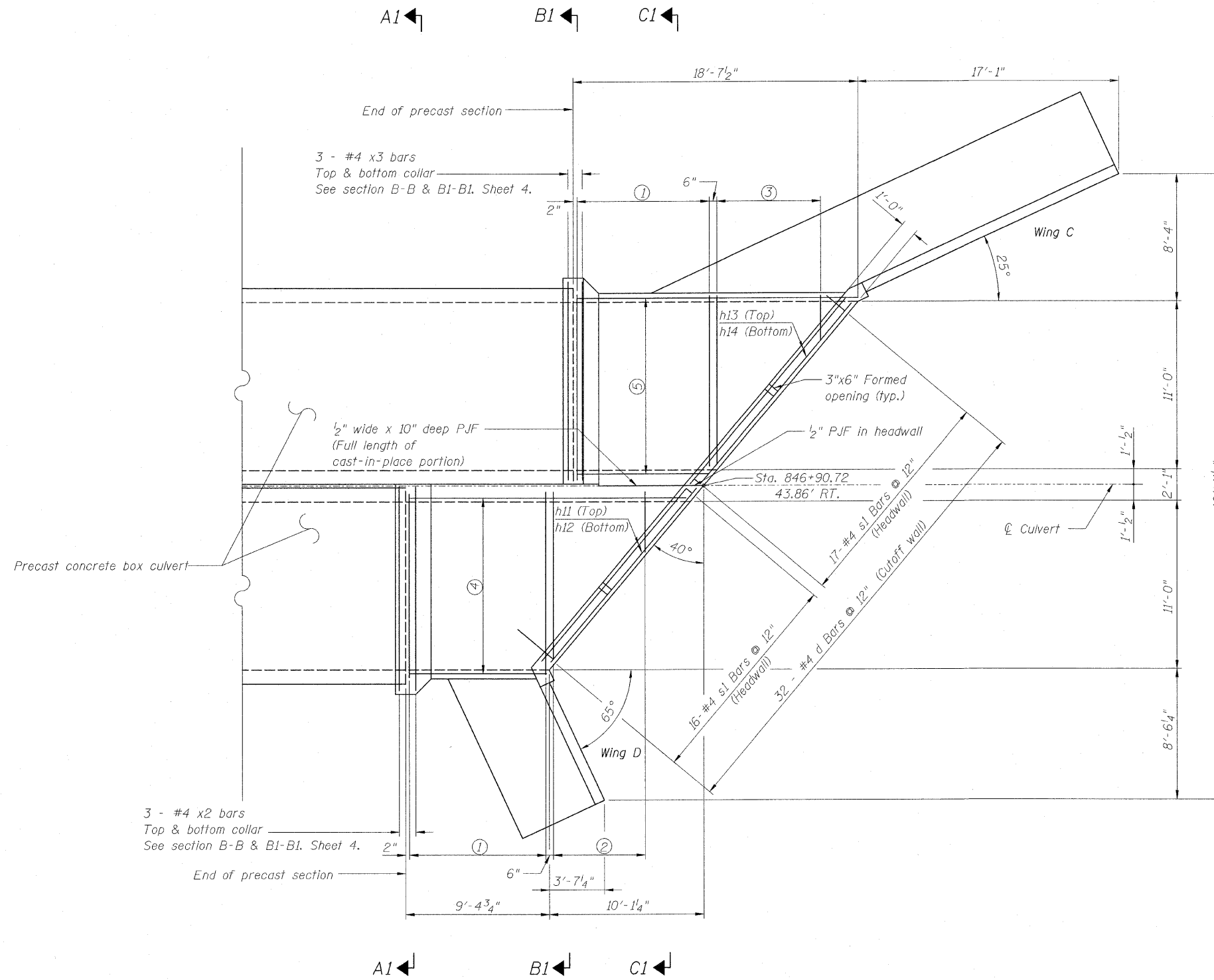

LEGEND

T.T. = Top of top slab
B.T. = Bottom of top slab
T.B. = Top of bottom slab
B.B. = Bottom of bottom slab

NOTE:

- ① 17 - #8 a bars @ 6" = 8'-0" (B.T. & T.B.)
5 - #4 a3 bars @ 24" = 8'-0" (B.B.)
6 - #5 a6 bars @ 18" = 7'-6" (T.T.)
- ② 17 - #8 a1 bars @ 6" = 8'-0" (B.T. & T.B.)
4 - #4 a4 bars @ 24" = 6'-0" (B.B.)
6 - #5 a7 bars @ 18" = 7'-6" (T.T.)
- ③ 17 - #8 a2 bars @ 6" = 8'-0" (B.T. & T.B.)
4 - #4 a5 bars @ 24" = 6'-0" (B.B.)
6 - #5 a8 bars @ 18" = 7'-6" (T.T.)
- ④ 23 - #6 h bars @ 6" = 11'-0" (B.T.)
12 - #5 h10 bars @ 12" = 11'-0" (B.B. & T.B.)
12 - #4 h19 bars @ 12" = 11'-0" (T.T.)
- ⑤ 23 - #6 h1 bars @ 6" = 11'-0" (B.T.)
12 - #5 h10 bars @ 12" = 11'-0" (B.B. & T.B.)
12 - #4 h19 bars @ 12" = 11'-0" (T.T.)
- ⑥ 6" (a, a1, a2)
24" (a3, a4, a5)
18" (a6, a7, a8)

See Sheets 4 & 5 of 9 for Sections A1-A1, B1-B1 and C1-C1.

SOUTH END PLAN
STRUCTURE NO. 101-1084

PLAN



Wight & Company
2500 North Frontage Road . Darien . IL60561
630.969.7000 630.969.7979 fax
Design Firm Registration 184-000451

SHEET NO. 3 9 SHEETS	F.A.P. RTE.	SECTION	COUNTY	TOTAL SHEETS	SHEET NO.
	505	115RS-2	WINNEBAGO	120	45
STA. 791+50 TO STA. 796+00		CONTRACT NO. 64E89			
FED. ROAD DIST. NO.		ILLINOIS	FED. AID PROJECT		

DESIGNED	BJM
CHECKED	MAS
DRAWN	TMF / JNH
CHECKED	BRT