

GENERAL NOTES

Plan dimensions and details relative to existing plans are subject to nominal construction variations. The Contractor shall field verify existing dimensions and details affecting new construction and make necessary approved adjustments prior to construction or ordering of materials. Such variations shall not be cause for additional compensation for a change in scope of the work, however, the Contractor will be paid for the quantity actually furnished at the unit price bid for the work

Existing reinforcement if exposed shall be cleaned and incorporated into the new construction. Cost included with Deck Slab Repair.

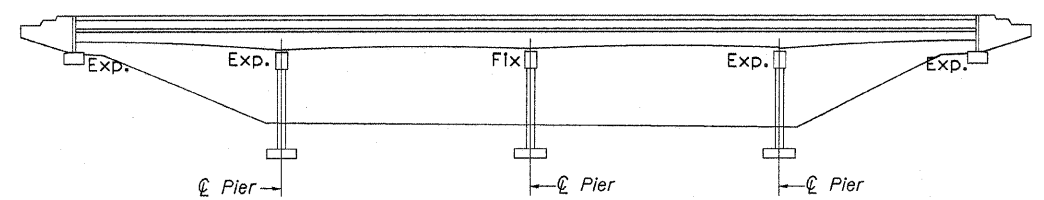

Elevation

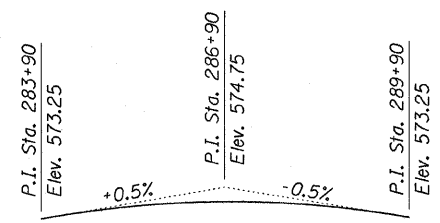

Profile Grade
Along Centerline Survey F.A.I. Route 280

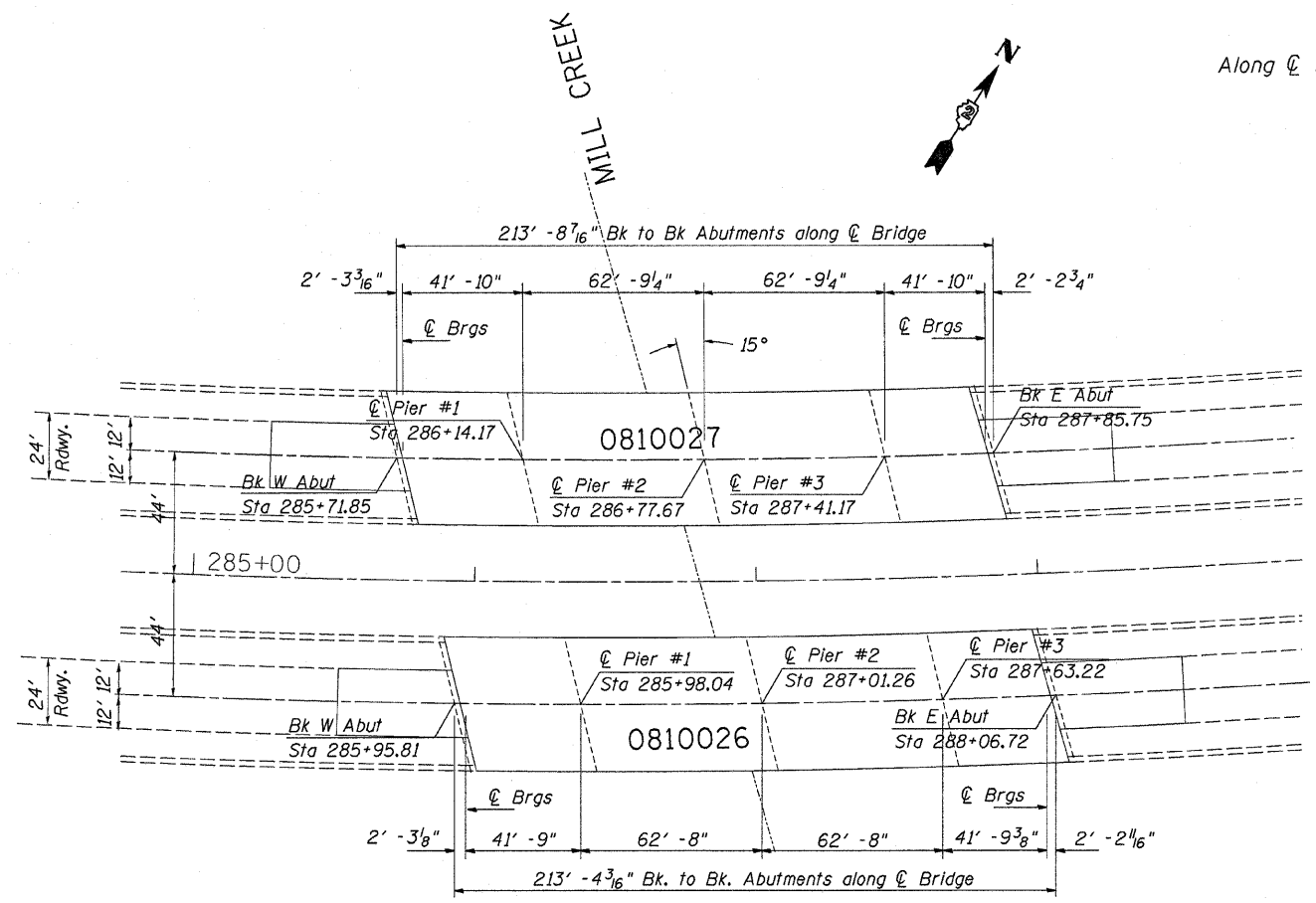

Plan

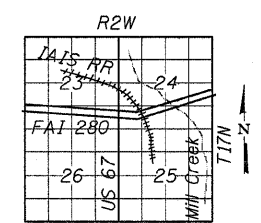

LOCATION SKETCH

TOTAL BILL OF MATERIAL

Item	Unit	Quantity
DECK SLAB REPAIR (FULL DEPTH)	SQ YD	86
DECK SLAB REPAIR (PARTIAL)	SQ YD	377



GENERAL PLAN & ELEVATION
I-280 OVER MILL CREEK
FAI ROUTE 280 SECTION D2 BR WEAR SURF I-280
STA. 286+90
ROCK ISLAND COUNTY
STRUCTURE NUMBER 081-0026 (E.B.)
STRUCTURE NUMBER 081-0027 (W.B.)

FILE NAME = G:\BRY\CADD\plans\Rock Island County\2010	USER NAME = linkdj	DESIGNED -	REVISED -	STATE OF ILLINOIS DEPARTMENT OF TRANSPORTATION	GENERAL PLAN & ELEVATION 081-0026 & 081-0027		F.A.I. RTE. 280	SECTION *	COUNTY ROCK ISLAND	TOTAL SHEETS 19	SHEET NO. 17	
280 deck repair\PLANeng.dgn		DRAWN -	REVISED -		SCALE: _____	SHEET NO. ____ OF ____ SHEETS	STA. _____ TO STA. _____	ILLINOIS FED. AID PROJECT		CONTRACT NO. 64F92		
PLOT SCALE = 50,000' / IN.		CHECKED -	REVISED -									
PLOT DATE = Thu Nov 05 11:03:28 2009		DATE -	REVISED -									