

**STAGE 7 CONSTRUCTION**  
(Sequence of construction / Applications)

1. Set up Traffic Control for Stage 7 Construction per Stage 7 plans, Standard 701306.
2. Wedge/level or mill/overlay pavement and place the remaining 2-1/4" of the 8" HMA shoulders from Sta. 568+50 to Sta. 585+79.
3. Temporary stripe pavement until final pavement striping is placed.
4. Set up Traffic Control according to Standard 701311.
5. Final stripe pavement from Sta. 557+20 to Sta. 589+00.

**NOTES:**

ALL SIGNS IN CONFLICT WITH THIS STAGE OF CONSTRUCTION SHALL BE COVERED.  
ALL STRIPING IN CONFLICT WITH THIS STAGE OF CONSTRUCTION SHALL BE REMOVED.

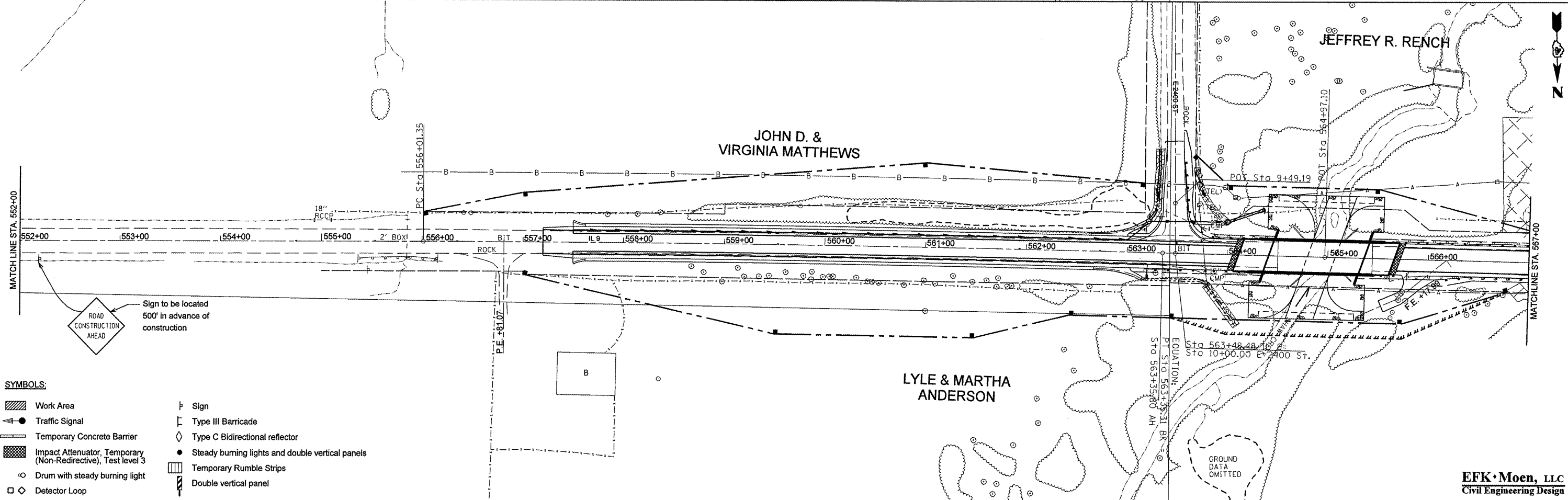
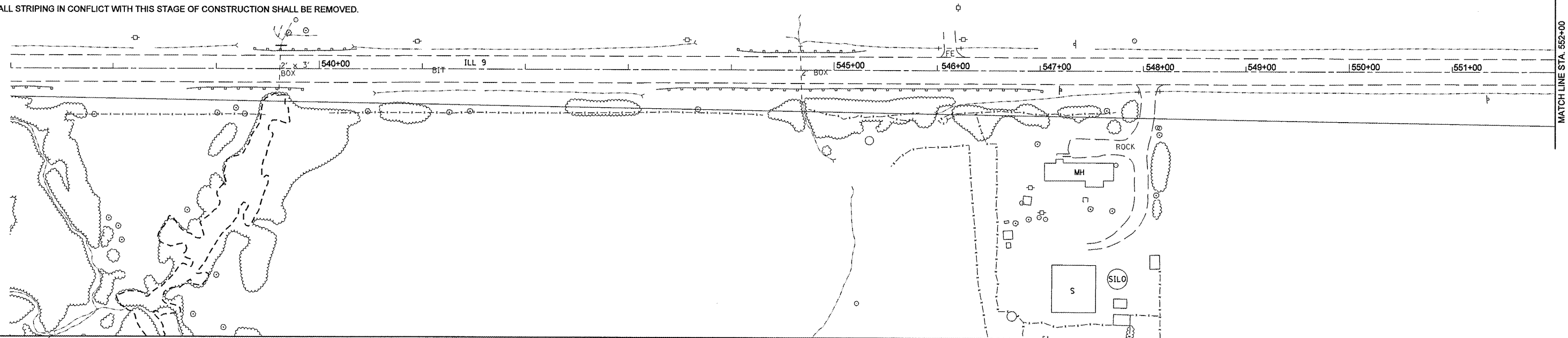

- SYMBOLS:**
- Work Area
  - Traffic Signal
  - Temporary Concrete Barrier
  - Impact Attenuator, Temporary (Non-Redirective), Test level 3
  - Drum with steady burning light
  - Detector Loop
  - Sign
  - Type III Barricade
  - Type C Bidirectional reflector
  - Steady burning lights and double vertical panels
  - Temporary Rumble Strips
  - Double vertical panel

**EFK•Moen, LLC**  
Civil Engineering Design

FILE NAME = Z:\08056_Show_Creek\dgn\Design\Final\Pl	USER NAME = jd	DESIGNED -	REVISED -
tsheets\32-0468352-sht-staging7.1.dgn		DRAWN - JD	REVISED -
PLOT SCALE = 100.0000' / IN.		CHECKED - SD	REVISED -
PLOT DATE = 10/16/2009		DATE - 10/15/09	REVISED -

**STATE OF ILLINOIS**  
**DEPARTMENT OF TRANSPORTATION**

**STAGE 7 PLAN**

SCALE: 1" = 50' SHEET NO. 15 OF 16 SHEETS STA. 540+00.00 TO STA. 567+00.00

F.A.P. RTE.	SECTION	COUNTY	TOTAL SHEETS	SHEET NO.
685	37BR-1	MCDONOUGH/FBI 108	138	32
FED. ROAD DIST. NO. ILLINOIS FED. AID PROJECT			CONTRACT NO. 68352	