

SECTION 10, T20N, R6E, 3RD PM

VILLAGE OF MANSFIELD

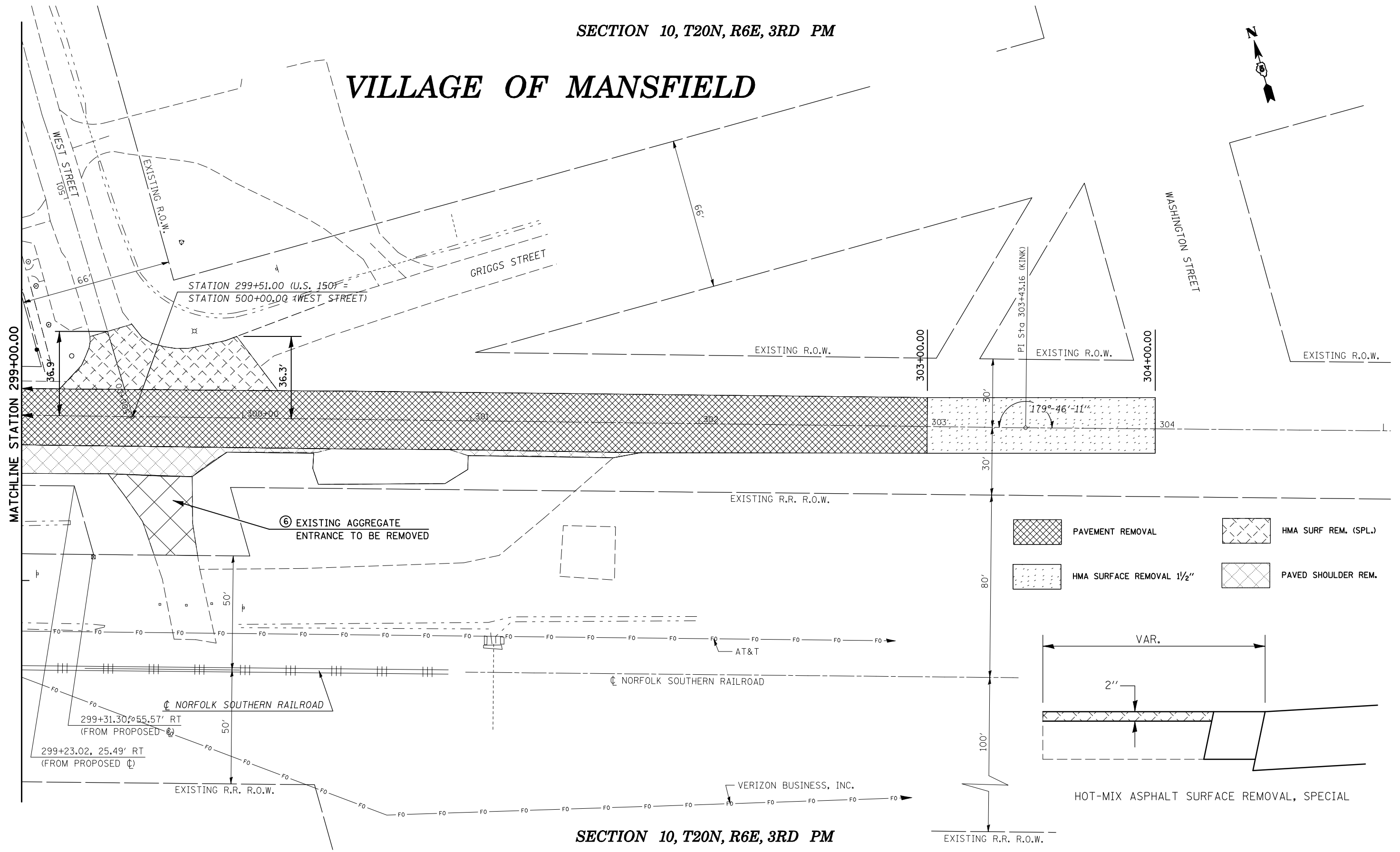

-  PAVEMENT REMOVAL
-  HMA SURF REM. (SPL.)
-  HMA SURFACE REMOVAL 1/2"
-  PAVED SHOULDER REM.

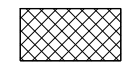
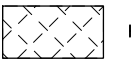
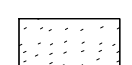
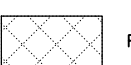
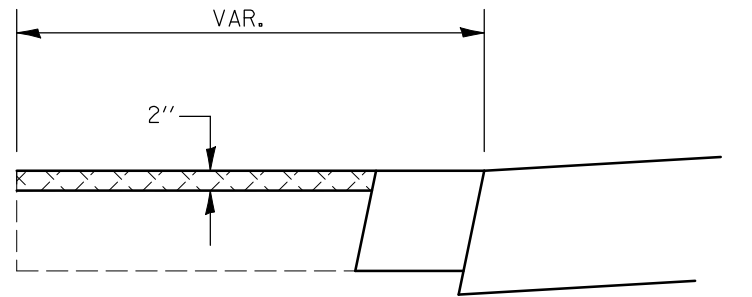

HOT-MIX ASPHALT SURFACE REMOVAL, SPECIAL

SECTION 10, T20N, R6E, 3RD PM

FILE NAME =	USER NAME = shererjm	DESIGNED - JMS	REVISED -
ct:\pw\work\PIWIDOT\SHERRERJM\dms86674\0570388-sht-rem.dgn		DRAWN - JMS	REVISED -
	PLOT SCALE = 40.0000' / IN.	CHECKED -	REVISED -
	PLOT DATE = 10/13/2009	DATE - 051909	REVISED -

STATE OF ILLINOIS
DEPARTMENT OF TRANSPORTATION

REMOVAL DETAILS

SCALE: 1" = 20' SHEET NO. 8 OF 8 SHEETS STA. 299+00.00 TO STA. 304+00.00

F.A.S. RTE.	SECTION	COUNTY	TOTAL SHEETS	SHEET NO.
1517	12VBR-1	PIATT	168	58
CONTRACT NO. 70388				
FED. ROAD DIST. NO. ILLINOIS FED. AID PROJECT				