

**NOTES:**

1. ALL DETAILS NOT SHOWN ARE TO BE PER REQUIREMENTS OF TC&P STD. 701321.
2. SEE STRUCTURE PLANS FOR ADDITIONAL INFORMATION ON STAGE CONSTRUCTION.
3. ADDITIONAL REQUIREMENTS FOR TRAFFIC CONTROL CAN BE FOUND IN THE CONTRACT SPECIAL PROVISIONS.
4. ACCESS MUST BE MAINTAINED TO ENTRANCES AT STA. 250+54 AND STA. 250+61 AT ALL TIMES.
5. TEMPORARY HMA RAMP SHALL BE CONSTRUCTED AND MAINTAINED AT A MINIMUM TAPER OF 1:40 ON BOTH THE UPSTREAM AND DOWNSTREAM ENDS OF THE SURFACE REMOVAL AREAS. TEMPORARY HMA RAMP SHALL BE CONSTRUCTED AND MAINTAINED ADJACENT TO THE BRIDGE APPROACH PAVEMENT ON THE NORTH SIDE AT A MINIMUM TAPER OF 1:60.

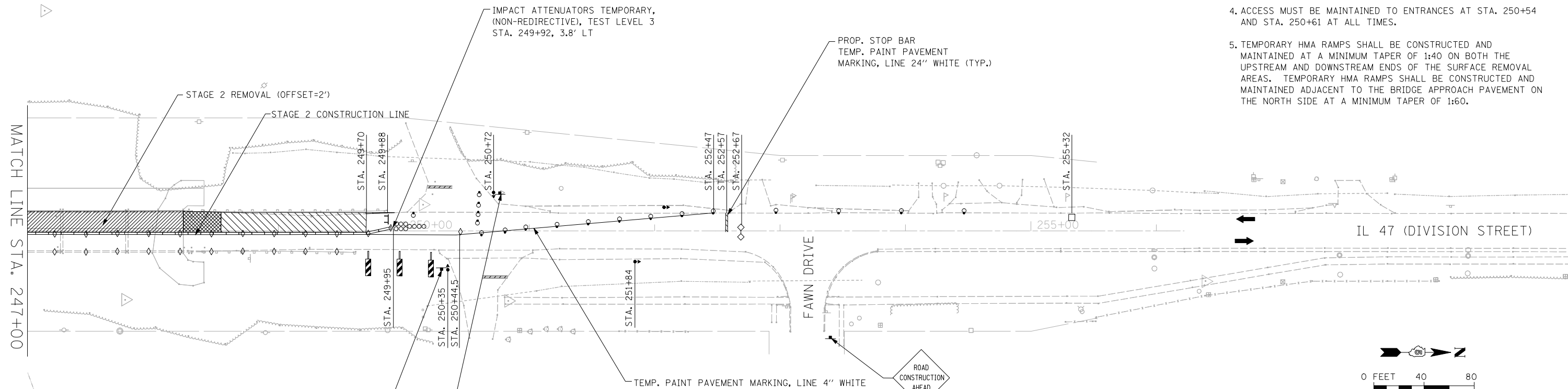

MATCH LINE STA. 247+00

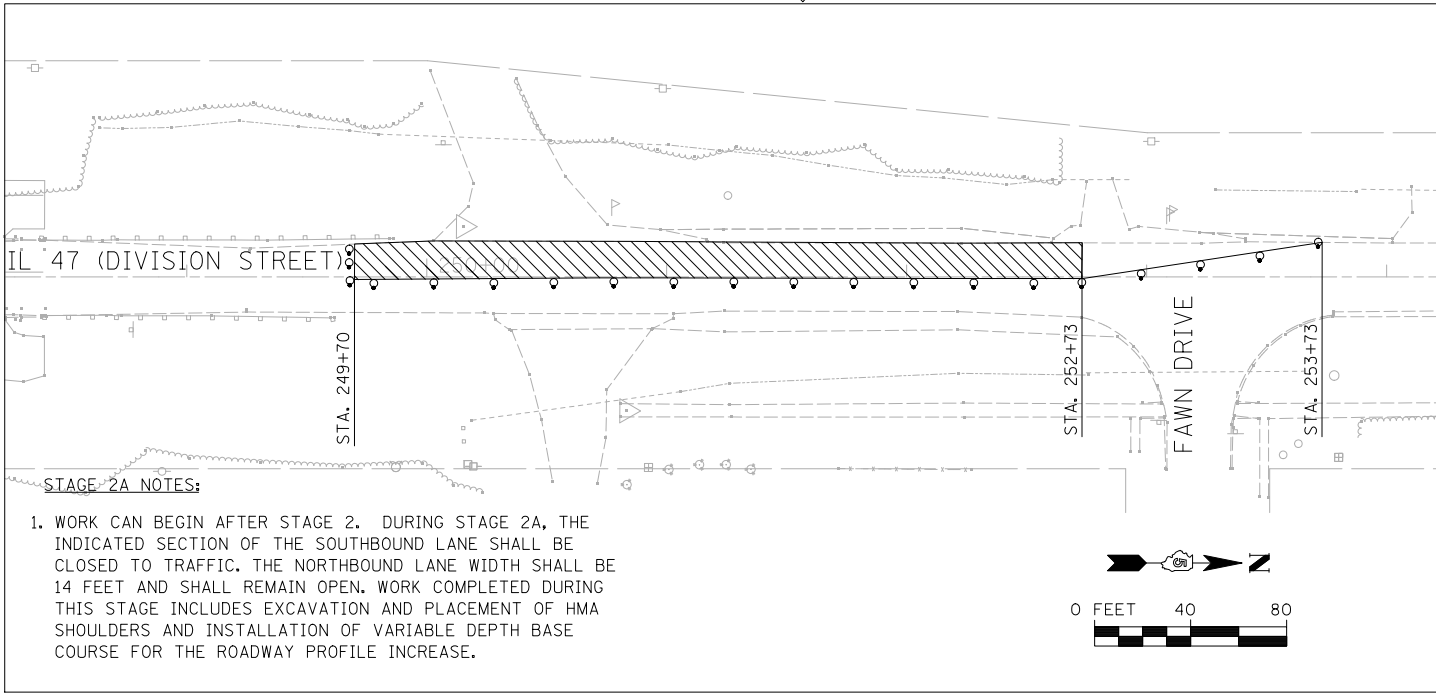
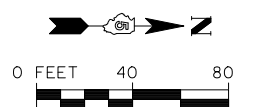
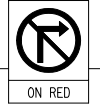

**STAGE 2A NOTES:**

1. WORK CAN BEGIN AFTER STAGE 2. DURING STAGE 2A, THE INDICATED SECTION OF THE SOUTHBOUND LANE SHALL BE CLOSED TO TRAFFIC. THE NORTHBOUND LANE WIDTH SHALL BE 14 FEET AND SHALL REMAIN OPEN. WORK COMPLETED DURING THIS STAGE INCLUDES EXCAVATION AND PLACEMENT OF HMA SHOULDERS AND INSTALLATION OF VARIABLE DEPTH BASE COURSE FOR THE ROADWAY PROFILE INCREASE.

**STAGE 2 NOTES:**

1. DURING STAGE 2, THE SOUTHBOUND LANE SHALL BE CLOSED TO TRAFFIC. THE NORTHBOUND LANE WIDTH SHALL BE 14 FEET AND SHALL REMAIN OPEN. THE CONTRACTOR WILL BE ABLE TO REMOVE AND CONSTRUCT THE WESTERN HALF OF THE BRIDGE. WORK COMPLETED DURING THIS STAGE INCLUDES EXCAVATION AND PLACEMENT OF HMA SHOULDERS AND INSTALLATION OF VARIABLE DEPTH BASE COURSE FOR THE ROADWAY PROFILE INCREASE.

**LEGEND:**

- ➔ TRAFFIC FLOW DIRECTION
- ⬅● TRAFFIC SIGNAL
- SIGN
- IMPACT ATTENUATOR
- ▨ APPROACH PAVEMENT REMOVAL
- ▧ STRUCTURE REMOVAL
- ▩ ROADWAY/SHOULDER WORK ZONE
- ▬ TEMPORARY CONCRETE BARRIER

FILE NAME = s:\p1\6380--6395\6346\021\micross\0570428-ah1-Stage2\_MOT-2.dgn



1170 SOUTH HOUBOLT ROAD JOLIET, ILLINOIS 60431 (815) 744-4200	USER NAME = saron	DESIGNED -	REVISED -
		DRAWN -	REVISED -
	PLOT SCALE = 80.0000' / IN.	CHECKED -	REVISED -
	PLOT DATE = 10/21/2009	DATE -	REVISED -

**STATE OF ILLINOIS  
DEPARTMENT OF TRANSPORTATION**

**MOT - STAGE 2**

SCALE: AS SHOWN SHEET NO. OF SHEETS STA. TO STA.

F.A.P. RTE.	SECTION	COUNTY	TOTAL SHEETS	SHEET NO.
326	(137BR)BR	CHAMPAIGN	75	18
FED. ROAD DIST. NO. ILLINOIS FED. AID PROJECT			CONTRACT NO. 70428	