

EXISTING REINFORCED BOX CULVERT

NOTE: 4 FT. EXISTING BOX CULVERT EXTENTION NOT SHOWN

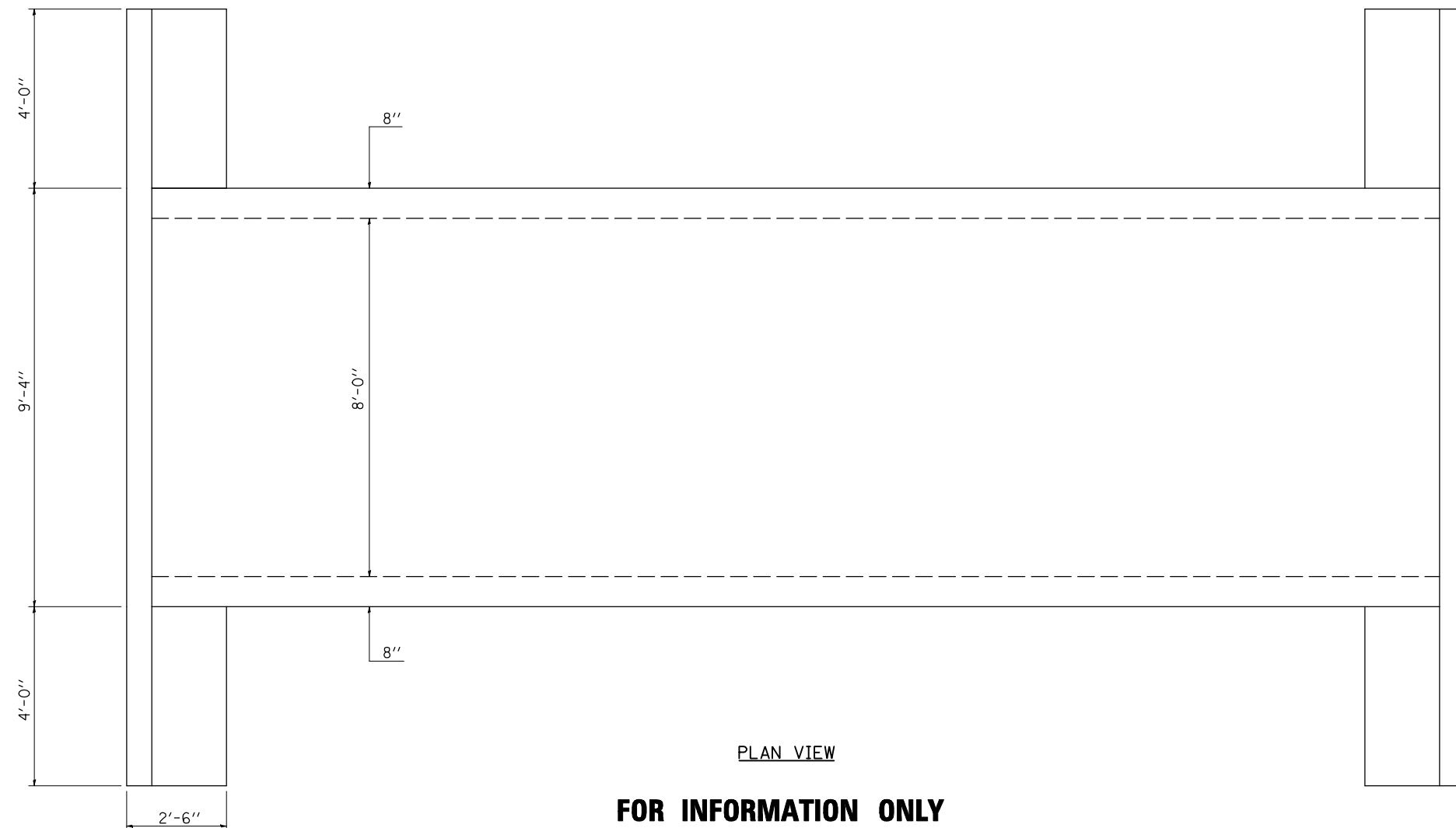
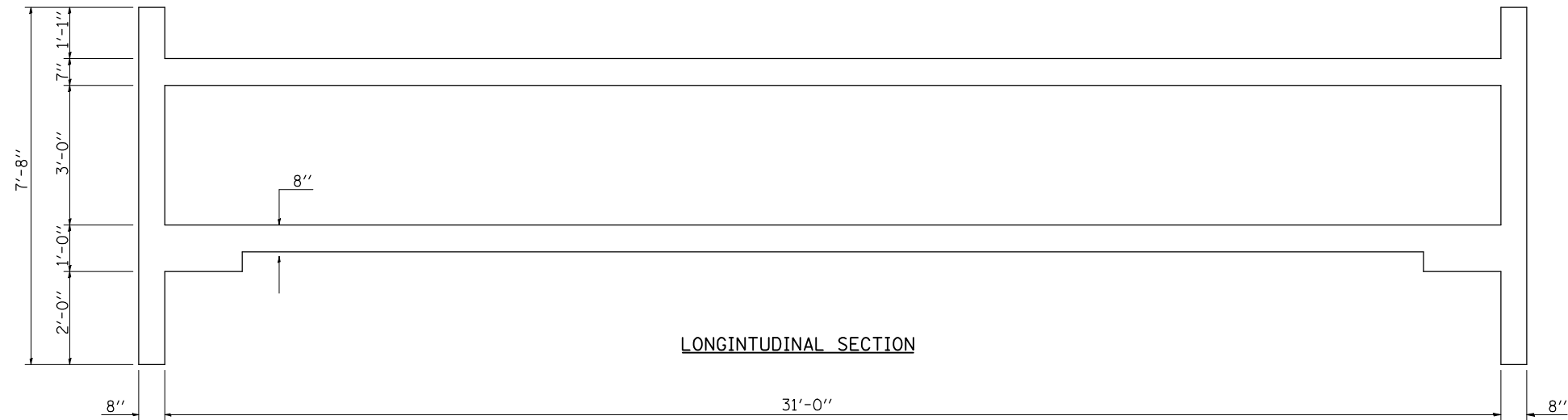

BILL OF MATERIALS		
STRUCTURE REMOVAL SUB-TOTAL	ORIGINAL 8'x3'x30' BOX CULVERT	20.1 CU. YD.*
STRUCTURE REMOVAL SUBTOTAL	4 FT. EXTENSION * (NOT SHOWN)	7.6 CU. YD.*
STRUCTURE REMOVAL TOTAL		27.7 CU. YD.

* NO READABLE PLANS AVAILABLE
ESTIMATED QUANTITY

REINFORCEMENT DETAILS NOT SHOWN

FOR INFORMATION ONLY

FILE NAME =	USER NAME = craigre	DESIGNED -	REVISED -	STATE OF ILLINOIS DEPARTMENT OF TRANSPORTATION	EXISTING CONCRETE BOX CULVERT PLAN				F.A. RTE.	SECTION	COUNTY	TOTAL SHEETS	SHEET NO.
ct:\pw\work\p\dot\craigre\d0124546\0570098-SHT-DETAILS.dgn		DRAWN -	REVISED -		836	119CR	CHAMPAIGN	29	20				
PLOT SCALE = 40.0000 ' / IN.		CHECKED -	REVISED -		SCALE: N/A				SHEET NO. OF SHEETS STA. TO STA.				
PLOT DATE = 10/23/2009		DATE -	REVISED -		FED. ROAD DIST. NO.				ILLINOIS FED. AID PROJECT				