

DATE	
BY	
FINAL SURVEY	SURVEYED
NOTE BOOK	PLOTTED
NO.	AREAS CHECKED

DATE	
BY	
ORIGINAL SURVEY	SURVEYED
NOTE BOOK	PLOTTED
NO.	AREAS CHECKED

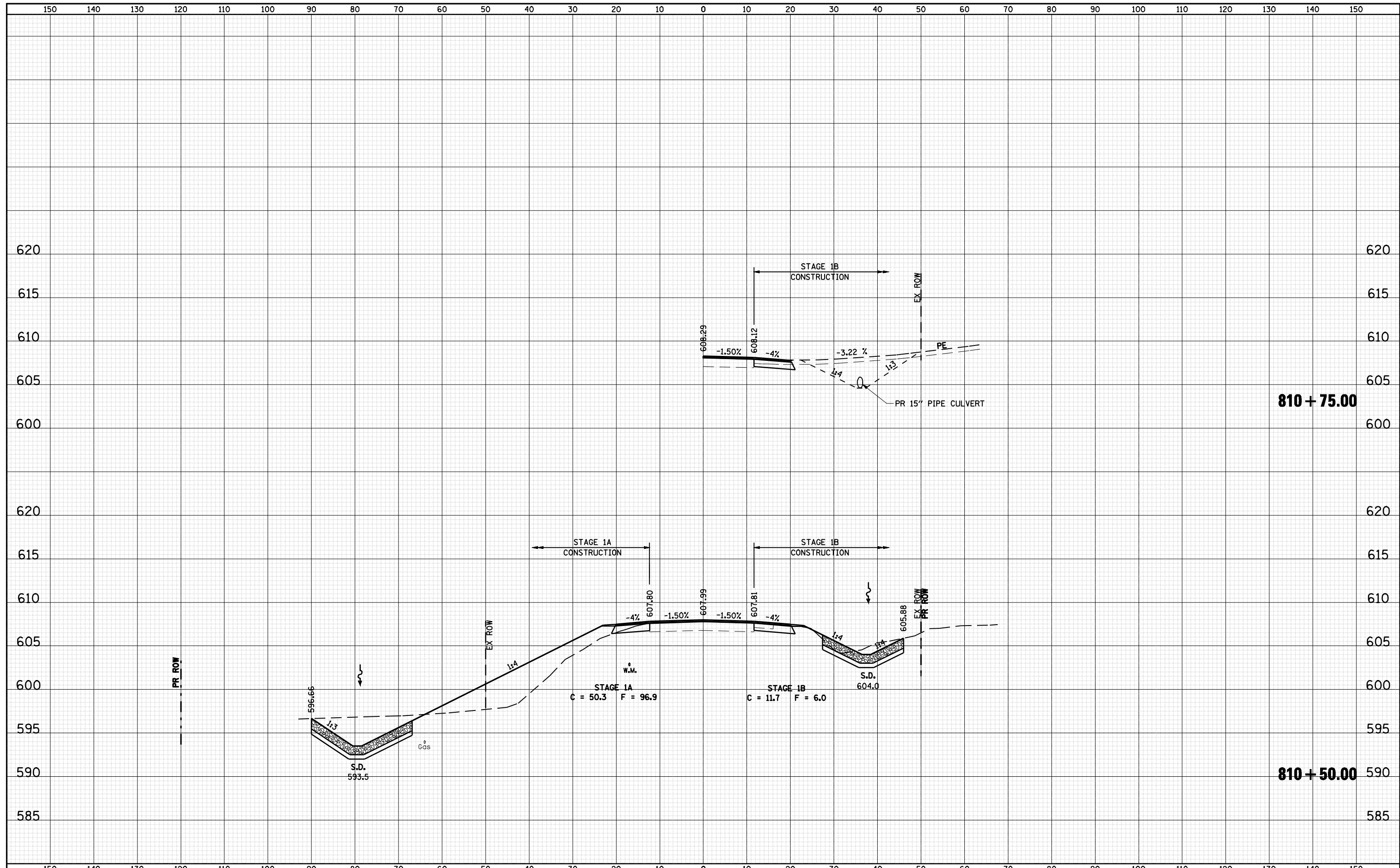

FILE NAME =	USER NAME = laughlinr1	DESIGNED -	REVISIED -	STATE OF ILLINOIS DEPARTMENT OF TRANSPORTATION	CROSS SECTIONS - IL RTE 16 (FAP 325)			F.A.P. RTE. 325	SECTION 114 (B-1)	COUNTY MACOUPIN	TOTAL SHEETS 57	SHEET NO. 51
e:\pwork\PWIDOT\LAUGHLINRL\d0169540\5081XS01.dgn		DRAWN -	REVISIED -		SCALE:	SHEET NO.	OF SHEETS	STA. 810+50.00	TO STA. 810+75.00	CONTRACT NO. 72646		
PLOT SCALE = 20.0000' / IN.		CHECKED -	REVISIED -		ILLINOIS FED. AID PROJECT							
PLOT DATE = Oct-21-2009 11:23:30AM		DATE -	REVISIED -									