

EXIST. CURVE 51
 PI STA. =411+11.06
 $\Delta = 53^\circ 37' 36''$ (LT)
 $D = 2^\circ 24' 15''$
 $R = 2,383.22'$
 $T = 1,204.55'$
 $L = 2,230.60'$
 $E = 287.11'$
 $S.E. = 3.5\%$
 $T.R. = 35'$
 $P.C. STA. = 399+06.51$
 $P.T. STA. = 421+37.11$

SE TRANS: 117'
 $SE = 3.5\%$
 LT 398+53.86 TO 399+35.76 (-1.5% TO -3.5%)
 RT 398+18.76 TO 399+35.76 (-1.5% TO +3.5%)
 LT 421+07.86 TO 421+58.17 (-3.5% TO -1.5%)
 RT 421+07.86 TO 422+28.37 (+3.5% TO -1.5%)

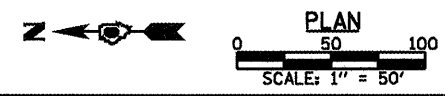
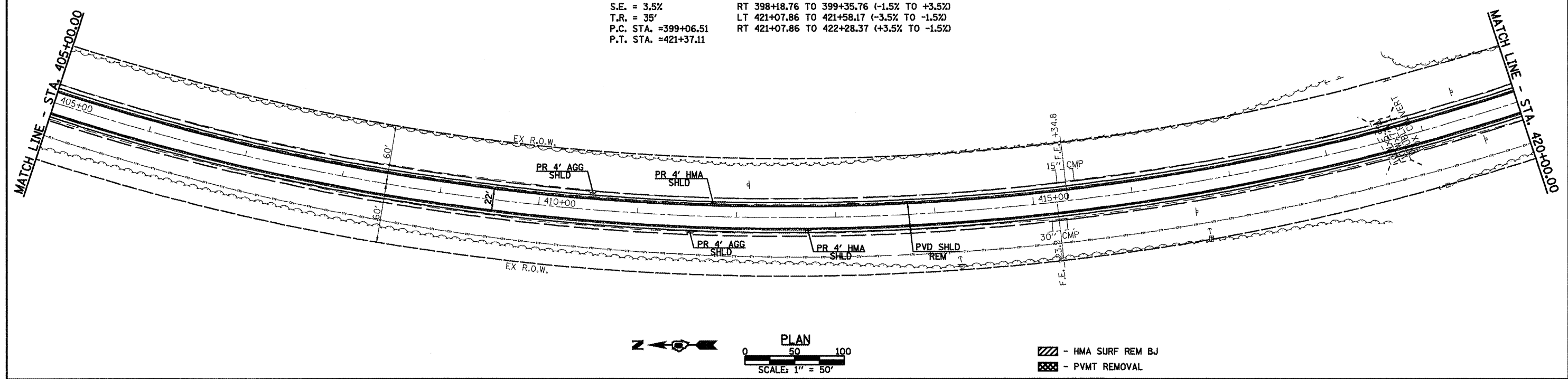

- HMA SURF REM BJ
 - PVMT REMOVAL

EXIST. CURVE 51
 PI STA. =411+11.06
 $\Delta = 53^\circ 37' 36''$ (LT)
 $D = 2^\circ 24' 15''$
 $R = 2,383.22'$
 $T = 1,204.55'$
 $L = 2,230.60'$
 $E = 287.11'$
 $S.E. = 3.5\%$
 $T.R. = 35'$
 $P.C. STA. = 399+06.51$
 $P.T. STA. = 421+37.11$

SE TRANS: 117'
 $SE = 3.5\%$
 LT 398+53.86 TO 399+35.76 (-1.5% TO -3.5%)
 RT 398+18.76 TO 399+35.76 (-1.5% TO +3.5%)
 LT 421+07.86 TO 421+58.17 (-3.5% TO -1.5%)
 RT 421+07.86 TO 422+28.37 (+3.5% TO -1.5%)

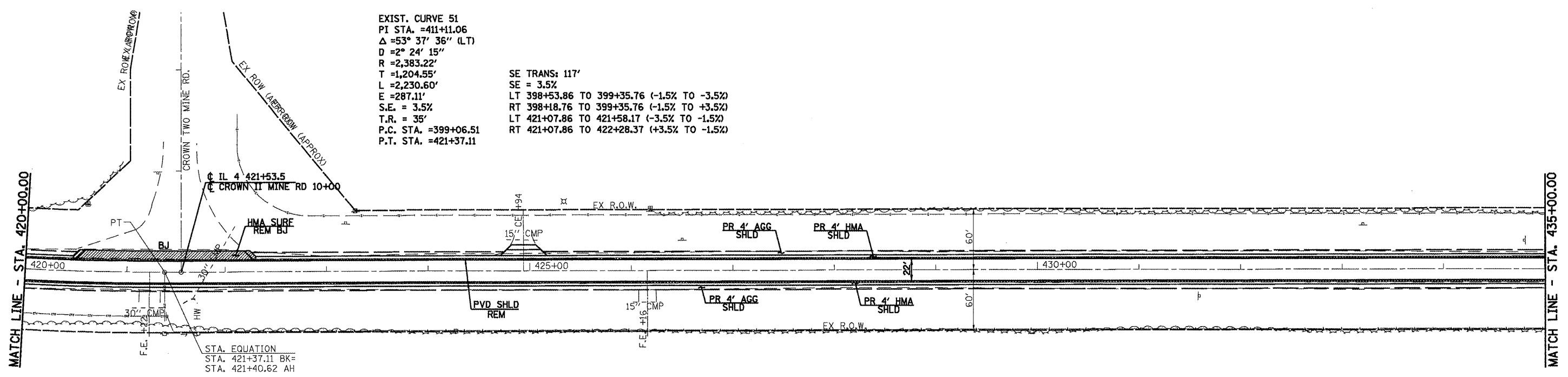

STA. EQUATION
 STA. 421+37.11 BK=
 STA. 421+40.62 AH

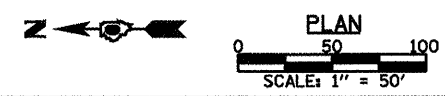

FILE NAME =	USER NAME = medonjavj	DESIGNED -	REVISED -	Allen Henderson & Associates, Inc. Civil and Structural Engineers Springfield, IL. 62703 Phone: (217)544-8033 IL Design Firm No. 184-001907	ROADWAY PLAN		F.A.P. RTE.	SECTION	COUNTY	TOTAL SHEETS	SHEET NO.	
SA\PROJ ENGR 1 (Negangard)\Dust Squad\VP	662 (IL 4) Henderson.pdf\CADD Sheets\0677	DRAWN PLAN2.dgn	REVISED -				662	DIW-3,RS-1LCRI	MACOUPIN	102	34	
PLOT SCALE = 100.0000' / IN.	CHECKED -	REVISED -	REVISED -		SCALE: 1" = 50'		SHEET NO. 2 OF 2 SHEETS		STA. 405+00.00 TO STA. 435+00.00		CONTRACT NO. 72765	
PLOT DATE = Aug-17-2009 04:05:54PM	DATE -	REVISED -	REVISED -				FED. ROAD DIST. NO.		ILLINOIS FED. AID PROJECT			