

**PLAN - TOP SLAB**

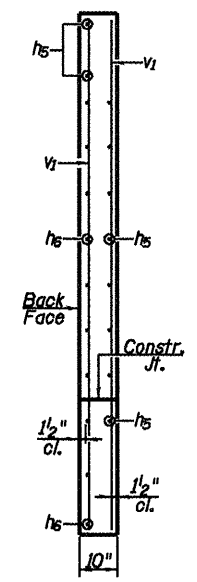

**SECTION A-A**

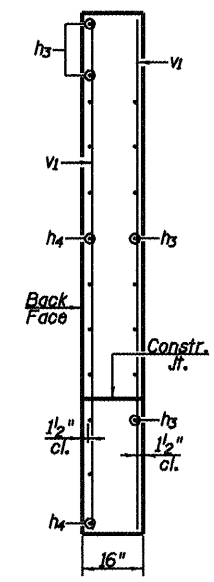

**SECTION B-B**

**MIN. BAR LAPS**  
 #5 bars = 1'-8"  
 #8 bars = 4'-6"

Bars indicated thus 20x2 #5 etc. indicates 20 lines of bars with 2 lengths per line.  
 A distance of half the length of the wingwall but not less than six feet of the barrel shall be poured monolithically with the wingwalls.

**CULVERT DETAILS  
 STRUCTURE NO. 059-7101**

**Allen Henderson & Associates, Inc.**  
 Civil and Structural Engineers Springfield, IL.  
 62703 Phone: (217)544-8033 IL Design Firm  
 No. 184-001907

SHEET NO. 5 9 SHEETS	F.A.P. RTE. 662	SECTION D(W-3,RS-11,CR)	COUNTY MACOUPIN	TOTAL SHEETS 102	SHEET NO. 68
	CONTRACT NO. 72765			ILLINOIS FED. AID PROJECT	