

BILL OF MATERIAL

Bar	No.	Size	Length	Shape
h ₂₀ (E)	60	#6	13'-7"	—
p ₂₀ (E)	10	#8	19'-0"	—
p ₂₁ (E)	10	#8	20'-0"	—
s ₂₂ (E)	38	#4	11'-5"	□
u ₂₀ (E)	8	#6	10'-1"	┘
v ₂₁ (E)	72	#5	4'-4"	—
v ₂₂ (E)	22	#5	11'-4"	—
Structure Excavation		Cu. Yd.	113.9	
Concrete Structures		Cu. Yd.	18.0	
Reinforcement Bars, Epoxy Coated		Pound	3,260	
Furnishing Metal Shell Piles, 14" x 0.250"		Foot	190	
Driving Piles		Foot	190	
Test Pile Metal Shells		Each	1	
Bar Splicers		Each	10	

For details of Bar Splicers, see sheet 24 of 27.
For details of piles, see sheet 25 of 27.

EAST ABUTMENT STRUCTURE NO. 054-0514

*Between beams 3 and 4 provide:
2 - v₂₀(E) in Stage I and
3 - v₂₀(E) in Stage II

PILE DATA

Type: Metal Shell 14 in. dia. x 0.25 in. walls
Nominal Required Bearing: 320 kips
Factored Resistance Available: 160 kips
Est. Length: 38 ft.
No. Production Piles: 5
No. Test Piles: 1

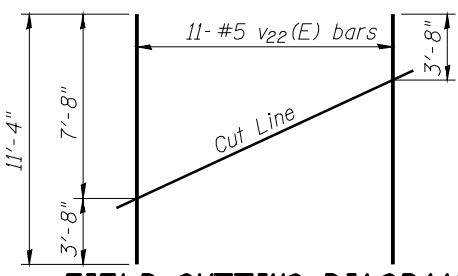

Order v₂₂(E) full length. Cut as shown and use remainder of bars in opposite face.

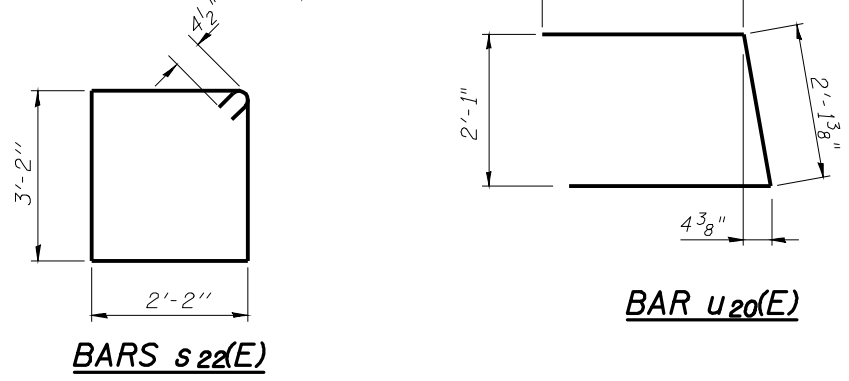

NOTES:

The contractor shall limit the pile hammer size selected considering the relatively high soil strengths indicated in the borings and avoid overdriving the piles beyond their nominal required bearing to prevent pile damage during driving.

USER NAME:	DESIGNED - RTM	REVISED -
	DRAWN - MSD	REVISED -
PLOT SCALE:	CHECKED - KEB	REVISED -
PLOT DATE:	DATE -	REVISED -

STATE OF ILLINOIS DEPARTMENT OF TRANSPORTATION

EAST ABUTMENT

SCALE: SHEET NO. 22 OF 27 SHEETS STA. TO STA.

F.A.P. RTE.	SECTION	COUNTY	TOTAL SHEETS	SHEET NO.
717	109B-3	LOGAN	73	57
CONTRACT NO. 72A88				
FED. ROAD DIST. NO.	ILLINOIS	FED. AID PROJECT		