

NE 1/4, SEC 17, T1S, R3W, 4th PM

NW 1/4, SEC 16, T1S, R3W, 4th PM

EXIST. CURVE 604
 PI STA. = 23+26.30
 $\Delta = 23^\circ 56' 04''$ (LT)
 $D = 12^\circ 00' 33''$
 $R = 477.09'$
 $T = 101.12'$
 $L = 199.30'$
 $E = 10.60'$
 $e = \text{-----}$
 $T.R. = \text{-----}$
 $S.E. \text{ RUN} = \text{-----}$
 $P.C. \text{ STA.} = 22+25.18$
 $P.T. \text{ STA.} = 24+24.48$

MT STERLING IMPLEMENT COMPANY
 6167105 TE-1, TE-2, TE-3

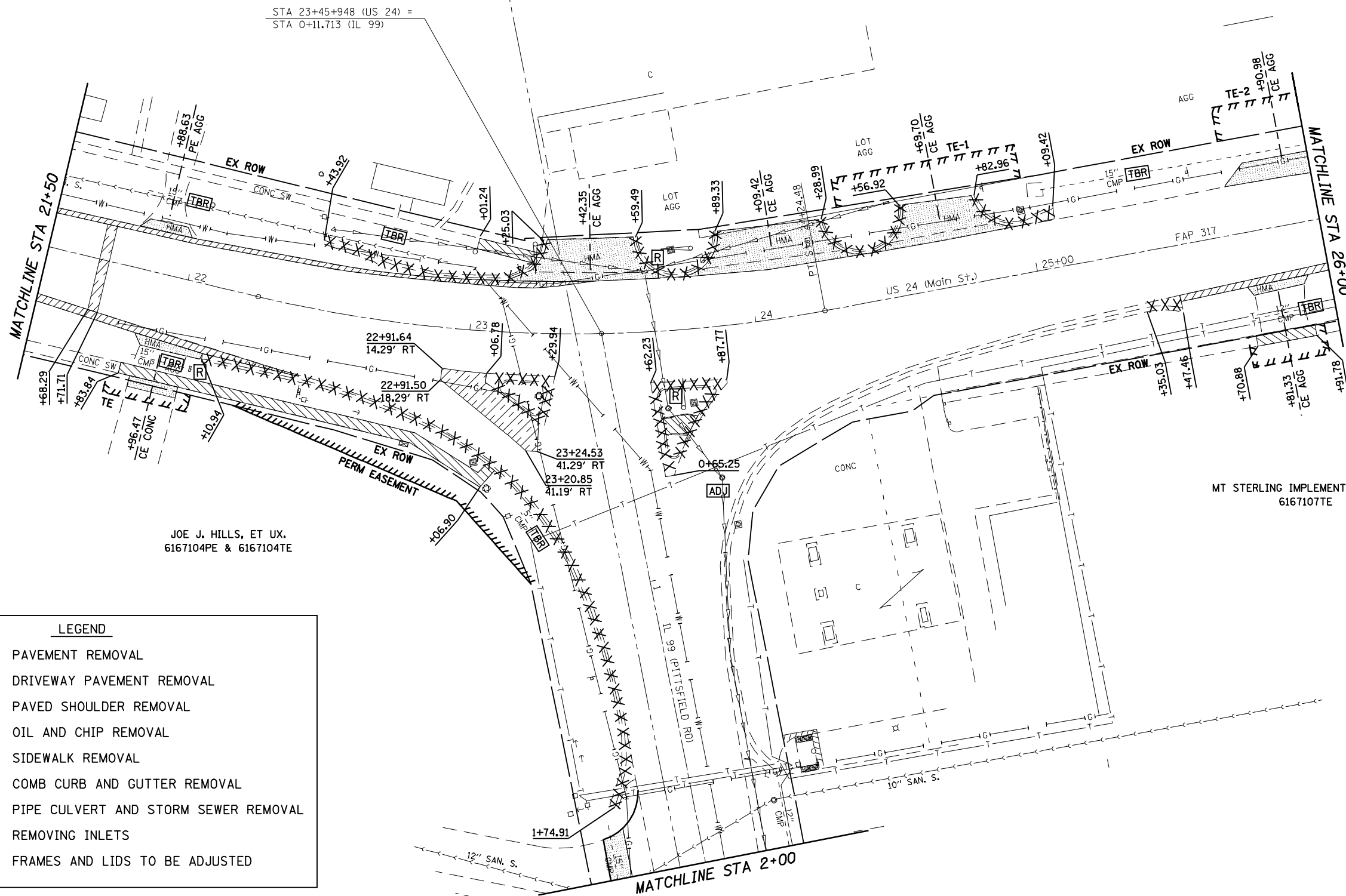

JOE J. HILLS, ET UX.
 6167104PE & 6167104TE

MT STERLING IMPLEMENT COMPANY
 6167107TE

LEGEND	
	PAVEMENT REMOVAL
	DRIVEWAY PAVEMENT REMOVAL
	PAVED SHOULDER REMOVAL
	OIL AND CHIP REMOVAL
	SIDEWALK REMOVAL
	COMB CURB AND GUTTER REMOVAL
	PIPE CULVERT AND STORM SEWER REMOVAL
	REMOVING INLETS
	FRAMES AND LIDS TO BE ADJUSTED

FILE NAME =	USER NAME = laughlinr1	DESIGNED -	REVISED -	STATE OF ILLINOIS DEPARTMENT OF TRANSPORTATION	REMOVAL PLAN SHEET	F.A.P. RTE.	SECTION	COUNTY	TOTAL SHEETS	SHEET NO.	
et:\pwork\PWIDOT\LAUGHLINRL\dms20175\672b60-sht-plan.dgn	DRAWN -	REVISED -	7(W-1,RS-8,N); 9RS-4			BROWN	177	47			
PLOT SCALE = 40.0000' / IN.	CHECKED -	REVISED -	CONTRACT NO. 72B60								
PLOT DATE = Oct-07-2009 08:43:56AM	DATE -	REVISED -	FED. ROAD DIST. NO. ILLINOIS FED. AID PROJECT								
				SCALE: 1" = 20'		SHEET NO. 3 OF 9 SHEETS		STA. 21+50 TO STA. 26+00		* FAP 317 (IIC 24) & 550 (II 99)	