

PAVEMENT MARKING LEGEND		
①	THERMOPLASTIC PAVEMENT MARKING - LINE 5"	(SOLID WHITE LINE)
②	THERMOPLASTIC PAVEMENT MARKING - LINE 5"	(YELLOW SKIP DASH)
③	THERMOPLASTIC PAVEMENT MARKING - LINE 5"	(SOLID YELLOW LINE)
④	THERMOPLASTIC PAVEMENT MARKING - LINE 5"	(DOUBLE YELLOW)
⑤	THERMOPLASTIC PAVEMENT MARKING - LINE 6"	(WHITE SKIP DASH)
⑥	THERMOPLASTIC PAVEMENT MARKING - LINE 8"	(SOLID WHITE LINE)

PAVEMENT MARKING LEGEND		
⑦	THERMOPLASTIC PAVEMENT MARKING - LINE 12"	(SOLID WHITE LINE)
⑧	THERMOPLASTIC PAVEMENT MARKING - LINE 12"	(SOLID YELLOW LINE)
⑨	PREFORMED PLASTIC PAVEMENT MARKING, TYPE B - INLAID - LINE 6"	(SOLID WHITE LINE)
⑩	PREFORMED PLASTIC PAVEMENT MARKING, TYPE B - INLAID - LINE 12"	(SOLID WHITE LINE)
⑪	PREFORMED PLASTIC PAVEMENT MARKING, TYPE B - INLAID - LINE 24"	(WHITE STOP BARS)
⑫	PREFORMED PLASTIC PAVEMENT MARKING, TYPE B - INLAID - LETTERS AND SYMBOLS	(WHITE ARROWS)

RAISED REFLECTIVE PAVEMENT MARKER	
◀	- ONE-WAY AMBER MARKER
▷	- ONE-WAY CRYSTAL MARKER
◆	- TWO-WAY MARKER

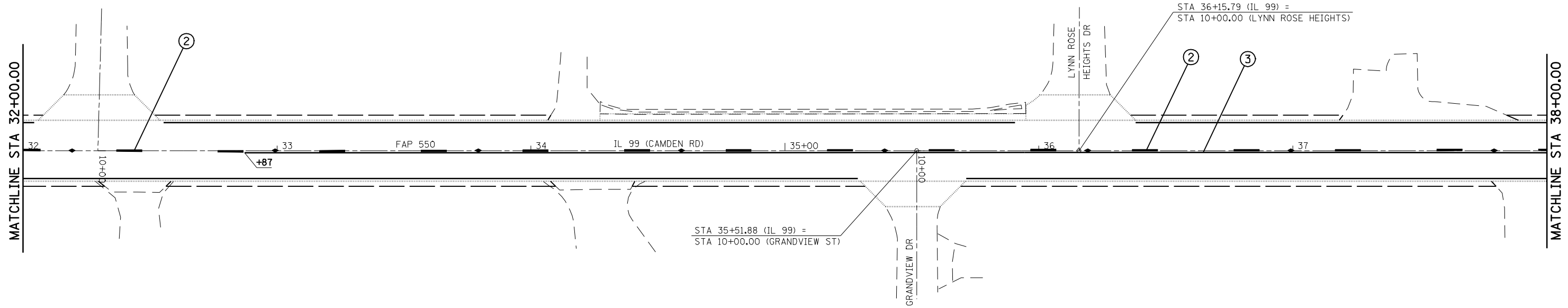

FILE NAME =	USER NAME = laughlinr1	DESIGNED -	REVISED -
es:\pwork\PWIDOT\LAUGHLINRL\dms20175\672b60-shr-plan35pm.dgn		DRAWN -	REVISED -
	PLOT SCALE = 40.0000' / IN.	CHECKED -	REVISED -
	PLOT DATE = Oct-07-2009 10:23:31AM	DATE -	REVISED -

**STATE OF ILLINOIS  
DEPARTMENT OF TRANSPORTATION**

**IL 99 3P PAVEMENT MARKING PLAN SHEET**

SCALE: SHEET NO. 3 OF 5 SHEETS STA. 26+00 TO STA. 38+00

F.A.P. RTE.	SECTION	COUNTY	TOTAL SHEETS	SHEET NO.
•	7(W-1,RS-8,N); 9RS-4	BROWN	177	94
CONTRACT NO. 72B60				
FED. ROAD DIST. NO. ILLINOIS FED. AID PROJECT				
• FAP 317 (11S 24) & 550 (11 99)				