

RAISED REFLECTIVE PAVEMENT MARKER

- ◀ - ONE-WAY AMBER MARKER
- ▷ - ONE-WAY CRYSTAL MARKER
- ◄ - TWO-WAY MARKER

MATCHLINE STA 26+00

MATCHLINE STA 32+00

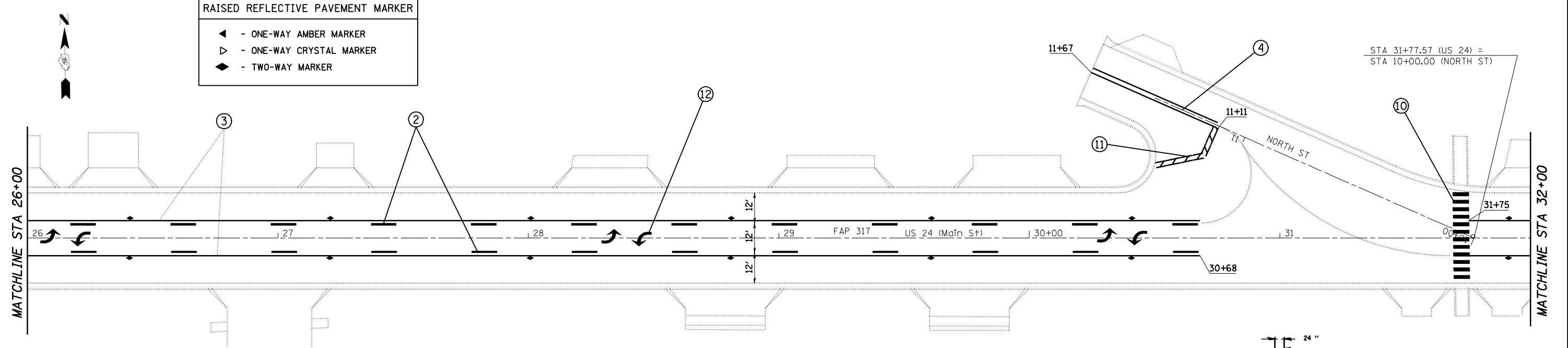

PAVEMENT MARKING LEGEND	
①	THERMOPLASTIC PAVEMENT MARKING - LINE 5" (SOLID WHITE LINE)
②	THERMOPLASTIC PAVEMENT MARKING - LINE 5" (YELLOW SKIP DASH)
③	THERMOPLASTIC PAVEMENT MARKING - LINE 5" (SOLID YELLOW LINE)
④	THERMOPLASTIC PAVEMENT MARKING - LINE 5" (DOUBLE YELLOW)
⑤	THERMOPLASTIC PAVEMENT MARKING - LINE 6" (WHITE SKIP DASH)
⑥	THERMOPLASTIC PAVEMENT MARKING - LINE 8" (SOLID WHITE LINE)

PAVEMENT MARKING LEGEND	
⑦	THERMOPLASTIC PAVEMENT MARKING - LINE 12" (SOLID WHITE LINE)
⑧	THERMOPLASTIC PAVEMENT MARKING - LINE 12" (SOLID YELLOW LINE)
⑨	PREFORMED PLASTIC PAVEMENT MARKING, TYPE B - INLAID - LINE 6" (SOLID WHITE LINE)
⑩	PREFORMED PLASTIC PAVEMENT MARKING, TYPE B - INLAID - LINE 12" (SOLID WHITE LINE)
⑪	PREFORMED PLASTIC PAVEMENT MARKING, TYPE B - INLAID - LINE 24" (WHITE STOP BARS)
⑫	PREFORMED PLASTIC PAVEMENT MARKING, TYPE B - INLAID - LETTERS AND SYMBOLS (WHITE ARROWS)

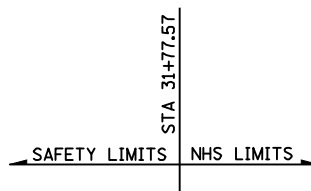
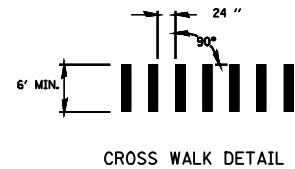

MATCHLINE STA 32+00

MATCHLINE STA 38+00

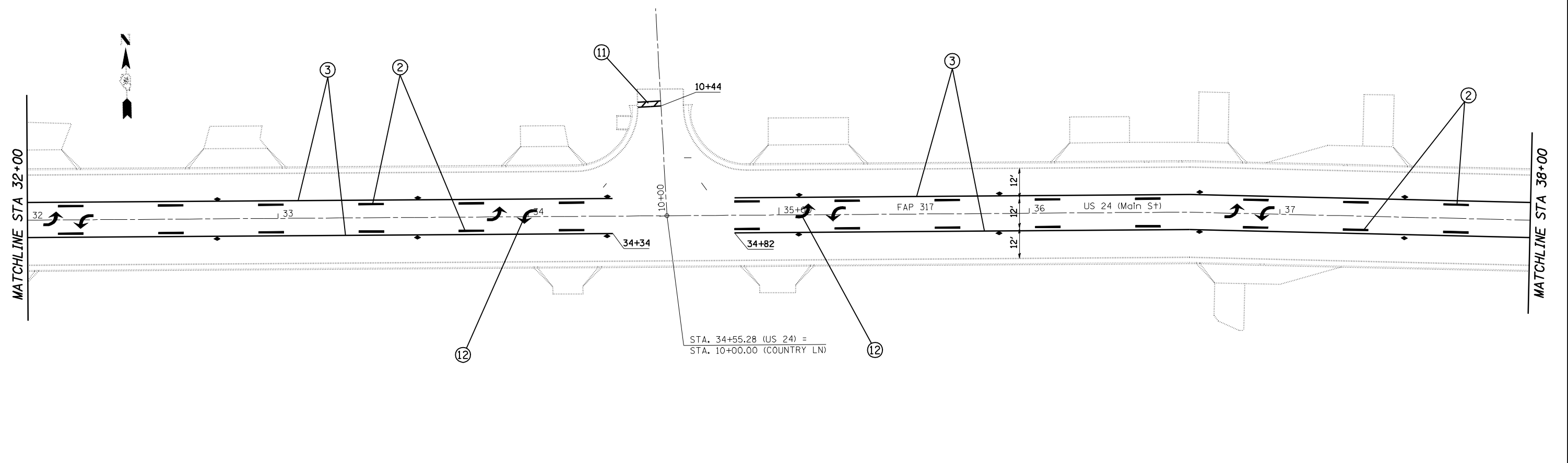

FILE NAME =	USER NAME = laughlinr1	DESIGNED -	REVISED -
er:\pwork\PWIDOT\LAUGHLINRL\dms20175\672b60-sht-plan.pmdgn		DRAWN -	REVISED -
PLOT SCALE = 40.0000 ' / IN.		CHECKED -	REVISED -
PLOT DATE = Oct-07-2009 10:29:49AM		DATE -	REVISED -

STATE OF ILLINOIS  
DEPARTMENT OF TRANSPORTATION

US 24 SAFETY PAVEMENT MARKING PLAN SHEET  
SCALE: 1" = 20' SHEET NO. 3 OF 5 SHEETS STA. 26+00 TO STA. 38+00

F.A.P. RTE.	SECTION	COUNTY	TOTAL SHEETS	SHEET NO.
*	7(W-1,RS-8,N); 9RS-4	BROWN	177	99
CONTRACT NO. 72B60				
FED. ROAD DIST. NO. ILLINOIS FED. AID PROJECT				
* FAP 317 (11S 24) & 550 (11 99)				