

DATE	
BY	
FINAL SURVEY	
SURVEYED	
PLOTTED	
TEMPLATE	
NOTE BOOK	
AREAS CHECKED	
NO.	

DATE	
BY	
ORIGINAL SURVEY	
SURVEYED	
PLOTTED	
TEMPLATE	
NOTE BOOK	
AREAS CHECKED	
NO.	

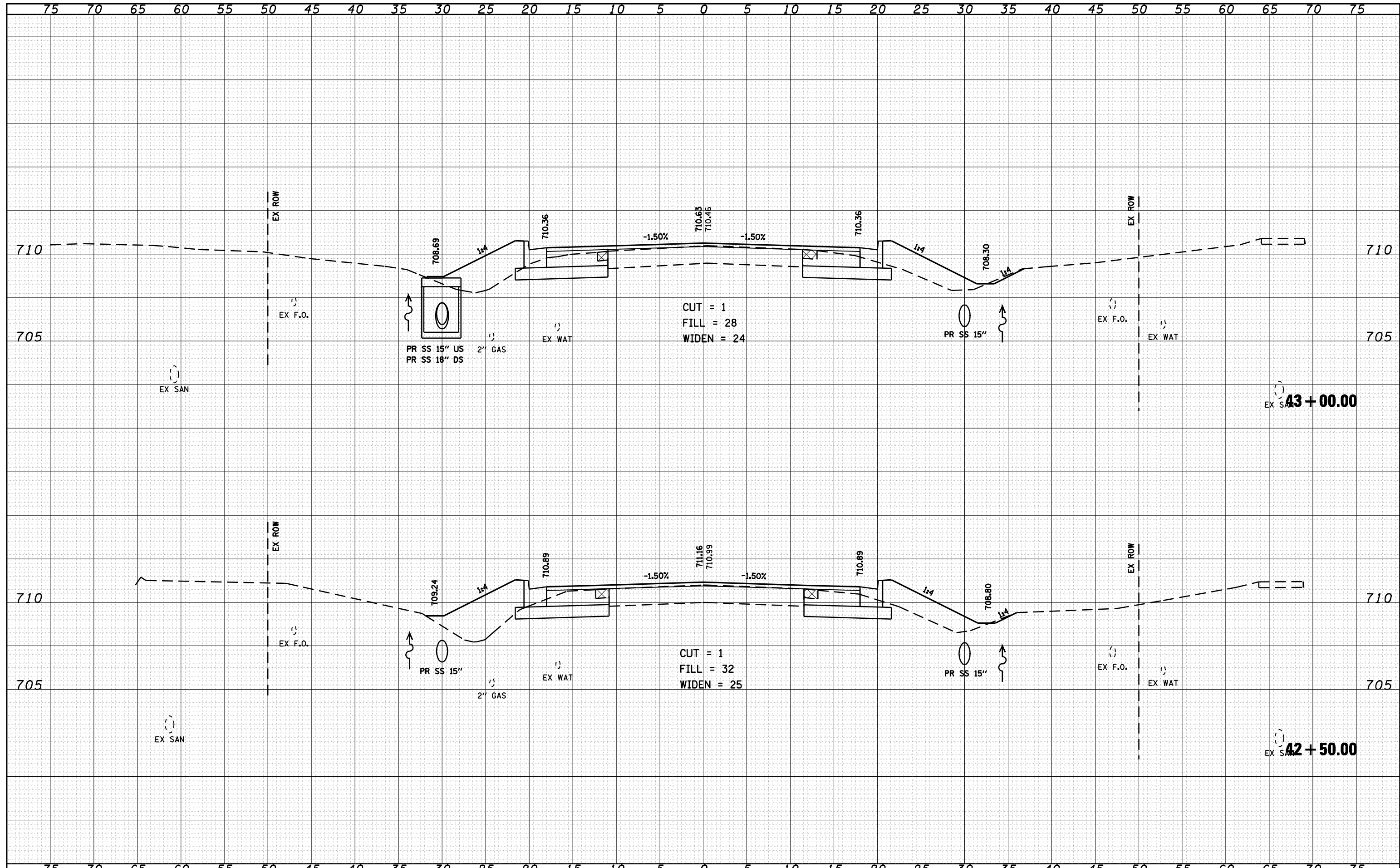

FILE NAME =	USER NAME = laughlinr1	DESIGNED -	REVISED -	<b>STATE OF ILLINOIS DEPARTMENT OF TRANSPORTATION</b>	<b>US 24 CROSS SECTIONS</b>		F.A.P. RTE.	SECTION	COUNTY	TOTAL SHEETS	SHEET NO.
c:\pwwork\pwwid\LAUGHLINRL\dms20175\d672b60	ksasht-e004.dgn	DRAWN -	REVISED -		SCALE: 1" = 5'	SHEET NO. 37 OF 50 SHEETS	STA. 42+50.00 TO STA. 43+00.00	7(W-1,RS-8,N); 9RS-4	BROWN	177	152
		CHECKED -	REVISED -		CONTRACT NO. 72B60		FED. ROAD DIST. NO. ILLINOIS FED. AID PROJECT				
		DATE -	REVISED -		* FAP 317 (1/5 24) & 550 (1/ 99)						