

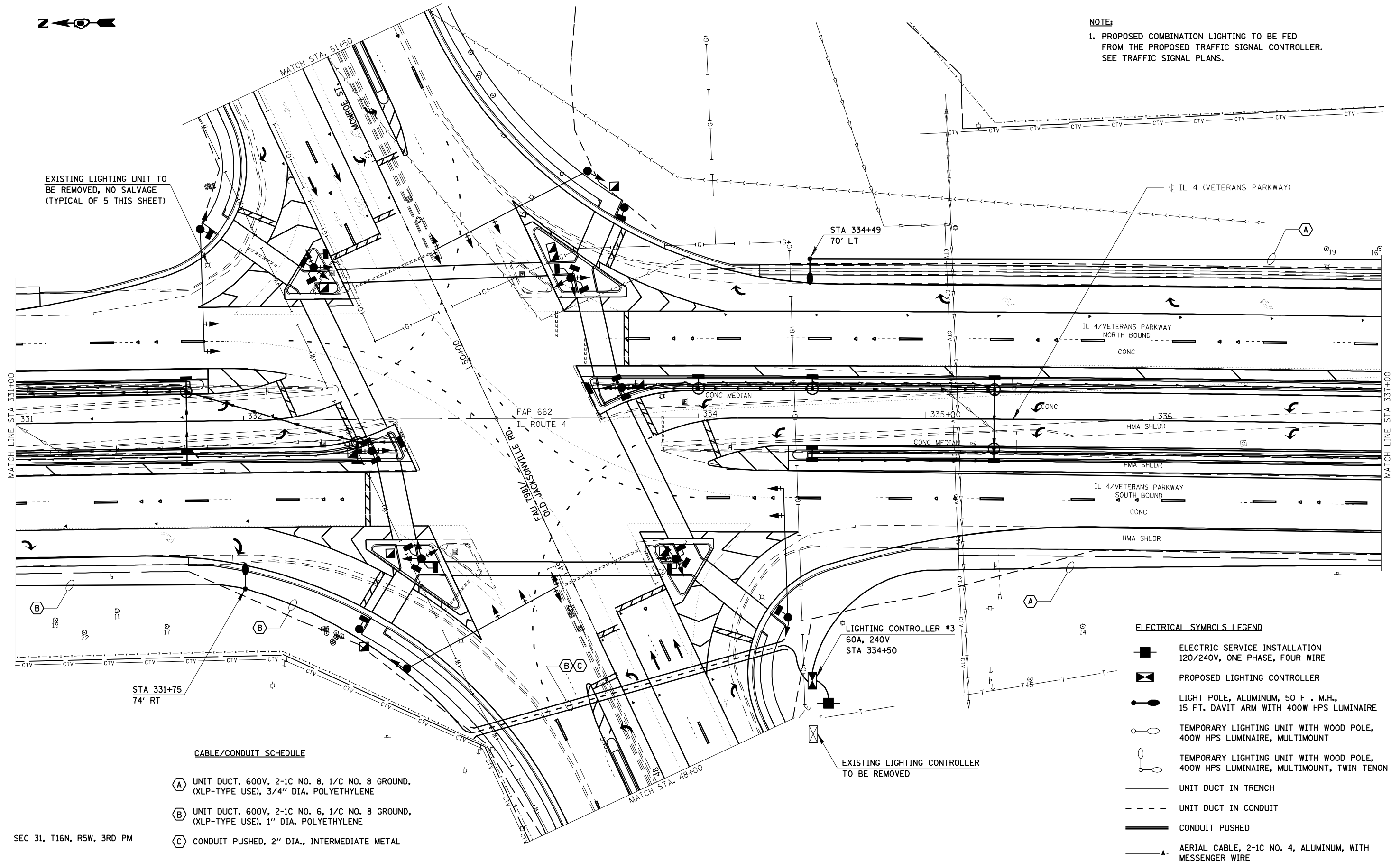

NOTE:

1. PROPOSED COMBINATION LIGHTING TO BE FED FROM THE PROPOSED TRAFFIC SIGNAL CONTROLLER. SEE TRAFFIC SIGNAL PLANS.



EXISTING LIGHTING UNIT TO BE REMOVED, NO SALVAGE (TYPICAL OF 5 THIS SHEET)

STA 334+49
70' LT

IL 4 (VETERANS PARKWAY)

IL 4/VETERANS PARKWAY
NORTH BOUND
CONC

FAP 662
IL ROUTE 4

HMA SHLDR
CONC MEDIAN

IL 4/VETERANS PARKWAY
SOUTH BOUND
CONC

HMA SHLDR

STA 331+75
74' RT

LIGHTING CONTROLLER #3
60A, 240V
STA 334+50

EXISTING LIGHTING CONTROLLER
TO BE REMOVED

CABLE/CONDUIT SCHEDULE

- (A) UNIT DUCT, 600V, 2-1C NO. 8, 1/C NO. 8 GROUND, (XLP-TYPE USE), 3/4" DIA. POLYETHYLENE
- (B) UNIT DUCT, 600V, 2-1C NO. 6, 1/C NO. 8 GROUND, (XLP-TYPE USE), 1" DIA. POLYETHYLENE
- (C) CONDUIT PUSHED, 2" DIA., INTERMEDIATE METAL

ELECTRICAL SYMBOLS LEGEND

- ELECTRIC SERVICE INSTALLATION 120/240V, ONE PHASE, FOUR WIRE
- PROPOSED LIGHTING CONTROLLER
- LIGHT POLE, ALUMINUM, 50 FT. M.H., 15 FT. DAVIT ARM WITH 400W HPS LUMINAIRE
- TEMPORARY LIGHTING UNIT WITH WOOD POLE, 400W HPS LUMINAIRE, MULTIMOUNT
- TEMPORARY LIGHTING UNIT WITH WOOD POLE, 400W HPS LUMINAIRE, MULTIMOUNT, TWIN TENON
- UNIT DUCT IN TRENCH
- UNIT DUCT IN CONDUIT
- CONDUIT PUSHED
- AERIAL CABLE, 2-1C NO. 4, ALUMINUM, WITH MESSENGER WIRE