

All sizes shall have standard 1/4 chamfers except as noted

STATE OF ILLINOIS DEPARTMENT OF TRANSPORTATION

NO.	REV.	DATE	BY	CHKD.	DESCRIPTION
1					
2					
3					
4					
5					
6					
7					
8					
9					
10					
11					
12					
13					
14					
15					
16					
17					
18					
19					
20					

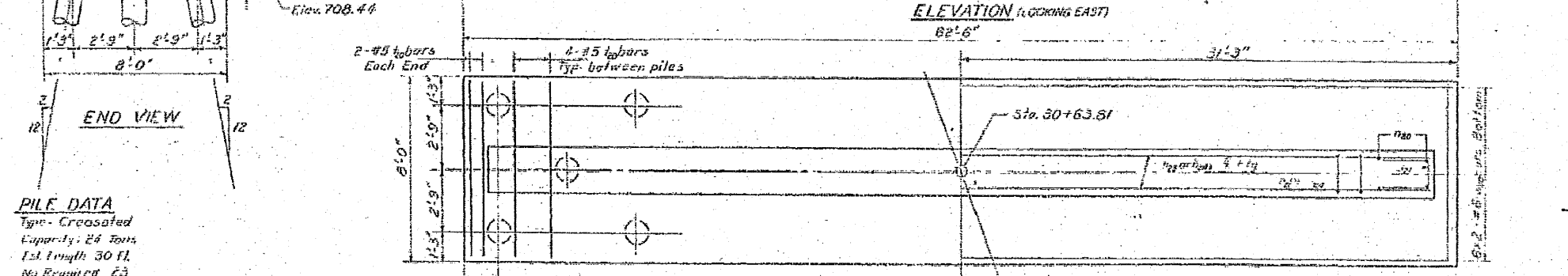
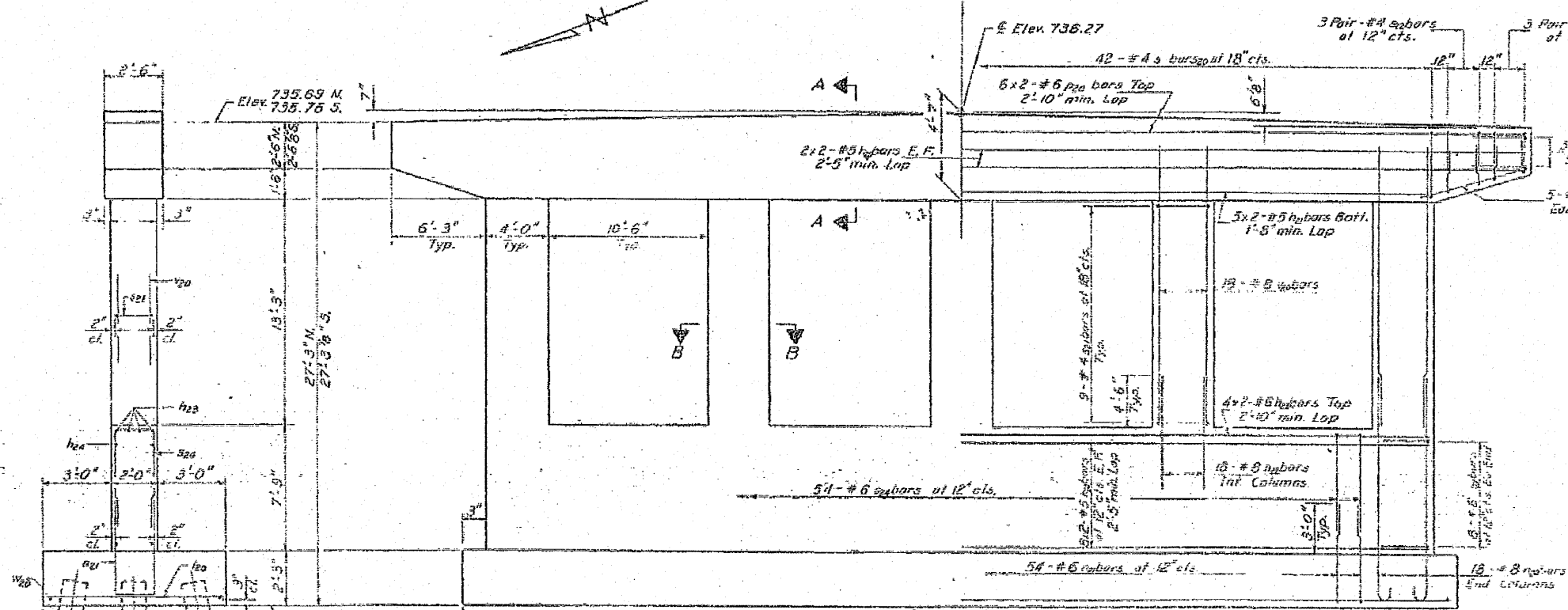
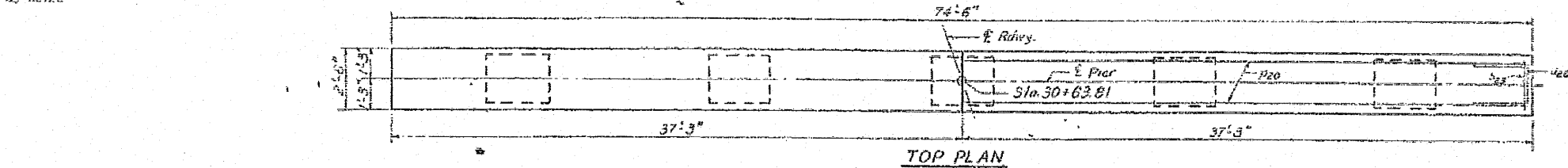

**PILE DATA**  
 Type - Cressed  
 Capacity - 24 Tons  
 Est. Length 30 ft.  
 No. Required - 23

DESIGNED: [Signature]  
 CHECKED: Richard Brunette  
 DRAWN: K.P. Summer  
 CHECKED: R.B.

EXAMINED: [Signature]  
 PASSED: [Signature]  
 APPROVED: [Signature]

March 2, 2009

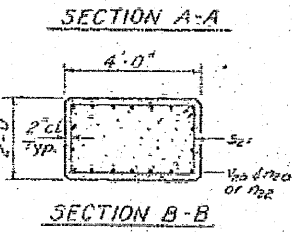
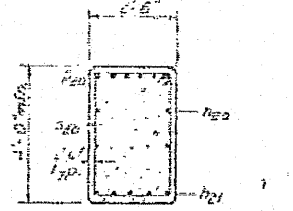

BILL OF MATERIAL

NO.	QTY.	SIZE	LENGTH	WEIGHT
122	8	#4	32'-4"	
123	10	#5	31'-9"	
124	10	#5	6'-6"	
125	8	#6	32'-4"	
126	32	#5	32'-4"	
127	36	#8	16'-2"	
128	54	#6	11'-8"	
129	54	#8	7'-2"	
130	12	#6	32'-4"	
131	42	#4	7'-2"	
132	45	#4	11'-8"	
133	12	#4	7'-6"	
134	12	#4	6'-10"	
135	34	#6	14'-8"	
136	30	#5	7'-8"	
137	6	#6	8'-1"	
138	16	#6	7'-7"	
139	30	#8	16'-2"	
140	12	#6	32'-4"	

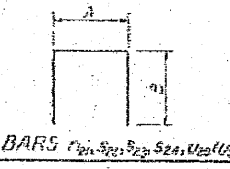

A/B DIMENSIONS

Bar	A	B
122	7'-8"	11'-8"
123	7'-8"	11'-8"
124	7'-8"	11'-8"
125	7'-8"	11'-8"
126	7'-8"	11'-8"
127	7'-8"	11'-8"
128	7'-8"	11'-8"
129	7'-8"	11'-8"
130	7'-8"	11'-8"
131	7'-8"	11'-8"
132	7'-8"	11'-8"
133	7'-8"	11'-8"
134	7'-8"	11'-8"
135	7'-8"	11'-8"
136	7'-8"	11'-8"
137	7'-8"	11'-8"
138	7'-8"	11'-8"
139	7'-8"	11'-8"
140	7'-8"	11'-8"

Class A Concrete, Conc. 120.1  
 Reinforcement Bars, Lbs. 13660  
 Cressed Piles 201 to 100 ft. 690  
 305 feet

PIER 2  
 F.A.P. RT91 SEC. 19VBR  
 COLES COUNTY  
 STA. 30+63.74