

The existing 3 span steel multi-beam structures were constructed in 1975 as section 58-66B at sta. 721+12.00. SN 058-0093 carries FAI-72 eastbound and SN 085-0094 carries FAI-72 westbound. The proposed project consists of new expansion joints, partial and full depth deck patching, replacement of bearings at abutments, new microsilica wearing surface on the deck and approach slabs, new deck drains and structural repair of concrete.

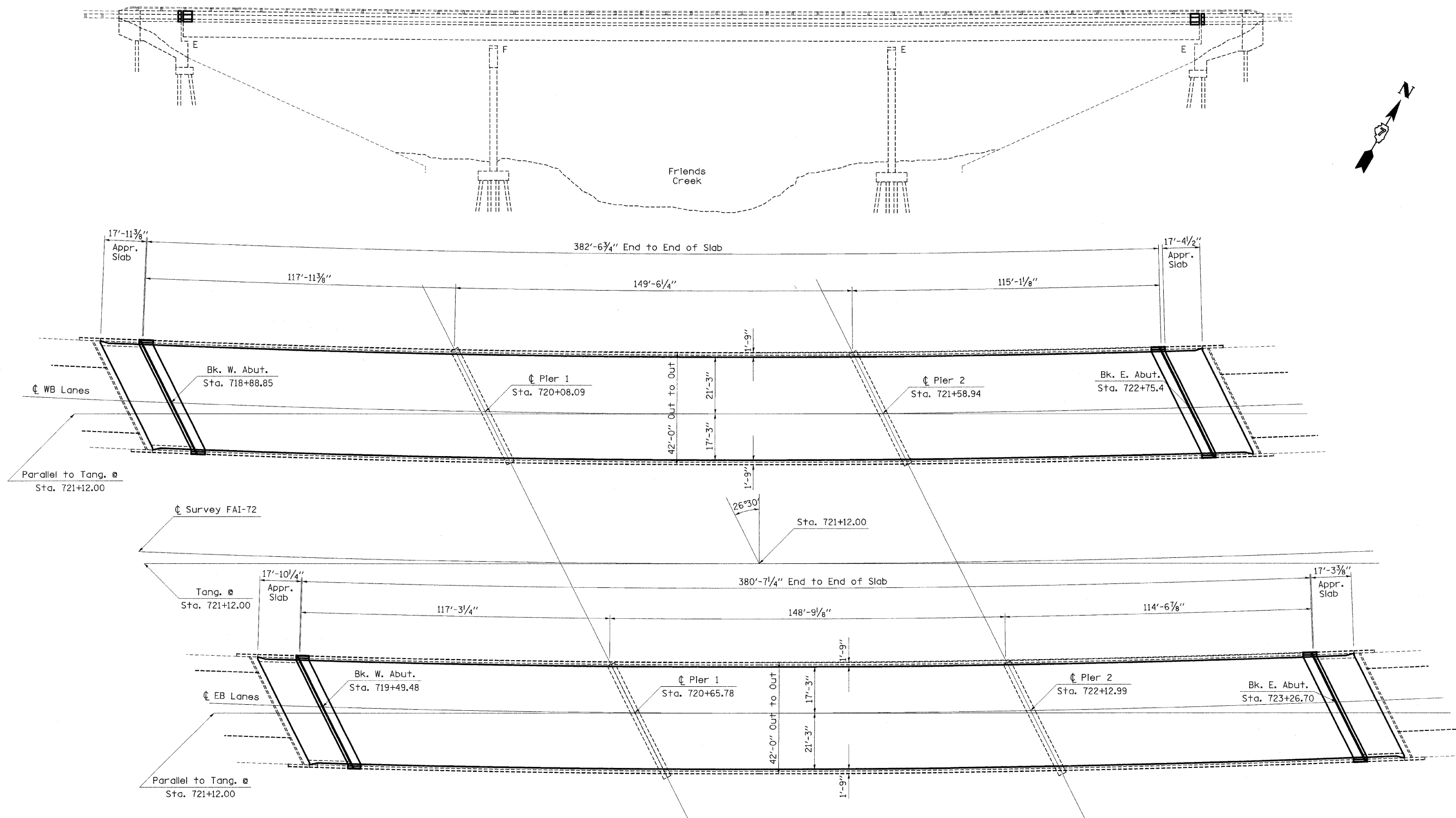

FILE NAME = c:\pw\work\PI\DOT\SWARTZRW\dms37779\k...enbridge.dgn	USER NAME = swartzw	DESIGNED -	REVISED -	<b>STATE OF ILLINOIS DEPARTMENT OF TRANSPORTATION</b>	<b>GENERAL PLAN &amp; ELEVATION SN. 058-0093 (EB) &amp; 058-0094 (WB)</b>		F.A.I. RTE. 72	SECTION 66(B,HVB,HB-1)BR	COUNTY MACON	TOTAL SHEETS 83	SHEET NO. 29
PLOT SCALE = 20,0000' / IN.	PLOT DATE = 9/28/2009	DRAWN -	REVISED -		SCALE: N/A	SHEET NO. 2 OF 17 SHEETS	FED. ROAD DIST. NO.		ILLINOIS FED. AID PROJECT	CONTRACT NO. 74343	
		CHECKED -	REVISED -								
		DATE -	REVISED -								