

Note: Trim existing long. reinf. to accomodate new joint opening (typ.)

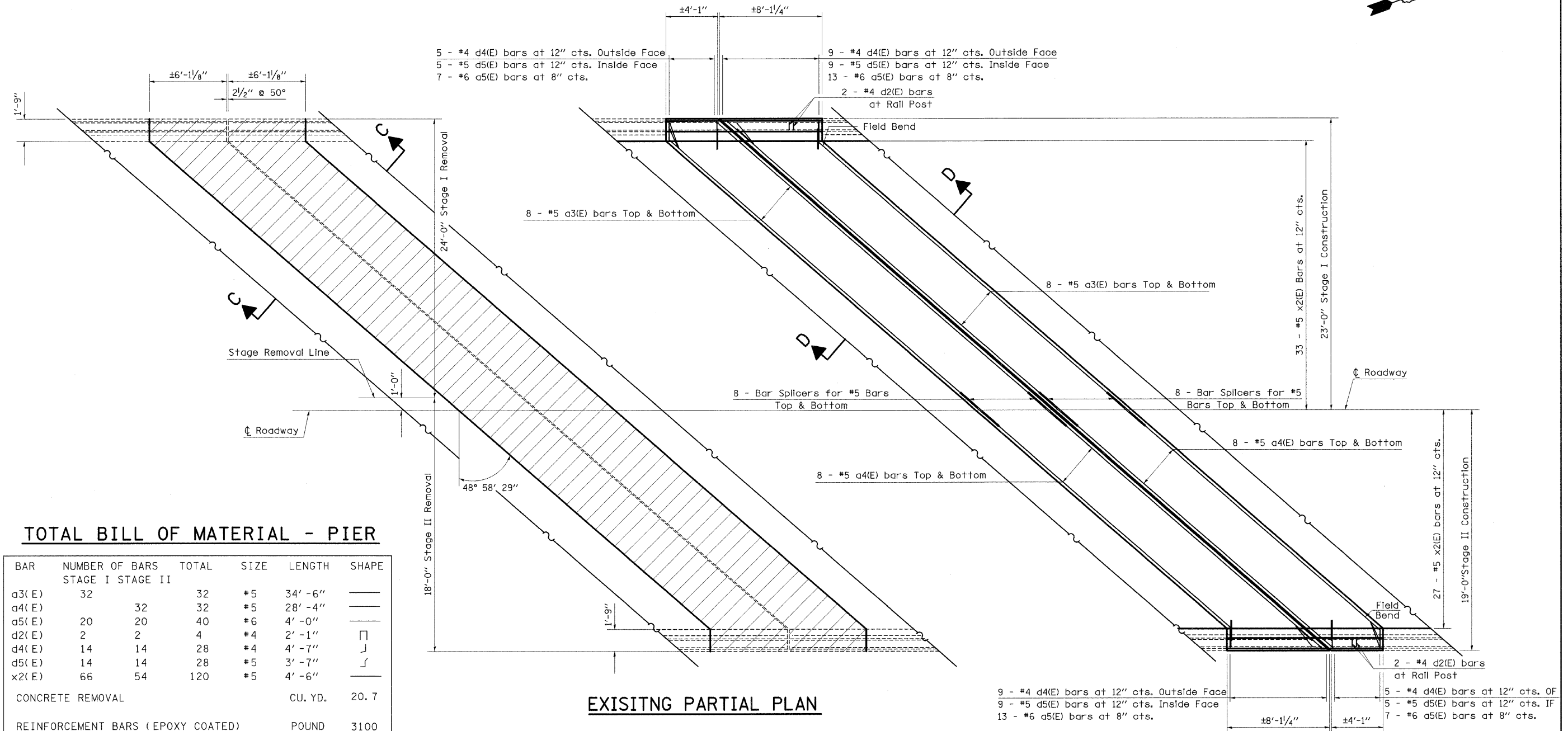
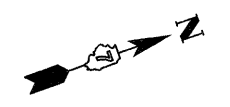

**TOTAL BILL OF MATERIAL - PIER**

BAR	NUMBER OF BARS		TOTAL	SIZE	LENGTH	SHAPE	
	STAGE I	STAGE II					
a3(E)	32		32	#5	34' - 6"	—	
a4(E)		32	32	#5	28' - 4"	—	
a5(E)	20	20	40	#6	4' - 0"	—	
d2(E)	2	2	4	#4	2' - 1"	⌈	
d4(E)	14	14	28	#4	4' - 7"	J	
d5(E)	14	14	28	#5	3' - 7"	⌋	
x2(E)	66	54	120	#5	4' - 6"	—	
CONCRETE REMOVAL						CU. YD.	20.7
REINFORCEMENT BARS (EPOXY COATED)						POUND	3100
CONCRETE SUPERSTRUCTURE						CU. YD.	23.2

REINFORCEMENT BARS DESIGNATED (E) SHALL BE EPOXY COATED

**EXISTING PARTIAL PLAN**

**PROPOSED PARTIAL PLAN**

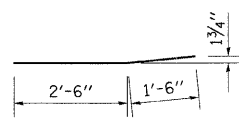

**BAR a4(E)**

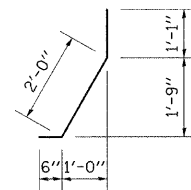

**BAR d5(E)**

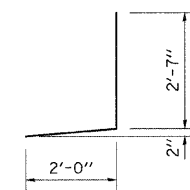

**BAR d4(E)**

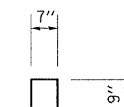

**BAR d2(E)**

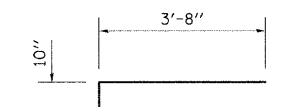

**BAR x2(E)**