

B.11: Railroad Spike in 30' Hoop 535 Feet
Left of Station 5834 + 34 Elev. 649.52.

STATE OF ILLINOIS
DEPARTMENT OF PUBLIC WORKS & BUILDINGS
DIVISION OF HIGHWAYS

PART NO.	SECTION	COUNTY	SHEET NO.	SHEET NO. /
		CUMBERLAND	12	4 / 10 SHEETS
74401				

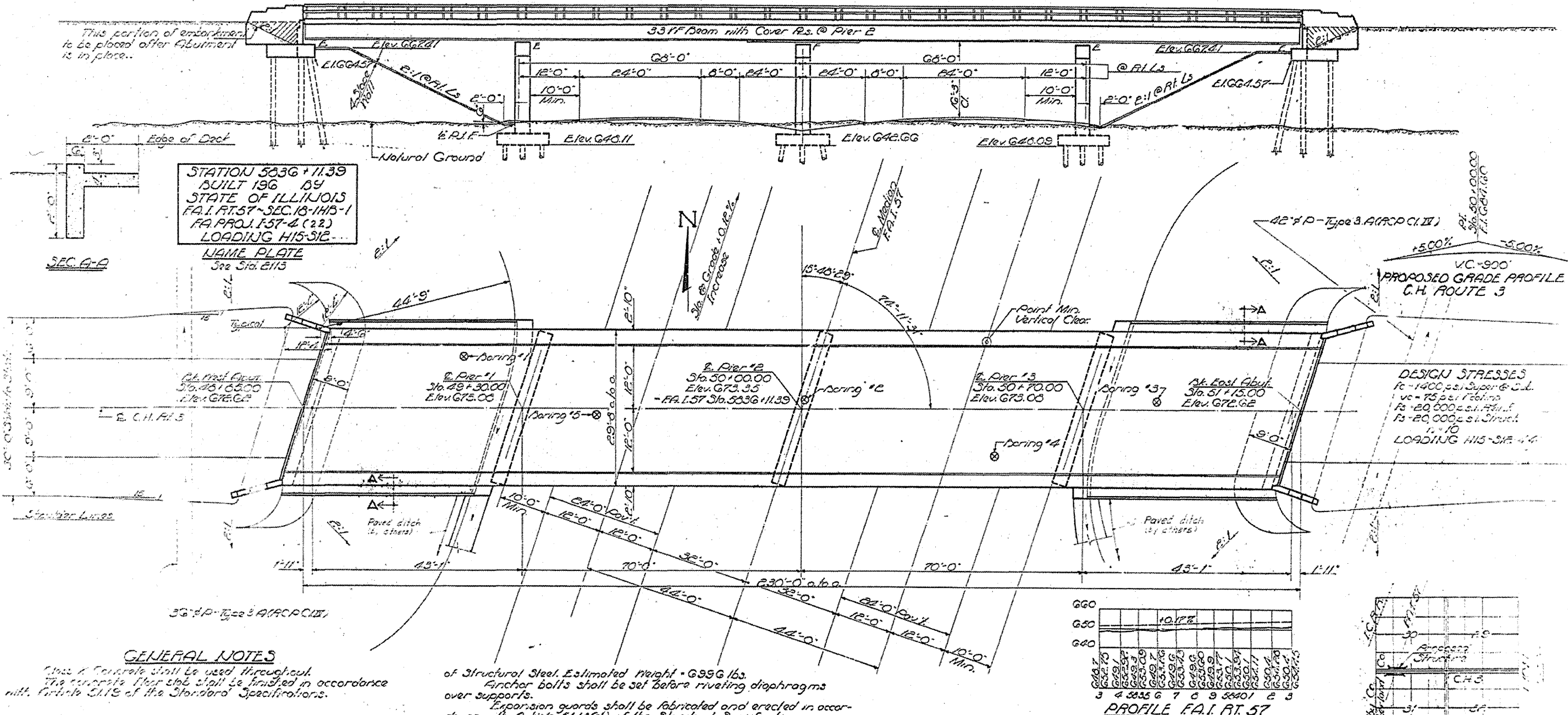

STATION 5836 + 11.39
BUILT 196 BY
STATE OF ILLINOIS
F.A.I. RT. 57 - SEC. 18-1/4-1
LOADING HIS-SIE-44
NAME PLATE
See Sta. 5115

DESIGN STRESSES
Rc = 1400 p.s.i. Super & S.L.
Vc = 75 p.s.i. Reinfr.
Fs = 20,000 p.s.i. Reinfr.
Ft = 20,000 p.s.i. Struct.
LOADING HIS-SIE-44

GENERAL NOTES

Class A Concrete shall be used throughout.
The concrete floor shall be finished in accordance with Article 51.15 of the Standard Specifications.
Grade concrete which is to be used in end posts must be free of dirt, silt, lime, kerosene and soft sandstone.
Steel reinforcement shall be reinforced with welded wire fabric.
All Structural Steel shall conform to the A.S.T.M. Specifications for Structural Steel, A. 36, Designation A-36.
Piles shall be driven in accordance with Article 51.15 of the Standard Specifications and are included in quantity.

of Structural Steel. Estimated weight - 6996 lbs.
Anchor bolts shall be set before riveting diaphragms over supports.
Expansion guards shall be fabricated and erected in accordance with Article 51.13(d) of the Standard Specifications.
Expansion guards are included in quantity of Structural Steel. Est'd. Wt. 770 lbs.
Except as otherwise provided, all structural steel shall receive one shop coat of red lead paint and two field coats of aluminum paint. See Articles 56.1 to 56.5 inclusive of the Standard Specifications.
All paint shall be furnished and applied by the Contractor.
The Contractor shall drive 2 test piles as directed by the Engineer before ordering remainder of piles. One concrete test pile in permanent location at West Abutment and one timber test pile in vicinity of Pier 2.
Piles in abutments shall be driven in holes precored through the embankment to the natural ground line in accordance with Article 60.9(c) of the Standard Specifications.

TOTAL BILL OF MATERIAL

Item	Unit	Super	Sub	Total
Class A Exc. Struct.	Cu. Yd.		190	190
Class A Concrete	Cu. Yd.	191.6	198.3	389.9
Structural Steel	Lbs.	166,500		166,500
Material Handrail	L.in.Ft.	455		455
Reinforcement Bars	Lbs.	36,950	14,920	51,870
Creosoted Piles	L.in.Ft.		792	792
Test Piles (Timber)	Each		1	1
Concrete Piles	L.in.Ft.		544	544
Test Piles (Concrete)	Each		1	1
Name Plates	Each		2	2
Slope Wall (C.)	Sq. Yd.			542
Protective Coat	Sq. Yd.	605		605

* Includes excavation for slope wall

GENERAL PLAN & ELEVATION
PROJECT 1-57-4 (22) 173
C.H. RT. 3 OVER INTERSTATE 57
F.A.I. RT. 57 - SEC. 18-1/4-1
CUMBERLAND COUNTY
STA. 5836 + 11.39

LOCATION 1

... of the Standard Specifications... Bill of Material removed items... Total from 45231 to 54,810 lbs.