

PLAN	SURVEYED	BY	DATE
	NOTED		
	CHECKED		
	FILED		
	NO.		

PROFILE	SURVEYED	BY	DATE
	NOTED		
	CHECKED		
	FILED		
	NO.		

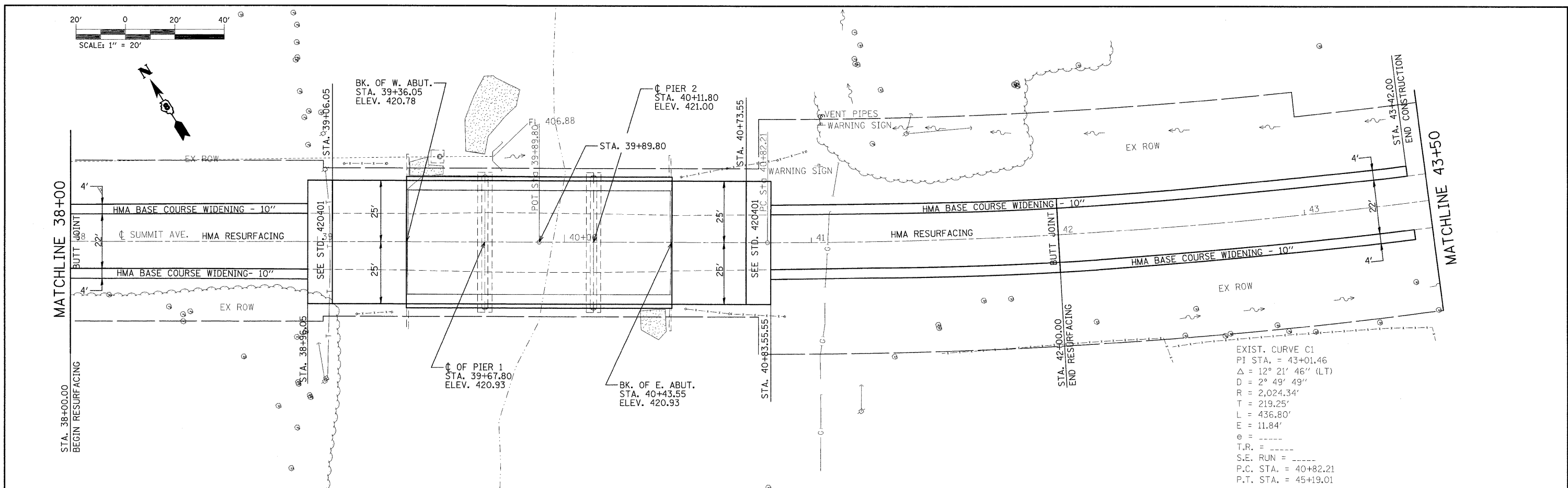

EXIST. CURVE C1  
 PI STA. = 43+01.46  
 $\Delta = 12^\circ 21' 46''$  (LT)  
 $D = 2^\circ 49' 49''$   
 $R = 2,024.34'$   
 $T = 219.25'$   
 $L = 436.80'$   
 $E = 11.84'$   
 $\epsilon =$   
 $T.R. =$   
 $S.E. RUN =$   
 $P.C. STA. = 40+82.21$   
 $P.T. STA. = 45+19.01$

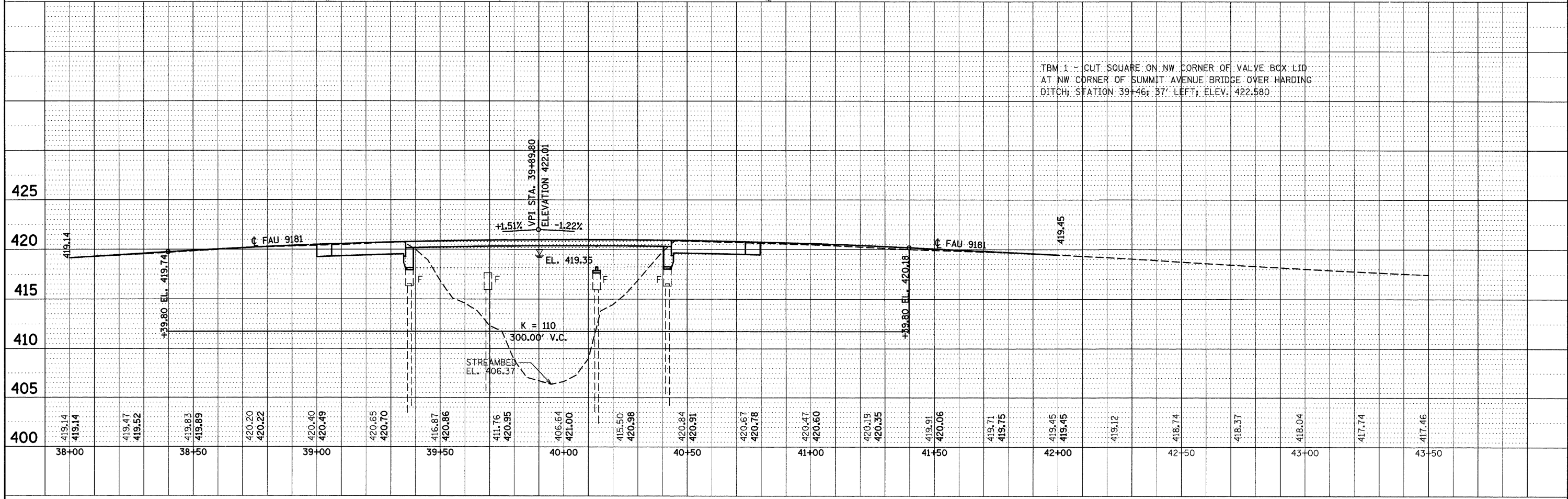

TBM 1 - CUT SQUARE ON NW CORNER OF VALVE BOX LID  
 AT NW CORNER OF SUMMIT AVENUE BRIDGE OVER HARDING  
 DITCH; STATION 39+46; 37' LEFT; ELEV. 422.580

FILE NAME =	USER NAME = manntm	DESIGNED -	REVISED -	<b>STATE OF ILLINOIS DEPARTMENT OF TRANSPORTATION</b>	<b>PLAN &amp; PROFILE SHEETS</b>	F.A.U. RTE. 9181	SECTION 52BR	COUNTY ST. CLAIR	TOTAL SHEETS 41	SHEET NO. 8		
ce:\pw_work\p\WIDOT\MANNM\dms71221\p\in84498a.dgn	PLOT SCALE = 20,000 / IN.	DRAWN -	REVISED -			SCALE:	SHEET NO. 2 OF 3 SHEETS	STA. 38+00	TO STA. 43+50	CONTRACT NO. 76120		
	PLOT DATE = 10/7/2009	CHECKED -	REVISED -			ILLINOIS FED. AID PROJECT						
		DATE -	REVISED -									