

**LOCATION**

**ADDITIONAL SIGNS**

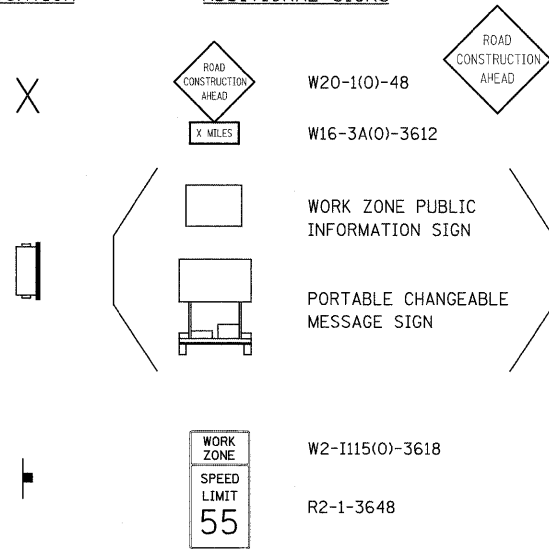

**NOTE:**

ADDITIONAL SIGNS AT THE FOUR LOCATIONS SHOWN BELOW IN ACCORDANCE WITH HIGHWAY STANDARD 701400, SHALL BE PAID FOR AT THE CONTRACT UNIT PRICE, EACH, FOR "TRAFFIC CONTROL AND PROTECTION, STANDARD 701402 (SPECIAL)".

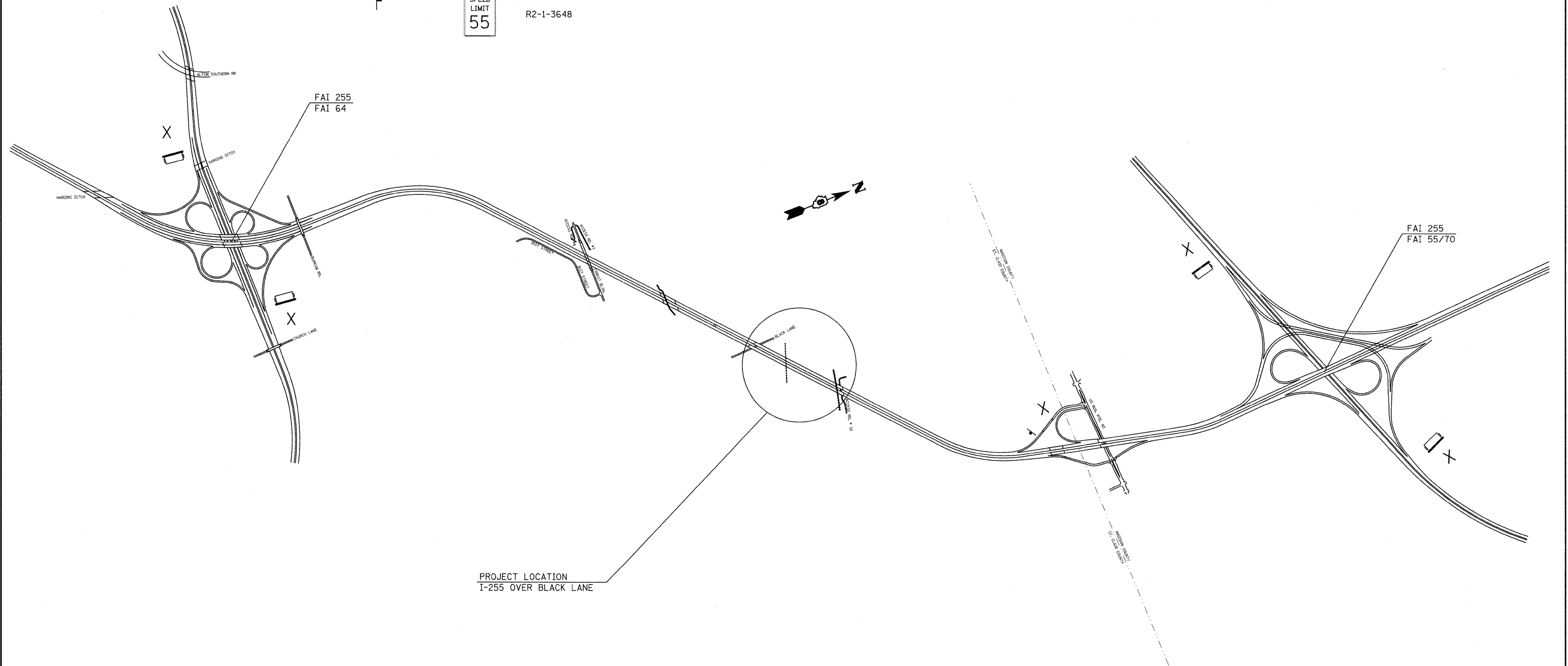

FILE NAME =	USER NAME = gelinh	DESIGNED - ---	REVISED - ---	<b>STATE OF ILLINOIS DEPARTMENT OF TRANSPORTATION</b>	<b>TRAFFIC CONTROL SIGNING PLAN</b>			F.A.I. RTE.	SECTION	COUNTY	TOTAL SHEETS	SHEET NO.
c:\pw\work\p\dot\gelinh\d0116762\0876925-StagingAdgn		DRAWN - ---	REVISED - ---		255	82-1HVB-1-1	ST CLAIR	45	7			
PLOT SCALE = 50.0000' / IN.		CHECKED - ---	REVISED - ---		CONTRACT NO. 76926							
PLOT DATE = 10/7/2009		DATE - ---	REVISED - ---		ILLINOIS FED. AID PROJECT							

SCALE: 1" = 50'    SHEET NO. 1 OF 1 SHEET    STA. \_\_\_\_\_ TO STA. \_\_\_\_\_