

C.M. Chiseled 11' NE Corner top wingwall N. Fork of Kaskaskia River Bridge. 18' L.A. Sta 687+22 Elev. 482.05
 Exist. Structure Built as S.B.T. Rte 2, Sec. 25B-1, Sta. 687+90 in 1937. Superstr is RC Slab on W/Bms. to be removed. Substr. is R.C. Pile Bents. Contr. shall utilize stage const. & maintain traffic at all times. Salvage.

STATE OF ILLINOIS
 DEPARTMENT OF TRANSPORTATION

ROUTE NO.	SECTION	COUNTY	TOTAL SHEETS	SHEET NO.
25BR	Marion	11	4	8 SHEETS

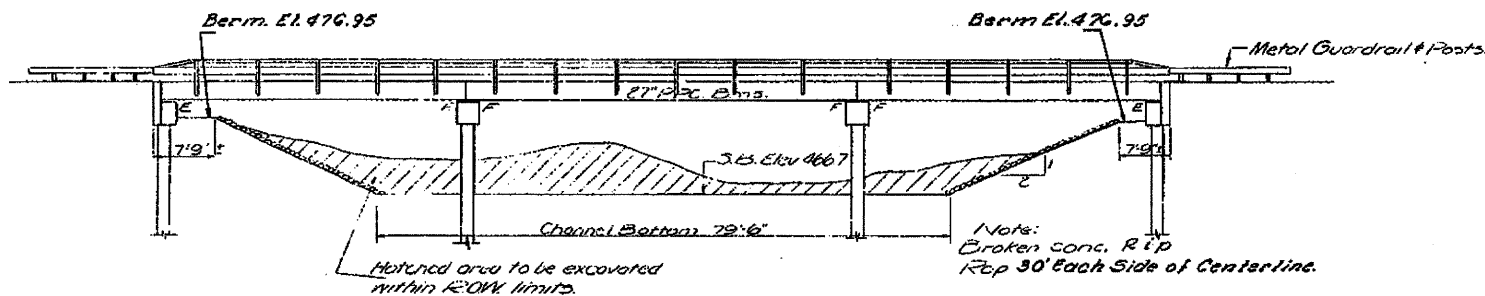

ELEVATION

STATION 687+90
 REBUILT 197 BY
 STATE OF ILLINOIS
 F.A. RT. 2 SEC. 25BR
 LOADING HS. 20-44

NAME PLATE
 (See 31d. 2119)

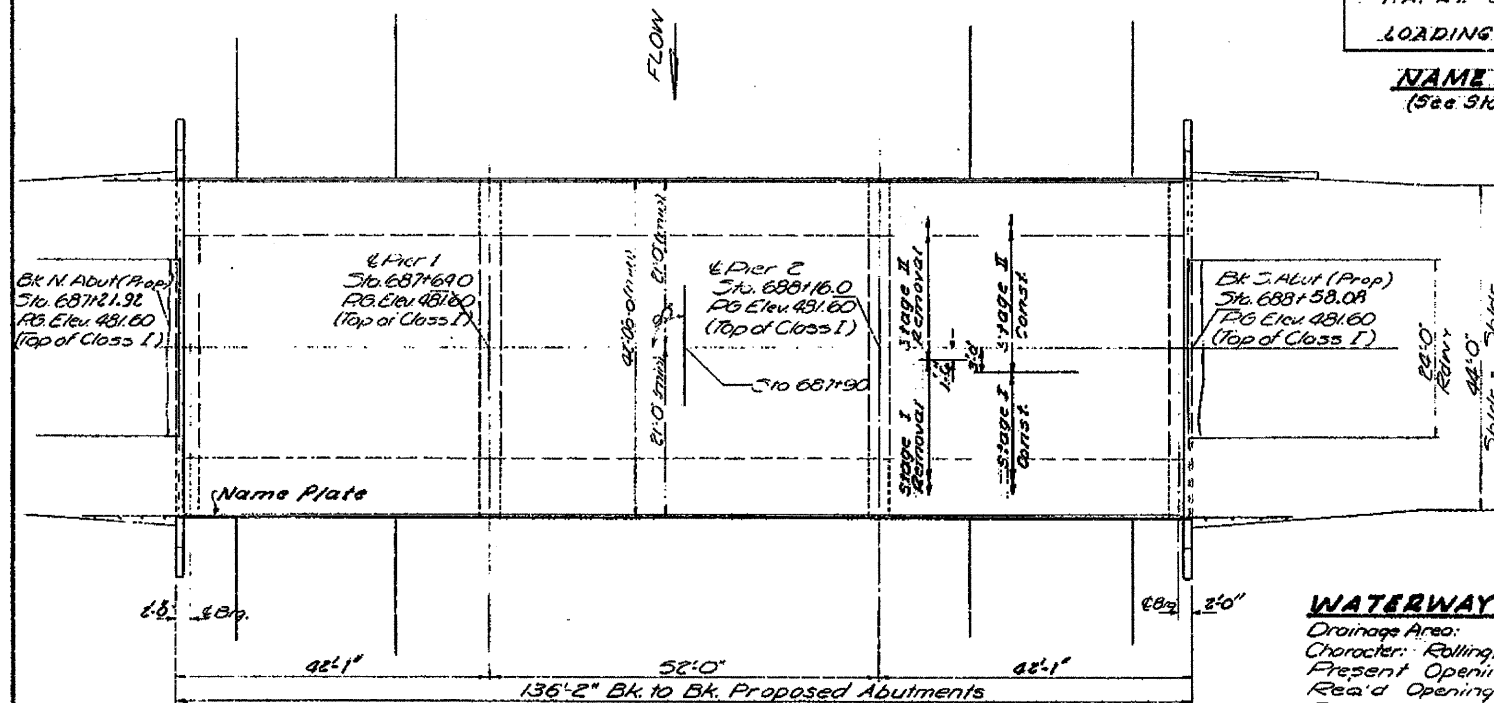

WATERWAY INFORMATION

Drainage Area: 40 Sq. Miles
 Character: Rolling, wooded, clay, cultivated, hilly.
 Present Opening 850 Sq. Ft.
 Road Opening 1200 Sq. Ft.
 Proposed Opening 1200 Sq. Ft. (Beneath low concrete)
 Q₁₀₀ = 6837 cfs.

TOTAL BILL OF MATERIAL

Item	Unit	Super	Sub	Total
Bituminous Concrete Surface Course Class I	Tons	92		92
Coal Tar Interlayer	Sq. Yds	597		597
Protective Coat	Sq. Yds	44		44
Steel Railing, Type T	Lin. Ft.	207		207
Precast Prestressed Concrete Deck Beams (27)	Sq. Ft.	5594		5594
Structural Steel	Lbs.	6630		6630
Preformed Jt. Sealer	Lin. Ft.	59		59
Temporary Guardrail	Lin. Ft.	139		139
Class X Concrete	Cu. Yds	8.4	19.6	28.0
Concrete Removal	Cu. Yds		49	49
Reinforcement Bars	Lbs.	300	6330	6630
Name Plates	Each	1		1
Pavement Removal & R.C.G. Replacement Type II - 10"	Sq. Yds.	15		15
Removal of Existing Superstructures	Each	1		1
Channel Excavation	Cu. Yds		778	778
Broken Concrete Rip Rap	Sq. Yds		303	303

DESIGNED: *John A. Morris*
 CHECKED: *John A. Morris*
 DRAWN: *J. Kessler*
 CHECKED: *JM*

EXAMINED: *John A. Morris*
 PASSED: _____
 APPROVED: _____

SEPTEMBER 12 1972

DESIGN STRESSES

FIELD UNITS
 fc: 1400 psi (Sub) (Super)
 fs: 20000 psi (Reinf. & Struct.)
 n: 10

PREC. PRESTR. UNITS
 fc: 5000 psi.
 fc: 4000 psi
 fs: 270000 psi (1/4" Strands)
 fs: 188,700 psi (3/8" Strands)

Design Specifications AA5HO, 1969 as applicable.

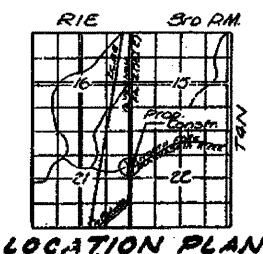
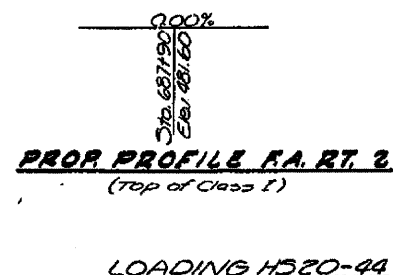

GENERAL PLAN & ELEVATION
 R.A. RT. 2 OVER
 N. FORK KASKASKIA RIVER
 R.A. RT. 2 SEC. 25BR
 MARION COUNTY
 STATION 687+90.

FILE NAME: 06FILE6	USER NAME: MUSER	DESIGNED: _____	REVISED: _____	STATE OF ILLINOIS DEPARTMENT OF TRANSPORTATION	EXISTING STRUCTURE PLANS FOR INFORMATION ONLY	F.A. RT. 2	SECTION 25BR-1	COUNTY MARION	TOTAL SHEETS 63	SHEET NO. 17
PLOT SCALE: 1"=40'	CHECKED: _____	DATE: _____	REVISED: _____	SCALE: _____	SHEET NO. 1 OF 7 SHEETS	STA. _____	TO STA. _____	ILLINOIS STATE AID PROJECT CONTRACT NO. 76A83		