

PLAN	SURVEYED	DATE
	ALIGNED	
	NOTED	
	BY	
	NO. OF WAY CHECKED	
	FILE NAME	
	NO.	

PROFILE	SURVEYED	DATE
	GRADES CHECKED	
	BY	
	NO. OF WAY CHECKED	
	FILE NAME	
	NO.	

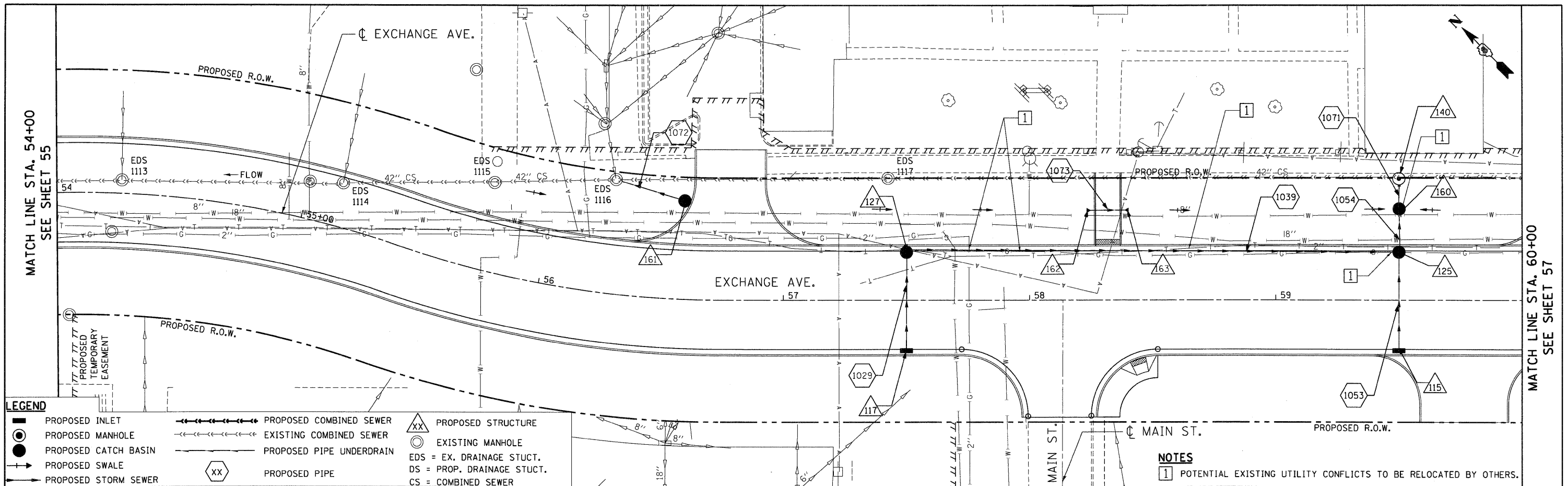

**LEGEND**

■ PROPOSED INLET	— PROPOSED COMBINED SEWER	△ PROPOSED STRUCTURE
● PROPOSED MANHOLE	- - - EXISTING COMBINED SEWER	○ EXISTING MANHOLE
● PROPOSED CATCH BASIN	— PROPOSED PIPE UNDERDRAIN	EDS = EX. DRAINAGE STUCT.
→ PROPOSED SWALE	XX PROPOSED PIPE	DS = PROP. DRAINAGE STUCT.
→ PROPOSED STORM SEWER		CS = COMBINED SEWER

**NOTES**  
 1 POTENTIAL EXISTING UTILITY CONFLICTS TO BE RELOCATED BY OTHERS.

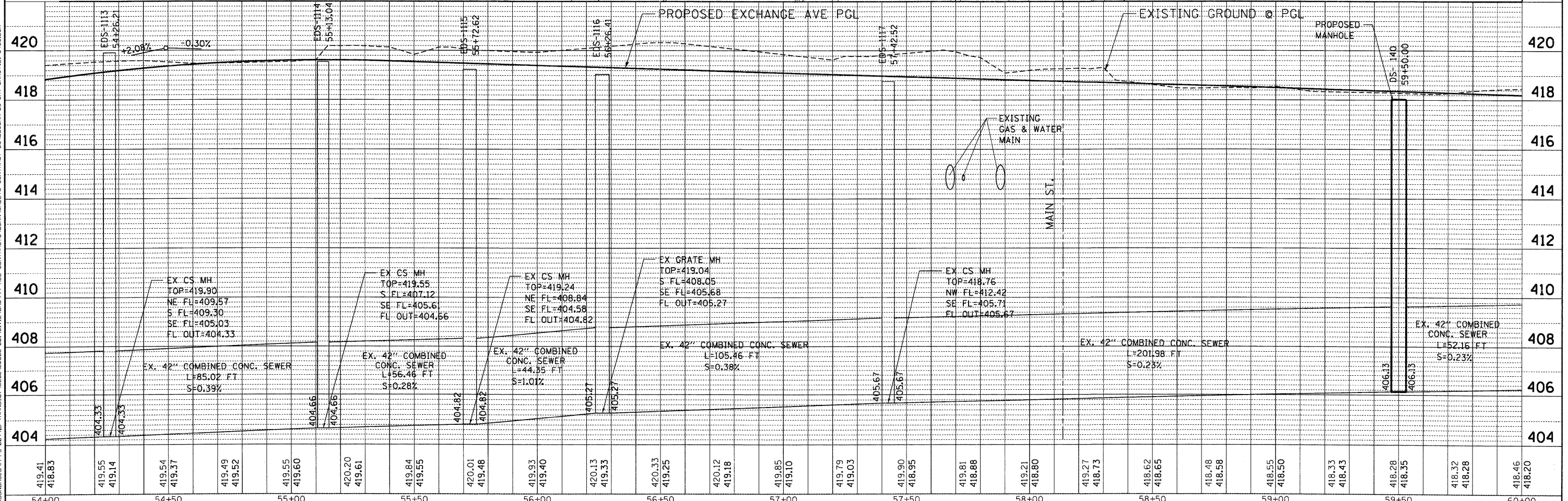

FILE NAME =	USER NAME = #USER#	DESIGNED - MMCg	REVISED -	<b>STATE OF ILLINOIS</b> <b>DEPARTMENT OF TRANSPORTATION</b> I-70 CONNECTION	<b>PROPOSED DRAINAGE PLAN &amp; PROFILE</b> <b>EXCHANGE AVENUE</b> <b>STA. 54+00.00 TO STA. 60+00.00</b>			F.A.P. RTE. 9153	SECTION 82-1K	COUNTY ST. CLAIR	TOTAL SHEETS 107	SHEET NO. 56
#FILE#		DRAWN - MMCg	REVISED -		SCALE: HORIZ. 1"=20'	VERT. 1"=2'	STA. TO STA.	FED. ROAD DIST. NO. ILLINOIS FED. AID PROJECT	CONTRACT NO. 76C40			
		CHECKED - TKL	REVISED -									
		DATE - 10/09/09	REVISED -									

10-20-2009, 16:46:28 BONDHJJD C:\LIC\WORKSPACE\BONDHJJD\VF-FS-0044-D-TRANS-07A\2202\20868-00\CIVIL\CD\99-ALL CONTRACTS\CONNSHEETS CONTRACT 83\BDC00N-03-SHT-DRNUTLL-5400.DGN