

PLAN  
 SURVEYED BY: \_\_\_\_\_ DATE: \_\_\_\_\_  
 PLOTTED BY: \_\_\_\_\_  
 CHECKED BY: \_\_\_\_\_  
 NO. OF WAY CHECKED: \_\_\_\_\_  
 CADD FILE NAME: \_\_\_\_\_

PROF ILE  
 SURVEYED BY: \_\_\_\_\_ DATE: \_\_\_\_\_  
 PLOTTED BY: \_\_\_\_\_  
 CHECKED BY: \_\_\_\_\_  
 NO. OF WAY CHECKED: \_\_\_\_\_  
 CADD FILE NAME: \_\_\_\_\_

10-14-2009 16:18:43 BONDHJUD  
 C:\IC-WORKSPACE\BONDHJUD\M-FS-004\4D-TRANS.07\2292\28866-001\CIVIL\CA0\99 ALL CONTRACTS\CONV\SHEETS CONTRACT 03\06CONN-03-SHT-DRNJULI-0000.DGN

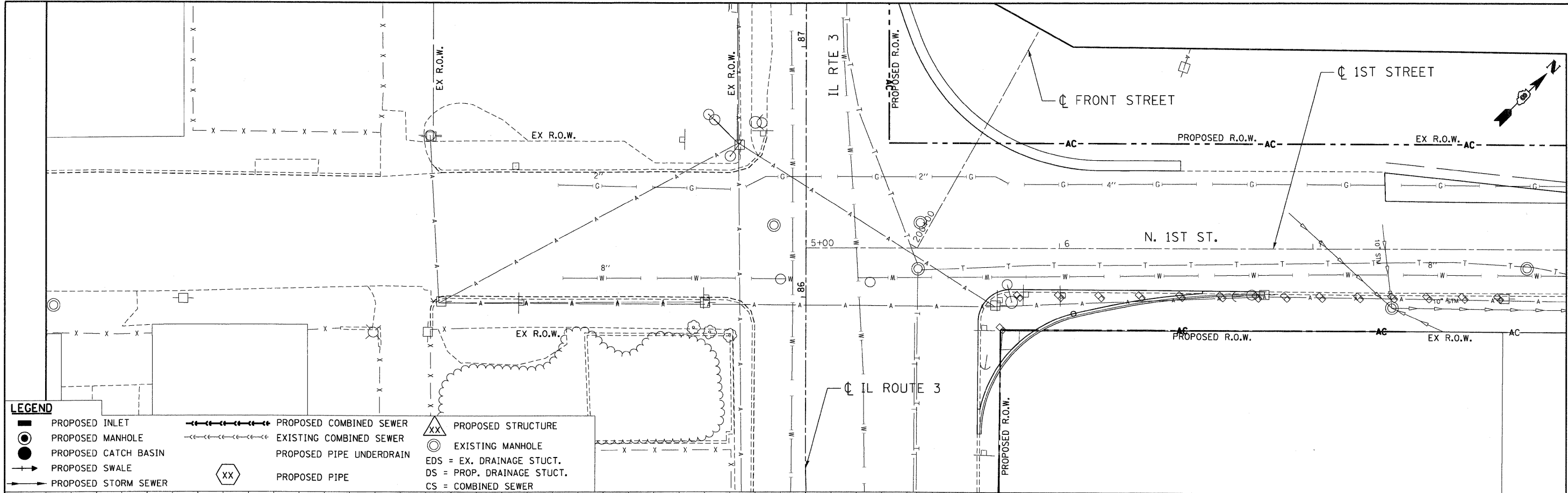

**LEGEND**

	PROPOSED INLET		PROPOSED COMBINED SEWER		PROPOSED STRUCTURE
	PROPOSED MANHOLE		EXISTING COMBINED SEWER		EXISTING MANHOLE
	PROPOSED CATCH BASIN		PROPOSED PIPE UNDERDRAIN		EDS = EX. DRAINAGE STUCT.
	PROPOSED SWALE		PROPOSED PIPE		DS = PROP. DRAINAGE STUCT.
	PROPOSED STORM SEWER				CS = COMBINED SEWER

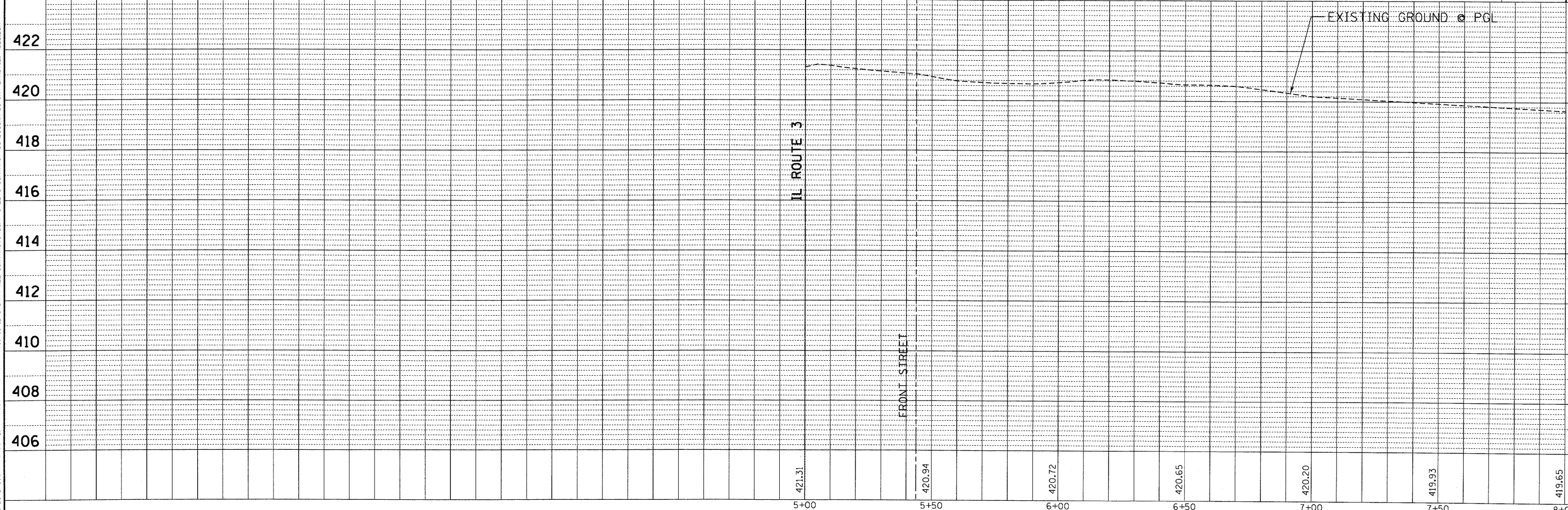

FILE NAME =	USER NAME = #USER#	DESIGNED - JB	REVISED -	<b>STATE OF ILLINOIS</b> <b>DEPARTMENT OF TRANSPORTATION</b> I-70 CONNECTION	<b>PROPOSED DRAINAGE PLAN &amp; PROFILE</b> <b>1ST STREET</b> <b>STA. 5+00.00 TO STA. 8+00.00</b>	F.A.P. RTE. 9153	SECTION 82-1K	COUNTY ST. CLAIR	TOTAL SHEETS 107	SHEET NO. 59	
#FILEL#	DRAWN - JB	CHECKED - ACL	REVISED -			SCALE: HORIZ. 1"=20'	VERT. 1"=2'	STA.	TO STA.	FED. ROAD DIST. NO.	ILLINOIS FED. AID PROJECT
PLOT SCALE = #SCALE#	DATE - 10/09/09	REVISI									
PLOT DATE = #DATE#											



MATCH LINE STA. 8+00  
SEE SHEET 60