

PLAN	SURVEYED	BY	DATE
	PLOTTED		
	NOTE BOOK		
	NO.		
	FILE NAME		

PROFILE	SURVEYED	BY	DATE
	PLOTTED		
	NOTE BOOK		
	NO.		
	FILE NAME		

10-14-2009, 16:18:58 BONDHUJOD BONDHUJOD\N\F5-0844.D-TRANS.07-2282-28868-081\CIVIL\GAD\99 ALL CONTRACTS\CONNS\SHEETS CONTRACT 03\DRNUTLL-1700.DGN

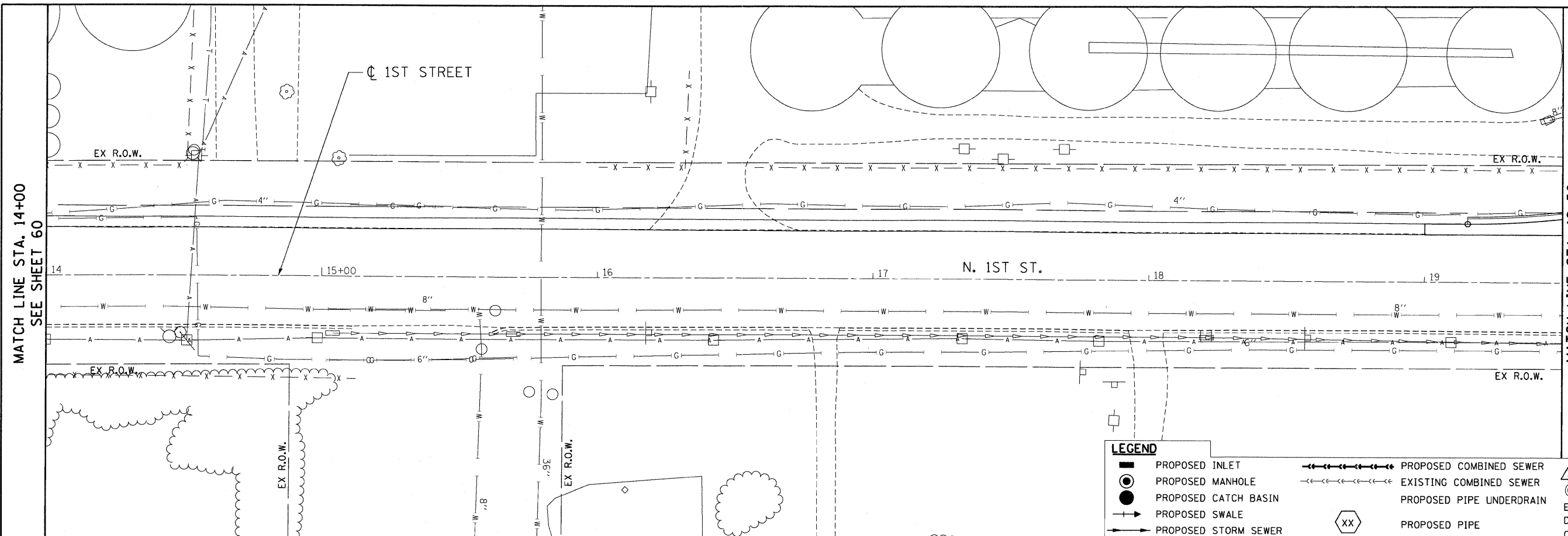

LEGEND

- PROPOSED INLET
- PROPOSED MANHOLE
- PROPOSED CATCH BASIN
- PROPOSED SWALE
- PROPOSED STORM SEWER
- PROPOSED COMBINED SEWER
- EXISTING COMBINED SEWER
- PROPOSED PIPE UNDERDRAIN
- XX PROPOSED PIPE
- △ XX PROPOSED STRUCTURE
- EXISTING MANHOLE
- EDS = EX. DRAINAGE STUCT.
- DS = PROP. DRAINAGE STUCT.
- CS = COMBINED SEWER

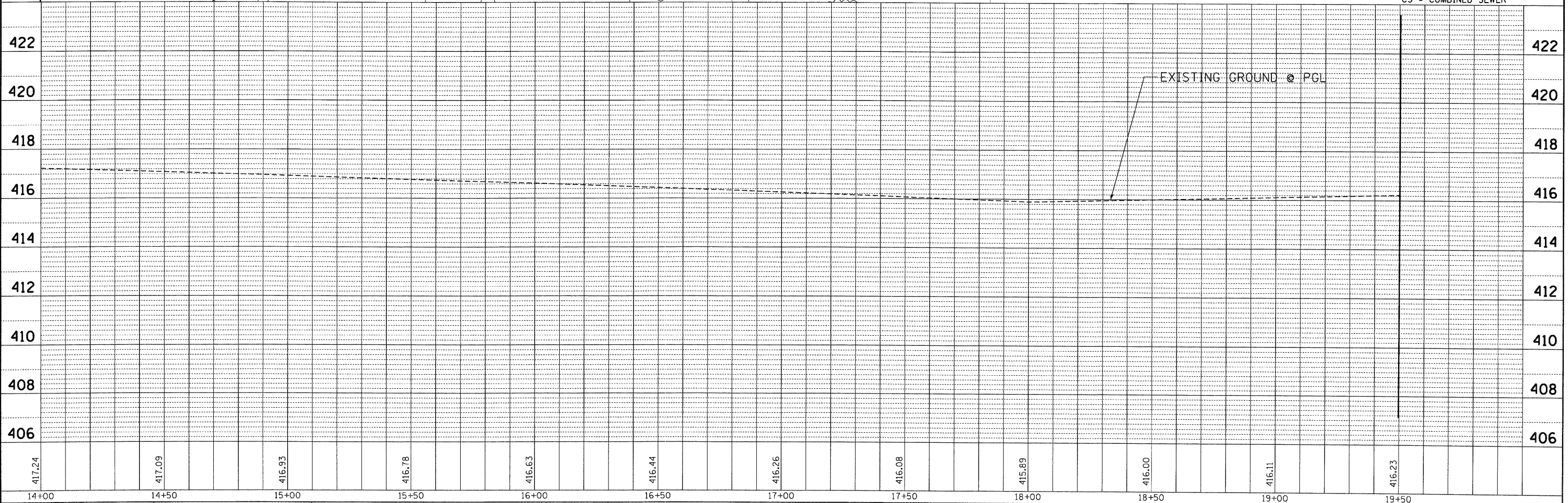

FILE NAME =	USER NAME = #USER#	DESIGNED - JB	REVISED -	STATE OF ILLINOIS DEPARTMENT OF TRANSPORTATION	PROPOSED DRAINAGE PLAN & PROFILE 1ST STREET STA. 14+00.00 TO STA. 19+50.00				F.A.P. RTE.	SECTION	COUNTY	TOTAL SHEETS	SHEET NO.
#FILE#		DRAWN - JB	REVISED -		I-70 CONNECTION				9153	82-1K	ST. CLAIR	107	61
		CHECKED - ACL	REVISED -		SCALE: HORIZ. 1"=20' VERT. 1"=2'				CONTRACT NO. 76C40				
		DATE - 10/09/09	REVISED -		STA. TO STA.				FED. ROAD DIST. NO. ILLINOIS FED. AID PROJECT				