

STATE OF ILLINOIS  
DEPARTMENT OF TRANSPORTATION

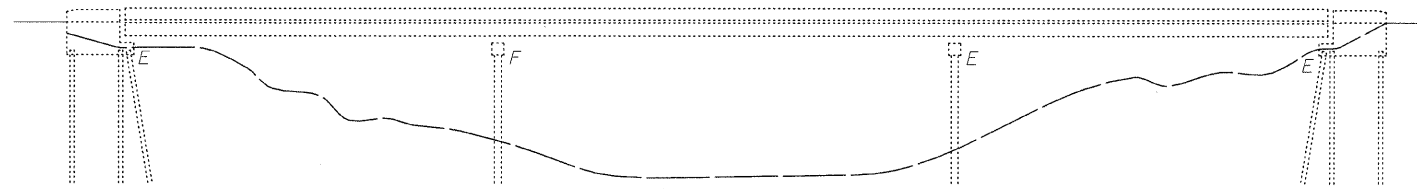

ELEVATION

INDEX OF SHEETS

1. General Plan and Elevation
2. General Data
3. Stage Construction Details
4. Temporary Concrete Barrier for Stage Construction
5. Continuous Seal Type Neoprene Expansion Joint
6. Pier Bearing Details
7. Pier 1 Details

SCOPE OF WORK

1. Replace expansion joints.
2. Wash bridge deck, parapets and abutment seats.
3. Seal deck, parapets, and abutment seats with "Concrete Sealer".
4. Remove and replace bearings at Pier 2.
5. Construct concrete pedestals around existing bearings at Pier 1.

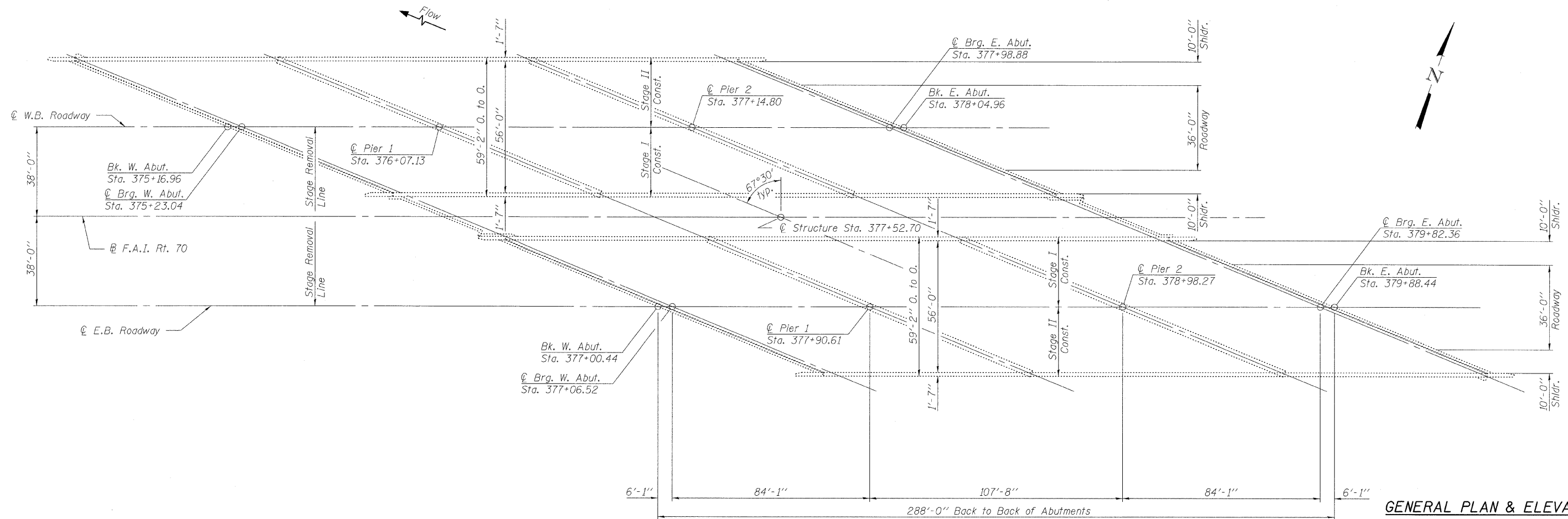

PLAN

GENERAL PLAN & ELEVATION  
I-70 OVER CANTEEN CREEK  
F.A.I. RT. 70 - SECTION 60-(6,7)BR  
MADISON COUNTY  
STA. 377+52.70  
STRUCTURE NO. 060-0010 (E.B.)  
STRUCTURE NO. 060-0011 (W.B.)

DESIGNED	KLH
CHECKED	EML
DRAWN	KLH
CHECKED	EML



Eric Lagemann 9/15/09  
Expires 11/30/2010

**HORNER & SHIFRIN, INC.**  
**ENGINEERS**

SHEET NO. 1	F.A.I. RTE.	SECTION	COUNTY	TOTAL SHEETS	SHEET NO.
	70	60-(5,6,7)RS, 60-(6,7)BR	MADISON	185	90
7 SHEETS	CONTRACT NO. 76C56				
FED. ROAD DIST. NO.		ILLINOIS FED. AID PROJECT			