

STATE OF ILLINOIS  
DEPARTMENT OF TRANSPORTATION

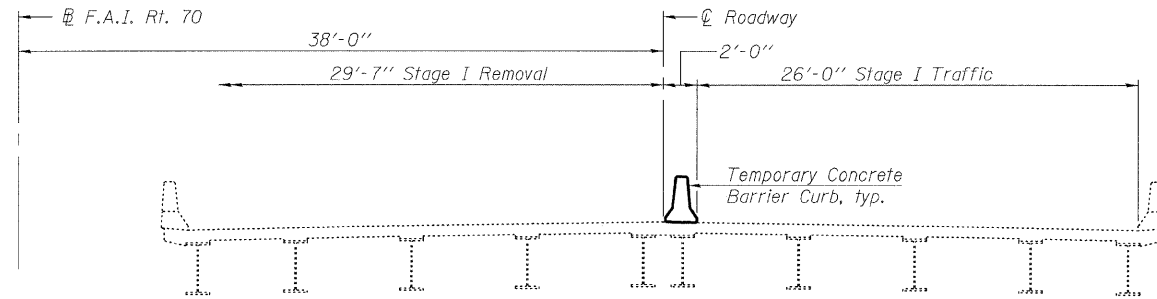

STAGE I REMOVAL

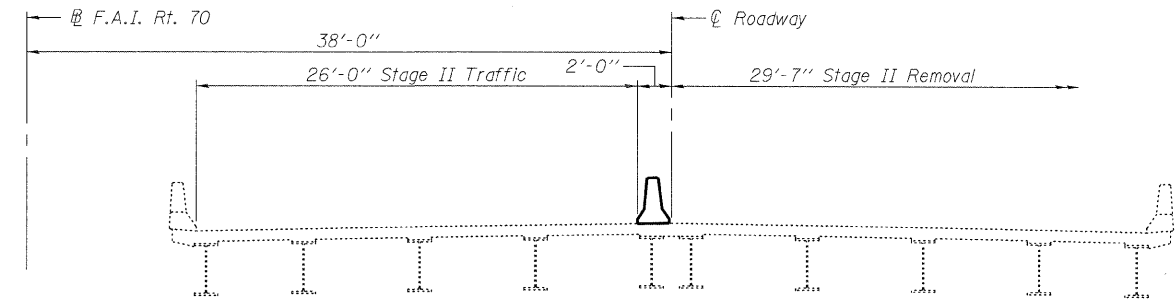

STAGE II REMOVAL

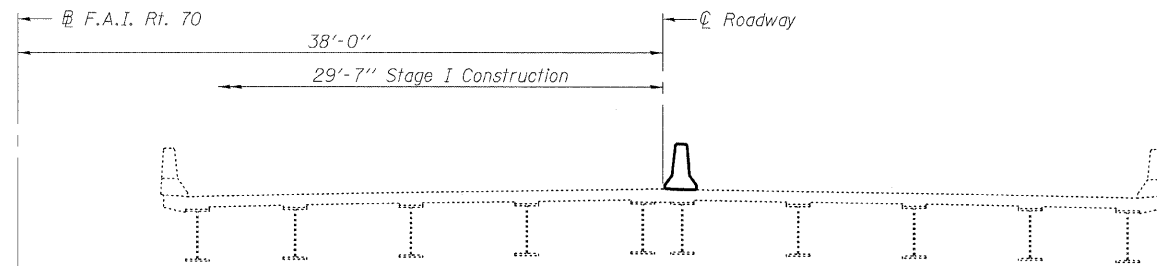

STAGE I CONSTRUCTION

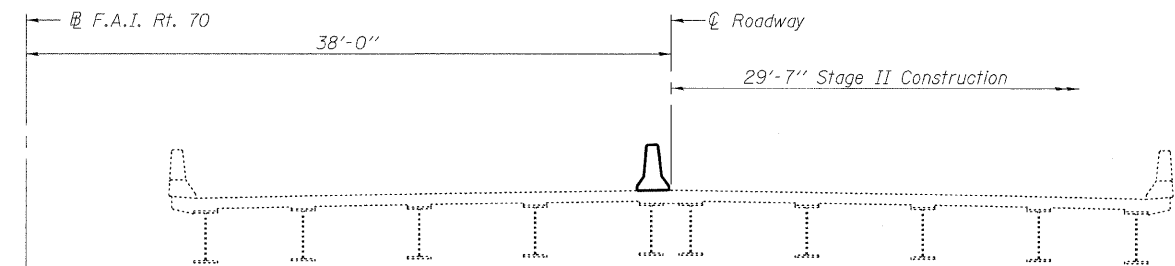

STAGE II CONSTRUCTION

Notes:  
All sections are looking east for E.B. Roadway and west for W.B. Roadway.  
For quantity of Temporary Concrete Barrier, see roadway plans.  
Stage removal and construction shown in sections is limited to expansion joint replacement, bearing replacement, and Pier 1 modifications.

DESIGNED	KLH
CHECKED	EML
DRAWN	KLH
CHECKED	EML

STAGE CONSTRUCTION DETAILS  
STRUCTURE NO. 060-0010 (E.B.)  
STRUCTURE NO. 060-0011 (W.B.)

**HORNER & SHIFRIN, INC.**  
ENGINEERS

SHEET NO. 3 7 SHEETS	F.A.I. RTE.	SECTION	COUNTY	TOTAL SHEETS	SHEET NO.
	70	60-(5,6,7)RS, 60-(6,7)BR	MADISON	185	92
FED. ROAD DIST. NO.			ILLINOIS FED. AID PROJECT		
			CONTRACT NO. 76C56		