







-  PAVEMENT REMOVAL
-  STRUCTURE REMOVAL
-  HOT-MIX ASPHALT BASE COURSE WIDENING, 10"

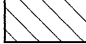
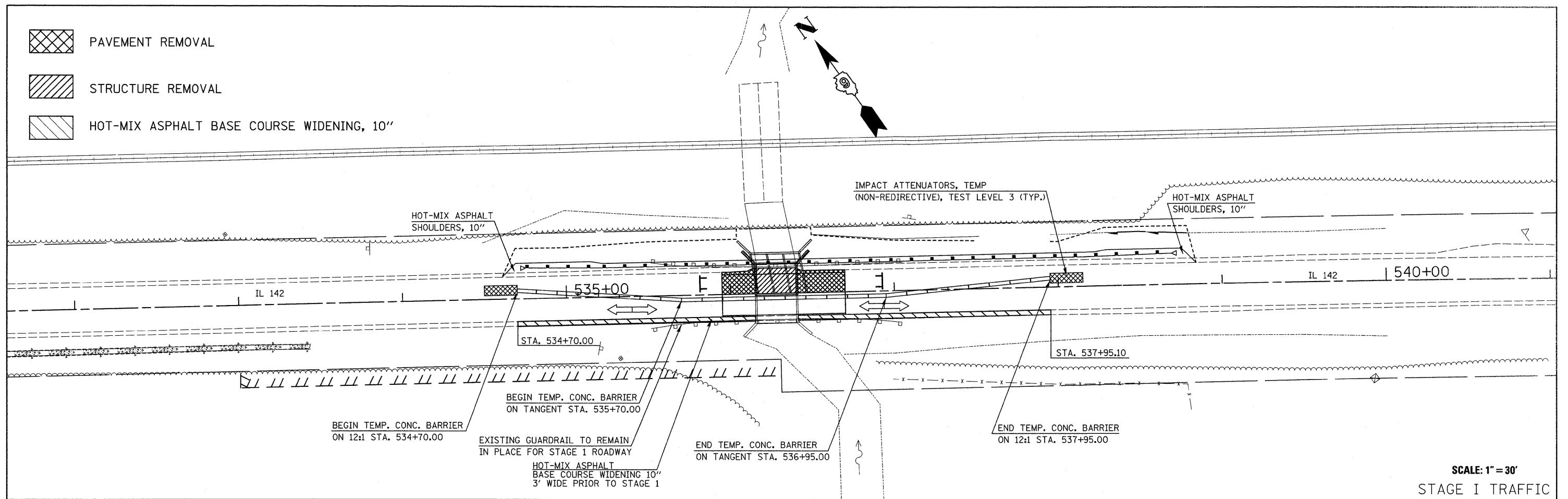

-  PAVEMENT REMOVAL
-  STRUCTURE REMOVAL
-  PAVED SHOULDER REMOVAL

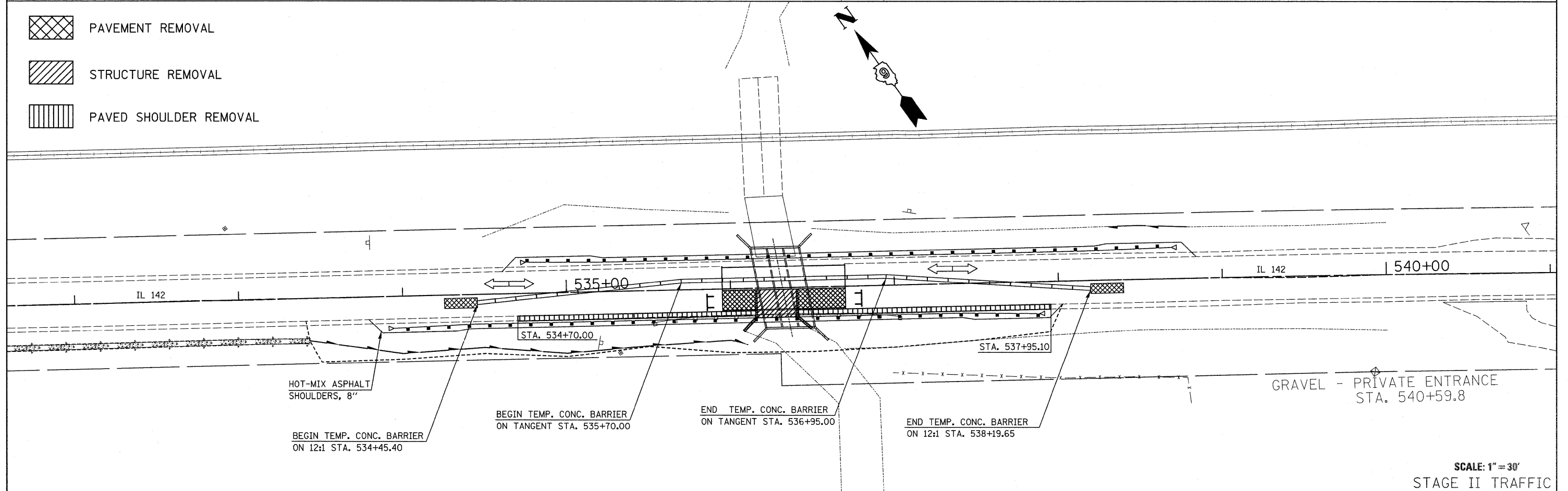

FILE NAME =	USER NAME = #USER#	DESIGNED -	REVISED -	STATE OF ILLINOIS DEPARTMENT OF TRANSPORTATION	STAGING PLAN IL 142 OVER UNNAMED STREAM			F.A. RTE. 849	SECTION 113B-1	COUNTY JEFFERSON	TOTAL SHEETS 24	SHEET NO. 10
#FILEL#		DRAWN -	REVISED -		SCALE: SHEET NO. OF SHEETS STA. TO STA.			FED. ROAD DIST. NO. ILLINOIS FED. AID PROJECT				
		CHECKED -	REVISED -		CONTRACT NO. 78085							
		DATE -	REVISED -									