

TRAFFIC SIGNAL LEGEND

| | PROPOSED | EXISTING |
|--|----------|----------|
| CONTROLLER | | |
| SERVICE INSTALLATION | | |
| SIGNAL HEAD | | |
| SIGNAL HEAD WITH BACKPLATE | | |
| SIGNAL HEAD PEDESTRIAN | | |
| SIGNAL POST | | |
| MAST ARM ASSEMBLY AND POLE, STEEL | | |
| MAST ARM ASSEMBLY AND POLE, ALUMINUM | | |
| COMBINATION MAST ARM ASSEMBLY AND POLE, STEEL WITH LUMINAIRE | | |
| UNIT DUCT | UD | |
| COMMON TRENCH | CT | |
| HANDHOLE | | |
| HEAVY DUTY HANDHOLE | | |
| DOUBLE HANDHOLE | | |
| G. S. CONDUIT IN TRENCH (T) OR PUSHED (P) | | |
| PEDESTRIAN PUSHBUTTON DETECTOR | | |
| DETECTOR LOOP | | |
| CAST IRON JUNCTION BOX | | |
| EMERGENCY VEHICLE LIGHT DETECTOR | | |
| CONFIRMATION BEACON | | |
| SIGNAL HEAD OPTICALLY PROGRAMMED | | |
| CONDUIT SPLICE | | |
| WOOD POLE | | |
| RACEWAY FOR MAGNETIC DETECTOR, TYPE I OR TYPE II | | |
| VEHICLE DETECTOR, NON COMPENSATED MAGNETIC TYPE | | |
| RAILROAD CONTROL CABINET | | |
| TELEPHONE CONNECTION | | |
| ILLUMINATED SIGN "NO LEFT TURN" | | |
| ILLUMINATED SIGN "NO RIGHT TURN" | | |
| UNINTERRUPTIBLE POWER SUPPLY | UPS | |

RESTORATION OF WORK AREA
 RESTORATION OF THE TRAFFIC SIGNAL WORK AREA SHALL BE INCIDENTAL TO THE RELATED PAY ITEM SUCH AS FOUNDATION, CONDUIT, HANDHOLE, TRENCH AND BACKFILL, ETC., AND NO EXTRA COMPENSATION SHALL BE ALLOWED. ALL ROADWAY SURFACES SUCH AS SHOULDERS, MEDIANS, SIDEWALKS, PAVEMENT, ETC., SHALL BE REPLACED IN KIND. ALL DAMAGE TO MOWED LAWNS SHALL BE REPLACED WITH AN APPROVED SOD AND ALL DAMAGE TO UNMOWED FIELDS SHALL BE SEEDED, IN ACCORDANCE WITH STANDARD SPECIFICATIONS 250 AND 252 RESPECTIVELY.

NOTE:
 THE TRAFFIC SIGNAL CONTROLLER EQUIPMENT FOR THIS PROJECT SHALL BE "ECONOLITE" TO MATCH THE EXISTING ADJACENT SYSTEM.

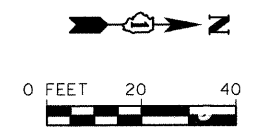
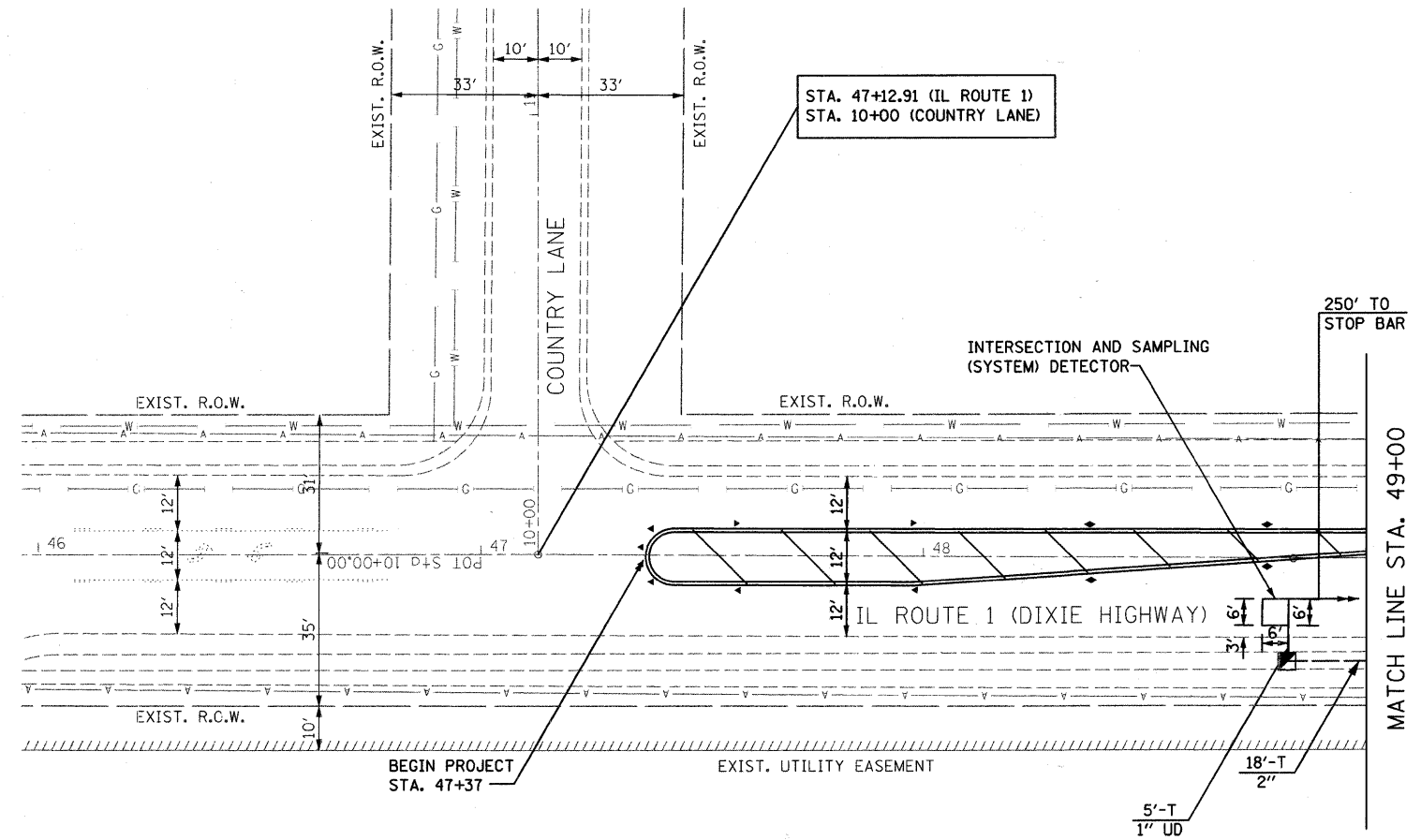

FILE NAME = s:\proj\65900-65901\65901\003\microsta\signals\plan.dgn

| | | | | | | | | | | | | | |
|--|---|---------------------|------------|-----------|---|---|---------------------|--------------|---------------------|---------------------------|----------------|--------------------|----------------|
| | 1170 SOUTH HOUBOLT ROAD JOLIET, ILLINOIS 60431 (815) 744-4200 | USER NAME = kindras | DESIGNED - | REVISED - | STATE OF ILLINOIS DEPARTMENT OF TRANSPORTATION | PROPOSED TRAFFIC SIGNAL INSTALLATION PLAN IL ROUTE 1 (DIXIE HIGHWAY) AND CHESTNUT LANE | | | F.A.U. RTE. 0332 | SECTION 06-00015-00-TL | COUNTY WILL | TOTAL SHEETS 31 | SHEET NO. 6 |
| | PLOT SCALE = 20,0000' / IN. | | CHECKED - | REVISED - | | | | | CONTRACT NO. 83909 | | | | |
| | PLOT DATE = 10/16/2009 | | DATE - | REVISED - | | SCALE: AS SHOWN | SHEET NO. OF SHEETS | STA. TO STA. | FED. ROAD DIST. NO. | ILLINOIS FED. AID PROJECT | | | |
| | | | | | | | | | | | | | |