

SCHEDULE OF QUANTITIES

PAY ITEM	UNIT	QUANTITY
PORTLAND CEMENT CONCRETE SIDEWALK 5 INCH	SQ FT	526
DETECTABLE WARNINGS	SQ FT	48
COMBINATION CURB AND GUTTER REMOVAL	FOOT	120
SIDEWALK REMOVAL	SQ FT	140
COMBINATION CONCRETE CURB AND GUTTER REMOVAL AND REPLACEMENT	FOOT	97
COMBINATION CONCRETE CURB AND GUTTER, TYPE B-6.24	FOOT	48
TRAFFIC CONTROL AND PROTECTION, STANDARD 701501	L SUM	0.25
TRAFFIC CONTROL AND PROTECTION, STANDARD 701502	L SUM	0.25
TRAFFIC CONTROL AND PROTECTION, STANDARD 701701	L SUM	0.25
TRAFFIC CONTROL AND PROTECTION, STANDARD 701801	L SUM	0.25
SIGN PANEL - TYPE 1	SQ FT	18
SIGN PANEL - TYPE 2	SQ FT	25
CONDUIT IN TRENCH, 2" DIA., GALVANIZED STEEL	FOOT	871
CONDUIT IN TRENCH, 2 1/2" DIA., GALVANIZED STEEL	FOOT	50
CONDUIT IN TRENCH, 3" DIA., GALVANIZED STEEL	FOOT	24
CONDUIT IN TRENCH, 5" DIA., GALVANIZED STEEL	FOOT	8
CONDUIT PUSHED, 2" DIA., GALVANIZED STEEL	FOOT	42
CONDUIT PUSHED, 2 1/2" DIA., GALVANIZED STEEL	FOOT	59
CONDUIT PUSHED, 4" DIA., GALVANIZED STEEL	FOOT	324
HANDHOLE	EACH	4
HEAVY-DUTY HANDHOLE	EACH	3
DOUBLE HANDHOLE	EACH	2
TRENCH AND BACKFILL FOR ELECTRICAL WORK	FOOT	953
FULL-ACTUATED CONTROLLER AND TYPE V CABINET, SPECIAL	EACH	1
TRANSCIEIVER - FIBER OPTIC	EACH	1
ELECTRIC CABLE IN CONDUIT, SIGNAL NO. 14 2C	FOOT	670
ELECTRIC CABLE IN CONDUIT, SIGNAL NO. 14 3C	FOOT	1,241
ELECTRIC CABLE IN CONDUIT, SIGNAL NO. 14 5C	FOOT	1,243
ELECTRIC CABLE IN CONDUIT, SIGNAL NO. 14 7C	FOOT	926
ELECTRIC CABLE IN CONDUIT, LEAD-IN, NO. 14 1 PAIR	FOOT	1,660
ELECTRIC CABLE IN CONDUIT, SERVICE, NO. 6 2C	FOOT	215
TRAFFIC SIGNAL POST, GALVANIZED STEEL 16 FT.	EACH	1
STEEL MAST ARM ASSEMBLY AND POLE, 22 FT.	EACH	1
STEEL MAST ARM ASSEMBLY AND POLE, 30 FT.	EACH	1
STEEL MAST ARM ASSEMBLY AND POLE, 34 FT.	EACH	1
STEEL MAST ARM ASSEMBLY AND POLE, 40 FT.	EACH	1
CONCRETE FOUNDATION, TYPE A	FOOT	4
CONCRETE FOUNDATION, TYPE C	FOOT	4
CONCRETE FOUNDATION, TYPE E 36-INCH DIAMETER	FOOT	60
SIGNAL HEAD, LED, 1-FACE, 3-SECTION, MAST-ARM MOUNTED	EACH	5
SIGNAL HEAD, LED, 1-FACE, 3-SECTION, BRACKET MOUNTED	EACH	1
SIGNAL HEAD, LED, 1-FACE, 5-SECTION, BRACKET MOUNTED	EACH	3
SIGNAL HEAD, LED, 1-FACE, 5-SECTION, MAST-ARM MOUNTED	EACH	3
PEDESTRIAN SIGNAL HEAD, LED, 1-FACE, BRACKET MOUNTED WITH COUNTDOWN TIMER	EACH	2
PEDESTRIAN SIGNAL HEAD, LED, 2-FACE, BRACKET MOUNTED WITH COUNTDOWN TIMER	EACH	3
TRAFFIC SIGNAL BACKPLATE, LOUVERED, ALUMINUM	EACH	8
INDUCTIVE LOOP DETECTOR	EACH	8
DETECTOR LOOP, TYPE I	FOOT	795
PEDESTRIAN PUSH-BUTTON	EACH	5
SERVICE INSTALLATION - GROUND MOUNTED	EACH	1
UNINTERRUPTIBLE POWER SUPPLY	EACH	1
ELECTRIC CABLE IN CONDUIT, GROUNDING, NO. 6 1C	FOOT	760
SIDEWALK REMOVAL AND REPLACEMENT	SQ FT	170

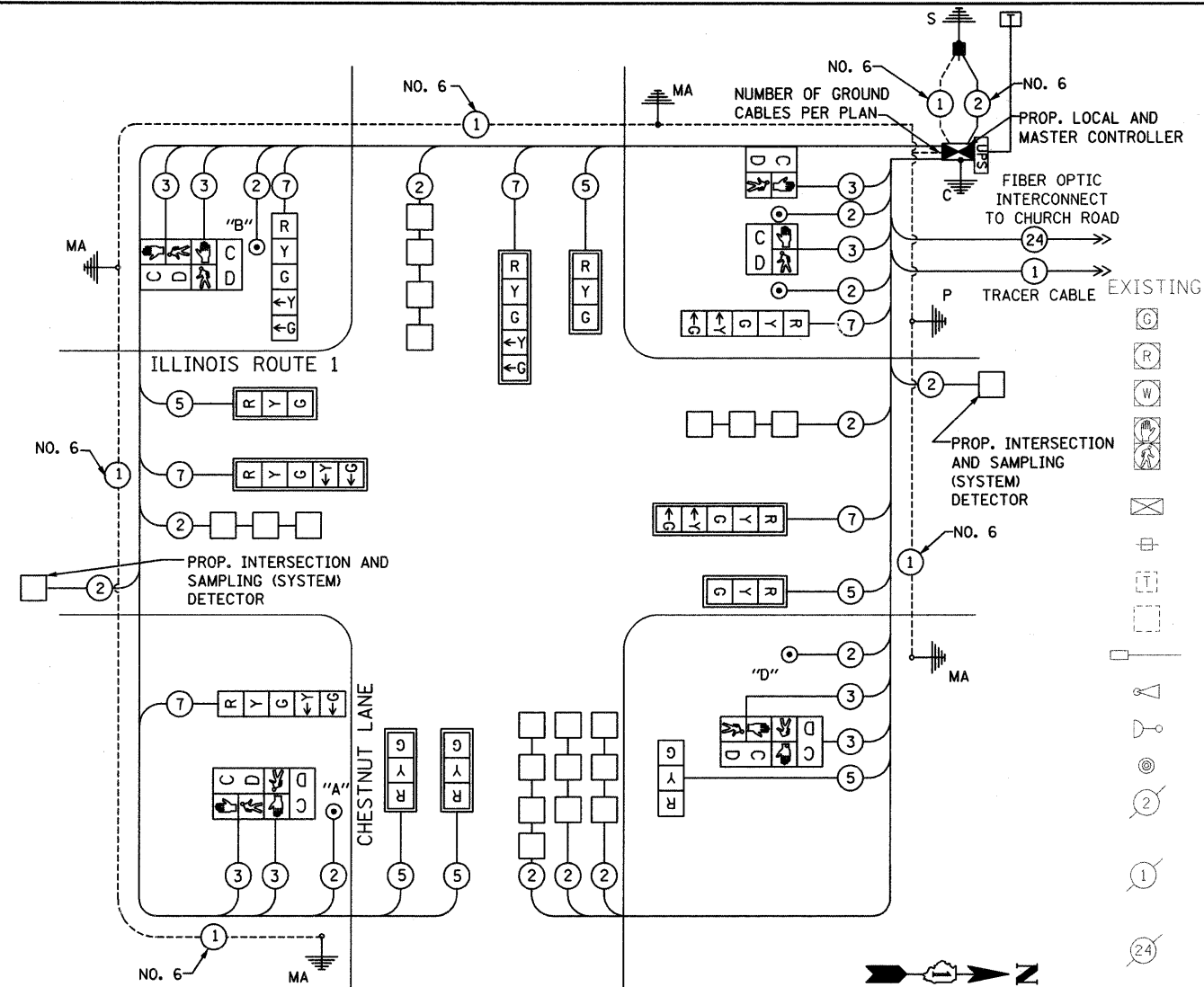

THE END OF THE TRACER CABLE SHALL BE CONTINUOUS AND EXTEND INTO THE CONTROLLER CABINET

CABLE PLAN LEGEND

- EXISTING PROPOSED
- 3" (200mm) TRAFFIC SIGNAL SECTION
  - 12" (300mm) TRAFFIC SIGNAL SECTION
  - 12" (300mm) PEDESTRIAN SIGNAL SECTION (LETTERS)
  - 12" (300mm) PEDESTRIAN SIGNAL SECTION (SYMBOLS)
  - CONTROLLER CABINET
  - SERVICE INSTALLATION
  - TELEPHONE INSTALLATION
  - VEHICLE DETECTOR, INDUCTION LOOP
  - MAGNETIC DETECTOR
  - EMERGENCY VEHICLE LIGHT DETECTOR
  - CONFIRMATION BEACON
  - PUSHBUTTON DETECTOR
  - DENOTES NUMBER OF CONDUCTORS. ALL CABLE NO. 14 EXCEPT AS INDICATED. ALL LOOP DETECTOR CABLE TO BE SHIELDED.
  - GROUND CABLE IN CONDUIT NO. 6 SOLID COPPER (GREEN)
  - FIBER OPTIC CABLE IN CONDUIT NO. 62.5/125 2-MM12F SM12F
  - SIGNAL FACE WITH BACKPLATE. "P" INDICATES PROGRAMMED HEAD.
  - RAILROAD CONTROL CABINET
  - ILLUMINATED SIGN, "NO LEFT TURN"
  - ILLUMINATED SIGN, "NO RIGHT TURN"
  - GROUND CABLE ROD AT HANDHOLE (H), DOUBLE HANDHOLE (H), OR CONTROLLER (C)
  - GROUND ROD AT POST (P) OR MAST ARM POLE (MA)
  - GROUND ROD AT ELECTRIC SERVICE INSTALLATION
  - UNINTERRUPTIBLE POWER SUPPLY

CONTROLLER SEQUENCE

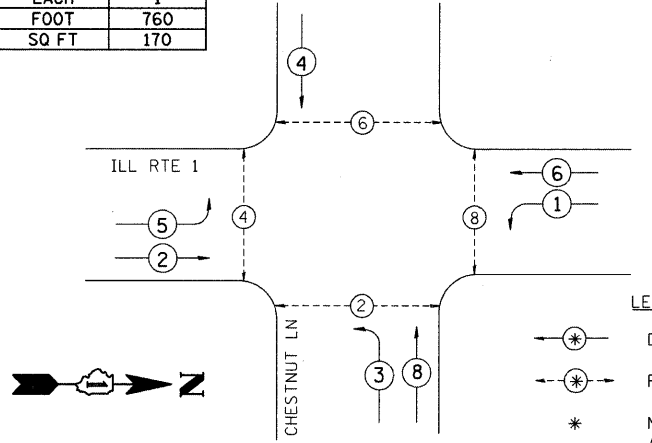

- LEGEND
- DUAL ENTRY PHASE
  - PEDESTRIAN PHASE
  - \* NUMBER REFERS TO ASSOCIATED PHASE

PHASE DESIGNATION DIAGRAM

I.D.O.T. TRAFFIC SIGNAL INSTALLATION ELECTRICAL SERVICE REQUIREMENTS

TYPE	NO. LAMPS	WATTAGE		%OPERATION	TOTAL WATTAGE
		INCAND.	LED		
SIGNAL (RED)	12		17	0.50	102
(YELLOW)	12		25	0.25	75
(GREEN)	12		15	0.25	45
ARROW	12		12	0.10	14.4
PED. SIGNAL	8		25	1.00	200
CONTROLLER	1		100	1.00	100
ILLUM. SIGN				0.05	0

ENERGY COSTS TO:

FLASHER	ENERGY COSTS TO:	TOTAL =
1	0.50	536.4

VILLAGE OF BEECHER  
724 PENFIELD DRIVE, P.O. BOX 1154  
BEECHER, ILLINOIS 60401

ENERGY SUPPLY CONTACT: TONY ESCALANTE  
PHONE: 708-878-9908  
COMPANY: COMMONWEALTH EDISON

FOUNDATION (DEPTH)	FT. (m)	CABLE SLACK	FT. (m)	VERTICAL	FT. (m)
TYPE A - POST	4 (1.2)	HANDHOLE	6.5 (2.0)	ALL FOUNDATIONS	3.5 (1.0)
C - CONTROLLER	4 (1.2)	DOUBLE HANDHOLE	13 (4.0)	MAST ARM (L) POLE	20'+L-2=
E - M. ARM POLE		SIGNAL POST	2 (1.0)		(6m+L-0.6m)
		24" (600 mm)	10 (3.0)	CONTROLLER CAB.	1 (0.5)
		30" (750 mm)	15 (4.6)	FIBER OPTIC	13 (4.0)
		36" (900 mm)	15 (4.6)	ELECTRIC SERVICE	1 (0.5)
				GROUND CABLE	1 (0.5)
				POST MOUNTED	6 (1.8)

NOTE: THE TRAFFIC SIGNAL CONTROLLER EQUIPMENT FOR THIS PROJECT SHALL BE "ECONOLITE" TO MATCH THE EXISTING ADJACENT SYSTEM.

PUSH-BUTTON NOTES  
PUSH-BUTTON "A" SHALL PLACE A CALL IN PHASES 2 AND 4  
PUSH-BUTTON "B" SHALL PLACE A CALL IN PHASES 4 AND 6  
PUSH-BUTTON "D" SHALL PLACE A CALL IN PHASES 2 AND 8



USER NAME = admin	DESIGNED -	REVISED -
PLOT SCALE = 20.0000' / IN.	DRAWN -	REVISED -
PLOT DATE = 10/27/2009	CHECKED -	REVISED -
	DATE -	REVISED -

STATE OF ILLINOIS  
DEPARTMENT OF TRANSPORTATION

SCHEDULE OF QUANTITIES, CABLE PLAN, PHASE DESIGNATION DIAGRAM  
IL ROUTE 1 (DIXIE HIGHWAY) AND CHESTNUT LANE  
SCALE: AS SHOWN SHEET NO. OF SHEETS STA. TO STA.

F.A. RTE.	SECTION	COUNTY	TOTAL SHEETS	SHEET NO.
0332	06-00015-00-TL	WILL	31	9

CONTRACT NO. 83909  
FED. ROAD DIST. NO. ILLINOIS FED. AID PROJECT