

STA 51+38 AND 52+05. SEE SCHEDULE OF QUANTITIES.
 REMOVE AND REPLACE SIDEWALK AS INDICATED,
 REMOVE EXISTING CURB AND GUTTER, PLACE
 PROPOSED CURB AND GUTTER AND CURB RAMP,
 PLACE DETECTABLE WARNINGS

STA 51+60 AND 52+19. SEE SCHEDULE OF QUANTITIES.
 REMOVE AND REPLACE SIDEWALK AS INDICATED,
 REMOVE EXISTING CURB AND GUTTER, PLACE
 PROPOSED CURB AND GUTTER AND CURB RAMP,
 PLACE DETECTABLE WARNINGS

INDICATES LIMIT OF HOT MIX
 ASPHALT SURFACE REMOVAL - 1 1/4".
 REMOVE FULL WIDTH OF 12TH AVENUE AND
 AT INTERSECTING STREETS AS SHOWN.

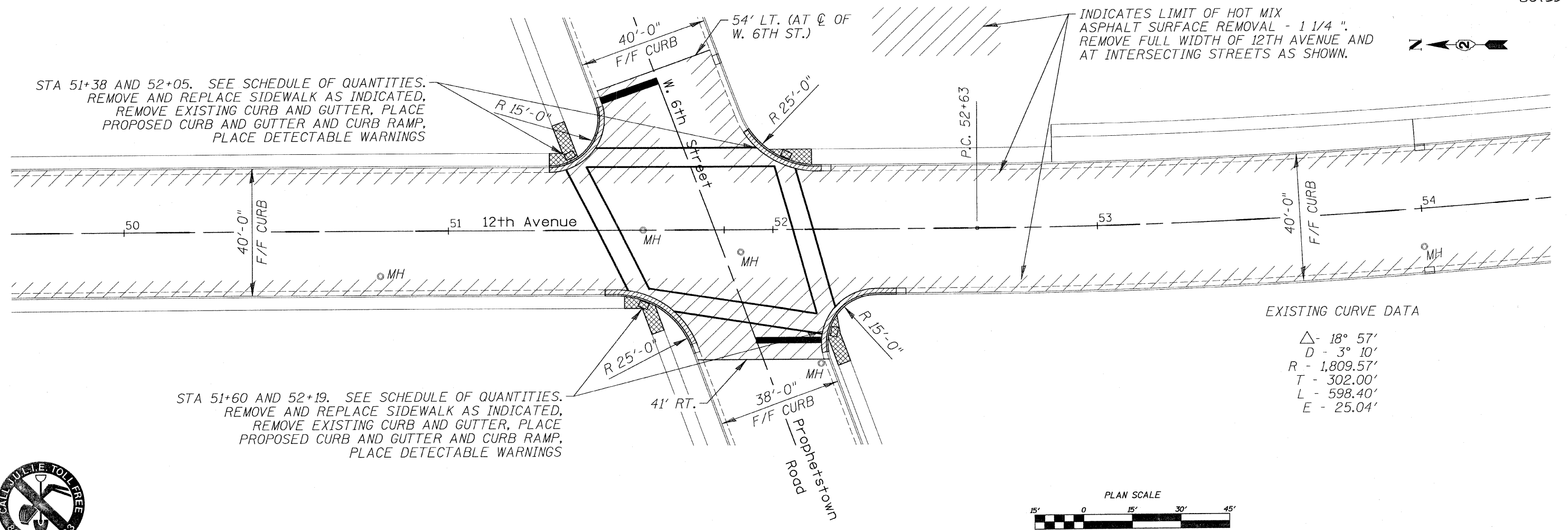

EXISTING CURVE DATA

- Δ - 18° 57'
- D - 3° 10'
- R - 1,809.57'
- T - 302.00'
- L - 598.40'
- E - 25.04'

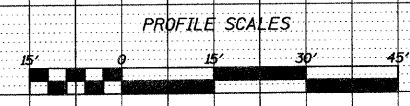
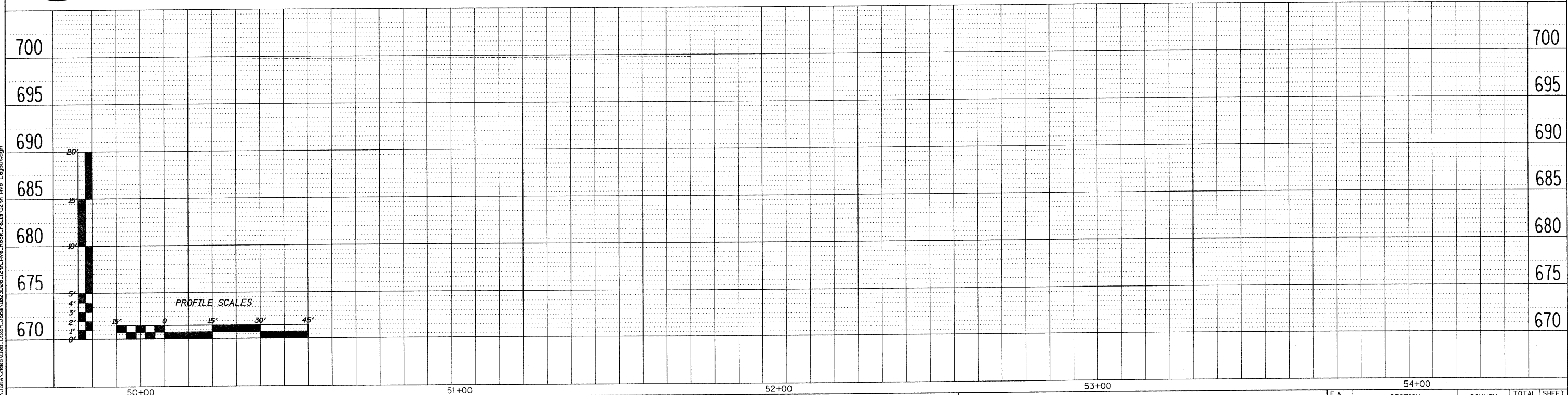
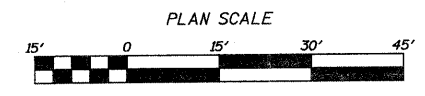

FILE NAME = L:\Jobs\2008\086_Dixon\Jobs\0223008_12th_Ave_Rock_Falls\12th_Ave_Layout.dgn

WILLETT, HOFMANN & ASSOCIATES, INC.
 CONSULTING ENGINEERS
 809 East Second Street Dixon, IL 61021
 Phone 815.284.3381 Fax 815.284.3385
 Design Firm #194-00078
 www.willetthofmann.com

DESIGNED - BDF	REVISED -
DRAWN - JDH	REVISED -
CHECKED - BDF	REVISED -
DATE -	REVISED -

CITY OF ROCK FALLS, ILLINOIS
12th AVE. - ROCK RIVER BRIDGE to W. 10th ST.

12TH AVENUE PLAN & PROFILE

F.A. RTE.	SECTION	COUNTY	TOTAL SHEETS	SHEET NO.
	09-00130-00-RS	WHITESIDE	21	10
FED. ROAD DIST. NO.			ILLINOIS FED. AID PROJECT	
			CONTRACT NO. 85499	