

**INDEX OF SHEETS**

1	COVER SHEET
2	SUMMARY OF QUANTITIES AND GENERAL NOTES
3	TYPICAL SECTIONS AND PAVEMENT DESIGN
4-5	SCHEDULE OF QUANTITIES
6-13	12TH AVENUE PLAN AND PROFILE
14-16	12TH AVENUE PAVEMENT MARKINGS
17	CATCH BASINS OR INLETS TO BE ADJUSTED OR RECONSTRUCTED (DS 17.4a)
18-20	TYPICAL PAVEMENT MARKINGS (DS 41.1)
21	ROUGH GROOVED SURFACE SIGN (DS 91.2)

**STATE OF ILLINOIS  
DEPARTMENT OF TRANSPORTATION  
PLANS FOR  
PROPOSED LOCAL AGENCY IMPROVEMENT  
FEDERAL AID URBAN PROJECT**

**F.A.U. ROUTE 5571 (12th AVENUE)  
CITY OF ROCK FALLS  
SECTION 09-00130-00-RS  
PROJECT NO. ARA-5062(027)  
JOB NO. C-92-165-09  
CONTRACT NO. 85499  
2010**

**STATE LOCATION MAP**

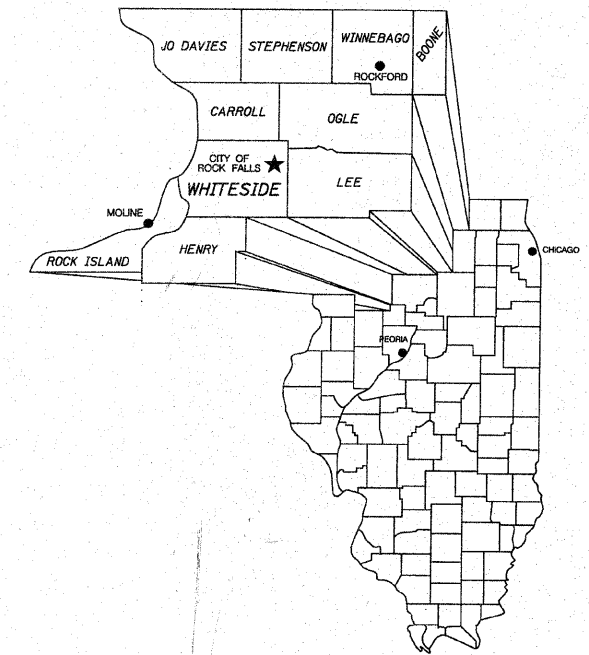

**STANDARDS**

424001-05	CURB RAMPS FOR SIDEWALKS
606001-04	CONCRETE CURB TYPE B AND COMBINATION CONCRETE CURB AND GUTTER
701006-03	OFF-ROAD OPERATIONS, 2-LANE, 2-WAY, 15' TO 24" FROM PAVEMENT EDGE
701301-03	LANE CLOSURE, 2-LANE, 2-WAY, SHORT TIME OPERATIONS
701311-03	LANE CLOSURE, 2-LANE, 2-WAY, MOVING OPERATIONS - DAY ONLY
701501-05	URBAN LANE CLOSURE, 2-LANE, 2-WAY, UNDIVIDED
701701-06	URBAN LANE CLOSURE, MULTILANE INTERSECTION
701901-01	TRAFFIC CONTROL DEVICES
720011-01	METAL POSTS FOR SIGNS, MARKERS AND DELINEATORS
728001-01	TELESCOPING STEEL SIGN SUPPORT
729001-01	APPLICATIONS OF TYPES A AND B METAL POSTS (FOR SIGNS & MARKERS)

**SCALES:**

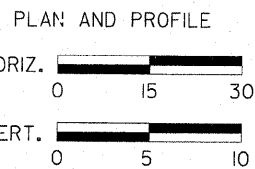

NET LENGTH = 2,955 FEET = 0.56 MILES

**UTILITIES**

NAME AND ADDRESS OF UTILITIES	TYPE
AT&T ATTN: DIANE ADAMS 1908 PROPHET ROAD ROCK FALLS, IL 61071 (815) 625-9958	TELEPHONE
NICOR GAS COMPANY ATTN: CONNIE LANE 1844 FERRY LANE NAPERVILLE, IL 60563 (630) 388-2362	GAS
ROCK FALLS ELECTRIC DEP'T. 1109 INDUSTRIAL PARK ROAD ROCK FALLS, IL. 61071 (815) 622-1145	ELECTRIC
COMCAST COMMUNICATIONS P.O. BOX 580 1304 WEST ROUTE 30 ROCK FALLS, IL. 61071 (888) 736-6608	CABLE TV
CITY OF ROCK FALLS 603 W. 10TH STREET ROCK FALLS, IL. 61071 (815) 622-1100	SANITARY & STORM SEWER, WATER DEP'T



SECTION 09-00130-00-RS  
12TH AVENUE  
BEGINS AT STA. 34+55

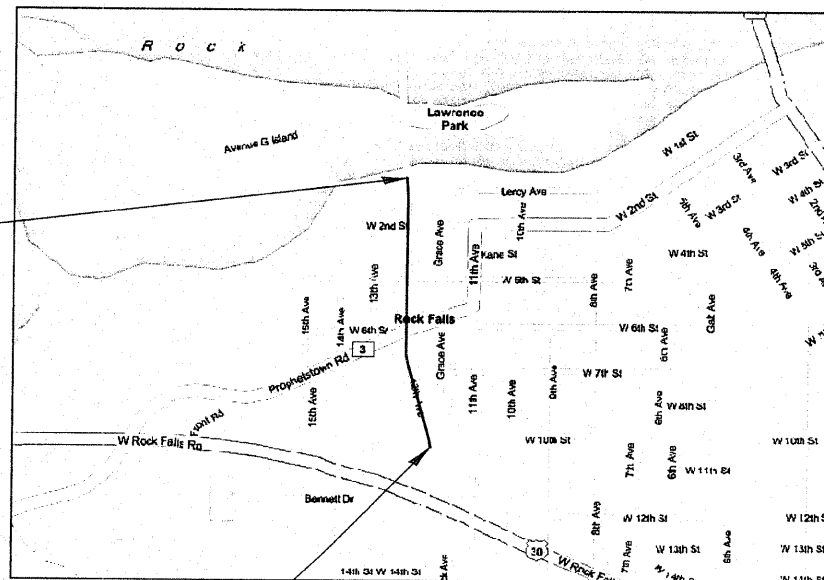

SECTION 09-00130-00-RS  
12TH AVENUE  
ENDS AT STA. 64+10

**LOCATION MAP**



CITY OF ROCK FALLS	
APPROVED	<u>11-16-09</u> DATE
	 MAYOR
PASSED	<u>Nov. 19, 2009</u> DATE
	 DISTRICT 2 ENGINEER OF LOCAL ROADS & STREETS
RELEASING FOR BID BASED ON LIMITED REVIEW	<u>Nov. 19, 2009</u> DATE
	 DEPUTY DIRECTOR OF HIGHWAYS, REGION 2 ENGINEER

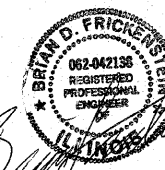

DATE: 11/17/2009  
EXPIRES 11/30/2011

**ADT = 9,200  
2.0 % TRUCKS  
MINOR ARTERIAL  
LAPP POLICY**

PLANS PREPARED BY:

**WILLET, HOFMANN & ASSOCIATES, INC.**  
CONSULTING ENGINEERS

Land Surveying - Transportation - Structural  
Environmental - Architecture

809 East Second Street Dixon, Illinois 61021  
Phone 815.284.3381 Fax 815.284.3385  
Design Firm #184-000918  
www.willett-hofmann.com

WHA #1023D08

# SUMMARY OF QUANTITIES

CONSTRUCTION TYPE CODE: I000

## GENERAL NOTES

CODE NO.	ITEM	UNIT	TOTAL
* 1	31100900 SUB-BASE GRANULAR MATERIAL, TYPE A, 10"	SQ YD	311
* 2	40600100 BITUMINOUS MATERIALS (PRIME COAT)	GAL	1,406
3	40600300 AGGREGATE (PRIME COAT)	TON	25
* 4	40600525 LEVELING BINDER (HAND METHOD), N50	TON	50
5	40600625 LEVELING BINDER (MACHINE METHOD), N50	TON	667
6	40600990 TEMPORARY RAMP	SQ YD	159
7	40603335 HOT-MIX ASPHALT SURFACE COURSE, MIX "D", N50	TON	1,551
8	42400200 PORTLAND CEMENT CONCRETE SIDEWALK, 5 INCH	SQ FT	773
9	42400800 DETECTABLE WARNINGS	SQ FT	102
* 10	44000154 HOT-MIX ASPHALT SURFACE REMOVAL, 1 1/4"	SQ YD	14,008
11	44000500 COMBINATION CURB AND GUTTER REMOVAL	FOOT	304
12	44000600 SIDEWALK REMOVAL	SQ FT	773
* 13	44212899 PAVEMENT PATCHING (FULL DEPTH)	SQ YD	311
* 14	44300300 AREA REFLECTIVE CRACK CONTROL TREATMENT, SYSTEM A	SQ YD	12,460
* 15	56109210 WATER VALVES TO BE ADJUSTED	EACH	4
* 16	60255500 MANHOLES TO BE ADJUSTED	EACH	27
* 17	60260100 INLETS TO BE ADJUSTED	EACH	29
* 18	60300105 FRAMES AND GRATES TO BE ADJUSTED	EACH	2
* 19	60610400 COMBINATION CONCRETE CURB AND GUTTER, TYPE M-6.24	FOOT	304
20	67100100 MOBILIZATION	L SUM	1
* 21	70101700 TRAFFIC CONTROL AND PROTECTION	L SUM	1
22	70300100 SHORT-TERM PAVEMENT MARKING	FOOT	1,041
23	70301000 WORK ZONE PAVEMENT MARKING REMOVAL	SQ FT	344
Δ 24	78000100 THERMOPLASTIC PAVEMENT MARKING - LETTERS AND SYMBOLS	SQ FT	94
Δ 25	78000200 THERMOPLASTIC PAVEMENT MARKING - LINE 4"	FOOT	1,406
Δ 26	78000400 THERMOPLASTIC PAVEMENT MARKING - LINE 6"	FOOT	1,423
Δ 27	78000650 THERMOPLASTIC PAVEMENT MARKING - LINE 24"	FOOT	153
* 28	81400115 HANDHOLE TO BE ADJUSTED	EACH	1

ALL BORROW/WASTE/USE SITES MUST BE APPROVED BY THE DEPARTMENT PRIOR TO REMOVING ANY MATERIAL FROM THE PROJECT OR INITIATING ANY EARTHMOVING ACTIVITIES, INCLUDING TEMPORARY STOCKPILING OUTSIDE THE LIMITS OF CONSTRUCTION.

MILLING MACHINES ON THIS PROJECT SHALL BE CAPABLE OF REMOVING A LAYER OF BITUMINOUS MATERIAL A MINIMUM OF 6' WIDE AND 1 1/4" INCHES IN DEPTH IN A SINGLE PASS. THE MAXIMUM DROP-OFF HEIGHT BETWEEN TRAVELED LANES SHALL BE EQUAL TO OR LESS THAN 1 1/4".

THE CONTRACTOR SHALL PLACE TEMPORARY HOT-MIX ASPHALT TAPERS ALONG ALL SIDES OF THE UTILITY STRUCTURES PROTRUDING ABOVE THE MILLED SURFACE. THE TEMPORARY TAPERS SHALL EXTEND 2' OUTSIDE OF THE CASTINGS, EXCEPT FOR THE APPROACH SIDE TO TRAFFIC, WHICH SHALL HAVE A 4' TAPER. HOT-MIX ASPHALT MEETING THE APPROVAL OF THE ENGINEER SHALL BE USED, AND NO COLD MILLINGS WILL BE ALLOWED. THE COST OF THE MATERIAL, PLACEMENT, MAINTENANCE, REMOVAL, AND DISPOSAL OF SAID WORK WILL BE INCLUDED IN THE PAY ITEM FOR "HOT-MIX ASPHALT SURFACE REMOVAL - 1 1/4".

THE AREA TO BE PRIMED SHALL BE LIMITED TO THAT WHICH CAN BE COVERED WITH HOT-MIX ASPHALT THE SAME DAY, UNLESS OTHERWISE PERMITTED BY THE ENGINEER.

THE CONTRACTOR SHALL BE RESPONSIBLE FOR PROTECTING UTILITY PROPERTY DURING CONSTRUCTION OPERATIONS AS OUTLINED IN ARTICLE 107.31 OF THE STANDARD SPECIFICATIONS. A MINIMUM OF 48 HOURS ADVANCE NOTICE IS REQUIRED FOR NON-EMERGENCY WORK. THE "JULIE" NUMBER IS 800-892-0123. THE UTILITIES LOCATED WITHIN THE PROJECT LIMITS, OR IMMEDIATELY ADJACENT TO THE PROJECT CONSTRUCTION LIMITS, ARE MEMBERS OF "JULIE" AND ARE LISTED ON THE COVER SHEET OF THESE PLANS.

UTILIZATION OF THE PAY ITEMS "LEVELING BINDER (HAND METHOD)", "PAVEMENT PATCHING (FULL DEPTH)", AND "SUB-BASE GRANULAR MATERIAL, TYPE A, 10'" SHALL BE AT THE DISCRETION OF THE RESIDENT ENGINEER. A CONTINGENCY AMOUNT FOR EACH ITEM HAS BEEN PLACED IN THIS CONTRACT.

\* INDICATES SPECIAL PROVISION

Δ SPECIALTY ITEMS



DESIGNED - BDF	REVISED -
DRAWN - BDF	REVISED -
CHECKED - BDF	REVISED -
DATE - 08/17/2009	REVISED -

**CITY OF ROCK FALLS, ILLINOIS**  
**12th AVENUE - ROCK RIVER BRIDGE to W. 10th ST.**

**SUMMARY OF QUANTITIES**  
**GENERAL NOTES**

SCALE:

F.A. RTE.	SECTION	COUNTY	TOTAL SHEETS	SHEET NO.
	09-00130-00-RS	WHITESIDE	21	2
FED. ROAD DIST. NO. - ILLINOIS FED. AID PROJECT			CONTRACT NO. 85499	

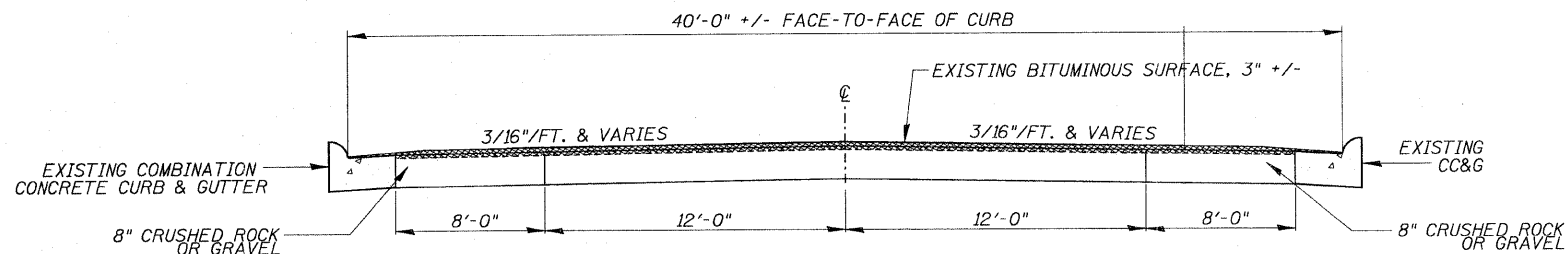

- BITUMINOUS SURFACE REMOVAL, 1 1/4"
- HMA REPLACEMENT-
  - 3/4" HMA LEVELING BINDER, N50
  - AREA REFLECTIVE CRACK CONTROL TREATMENT, SYSTEM A (PLACE ON LEVELING BINDER)
  - 1 3/4" HMA SURFACE COURSE, MIX "D", N50

**TYPICAL SECTION**

STATION 41+30.00 TO STATION 64+10.00

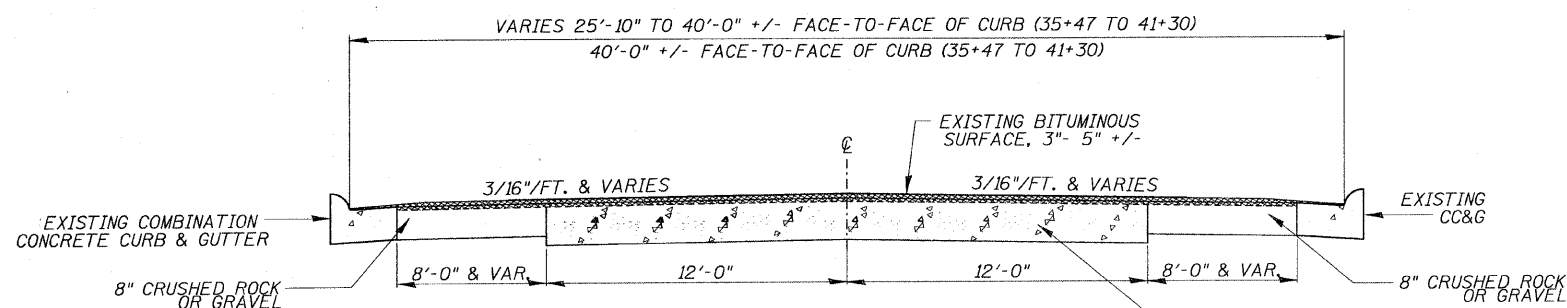

- BITUMINOUS SURFACE REMOVAL, 1 1/4"
- HMA REPLACEMENT-
  - 3/4" HMA LEVELING BINDER, N50
  - AREA REFLECTIVE CRACK CONTROL TREATMENT, SYSTEM A (PLACE ON LEVELING BINDER)
  - 1 3/4" HMA SURFACE COURSE, MIX "D", N50

**TYPICAL SECTION**

STATION 34+55.00 TO STATION 41+30.00

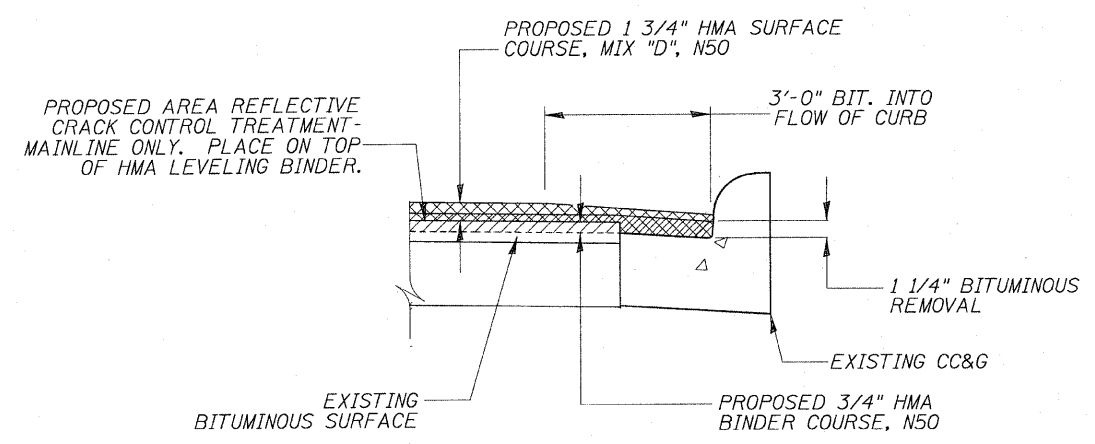

- BITUMINOUS SURFACE REMOVAL, 1 1/4"
- HMA REPLACEMENT-
  - 3/4" HMA LEVELING BINDER, N50
  - AREA REFLECTIVE CRACK CONTROL TREATMENT, SYSTEM A
  - 1 3/4" HMA SURFACE COURSE, MIX "D", N50

**TYPICAL CURB TAPER**

THE FOLLOWING MIXTURE REQUIREMENTS ARE APPLICABLE FOR THIS PROJECT:

MIXTURE USE(S):	SURFACE	LEVEL BINDER
PG:	PG 64-22	PG 64-22
DESIGN AIR VOIDS	4.0 @ N50	4.0 @ N50
MIXTURE COMPOSITION (GRADATION MIXTURE)	IL 9.5 OR 12.5	IL 9.5
FRICTION AGGREGATE	D	N/A
20 YEAR ESAL	0.5	0.5

**WILLET, HOFMANN & ASSOCIATES, INC.**  
 CONSULTING ENGINEERS  
 809 East Second Street Dixon, IL 61021  
 Phone 815.284.3381 Fax 815.284.3385  
 Design Firm # 184-00918  
 www.willetthofmann.com

DESIGNED - BDF	REVISED -
DRAWN - BDF	REVISED -
CHECKED - BDF	REVISED -
DATE - 07/11/2009	REVISED -

**CITY OF ROCK FALLS, ILLINOIS**  
**12th AVENUE – ROCK RIVER BRIDGE to W. 10th ST.**

**TYPICAL SECTIONS PAVEMENT DESIGN**

F.A. RTE.	SECTION	COUNTY	TOTAL SHEETS	SHEET NO.
	09-00130-00-RS	WHITESIDE	21	3
FED. ROAD DIST. NO. ILLINOIS FED. AID PROJECT				

SCALE:

# ROADWAY SCHEDULES

SUB-BASE GRANULAR MATERIAL, TYPE A, 10"		
STATION	SQ YD	REMARKS
DETERMINED BY THE RESIDENT ENGR.	311	
PROJECT TOTAL	311	ESTIMATED AT 20% OF HMA SURFACE REMOVAL AREA
31100900		

BITUMINOUS MATERIALS (PRIME COAT)		
STATION	GAL	REMARKS
12TH AVENUE, MAINLINE		
34+55 TO 35+47	32	MAINLINE WIDTH VARIES
35+47 TO 64+10	1,280	40.0' MAINLINE WIDTH
12TH AVENUE, SIDE ROADS		
LT, W. 2ND STREET	15	48.0' LT OF C
RT, W. 2ND STREET	13	45' RT OF C
LT, W. 5TH STREET	9	36.0' LT OF C
RT, W. 5TH STREET	7	36.0' RT OF C
LT, W. 6TH STREET	17	54.0' LT OF C
RT, W. 6TH STREET	12	41.0' RT OF C
LT, W. 10TH STREET	10	41.0' LT OF C
RT, W. 10TH STREET	11	47.0' RT OF C
PROJECT TOTAL	1,406	
40600100		

LEVELING BINDER (MACHINE METHOD), N50		
STATION	TON	REMARKS
12TH AVENUE, MAINLINE		
34+55 TO 35+47	15	MAINLINE WIDTH VARIES
35+47 TO 64+10	605	40.0' MAINLINE WIDTH
12TH AVENUE, SIDE ROADS		
LT, W. 2ND STREET	8	48.0' LT OF C
RT, W. 2ND STREET	6	45' RT OF C
LT, W. 5TH STREET	5	36.0' LT OF C
RT, W. 5TH STREET	3	36.0' RT OF C
LT, W. 6TH STREET	8	54.0' LT OF C
RT, W. 6TH STREET	6	41.0' RT OF C
LT, W. 10TH STREET	5	41.0' LT OF C
RT, W. 10TH STREET	6	47.0' RT OF C
PROJECT TOTAL	667	
40600625		

TEMPORARY RAMP		
STATION	SQ YD	REMARKS
12TH AVENUE		
34+55	12	FULL WIDTH MAINLINE (4' LONG)
RT, 40+63	18	W. 2ND STREET (4' LONG)
LT, 40+67	19	W. 2ND STREET (4' LONG)
RT, 46+46	13	W. 5TH STREET (4' LONG)
LT, 46+56	18	W. 5TH STREET (4' LONG)
RT, 51+82	17	W. 6TH STREET (4' LONG)
LT, 51+82	18	W. 6TH STREET (4' LONG)
RT, 63+42	13	W. 10TH STREET (4' LONG)
LT, 63+44	13	W. 10TH STREET (4' LONG)
64+10	18	FULL WIDTH MAINLINE (4' LONG)
PROJECT TOTAL	159	
40600990		

HOT-MIX ASPHALT SURFACE COURSE, MIX "D", N50		
STATION	TON	REMARKS
12TH AVENUE, MAINLINE		
34+55 TO 35+47	35	MAINLINE WIDTH VARIES
35+47 TO 64+10	1,411	40.0' MAINLINE WIDTH
12TH AVENUE, SIDE ROADS		
LT, W. 2ND STREET	17	48.0' LT OF C
RT, W. 2ND STREET	14	45' RT OF C
LT, W. 5TH STREET	10	36.0' LT OF C
RT, W. 5TH STREET	7	36.0' RT OF C
LT, W. 6TH STREET	19	54.0' LT OF C
RT, W. 6TH STREET	13	41.0' RT OF C
LT, W. 10TH STREET	12	41.0' LT OF C
RT, W. 10TH STREET	13	47.0' RT OF C
PROJECT TOTAL	1,551	
40603335		

PORTLAND CEMENT CONCRETE SIDEWALK 5 INCH		
STATION	SQ FT	REMARKS
12TH AVENUE		
LT, 40+32	75	CURB RAMP, N. SIDE, 2ND ST.
LT, 40+90	176	CURB RAMP, S. SIDE, 2ND ST.
RT, 46+23	27	CURB RAMP, 4' WIDTH, N. SIDE, 5TH ST.
LT, 46+27	73	CURB RAMP, 4' WIDTH, N. SIDE, 5TH ST.
RT, 46+78	78	CURB RAMP, 4' WIDTH, S. SIDE, 5TH ST.
LT, 46+83	73	CURB RAMP, 4' WIDTH, S. SIDE, 5TH ST.
LT, 52+05	41	CURB RAMP, 5' WIDTH, S. SIDE, 6TH ST.
RT, 52+19	50	CURB RAMP, 4' WIDTH, S. SIDE, 6TH ST.
LT, 51+38	67	CURB RAMP, 4' WIDTH, N. SIDE, 6TH ST.
RT, 51+60	57	CURB RAMP, 4' WIDTH, N. SIDE, 6TH ST.
LT, 63+31	32	CURB RAMP, 4' WIDTH, N. SIDE, 10TH ST.
LT, 63+69	24	CURB RAMP, 4' WIDTH, S. SIDE, 10TH ST.
PROJECT TOTAL	773	
42400200		

DETECTABLE WARNINGS		
STATION	SQ FT	REMARKS
12TH AVENUE		
LT, 40+32	18	3 - 3.0' X 2.0', NORTH SIDE OF 2ND
LT, 40+90	18	3 - 3.0' X 2.0', SOUTH SIDE OF 2ND
RT, 46+23	6	3.0' X 2.0', NORTH SIDE OF 5TH
LT, 46+27	66	3.0' X 2.0', NORTH SIDE OF 5TH
RT, 46+78	12	2 - 3.0' X 2.0', SOUTH SIDE OF 5TH
LT, 46+83	6	3.0' X 2.0', SOUTH SIDE OF 5TH
LT, 52+05	6	3.0' X 2.0', SOUTH SIDE OF 6TH
RT, 52+19	6	3.0' X 2.0', SOUTH SIDE OF 6TH
LT, 51+38	6	3.0' X 2.0', NORTH SIDE OF 6TH
RT, 51+60	6	3.0' X 2.0', NORTH SIDE OF 6TH
LT, 63+31	6	3.0' X 2.0', NORTH SIDE, W. 10TH ST.
LT, 63+69	6	3.0' X 2.0', SOUTH SIDE, W. 10TH ST.
PROJECT TOTAL	102	
42400800		

HOT-MIX ASPHALT SURFACE REMOVAL 1 1/4"		
STATION	SQ YD	REMARKS
12TH AVENUE, MAINLINE		
34+55 TO 35+47	321	MAINLINE WIDTH VARIES
35+47 TO 64+10	12,796	40.0' MAINLINE WIDTH
12TH AVENUE, SIDE ROADS		
LT, W. 2ND STREET	149	48.0' LT OF C
RT, W. 2ND STREET	121	45' RT OF C
LT, W. 5TH STREET	86	36.0' LT OF C
RT, W. 5TH STREET	64	36.0' RT OF C
LT, W. 6TH STREET	165	54.0' LT OF C
RT, W. 6TH STREET	112	41.0' RT OF C
LT, W. 10TH STREET	91	41.0' LT OF C
RT, W. 10TH STREET	103	47.0' RT OF C
PROJECT TOTAL	14,008	
40600154		

COMBINATION CURB AND GUTTER REMOVAL		
STATION	FOOT	REMARKS
12TH AVENUE, MAINLINE		
LT, 40+32	19	RADIUS 2ND STREET LT, NORTH SIDE
LT, 40+90	45	RADIUS 2ND STREET LT, SOUTH SIDE
RT, 46+23	22	RADIUS 5TH STREET RT, NORTH SIDE
LT, 46+27	20	RADIUS 5TH STREET LT, NORTH SIDE
RT, 46+78	33	RADIUS 5TH STREET RT, SOUTH SIDE
LT, 46+83	24	RADIUS 5TH STREET LT, SOUTH SIDE
LT, 52+05	26	RADIUS 6TH STREET LT, SOUTH SIDE
RT, 52+19	30	RADIUS 6TH STREET RT, SOUTH SIDE
LT, 51+38	28	RADIUS 6TH STREET LT, NORTH SIDE
RT, 51+60	33	RADIUS 6TH STREET RT, NORTH SIDE
LT, 63+31	13	RADIUS, W. 10TH STREET, NORTH SIDE
LT, 63+69	11	RADIUS, W. 10TH STREET, SOUTH SIDE
PROJECT TOTAL	304	
44000500		

SIDEWALK REMOVAL		
STATION	SQ FT	REMARKS
12TH AVENUE, MAINLINE		
LT, 40+32	75	WIDTH VARIES
LT, 40+90	176	WIDTH VARIES
RT, 46+23	27	4' WIDTH
LT, 46+27	73	4' WIDTH
RT, 46+78	78	4' WIDTH
LT, 46+83	73	4' WIDTH
LT, 52+05	41	5' WIDTH
RT, 52+19	50	4' WIDTH
LT, 51+38	67	4' WIDTH
RT, 51+60	57	4' WIDTH
LT, 63+31	32	4' WIDTH
LT, 63+69	24	4' WIDTH
PROJECT TOTAL	773	
44000600		

PAVEMENT PATCHING (FULL DEPTH)		
STATION	SQ YD	REMARKS
DETERMINED BY THE RESIDENT ENGR.		
PROJECT TOTAL	311	ESTIMATED AT 20% OF HMA SURFACE REMOVAL AREA
44212899		



DESIGNED - BDF	REVISED -
DRAWN - BDF	REVISED -
CHECKED - BDF	REVISED -
DATE - 07/13/2009	REVISED -

## CITY OF ROCK FALLS, ILLINOIS 12th AVENUE - ROCK RIVER BRIDGE to W. 10th ST.

## SCHEDULE OF QUANTITIES

SCALE:

F.A. - RTE.	SECTION	COUNTY	TOTAL SHEETS	SHEET NO.
	09-00130-00-RS	WHITESIDE	21	4
CONTRACT NO. 85499				
FED. ROAD DIST. NO. ILLINOIS FED. AID PROJECT				

# ROADWAY SCHEDULES

WATER VALVES TO BE ADJUSTED		
STATION	EACH	REMARKS
LT 31', 40+43	1	
LT 15', 40+50	1	
RT 26', 40+50	1	
RT 27', 46+37	1	
<b>PROJECT TOTAL</b>	<b>4</b>	

56109210

MANHOLES TO BE ADJUSTED		
STATION	EACH	REMARKS
RT 6', 34+72	1	
LT 15', 36+84	1	
RT 6', 37+44	1	
LT 16', 38+73	1	
¢ 40+62	1	
RT 6', 40+64	1	
LT 15', 41+04	1	
RT 1', 41+04	1	
RT 17', 41+05	1	
LT 17', 42+64	1	
¢ 43+79	1	
RT 6', 46+14	1	
RT 7', 46+40	1	
¢ 46+56	1	
LT 14', 46+56	1	
RT 17', 46+57	1	
RT 7', 47+93	1	
RT 16', 48+79	1	
LT 1', 49+05	1	
RT 15', 50+79	1	
¢ 51+60	1	
RT 8', 51+88	1	
RT 12', 54+00	1	
RT 11', 56+33	1	
RT 10', 61+42	1	
RT 6', 63+15	1	
RT 34', 63+32	1	
<b>PROJECT TOTAL</b>	<b>27</b>	

60255500

INLETS TO BE ADJUSTED		
STATION	EACH	REMARKS
12TH AVENUE		
RT 20', 37+42	1	
LT 20', 37+45	1	
RT 20', 40+26	1	
RT 43', 40+43	1	
RT 36', 40+83	1	
LT 28', 40+86	1	
LT 20', 41+01	1	
RT 20', 41+01	1	
RT 20', 46+11	1	
LT 20', 46+19	1	
RT 32', 46+32	1	
RT 32', 46+61	1	
LT 32', 46+78	1	
RT 20', 47+93	1	
LT 20', 48+02	1	
LT 40', 51+46	1	
RT 36', 51+75	1	
LT 53', 51+83	1	
LT 20', 52+15	1	
RT 20', 52+38	1	
LT 20', 54+01	1	
RT 20', 54+01	1	
RT 20', 56+34	1	
LT 20', 56+36	1	
RT 20', 61+42	1	
LT 20', 61+43	1	
RT 20', 63+01	1	
LT 24', 63+26	1	
RT 35', 63+50	1	
<b>PROJECT TOTAL</b>	<b>29</b>	

60260100

FRAMES AND GRATES TO BE ADJUSTED		
STATION	EACH	REMARKS
LT 17', 40+25	1	
LT 38', 40+45	1	
<b>PROJECT TOTAL</b>	<b>2</b>	

60300105

COMBINATION CONCRETE CURB AND GUTTER, TYPE M-6.24		
STATION	FOOT	REMARKS
12TH AVENUE, MAINLINE		
LT. 40+32	19	RADIUS 2ND STREET LT, NORTH SIDE
LT. 40+90	45	RADIUS 2ND STREET RT, SOUTH SIDE
RT. 46+23	22	RADIUS 5TH STREET RT, NORTH SIDE
LT. 46+27	20	RADIUS 5TH STREET LT, NORTH SIDE
RT. 46+78	33	RADIUS 5TH STREET RT, SOUTH SIDE
LT. 46+83	24	RADIUS 5TH STREET LT, SOUTH SIDE
LT. 52+05	26	RADIUS 6TH STREET LT, SOUTH SIDE
RT. 52+19	30	RADIUS 6TH STREET RT, SOUTH SIDE
LT. 51+38	28	RADIUS 6TH STREET LT, NORTH SIDE
RT. 51+60	33	RADIUS 6TH STREET RT, NORTH SIDE
LT. 63+31	13	RADIUS, W. 10TH STREET, NORTH SIDE
LT. 63+69	11	RADIUS, W. 10TH STREET, SOUTH SIDE
<b>PROJECT TOTAL</b>	<b>304</b>	

60610400

THERMOPLASTIC PAVEMENT MARKING - LETTERS AND SYMBOLS		
STATION	SQ FT	REMARKS
12TH AVENUE, MAINLINE		
RT. 39+37	8.8	LEFT TURN ARROW (WHITE)
RT. 39+39	14.7	COMB. RIGHT/THROUGH ARROW (WHITE)
RT. 40+07	8.8	LEFT TURN ARROW (WHITE)
RT. 40+09	14.7	COMB. RIGHT/THROUGH ARROW (WHITE)
LT. 40+20	14.7	COMB. RIGHT/THROUGH ARROW (WHITE)
LT. 40+22	8.8	LEFT TURN ARROW (WHITE)
LT. 40+90	14.7	COMB. RIGHT/THROUGH ARROW (WHITE)
LT. 40+92	8.8	LEFT TURN ARROW (WHITE)
<b>PROJECT TOTAL</b>	<b>94</b>	

78000100

THERMOPLASTIC PAVEMENT MARKING - LINE 4"		
STATION	FOOT	REMARKS
12TH AVENUE, MAINLINE		
¢ 34+55 TO 35+47	184	DOUBLE CENTER LINE - SOLID (YELLOW)
¢ 35+47 TO 40+19	472	SINGLE CENTER LINE - SOLID (YELLOW)
¢ 41+08 TO 43+40	232	SINGLE CENTER LINE - SOLID (YELLOW)
¢ 43+40 TO 64+10	518	CENTER LINE - 10'-30' SP (YELLOW)
<b>PROJECT TOTAL</b>	<b>1,406</b>	

78000200

THERMOPLASTIC PAVEMENT MARKING - LINE 6"		
STATION	FOOT	REMARKS
12TH AVENUE, MAINLINE		
RT. 38+75 TO 40+19	144	TURN LANE (WHITE)
LT. & RT. 40+32 (2ND ST)	116	CROSSWALK, N. SIDE OF INTERSEC (WHT)
LT. & RT. 40+82 (2ND ST)	116	CROSSWALK, S. SIDE OF INTERSEC (WHT)
LT. 41+08 TO 42+70	162	TURN LANE (WHITE)
LT. & RT. 46+80 (5TH ST)	77	CROSSWALK, S. SIDE OF INTERSEC (WHT)
LT. & RT. 51+46 (10TH ST)	86	CROSSWALK, N. SIDE OF INTERSEC (WHT)
LT. & RT. 52+06 (10TH ST)	94	CROSSWALK, S. SIDE OF INTERSEC (WHT)
12TH AVENUE, SIDE STREETS		
RT. 22', 40+63 (2ND ST)	87	CROSSWALK, W. SIDE OF INTERSEC (WHT)
LT. 38', 40+67 (2ND ST)	92	CROSSWALK, E. SIDE OF INTERSEC (WHT)
RT. 20', 46+46 (5TH ST)	79	CROSSWALK, W. SIDE OF INTERSEC (WHT)
LT. 22', 46+56 (5TH ST)	94	CROSSWALK, E. SIDE OF INTERSEC (WHT)
LT. 20', 51+75 (6TH ST)	108	CROSSWALK, E. SIDE OF INTERSEC (WHT)
RT. 22', 51+85 (6TH ST)	99	CROSSWALK, W. SIDE OF INTERSEC (WHT)
LT. 27', 63+45 (10TH ST)	69	CROSSWALK, E. SIDE OF INTERSEC (WHT)
<b>PROJECT TOTAL</b>	<b>1,423</b>	

78000400

THERMOPLASTIC PAVEMENT MARKING - LINE 24"		
STATION	FOOT	REMARKS
12TH AVENUE, MAINLINE		
RT. 40+19 (2ND ST.)	20	STOP BAR, NORTH SIDE OF INTERSECTION
LT. 41+08 (2ND ST.)	22	STOP BAR, SOUTH SIDE OF INTERSECTION
12TH AVENUE, SIDE STREETS		
RT. 40', 40+72 (2ND ST.)	18	STOP BAR, WEST SIDE OF INTERSECTION
LT. 31', 46+45 (5TH ST.)	20	STOP BAR, EAST SIDE OF INTERSECTION
LT. 45', 51+60 (6TH ST.)	20	STOP BAR, EAST SIDE OF INTERSECTION
RT. 34', 52+00 (6TH ST.)	24	STOP BAR, WEST SIDE OF INTERSECTION
LT. 41', 63+37 (10TH ST.)	15	STOP BAR, EAST SIDE OF INTERSECTION
RT. 34', 63+49 (10TH ST.)	14	STOP BAR, WEST SIDE OF INTERSECTION
<b>PROJECT TOTAL</b>	<b>153</b>	

78000650

HANDHOLE TO BE ADJUSTED		
STATION	EACH	REMARKS
LT 38', 40+39	1	
<b>PROJECT TOTAL</b>	<b>1</b>	

81400115

**WILLET, HOFMANN & ASSOCIATES, INC.**  
**CONSULTING ENGINEERS**  
 809 East Second Street Dixon, IL 61021  
 Phone 815.284.3361 Fax 815.284.3365  
 Design Firm # 184-00918  
 www.willett-hofmann.com

DESIGNED - BDF	REVISED -
DRAWN - BDF	REVISED -
CHECKED - BDF	REVISED -
DATE - 07/13/2009	REVISED -

**CITY OF ROCK FALLS, ILLINOIS**  
**12th AVENUE - ROCK RIVER BRIDGE to W. 10th ST**

**SCHEDULE OF QUANTITIES**

F.A. RTE.	SECTION	COUNTY	TOTAL SHEETS	SHEET NO.
	09-00130-00-RS	WHITESIDE	21	5
FED. ROAD DIST. NO. - ILLINOIS FED. AID PROJECT			CONTRACT NO. 85499	

EXISTING CURVE DATA

- Δ - 3° 00'
- D - 1° 12'
- R - 4,774.74'
- T - 125.00'
- L - 250.00'
- E - 1.64'

INDICATES LIMIT OF HOT MIX ASPHALT SURFACE REMOVAL - 1 1/4" REMOVE FULL WIDTH OF 12TH AVENUE AND AT INTERSECTING STREETS AS SHOWN.

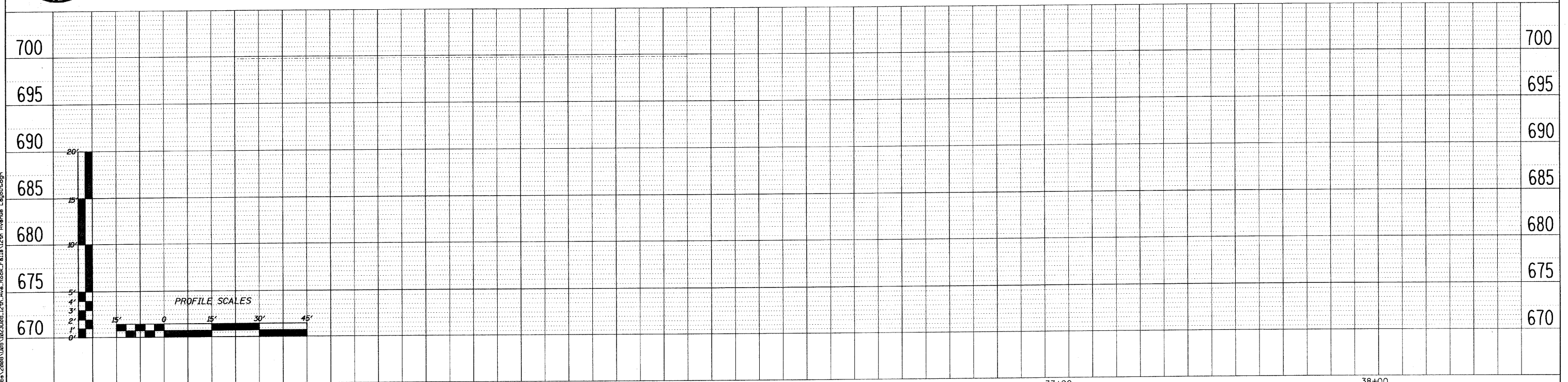
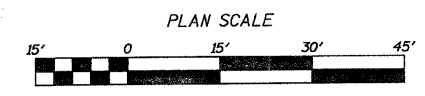
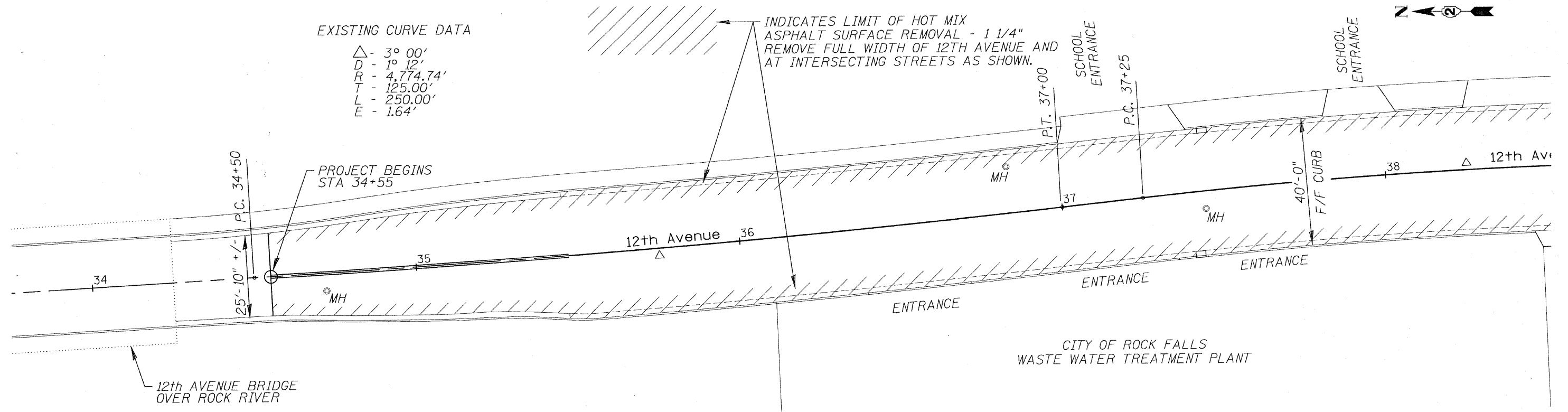

FILE NAME: L:\Vdata\2008\08\12th Ave Rock Falls\12th Avenue Layout.dgn

**WILLETT, HOFMANN & ASSOCIATES, INC.**  
**CONSULTING ENGINEERS**  
 809 East Second Street Dixon, IL 61021  
 Phone 815.284.3381 Fax 815.284.3385  
 Design Firm #194-00019  
 www.willettthofmann.com

DESIGNED - BDF	REVISED -
DRAWN - JDH	REVISED -
CHECKED - BDF	REVISED -
DATE -	REVISED -

**CITY OF ROCK FALLS, ILLINOIS**  
**12th AVE. - ROCK RIVER BRIDGE to W. 10th ST.**

**12TH AVENUE PLAN & PROFILE**

F.A. RTE.	SECTION	COUNTY	TOTAL SHEETS	SHEET NO.
	09-00130-00-RS	WHITESIDE	21	6
CONTRACT NO. 85499				
FED. ROAD DIST. NO.		ILLINOIS FED. AID PROJECT		

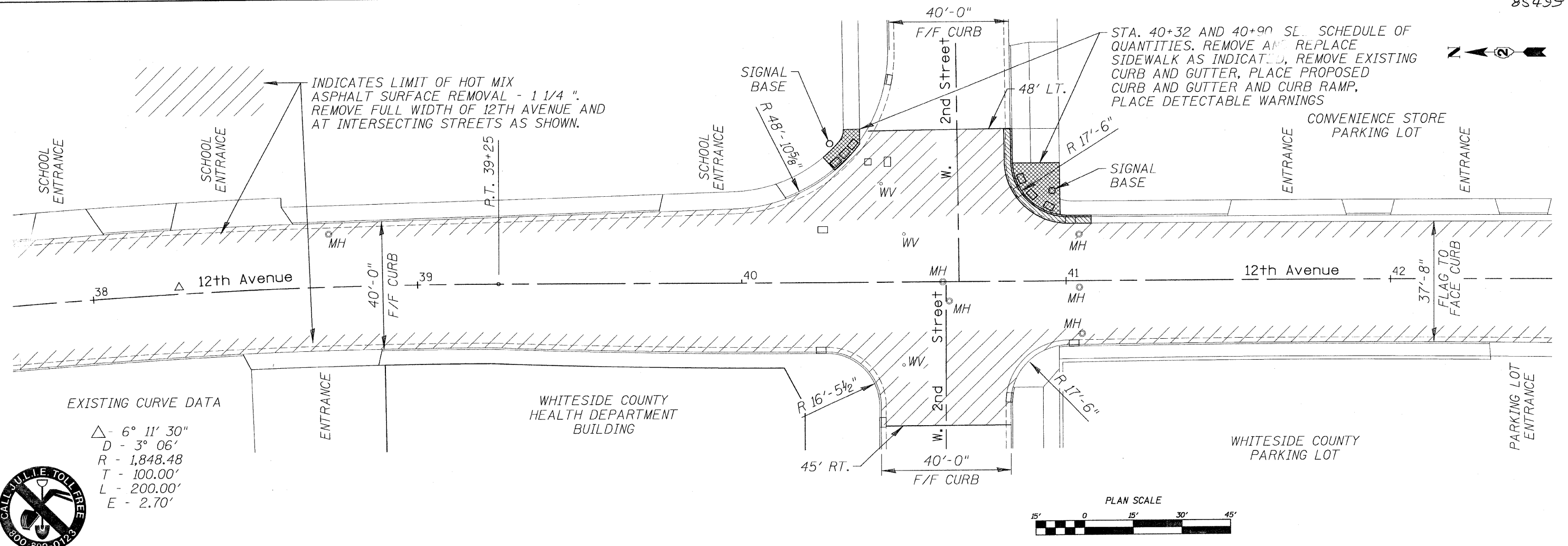

FILE NAME: L:\Jobs\2008\088\_Dixon\Job\1023008\_12th\_Ave\_Rock\_Falls\12th\_Ave\_Landscape.dgn

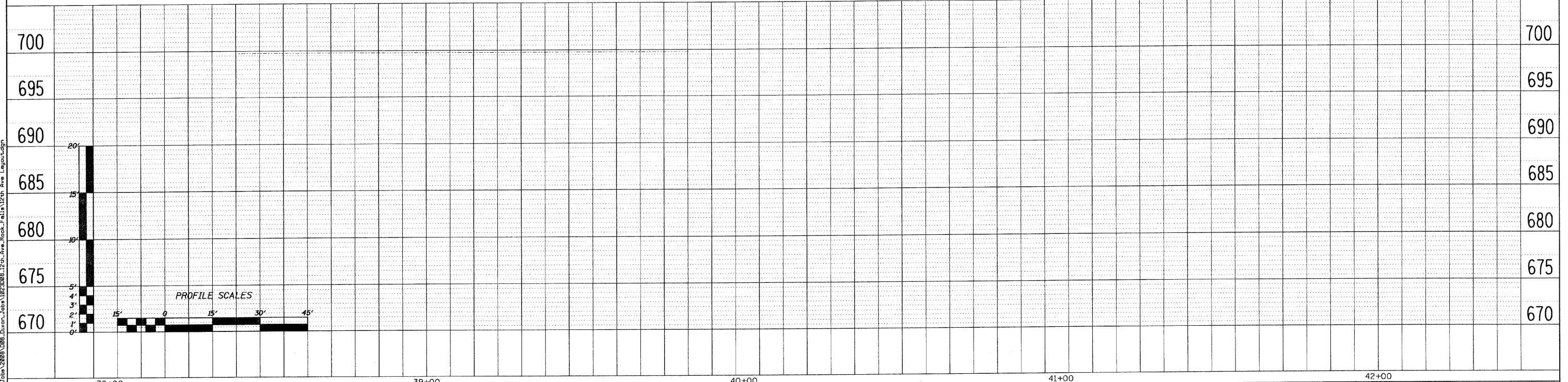

**WILLET, HOFMANN & ASSOCIATES, INC.**  
 CONSULTING ENGINEERS  
 809 East Second Street Dixon, IL 61021  
 Phone 815.294.3381 Fax 815.284.3385  
 Design Firm #104-00918  
 www.willett-hofmann.com

DESIGNED - BDF	REVISED -
DRAWN - JOH	REVISED -
CHECKED - BDF	REVISED -
DATE -	REVISED -

**CITY OF ROCK FALLS, ILLINOIS**  
**12th AVE. - ROCK RIVER BRIDGE to W. 10th ST.**

**12TH AVENUE PLAN & PROFILE**

F.A. RTE.	SECTION	COUNTY	TOTAL SHEETS	SHEET NO.
	09-00130-00-RS	WHITESIDE	21	7
CONTRACT NO. 85499				
FED. ROAD DIST. NO. - ILLINOIS FED. AID PROJECT				

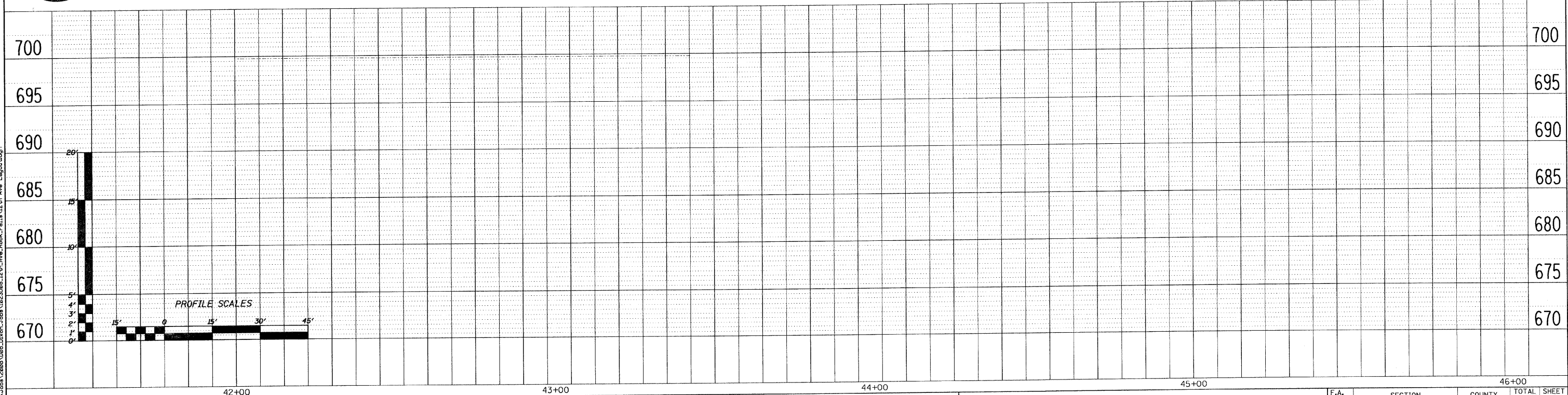
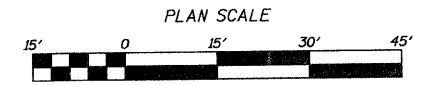
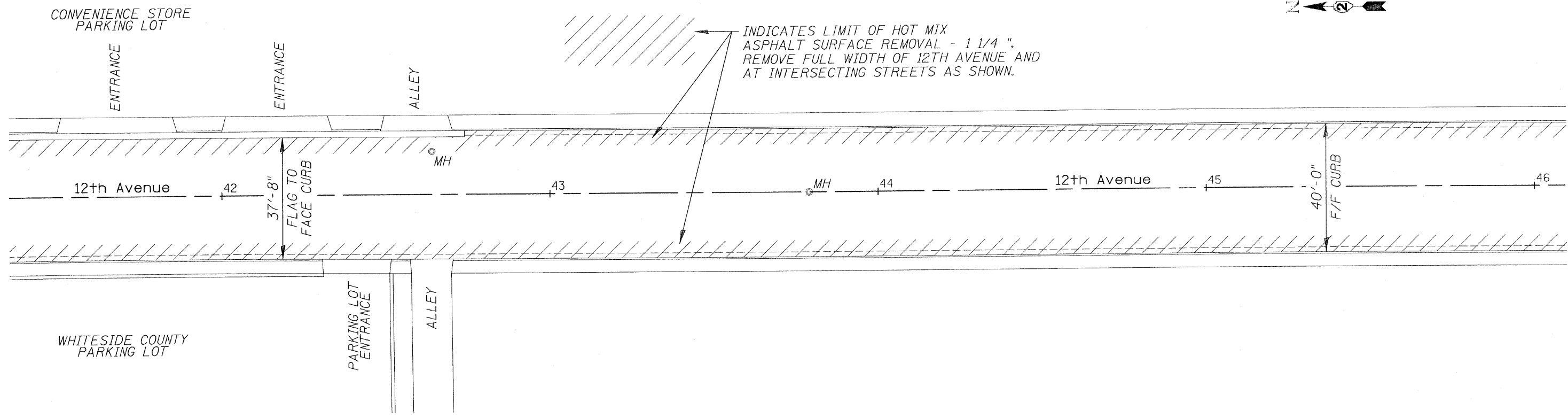

FILE NAME = L:\Jobs\2808\085\Drawn\Job\1023088\_12th\_Ave\_Rock\_Falls\12th\_Ave\_Layout.dgn

**WILLET, HOFMANN & ASSOCIATES, INC.**  
**CONSULTING ENGINEERS**  
 809 East Second Street Dixon, IL 61021  
 Phone 815.284.3381 Fax 815.284.3385  
 Design Firm #104-00019  
 www.willett-hofmann.com

DESIGNED - BDF	REVISED -
DRAWN - JDH	REVISED -
CHECKED - BDF	REVISED -
DATE -	REVISED -

**CITY OF ROCK FALLS, ILLINOIS**  
**12th AVE. - ROCK RIVER BRIDGE to W. 10th ST.**

**12TH AVENUE PLAN & PROFILE**

F.A. RTE.	SECTION	COUNTY	TOTAL SHEETS	SHEET NO.
	09-00130-00-RS	WHITESIDE	21	8
FED. ROAD DIST. NO.			ILLINOIS FED. AID PROJECT	
			CONTRACT NO. 85499	



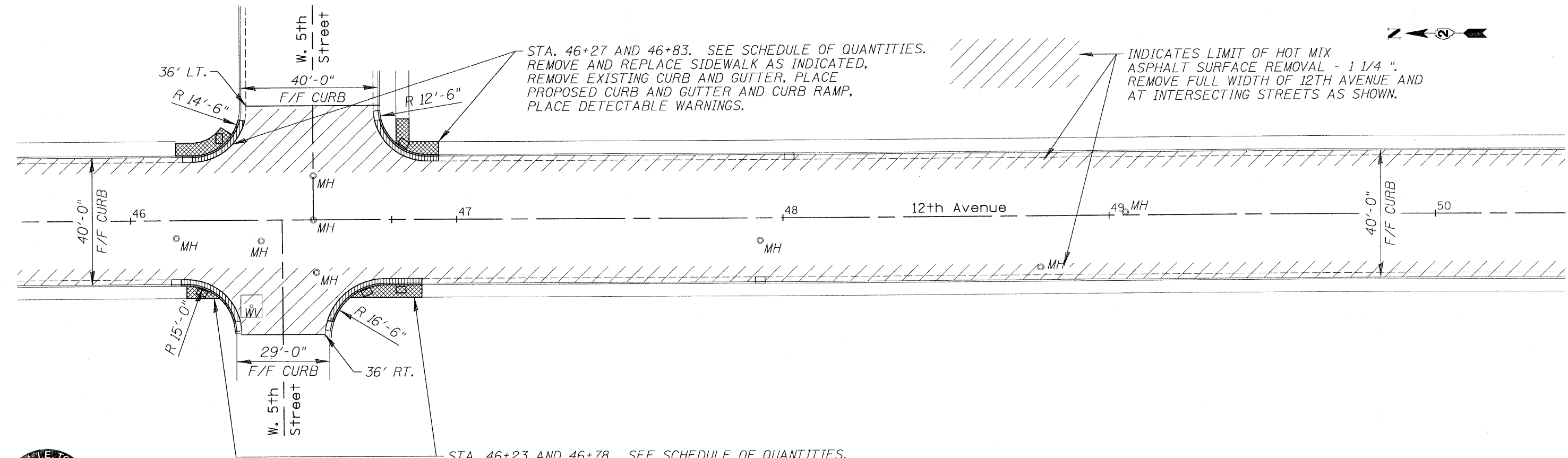

STA. 46+27 AND 46+83. SEE SCHEDULE OF QUANTITIES.  
 REMOVE AND REPLACE SIDEWALK AS INDICATED,  
 REMOVE EXISTING CURB AND GUTTER, PLACE  
 PROPOSED CURB AND GUTTER AND CURB RAMP,  
 PLACE DETECTABLE WARNINGS.

INDICATES LIMIT OF HOT MIX  
 ASPHALT SURFACE REMOVAL - 1 1/4".  
 REMOVE FULL WIDTH OF 12TH AVENUE AND  
 AT INTERSECTING STREETS AS SHOWN.

STA. 46+23 AND 46+78. SEE SCHEDULE OF QUANTITIES.  
 REMOVE AND REPLACE SIDEWALK AS INDICATED,  
 REMOVE EXISTING CURB AND GUTTER, PLACE  
 PROPOSED CURB AND GUTTER AND CURB RAMP,  
 PLACE DETECTABLE WARNINGS.

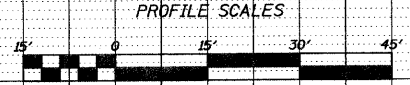
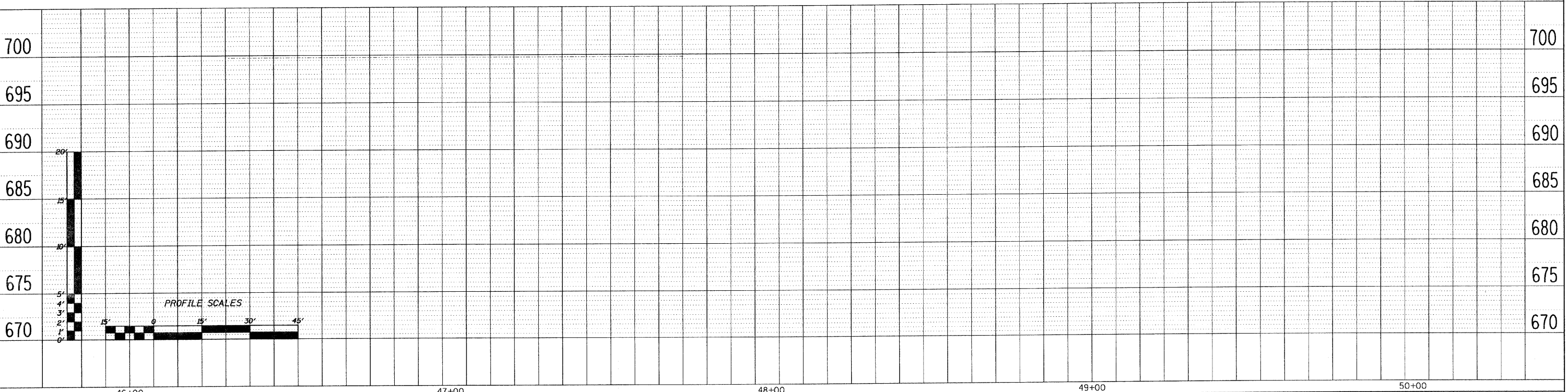
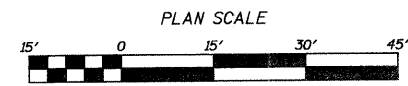

FILE NAME = L:\Jobs\2008\088\_Duron\Jobs\1823008\_12th\_Ave\_Rock\_Falls\12th\_Ave\_Layout.dgn

**WILLET, HOFMANN & ASSOCIATES, INC.**  
 CONSULTING ENGINEERS  
 609 East Second Street, Dixon, IL 61021  
 Phone 815.284.3361 Fax 815.284.3385  
 Design Firm #184-00918  
 www.willett-hofmann.com

DESIGNED - BDF	REVISED -
DRAWN - JDH	REVISED -
CHECKED - BDF	REVISED -
DATE -	REVISED -

**CITY OF ROCK FALLS, ILLINOIS**  
**12th AVE. - ROCK RIVER BRIDGE to W. 10th ST.**

**12TH AVENUE PLAN & PROFILE**  
 SCALE:

F.A. RTE.	SECTION	COUNTY	TOTAL SHEETS	SHEET NO.
	09-00130-00-RS	WHITESIDE	21	9
CONTRACT NO. 85499				
FED. ROAD DIST. NO. - ILLINOIS FED. AID PROJECT				

STA 51+38 AND 52+05. SEE SCHEDULE OF QUANTITIES.  
 REMOVE AND REPLACE SIDEWALK AS INDICATED,  
 REMOVE EXISTING CURB AND GUTTER, PLACE  
 PROPOSED CURB AND GUTTER AND CURB RAMP,  
 PLACE DETECTABLE WARNINGS

STA 51+60 AND 52+19. SEE SCHEDULE OF QUANTITIES.  
 REMOVE AND REPLACE SIDEWALK AS INDICATED,  
 REMOVE EXISTING CURB AND GUTTER, PLACE  
 PROPOSED CURB AND GUTTER AND CURB RAMP,  
 PLACE DETECTABLE WARNINGS

INDICATES LIMIT OF HOT MIX  
 ASPHALT SURFACE REMOVAL - 1 1/4".  
 REMOVE FULL WIDTH OF 12TH AVENUE AND  
 AT INTERSECTING STREETS AS SHOWN.

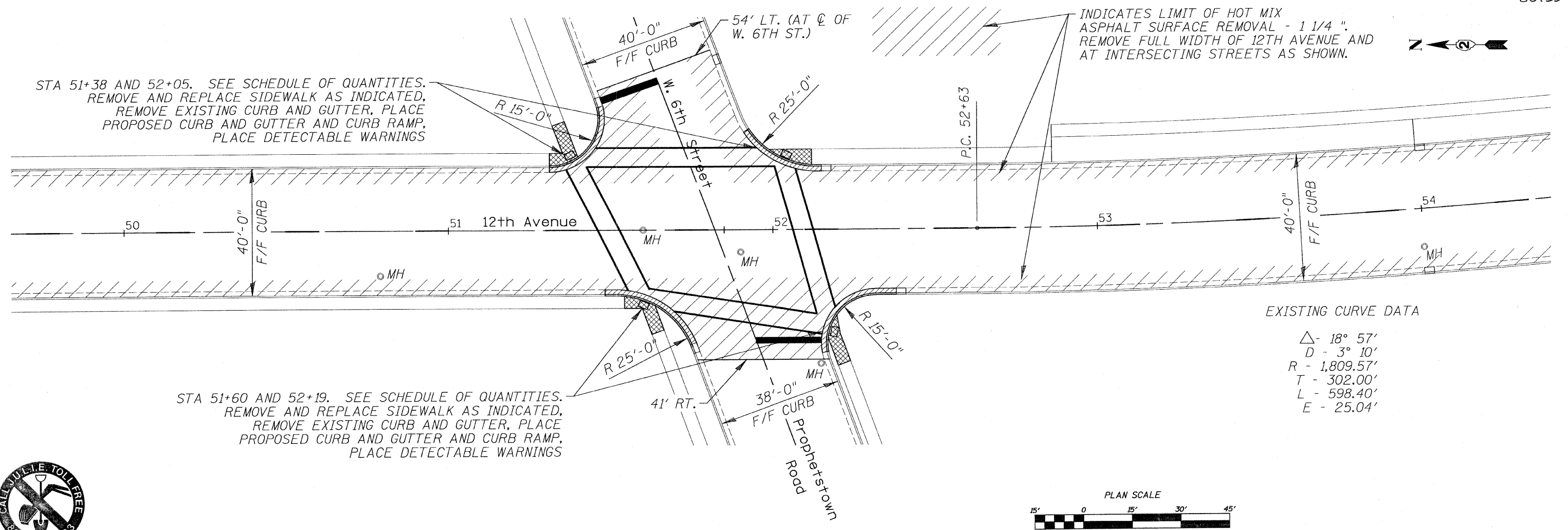

EXISTING CURVE DATA

Δ	- 18° 57'
D	- 3° 10'
R	- 1,809.57'
T	- 302.00'
L	- 598.40'
E	- 25.04'

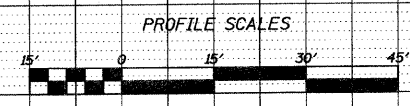
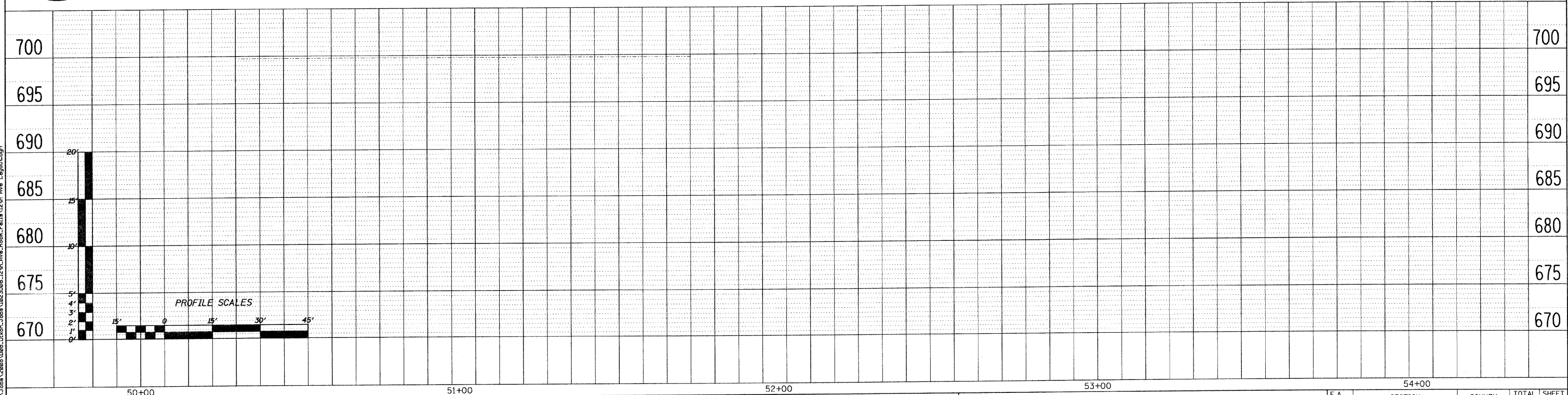
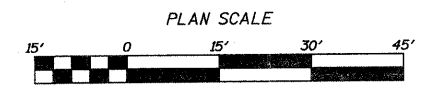

FILE NAME = L:\Jobs\2008\086\_Dixon\Jobs\0223008\_12th\_Ave\_Rock\_Falls\12th\_Ave\_Layout.dgn

**WILLET, HOFMANN & ASSOCIATES, INC.**  
 CONSULTING ENGINEERS  
 809 East Second Street Dixon, IL 61021  
 Phone 815.284.3381 Fax 815.284.3385  
 Design Firm #194-00078  
 www.willetthofmann.com

DESIGNED	- BDF	REVISED	-
DRAWN	- JDH	REVISED	-
CHECKED	- BDF	REVISED	-
DATE	-	REVISED	-

**CITY OF ROCK FALLS, ILLINOIS**  
**12th AVE. - ROCK RIVER BRIDGE to W. 10th ST.**

**12TH AVENUE PLAN & PROFILE**  
 SCALE:

F.A. RTE.	SECTION	COUNTY	TOTAL SHEETS	SHEET NO.
	09-00130-00-RS	WHITESIDE	21	10
FED. ROAD DIST. NO.			ILLINOIS FED. AID PROJECT	
			CONTRACT NO. 85499	

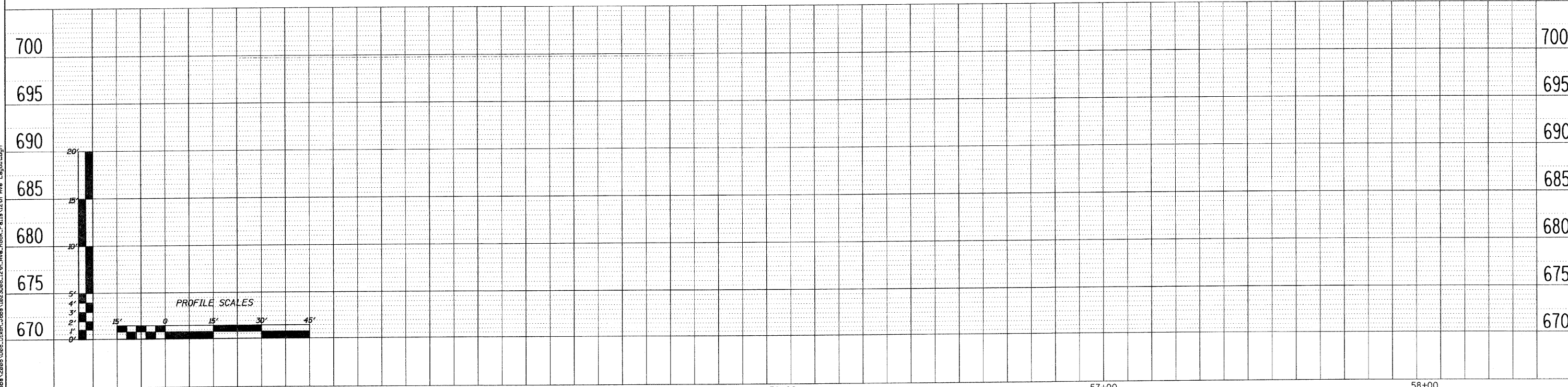
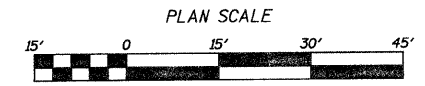
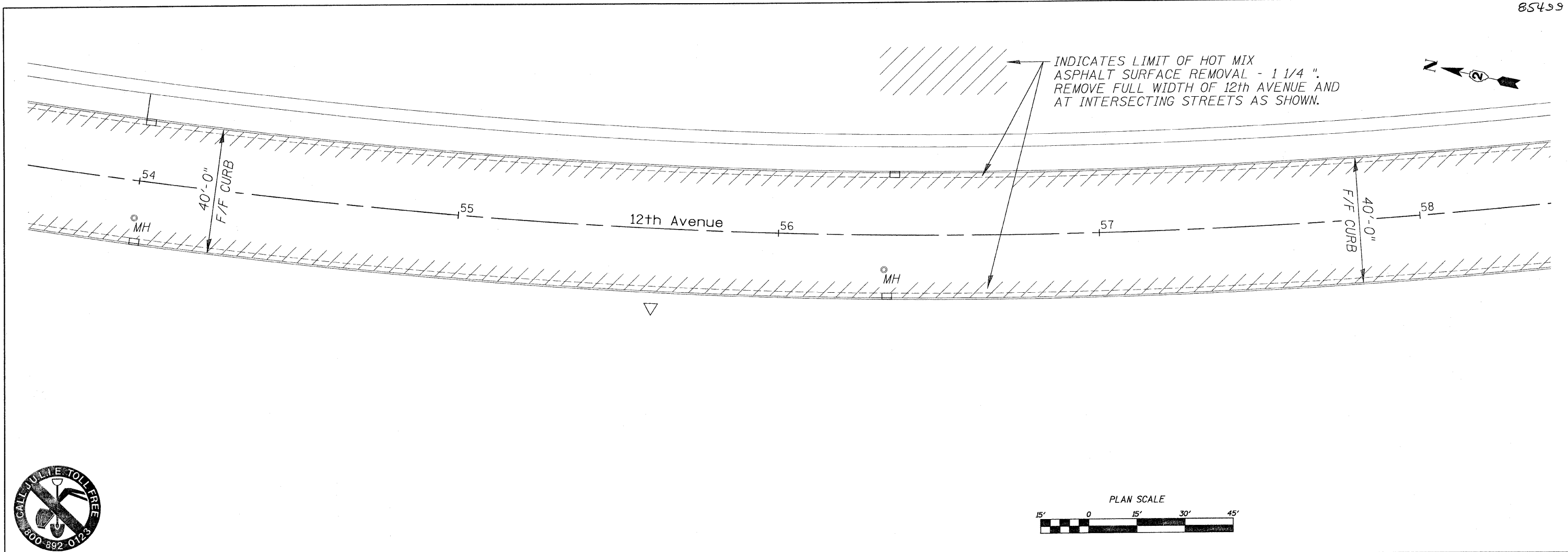

FILE NAME: L:\Jobs\2008\08\_Duon\Jobs\1023008\_12th\_Ave\_Rock\_Falls\12th\_Ave\_Layout.dgn

**WILLETT, HOFMANN & ASSOCIATES, INC.**  
**CONSULTING ENGINEERS**  
 800 East Second Street, Dixon, IL 61021  
 Phone 815.284.3381 Fax 815.284.3385  
 Design Firm #184-00818  
 www.willett-hofmann.com

DESIGNED - BDF	REVISED -
DRAWN - JDH	REVISED -
CHECKED - BDF	REVISED -
DATE -	REVISED -

**CITY OF ROCK FALLS, ILLINOIS**  
**12th AVE. - ROCK RIVER BRIDGE to W. 10th ST.**

**12TH AVENUE PLAN & PROFILE**  
 SCALE:

F.A. RTE.	SECTION	COUNTY	TOTAL SHEETS	SHEET NO.
	09-00130-00-RS	WHITESIDE	21	11
CONTRACT NO. 85499				
FED. ROAD DIST. NO. - ILLINOIS FED. AID PROJECT				

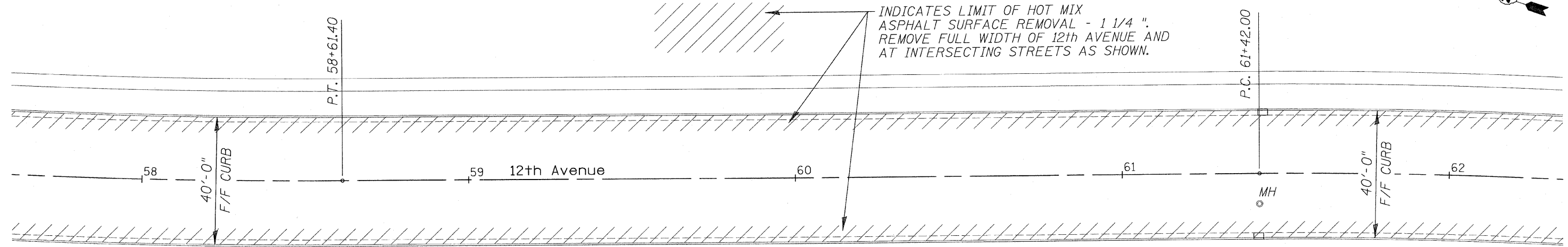

EXISTING CURVE DATA

- Δ - 20° 51'
- D - 3° 10'
- R - 1,809.57'
- T - 332.90'
- L - 658.40'
- E - 30.37'

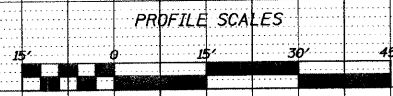
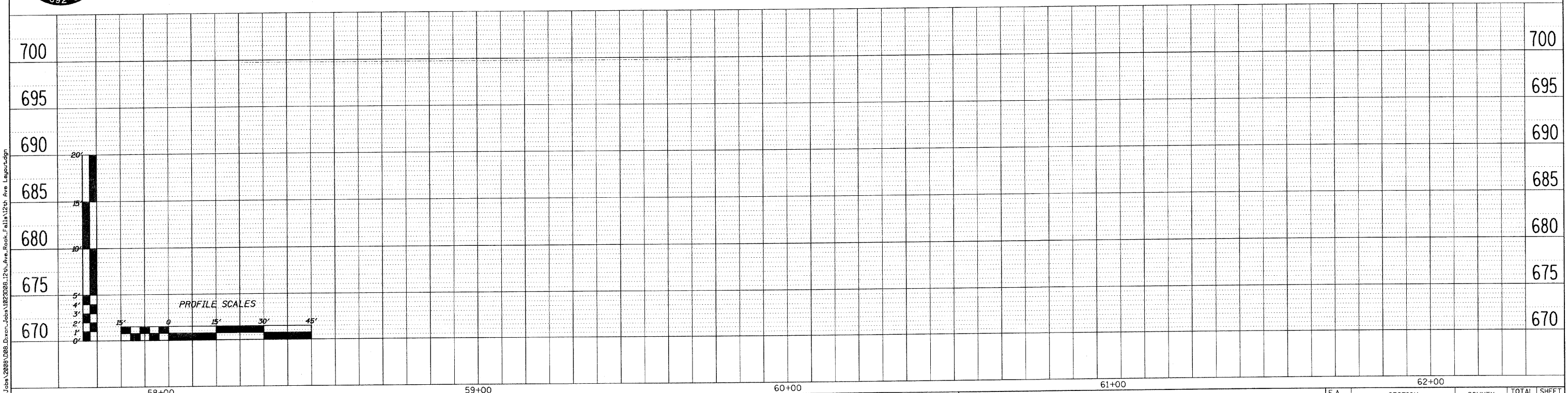
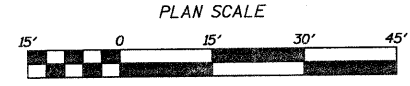

FILE NAME = L:\Jobs\2009\098\_Division\Jobs\1822008\_12th Ave. Rock Falls\12th Ave Layout.dgn

**WILLET, HOFMANN & ASSOCIATES, INC.**  
**CONSULTING ENGINEERS**  
 809 East Second Street Dixon, IL 61021  
 Phone 815.284.3381 Fax 815.284.3385  
 Design Firm #184-00978  
 www.willett-hofmann.com

DESIGNED - BDF	REVISED -
DRAWN - JDH	REVISED -
CHECKED - BDF	REVISED -
DATE -	REVISED -

**CITY OF ROCK FALLS, ILLINOIS**  
**12th AVE. - ROCK RIVER BRIDGE to W. 10th ST.**

**12TH AVENUE PLAN & PROFILE**  
 SCALE:

F.A. RTE.	SECTION	COUNTY	TOTAL SHEETS	SHEET NO.
	09-00130-00-RS	WHITESIDE	21	12
CONTRACT NO. 85499				
FED. ROAD DIST. NO. - [ILLINOIS] FED. AID PROJECT				

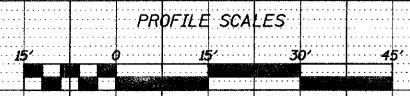
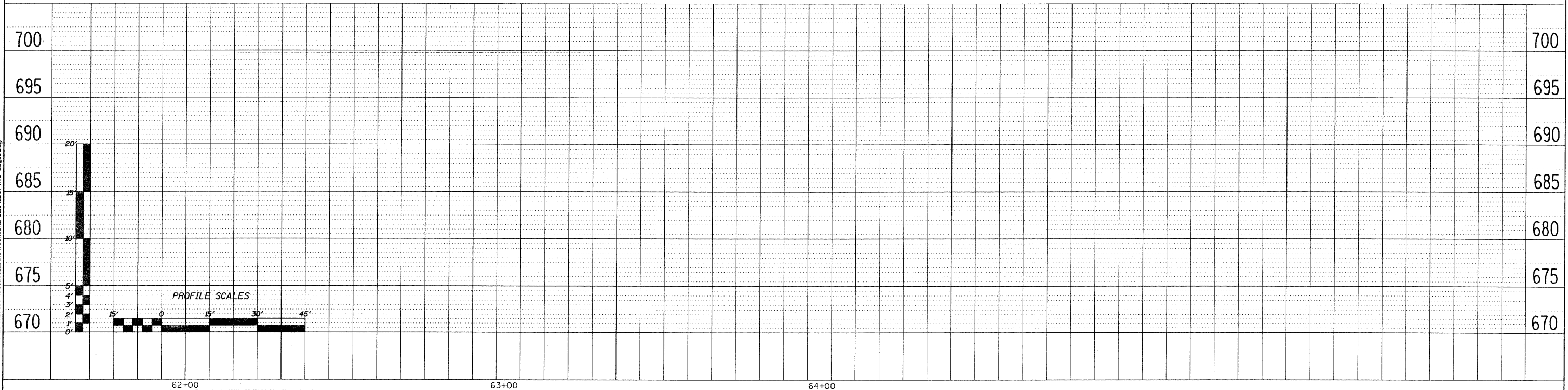
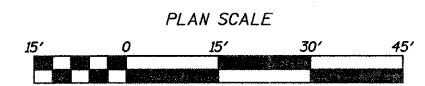
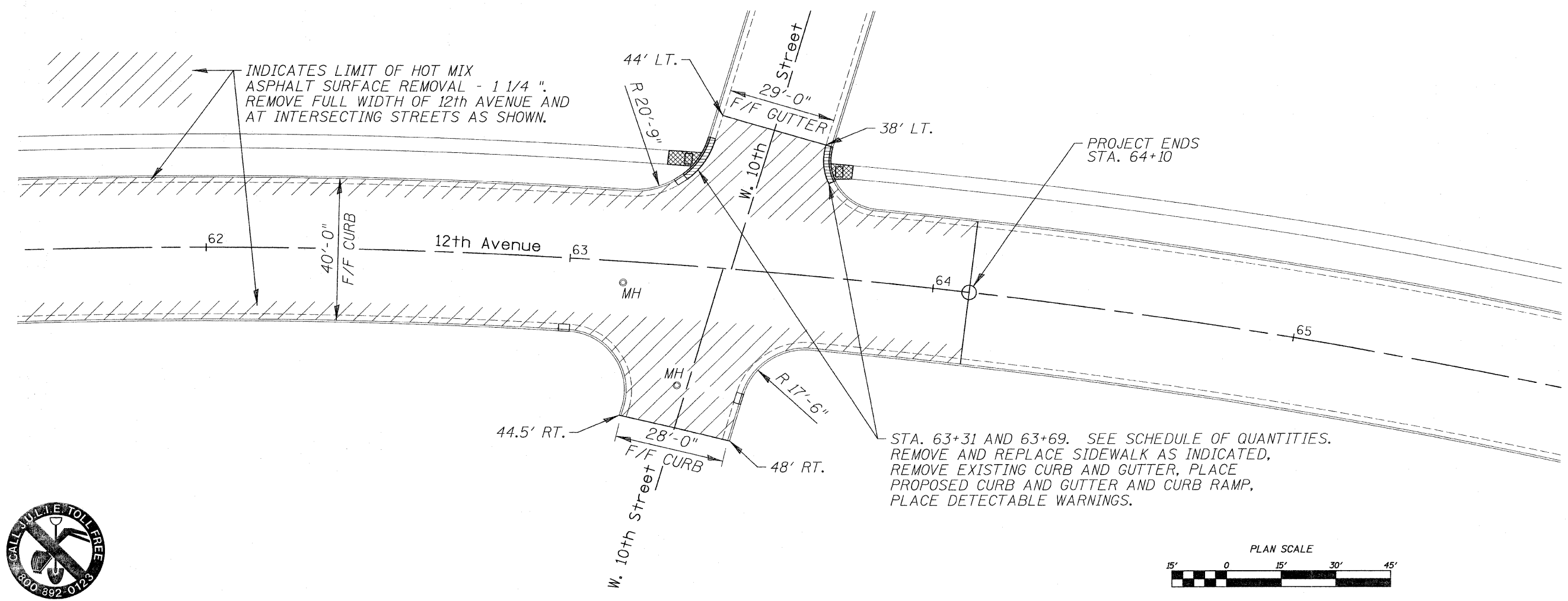

FILE NAME = L:\Jobs\2889\088\_Divon\Jobs\1923085\12th\_Ave\_Rock\_Falls\12th\_Ave\_Layout.dgn

**WILLET, HOFMANN & ASSOCIATES, INC.**  
**CONSULTING ENGINEERS**  
 809 East Second Street Dixon, IL 61021  
 Phone 815.294.3381 Fax 815.294.3385  
 Design Firm #184-00918  
 www.willett-hofmann.com

DESIGNED - BDF	REVISED -
DRAWN - JDH	REVISED -
CHECKED - BDF	REVISED -
DATE -	REVISED -

**CITY OF ROCK FALLS, ILLINOIS**  
**12th AVE. - ROCK RIVER BRIDGE to W. 10th ST.**

**12TH AVENUE PLAN & PROFILE**

F.A. RTE.	SECTION	COUNTY	TOTAL SHEETS	SHEET NO.
	09-00130-00-RS	WHITESIDE	21	13
FED. ROAD DIST. NO. - ILLINOIS FED. AID PROJECT			CONTRACT NO. 85499	

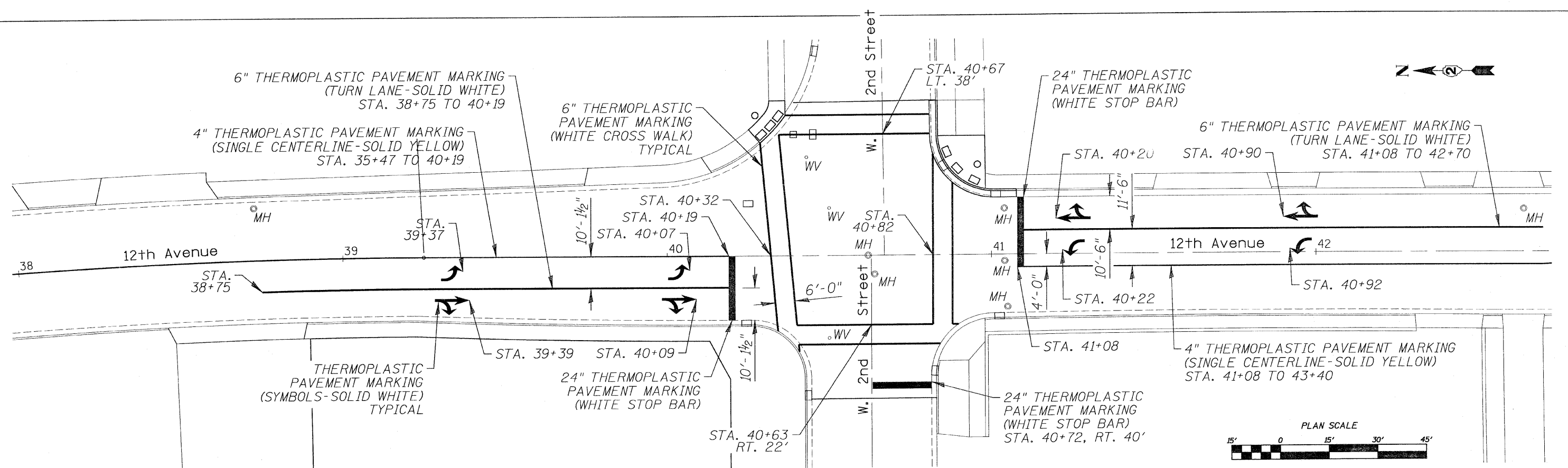
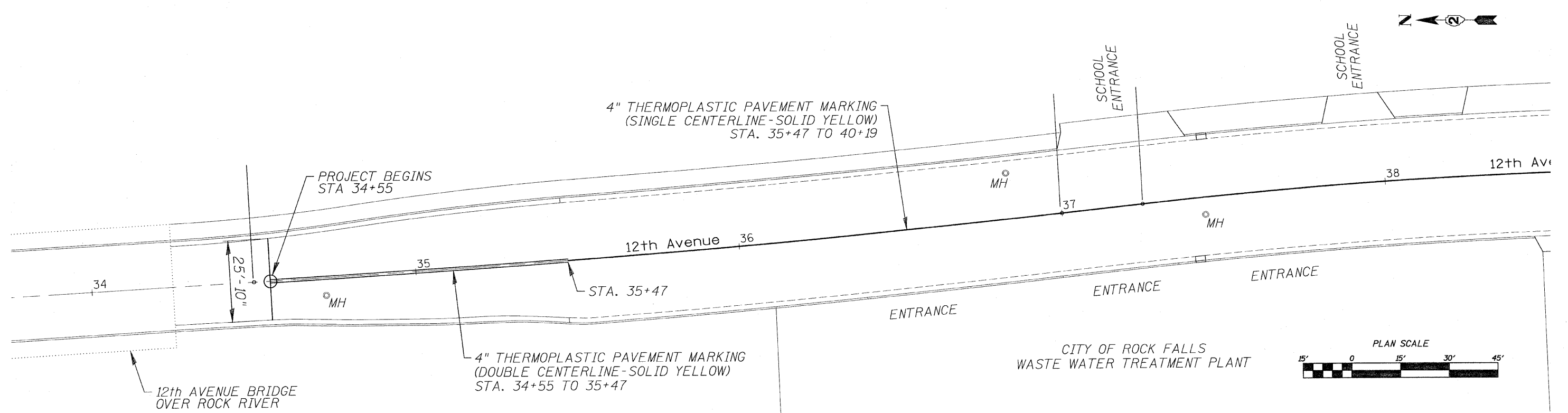

FILE NAME: I:\Jobs\2008\098\023088\_12th\_Ave\_Rock\_Falls\12th Avenue Layout.dgn

**WILLET, HOFMANN & ASSOCIATES, INC.**  
**CONSULTING ENGINEERS**  
 809 East Second Street Dixon, IL 61021  
 Phone 815.284.3381 Fax 815.284.3385  
 Design Firm #194-00918  
 www.willett-hofmann.com

DESIGNED - BDF	REVISED -
DRAWN - JDH	REVISED -
CHECKED - BDF	REVISED -
DATE -	REVISED -

**CITY OF ROCK FALLS, ILLINOIS**  
**12th AVE. – ROCK RIVER BRIDGE to W. 10th ST.**

**12TH AVENUE PAVEMENT MARKINGS**

SCALE:

F.A. RTE.	SECTION	COUNTY	TOTAL SHEETS	SHEET NO.
	09-00130-00-RS	WHITESIDE	21	14
CONTRACT NO. 85499				
FED. ROAD DIST. NO. ILLINOIS FED. AID PROJECT				

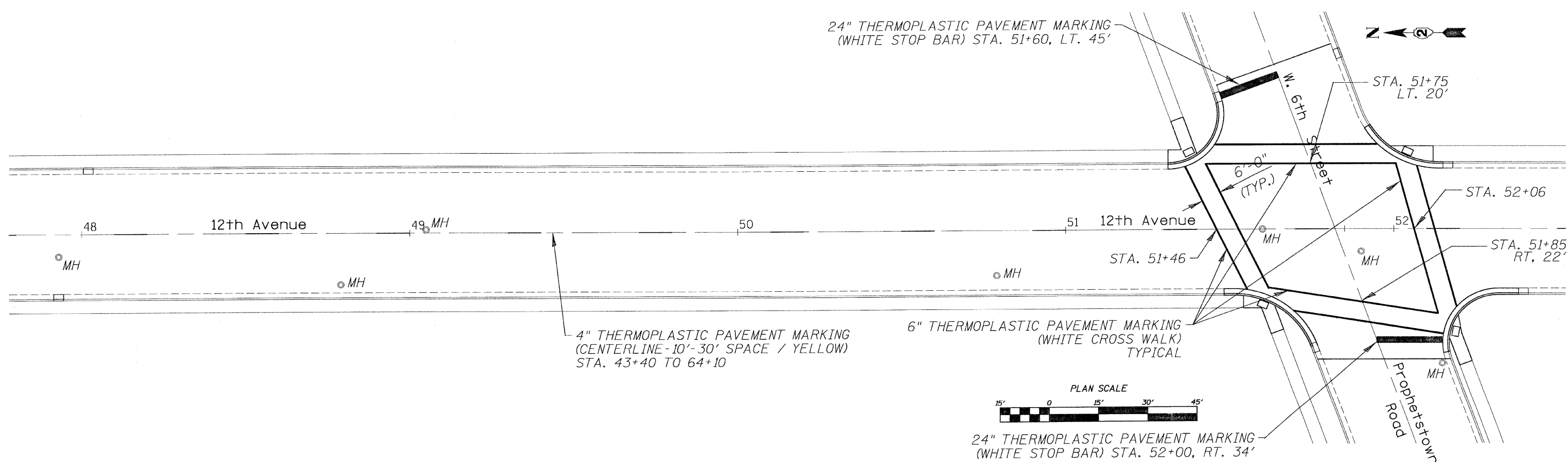
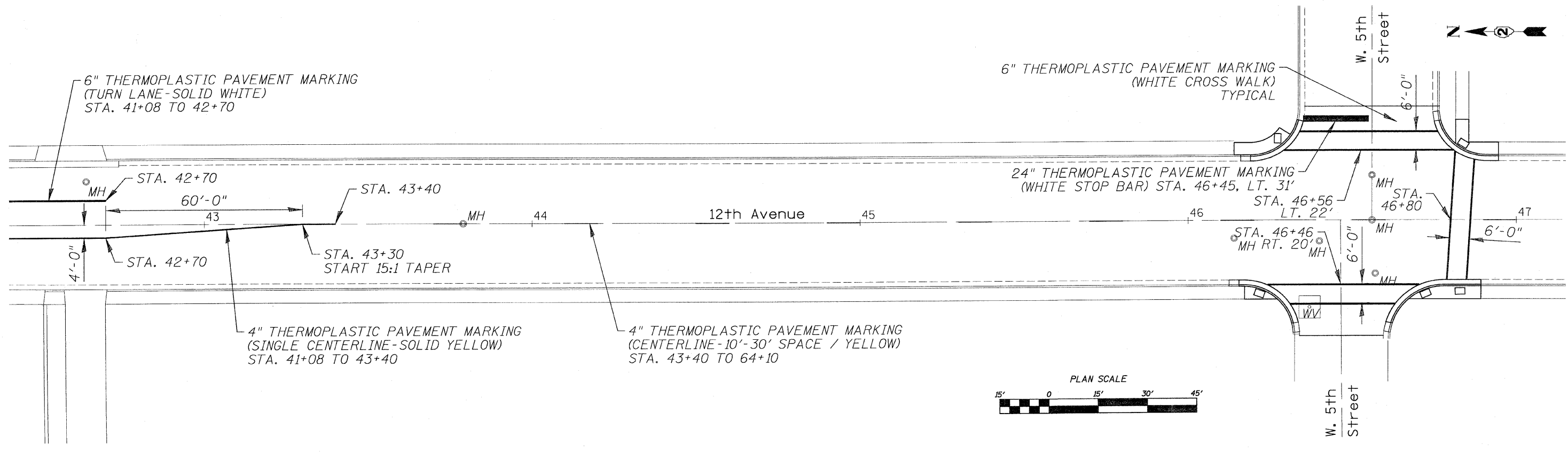

FILE NAME = L:\Jobs\2008\0801\0801\0801\12th Ave Rock Falls\12th Avenue Layout.dgn

**WILLET, HOFMANN & ASSOCIATES, INC.**  
 CONSULTING ENGINEERS  
 809 East Second Street Dixon, IL 61021  
 Phone 815-294-3381 Fax 815-294-3385  
 Design Firm #184-00918  
 www.willett-hofmann.com

DESIGNED - BDF	REVISED -
DRAWN - JDH	REVISED -
CHECKED - BDF	REVISED -
DATE -	REVISED -

**CITY OF ROCK FALLS, ILLINOIS**  
**12th AVE. - ROCK RIVER BRIDGE to W. 10th ST.**

**12TH AVENUE PAVEMENT MARKINGS**

F.A. RTE.	SECTION	COUNTY	TOTAL SHEETS	SHEET NO.
	09-00130-00-RS	WHITESIDE	21	15
FED. ROAD DIST. NO. - ILLINOIS FED. AID PROJECT				

SCALE:

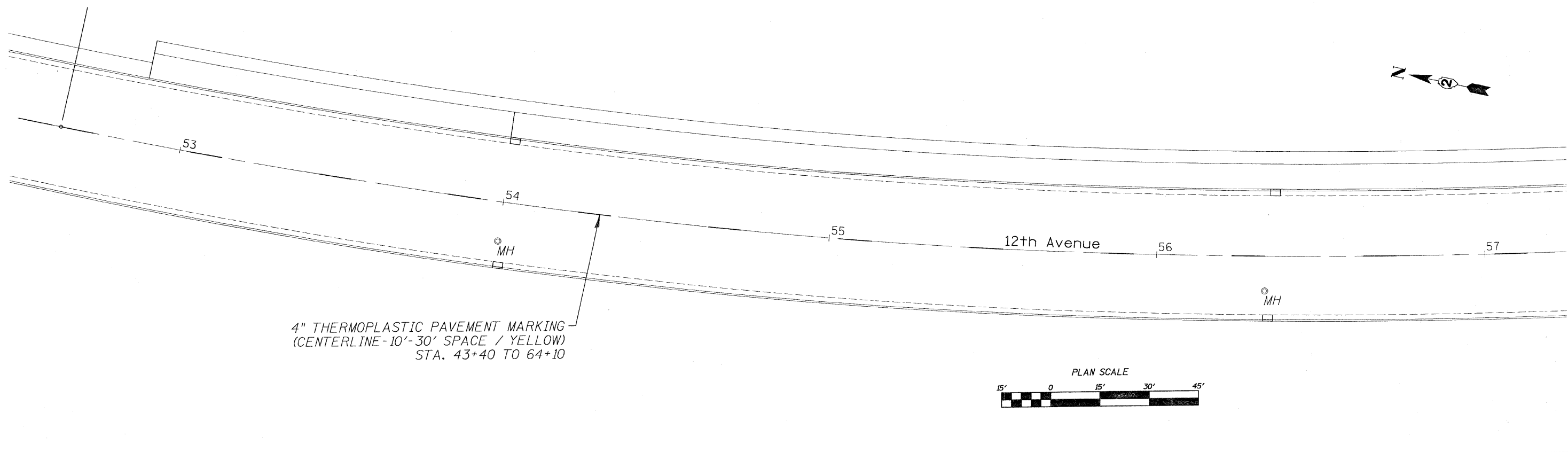

4" THERMOPLASTIC PAVEMENT MARKING  
(CENTERLINE-10'-30' SPACE / YELLOW)  
STA. 43+40 TO 64+10

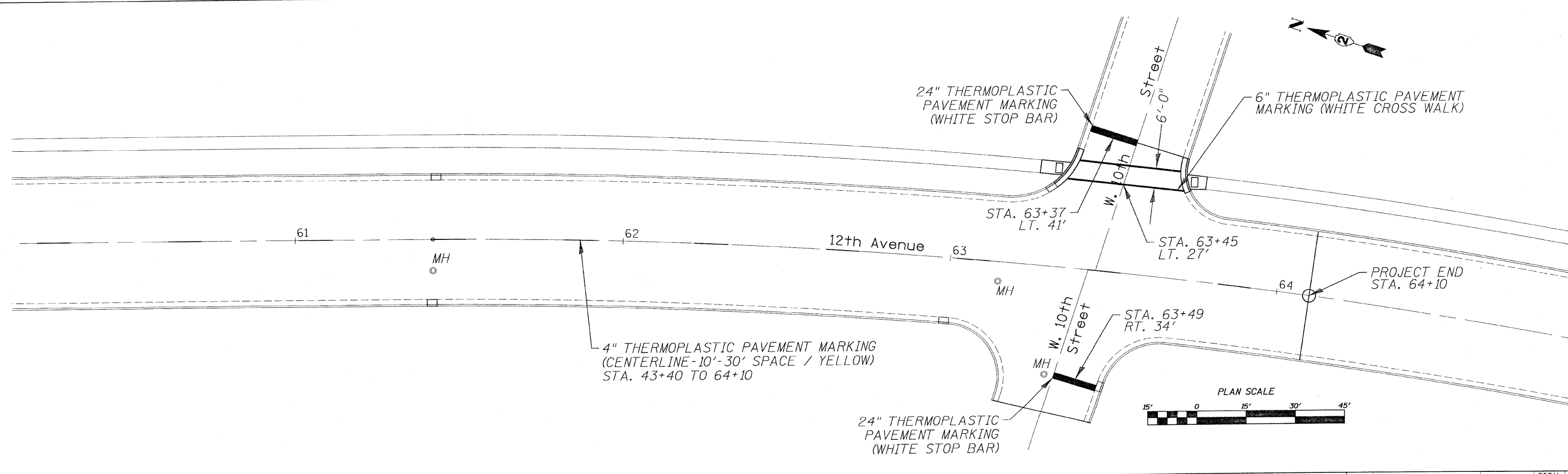
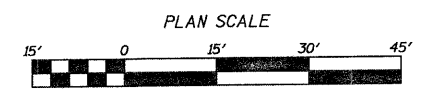

4" THERMOPLASTIC PAVEMENT MARKING  
(CENTERLINE-10'-30' SPACE / YELLOW)  
STA. 43+40 TO 64+10

24" THERMOPLASTIC PAVEMENT MARKING  
(WHITE STOP BAR)

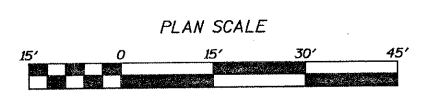

FILE NAME = L:\Jobs\2809\086\1823208\12th\_Ave\_Rock\_Falls\12th Avenue Layout.dgn

**WILLET, HOFMANN & ASSOCIATES, INC.**  
CONSULTING ENGINEERS  
809 East Second Street Dixon, IL 61021  
Phone 815.284.3381 Fax 815.284.3385  
Design Firm #154-00518  
www.willett-hofmann.com

DESIGNED - BDF	REVISED -
DRAWN - JDH	REVISED -
CHECKED - BDF	REVISED -
DATE -	REVISED -

**CITY OF ROCK FALLS, ILLINOIS**  
**12th AVE. - ROCK RIVER BRIDGE to W. 10th ST.**

**12TH AVENUE PAVEMENT MARKINGS**

SCALE:

F.A. RTE.	SECTION	COUNTY	TOTAL SHEETS	SHEET NO.
	09-00130-00-RS	WHITESIDE	21	16
FED. ROAD DIST. NO. - ILLINOIS FED. AID PROJECT			CONTRACT NO. 85499	



# CATCH BASIN OR INLETS TO BE ADJUSTED OR RECONSTRUCTED

## (DETAILS FOR CURB & GUTTER REPLACEMENT)

CONCRETE CURB AND GUTTER SHALL BE CONSTRUCTED IN ACCORDANCE WITH SECTION 606 OF THE STANDARD SPECIFICATIONS, SUPPLEMENTAL SPECIFICATIONS, STANDARD 606001 AND THIS DRAWING.

CLASS SI CONCRETE SHALL BE USED THROUGHOUT. A HOLE 40 (1 1/2) IN DIAMETER AND 225 (9) DEEP SHALL BE DRILLED IN THE EXISTING CONCRETE CURB AS SHOWN. A 32x450 (1 1/4 X 18) SMOOTH DOWEL BAR SHALL BE GROUTED IN THE HOLE LONGITUDINALLY.

JOINTS OF A TYPE SIMILAR TO THAT IN THE UNDERLYING PAVEMENT (EXPANSION OR CONTRACTION) SHALL BE INSTALLED IN THE CONCRETE CURB IN ALIGNMENT WITH THE JOINTS IN THE PAVEMENT.

THE PROPOSED CONFIGURATION OF THE CURB AND GUTTER SHALL MATCH THAT REMOVED.

THE LOCATION OF THE DOWEL BAR SHALL BE DETERMINED BY THE ENGINEER.

ALL EXISTING TIE BARS IN EDGE OF PAVEMENT SLAB THRU REPLACEMENT AREA SHALL BE CUT OFF.

THE WORK SHALL BE DONE IN ACCORDANCE WITH SECTION 602 OF THE STANDARD SPECIFICATIONS AND INCLUDES THE REMOVAL AND REPLACEMENT OF SOD, CONCRETE PAVEMENT AND/OR CURB AND GUTTER ADJACENT TO CATCH BASINS OR INLETS TO BE ADJUSTED OR RECONSTRUCTED AND SHALL BE INCLUDED IN THE PAY ITEM OF CATCH BASINS OR INLETS TO BE ADJUSTED OR RECONSTRUCTED AS SPECIFIED.

REVISED - 5-4-94

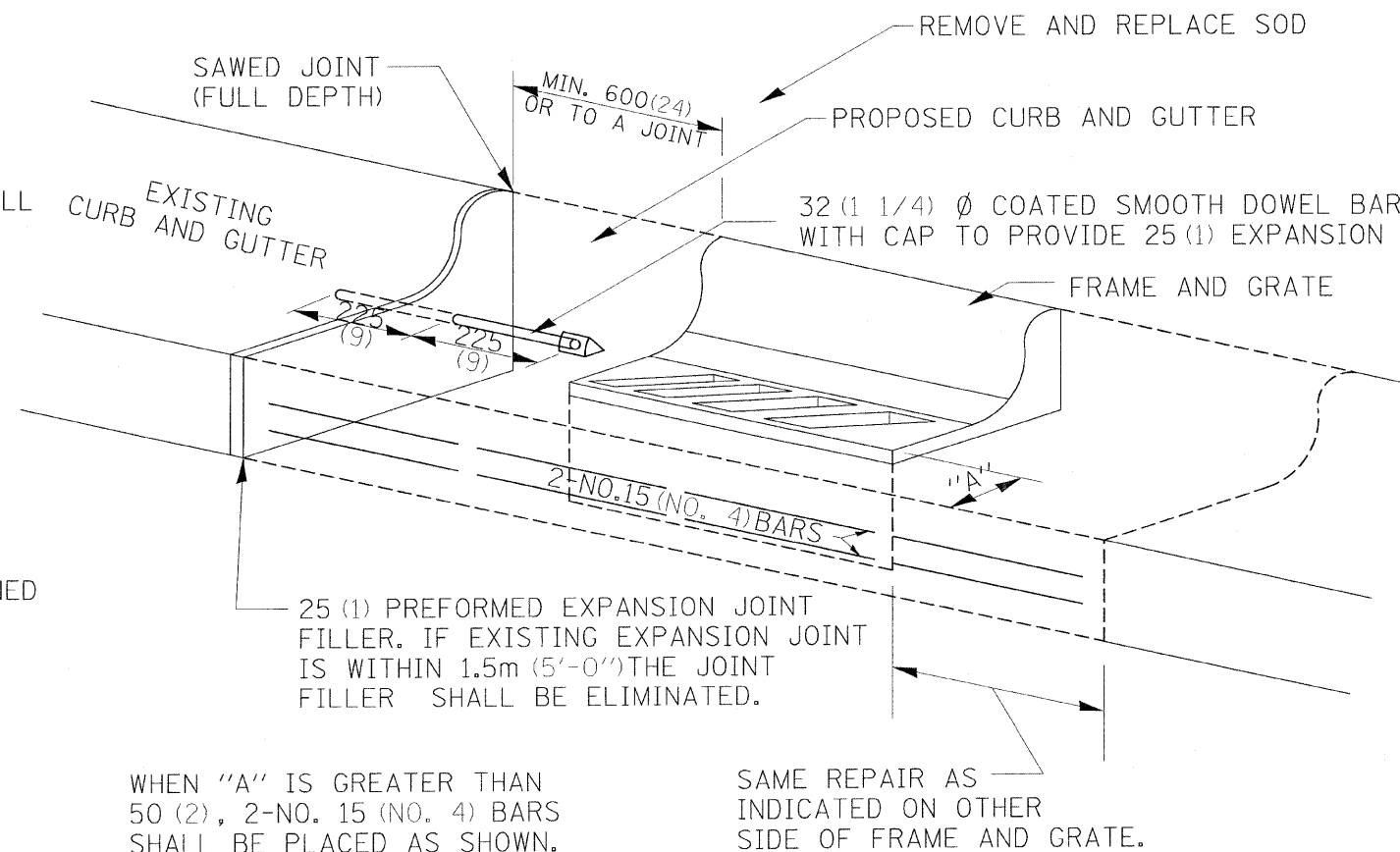

ALL DIMENSIONS ARE IN MILLIMETERS (INCHES) UNLESS OTHERWISE NOTED.

**WILLET, HOFMANN & ASSOCIATES, INC.**  
**CONSULTING ENGINEERS**  
 809 East Second Street Dixon, IL 61021  
 Phone 815.294.3381 Fax 815.294.3385  
 Design Firm # 184-00918  
 www.willett-hofmann.com

DESIGNED - BDF	REVISED -
DRAWN - JDH	REVISED -
CHECKED - BDF	REVISED -
DATE - 10/30/2009	REVISED -

**CITY OF ROCK FALLS, ILLINOIS**  
**12th AVE. - ROCK RIVER BRIDGE to W. 10th ST.**

**CATCH BASIN OR INLETS TO BE ADJUSTED OR RECONSTRUCTED, DS 17.4a**

F.A. RTE.	SECTION	COUNTY	TOTAL SHEETS	SHEET NO.
	09-00130-00-RS	WHITESIDE	21	17
FED. ROAD DIST. NO. - ILLINOIS FED. AID PROJECT			CONTRACT NO. 85499	

FILE NAME =

# TYPICAL PAVEMENT MARKINGS

## TYPICAL PAVEMENT MARKING FOR FLUSH MEDIAN AT LEFT TURN LANE

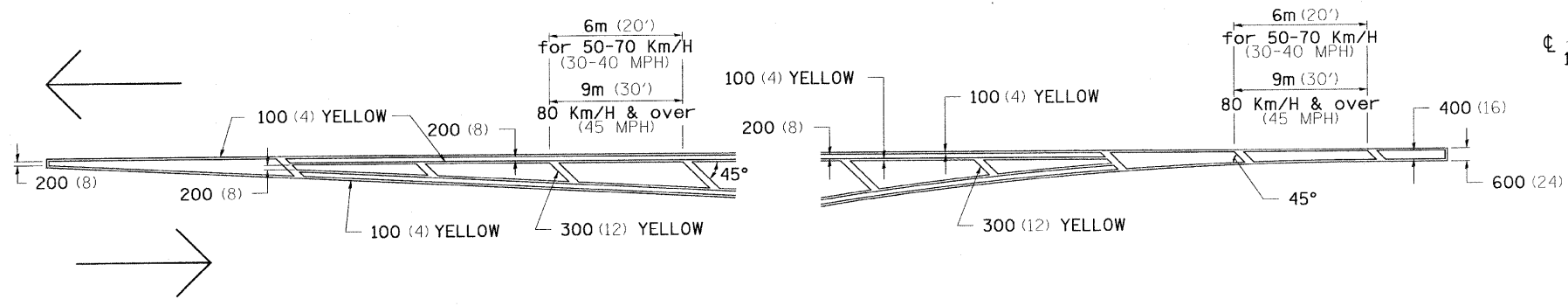

## MEDIAN PAVEMENT MARKING

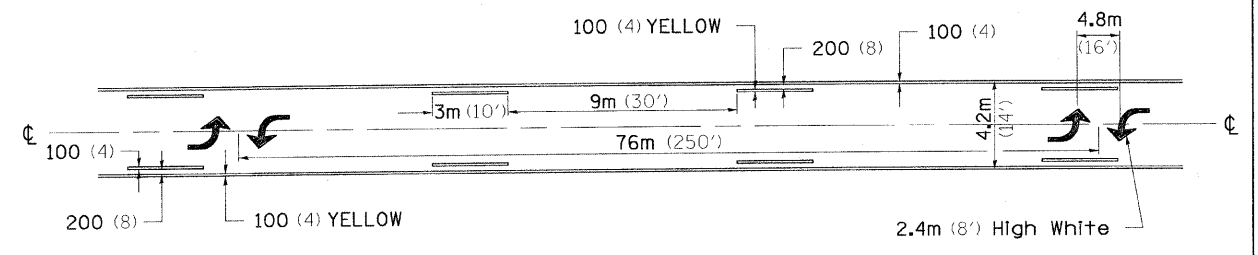

\*\* ALL DIMENSIONS ARE IN MILLIMETERS (INCHES) UNLESS OTHERWISE NOTED.

## TYPICAL ISLAND OFFSET SHOULDER WIDTH

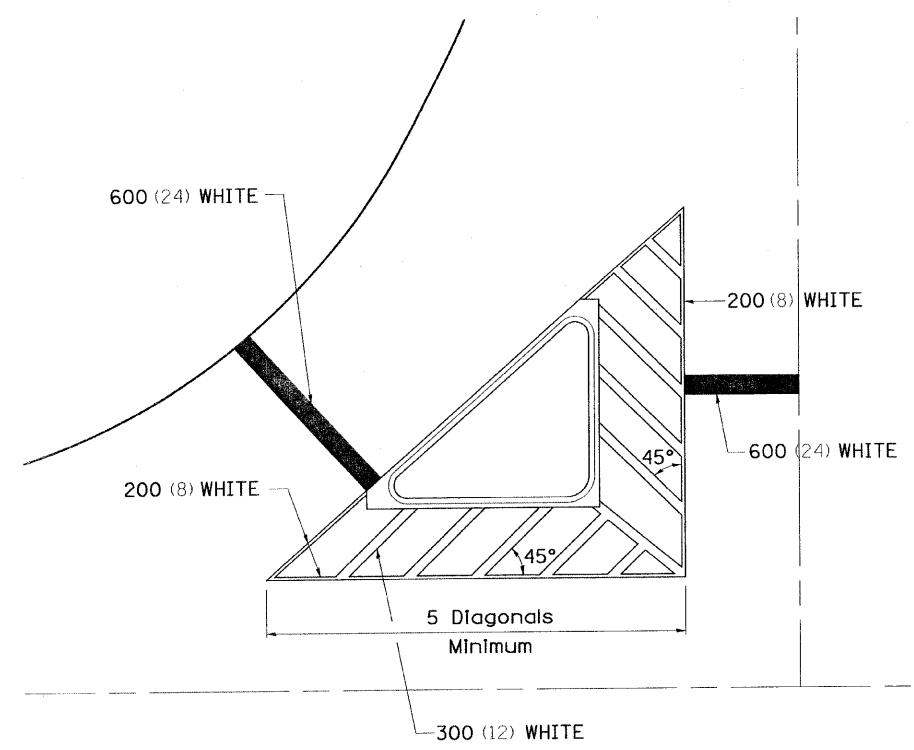

## TYPICAL PARKING SPACING

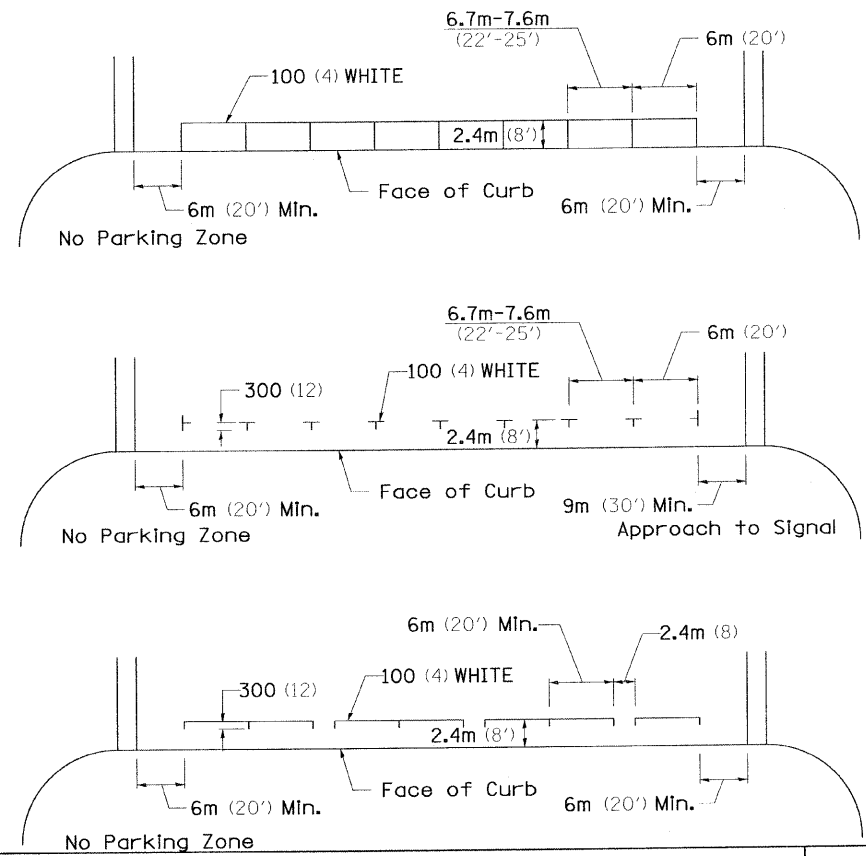

## STANDARD CROSSWALK MARKING

See Schedules for Locations

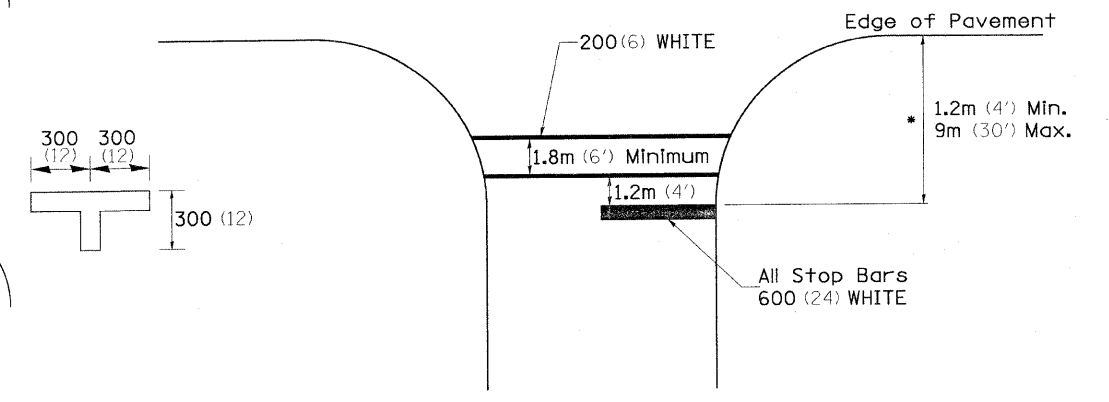

\* Distance to the nearest edge of the intersecting roadway in the absence of a marked crosswalk.

FILE NAME: L:\Job\2009\099\1025699\1025699\_Spec\1025699\_15th Ave Final Layout\_10.26.09.dgn

**WILLET, HOFMANN & ASSOCIATES, INC.**  
 CONSULTING ENGINEERS  
 609 East Second Street, Dixon, IL 61021  
 Phone: 815.284.3381 Fax: 815.284.3385  
 Design Firm # 184-00818  
 www.willett-hofmann.com

DESIGNED - BDF	REVISED -
DRAWN - JQH	REVISED -
CHECKED - BDF	REVISED -
DATE - 10/30/2009	REVISED -

**CITY OF ROCK FALLS, ILLINOIS**  
**12TH AVE. - ROCK RIVER BRIDGE to W. 10TH ST.**

### TYPICAL PAVEMENT MARKINGS, DS 41.1

SCALE: SHEET NO. 1 OF 3 SHEETS

F.A. RTE.	SECTION	COUNTY	TOTAL SHEETS	SHEET NO.
	09-00130-00-RS	WHITESIDE	21	18
FED. ROAD DIST. NO. ILLINOIS FED. AID PROJECT			CONTRACT NO. 85499	

# TYPICAL PAVEMENT MARKINGS

## ARROW LAYOUT

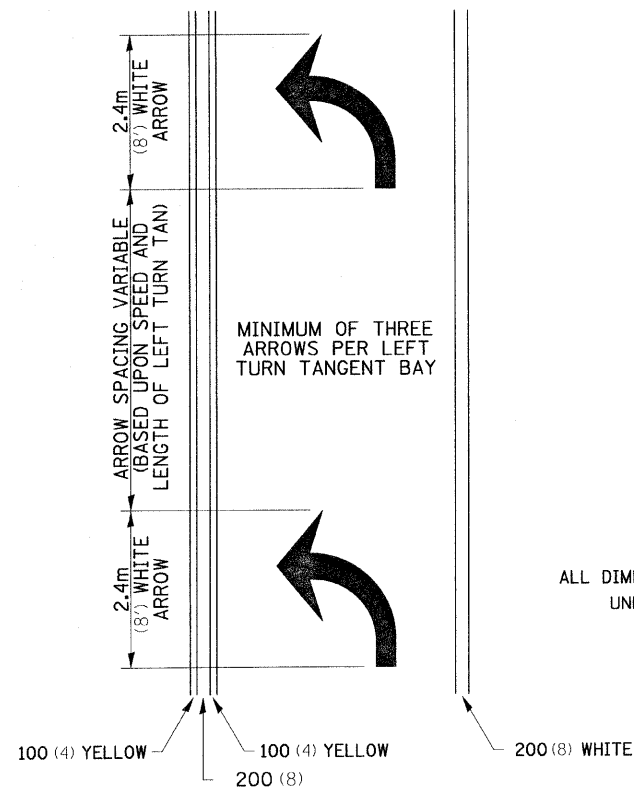

- ▲ ONE-WAY AMBER MARKER
- △ ONE-WAY CRYSTAL MARKER
- ◆ TWO-WAY AMBER MARKER

ALL DIMENSIONS ARE IN MILLIMETERS (INCHES) UNLESS OTHERWISE NOTED.

## TYPICAL PAVEMENT MARKING FOR FLUSH MEDIAN

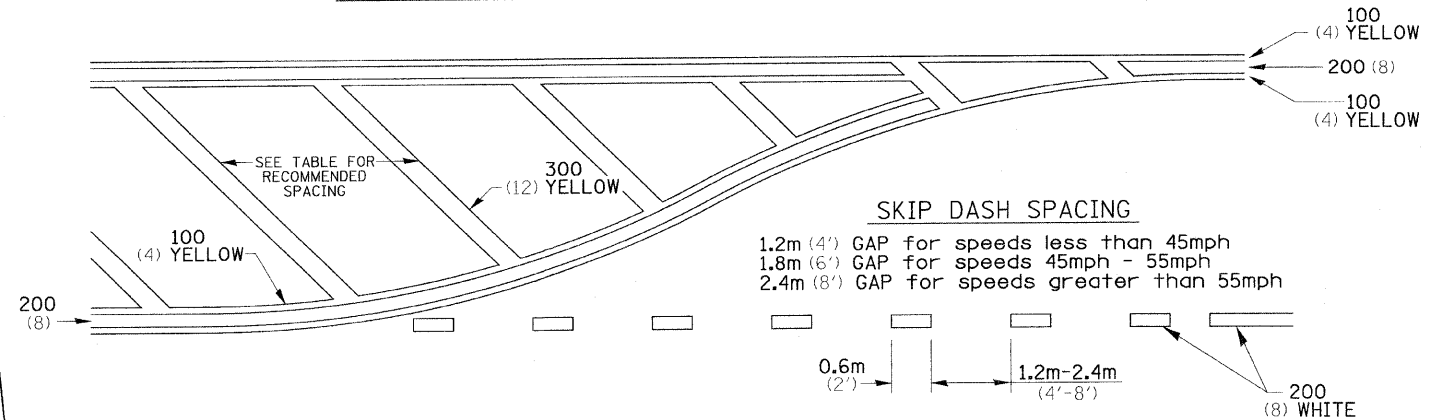

## RECOMMENDED SPACING BETWEEN DIAGONALS (IN FEET)

Speed Limit Range	Continuous Median Area	Intersection Channelization	Objects (Islands)
less than 50Km/H (30MPH)	15.3m (50')	4.53m (15')	3.05m (10')
50-60Km/H (30-40MPH)	22.9m (75')	6.1m (20')	4.53m (15')
70Km/H (45MPH) & over	22.9m (75')	9.05m (30')	6.1m (20')

NOTE: If the spacing recommended in the Table does not permit at least five diagonal lines in the area being marked, the spacing from the next lowest speed range should be used. The recommended spacing is measured parallel to the pavement center line.

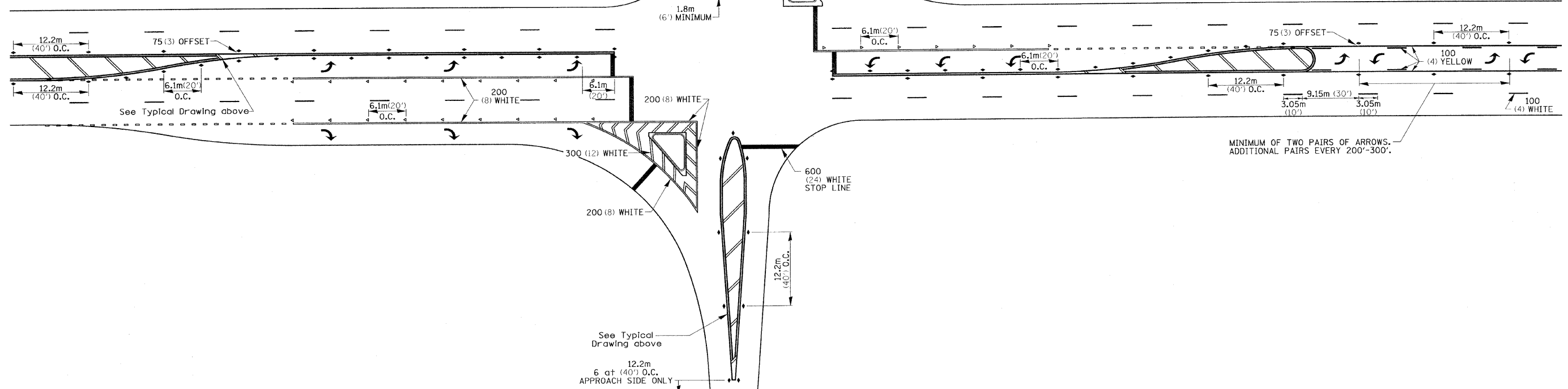

**WILLET, HOFMANN & ASSOCIATES, INC.**  
CONSULTING ENGINEERS  
809 East Second Street, Dixon, IL 61021  
Phone: 815.284.3381 Fax: 815.284.3385  
Design Firm # 184-00918  
www.willett-hofmann.com

DESIGNED - BDF	REVISED -
DRAWN - JDH	REVISED -
CHECKED - BDF	REVISED -
DATE - 10/30/2009	REVISED -

**CITY OF ROCK FALLS, ILLINOIS**  
**12TH AVENUE - ROCK RIVER BRIDGE to W. 10TH ST.**

**TYPICAL PAVEMENT MARKINGS, DS 41.1**

SCALE: SHEET NO. 2 OF 3 SHEETS

F.A. RTE.	SECTION	COUNTY	TOTAL SHEETS	SHEET NO.
	09-00130-00-RS	WHITESIDE	21	19
FED. ROAD DIST. NO. [ILLINOIS] FED. AID PROJECT				

FILE NAME

# TYPICAL PAVEMENT MARKINGS

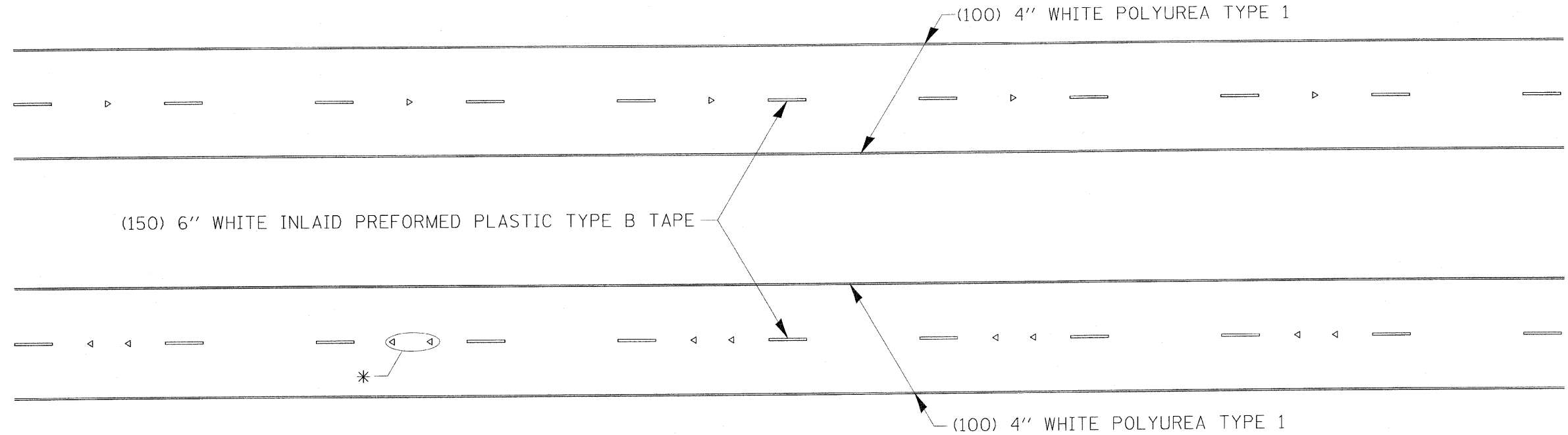

\* SEE HIGHWAY STANDARD 781001 FOR SPACING DETAILS.  
 USE DOUBLE MARKERS WHEN ADT ≥ 25,000.

## MULTI-LANE / DIVIDED

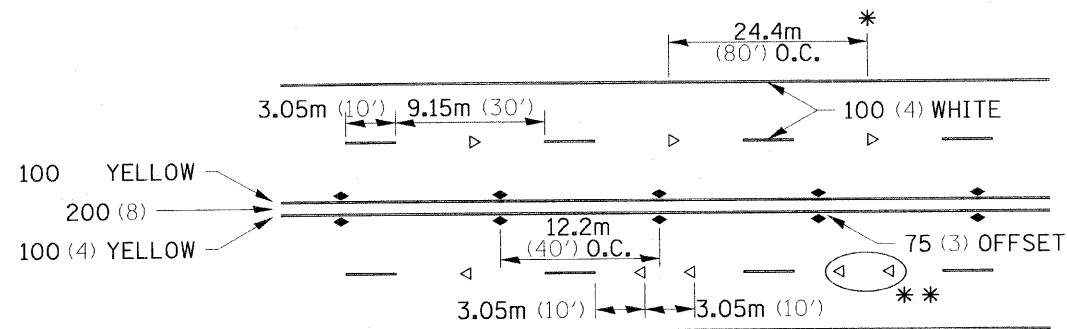

\* REDUCE TO 12.2m (40') O.C. ON CURVES WHERE ADVISORY SPEEDS ARE 15Km/H (10MPH) LOWER THAN POSTED SPEEDS.  
 \*\* USE DOUBLE MARKERS WHEN ADT ≥ 25,000

## MULTI-LANE / UNDIVIDED

### SYMBOLS

## TYPICAL PAVEMENT MARKING FOR TWO LANE SECTION – NO PASSING ZONES

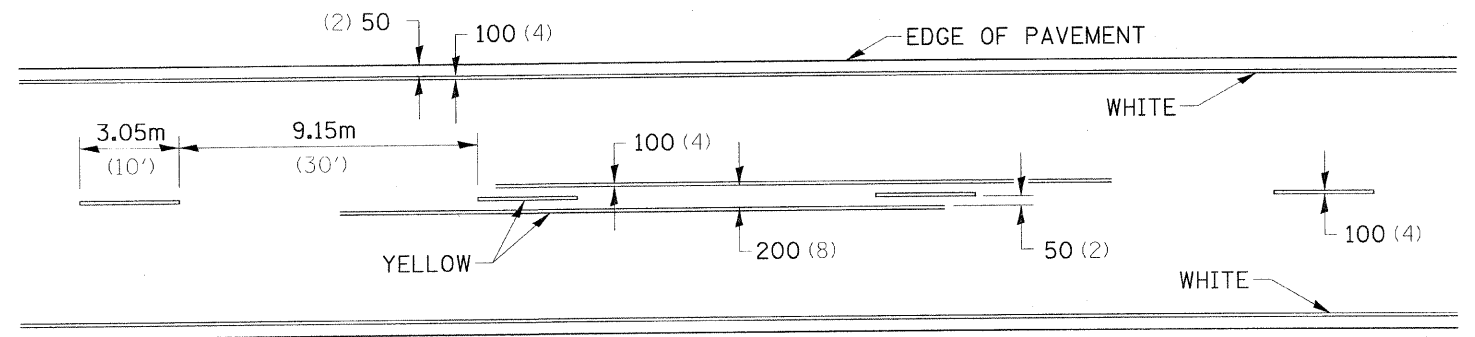

FILE NAME = L:\Jobs\2009\09\1035858\Star\16th Avenue\16th Ave Final Layout 10.26.09.dgn

**WILLET, HOFMANN & ASSOCIATES, INC.**  
**CONSULTING ENGINEERS**  
 809 East Second Street, Dixon, IL 61021  
 Phone 815.284.3381 Fax 815.284.3385  
 Design Firm 184-00918  
 www.willett-hofmann.com

DESIGNED - BDF	REVISED -
DRAWN - JDH	REVISED -
CHECKED - BDF	REVISED -
DATE - 10/30/2009	REVISED -

**CITY OF ROCK FALLS, ILLINOIS**  
**12TH AVENUE – ROCK RIVER BRIDGE to W. 10TH ST.**

**TYPICAL PAVEMENT MARKINGS, DS 41.1**

SCALE: SHEET NO. 3 OF 3 SHEETS

F.A. RTE.	SECTION	COUNTY	TOTAL SHEETS	SHEET NO.
	09-00147-00-RS	WHITESIDE	21	20
FED. ROAD DIST. NO. _ ILLINOIS FED. AID PROJECT			CONTRACT NO. 85499	

# ROUGH GROOVED SURFACE SIGN

ILLINOIS STANDARD W8-I107

SIGN PANEL TYPE 1



COLOR: LEGEND AND BORDER - BLACK NON-REFLECTIVE  
BACKGROUND - ORANGE REFLECTORIZED

SIGN SIZE	DIMENSIONS							
	A	B	C	D	E	F	G	H
1200x1200 (48x48)	1200 (48.0)	600 (24.1)	75 (3.0)	850 (34.0)	825 (33.0)	150 (6.0)	325 (13.0)	88 (3.5)

SIGN SIZE	SERIES			MARGIN	BORDER	BLANK STD.
	LINES					
	1	2	3			
1200x1200 (48x48)	7C	7C	7C	20 (0.8)	30 (1.2)	B4-48D

ALL DIMENSIONS IN INCHES.

REVISED - 1-09-08

### GENERAL NOTES

SIGN PANELS AND FACE MATERIALS SHALL BE ACCORDING TO SECTION 720 OF THE STANDARD SPECIFICATIONS  
METAL POSTS SHALL BE IN ACCORDANCE WITH STD. 720011.

ALL MOUNTING HARDWARE SHALL BE ALUMINUM, STAINLESS STEEL, ZINC OR CADMIUM PLATED STEEL AND SHALL BE INCLUDED TO THE COST OF THE INSTALLATION.

ALL DIMENSIONS ARE IN MILLIMETERS (INCHES) UNLESS OTHERWISE NOTED.

FILE NAME



**WILLETT, HOFMANN & ASSOCIATES, INC.**  
CONSULTING ENGINEERS  
809 East Second Street Dixon, IL 61021  
Phone 815.284.3381 Fax 815.284.3385  
Design Firm # 184-00518  
www.willett-hofmann.com

DESIGNED - BDF	REVISED -
DRAWN - JDH	REVISED -
CHECKED - BDF	REVISED -
DATE - 10/30/2009	REVISED -

**CITY OF ROCK FALLS, ILLINOIS**  
**12TH AVENUE - ROCK RIVER BRIDGE to W. 10th STREET**

**ROUGH GROOVED SURFACE SIGN, DS 91.2**  
SCALE: SHEET NO. 1 OF 1 SHEETS

F.A. RTE.	SECTION	COUNTY	TOTAL SHEETS	SHEET NO.
	09-00130-00-RS	WHITESIDE	21	21
FED. ROAD DIST. NO. ILLINOIS FED. AID PROJECT			CONTRACT NO. 85499	