

ROUTE NO.	SECTION	COUNTY	TOTAL SHEETS	SHEET NO.
R. B. I.	F. A. A.	LEE	35	21
FED. ROAD DIST. NO. 7		ILLINOIS	FED. AID PROJECT-	

\* Section 03-00160-00-PV Contract #85503

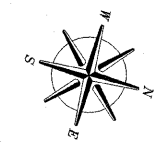
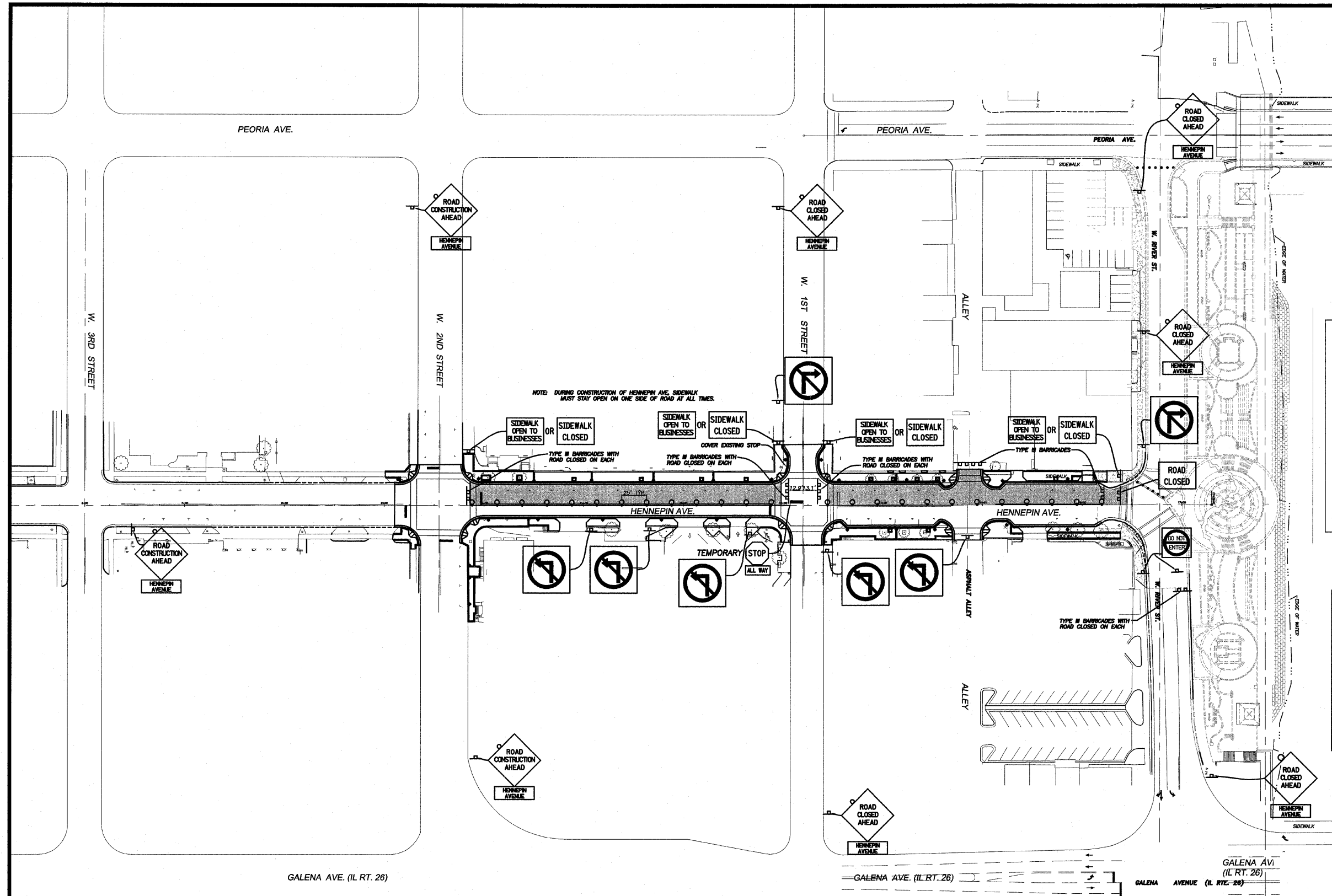

**GENERAL NOTES**

1. CONTRACTOR SHALL ALLOW TEMPORARY OPENINGS IN CONSTRUCTION FENCE TO ALLOW ACCESS TO LOCAL BUSINESSES AND CROSSWALKS.
2. CONTRACTOR TO MAINTAIN VEHICULAR & PEDESTRIAN ACCESS TO LOCAL BUSINESSES AT ALL TIMES - SEE SPECIAL PROVISIONS.
3. EAST TO WEST SIDEWALK CLOSURES ARE RESTRICTED TO ONE SIDE AT A TIME.

**LEGEND**

- Work area
- Sign
- Type III Barricades
- Drum with steady burning light

**SIGN LEGEND**

SIDEWALK CLOSED R11-1101-2418	ROAD CONSTRUCTION AHEAD W20-1(10)-48	ROAD CLOSED AHEAD W20-3(10)-48	RIVER STREET R3-1-2424	W. FIRST STREET R3-2-2424	W. 3RD STREET R11-2	ROAD CLOSED TO THRU TRAFFIC R11-4 36"x24"	HENNEPIN AVENUE CUSTOM 24"x18"	W. 2ND STREET CUSTOM 24"x18"
STOP R1-1	ALL WAY R1-4	ROAD CLOSED R11-2	W. 1ST STREET CUSTOM 24"x18"	W. 3RD STREET CUSTOM 24"x18"	W. 2ND STREET CUSTOM 24"x18"	DO NOT ENTER R5-1	W. 1ST STREET CUSTOM 24"x18"	W. 2ND STREET CUSTOM 24"x18"

**PHASE I QUANTITIES**

70300220	TEMPORARY PAVEMENT MARKING - LINE 4"			
	LOCATION	COLOR	FOOT	
	STA. 9+96 - STA. 12+98	WHITE	312	
	STA. 13+45 - STA. 16+44	WHITE	299	
				TOTAL 611 FOOT
70300280	TEMPORARY PAVEMENT MARKING - LINE 24"			
	LOCATION	COLOR	FOOT	
	LT. STA. 13+07 - LT. STA. 13+20	WHITE	13	
				TOTAL 13 FOOT

**PHASE 1**

**TRAFFIC CONTROL PLAN**

HENNEPIN AVE.  
SECTION 03-00160-00-PV  
CITY OF DIXON

**wendler**  
GROUND BREAKING SOLUTIONS  
engineers - surveyors - scientists

Date: 09/24/2009  
Job: 2090205  
www.wendlers.com ph. 815.288.2281