

F.A.S. ROUTE NO.	SECTION	ILLINOIS PROJECT	CONTRACT NO.	COUNTY	TOTAL SHEETS	SHEET NUMBER
268	06-00173-00-SW		87359	LASALLE	15	13

F.A.S. 268 - MAIN STREET
SECTION 06-00173-00-SW
CITY OF MARSEILLES, LASALLE COUNTY

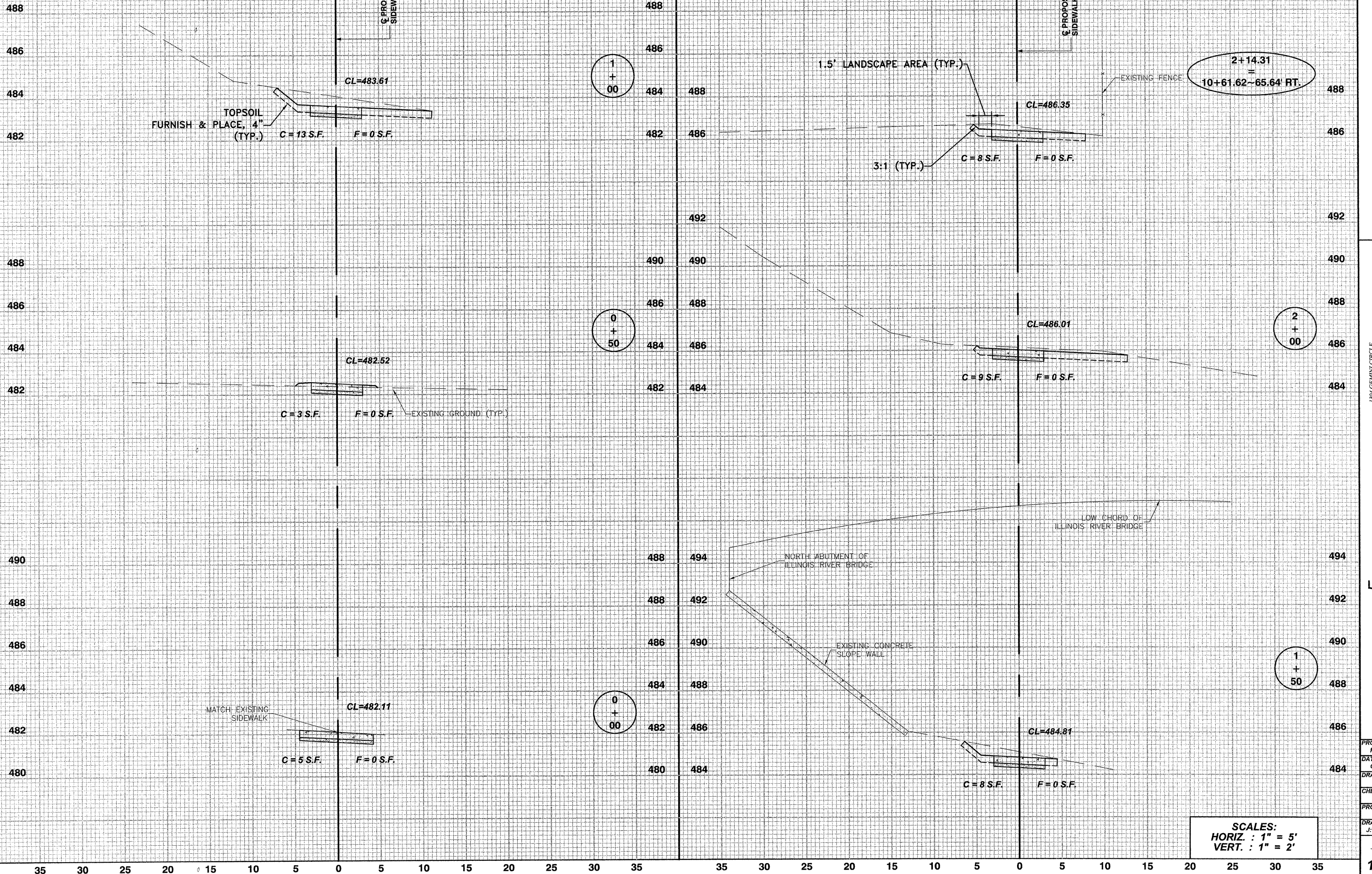

1304 GEMINI CIRCLE
 OTTAWA, IL 61350-1692
 TEL: 815-434-3925
 FAX: 815-434-3933

E. TSCHIED
DUTTLINGER & ASSOCIATES INC.
 Professional Engineers & Land Surveyors

PROFESSIONAL DESIGN
 FIRM # 184-000711
 DATE PLOTTED:
 OCTOBER 21, 2009
 DRAWN BY:
 R.M.S.
 CHECKED BY:
 PROJECT NUMBER:
 2057.92
 DRAWING FILE:
 J:\205792_XSEC.DWG

SCALES:
 HORIZ. : 1" = 5'
 VERT. : 1" = 2'

SIDEWALK CROSS SECTIONS ~ 0+00 (SW) TO 2+14 = 10+61