

- VERTICALLY TRANSITION GUARDRAIL 1" PER 12'-6" GUARDRAIL SECTION (TOTAL DROP = ±4")
- DETERMINE INVERT ELEVATION IN FIELD BEFORE ORDERING MATERIALS
- GUARDRAIL CONNECTION DETAIL (SEE SHEET 2)

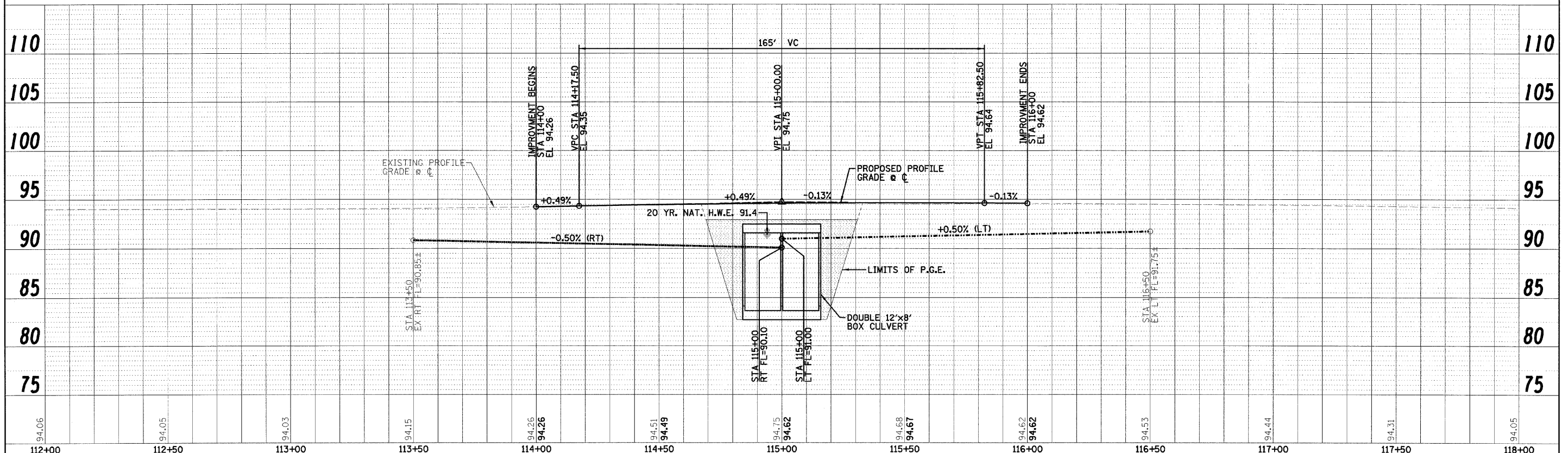
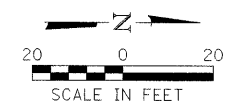

| | |
|-----------------|-----------|
| DESIGNED - JML | REVISED - |
| DRAWN - DRR | REVISED - |
| CHECKED - MSW | REVISED - |
| DATE - 10/21/09 | REVISED - |

LIVINGSTON COUNTY DEPARTMENT OF HIGHWAYS

PLAN & PROFILE
SCALE: SHEET NO. 8 OF 34 SHEETS STA. 112+00 TO STA. 118+00

WESTON ROAD (C.H. 10) OVER HICKORY CREEK
SECTION 09-00120-03-BR
LIVINGSTON COUNTY

| | | | | |
|---------------------|----------------|---------------------------|--------------|-----------|
| F.A.S. | SECTION | COUNTY | TOTAL SHEETS | SHEET NO. |
| 349 | 09-00120-03-BR | LIVINGSTON | 34 | 8 |
| S.N. 053-5015 | | CONTRACT NO. 87412 | | |
| FED. ROAD DIST. NO. | | ILLINOIS FED. AID PROJECT | | |

PLAN SURVEYED BY DATE
NOTE BOOK NO.
ALTIMETER CHECKED BY DATE
RT. OF WAY CHECKED BY DATE
ROAD FILE NAME

PROFILE SURVEYED BY DATE
NOTE BOOK NO.
GRADE CHECKED BY DATE
STRUCTURE NOTATIONS CRVD