

FINAL SURVEY	DATE
SURVEYED	BY
PLOTTED	
NOTE BOOK	
AREAS CHECKED	
NO.	

ORIGINAL SURVEY	DATE
SURVEYED	BY
PLOTTED	
NOTE BOOK	
AREAS CHECKED	
NO.	

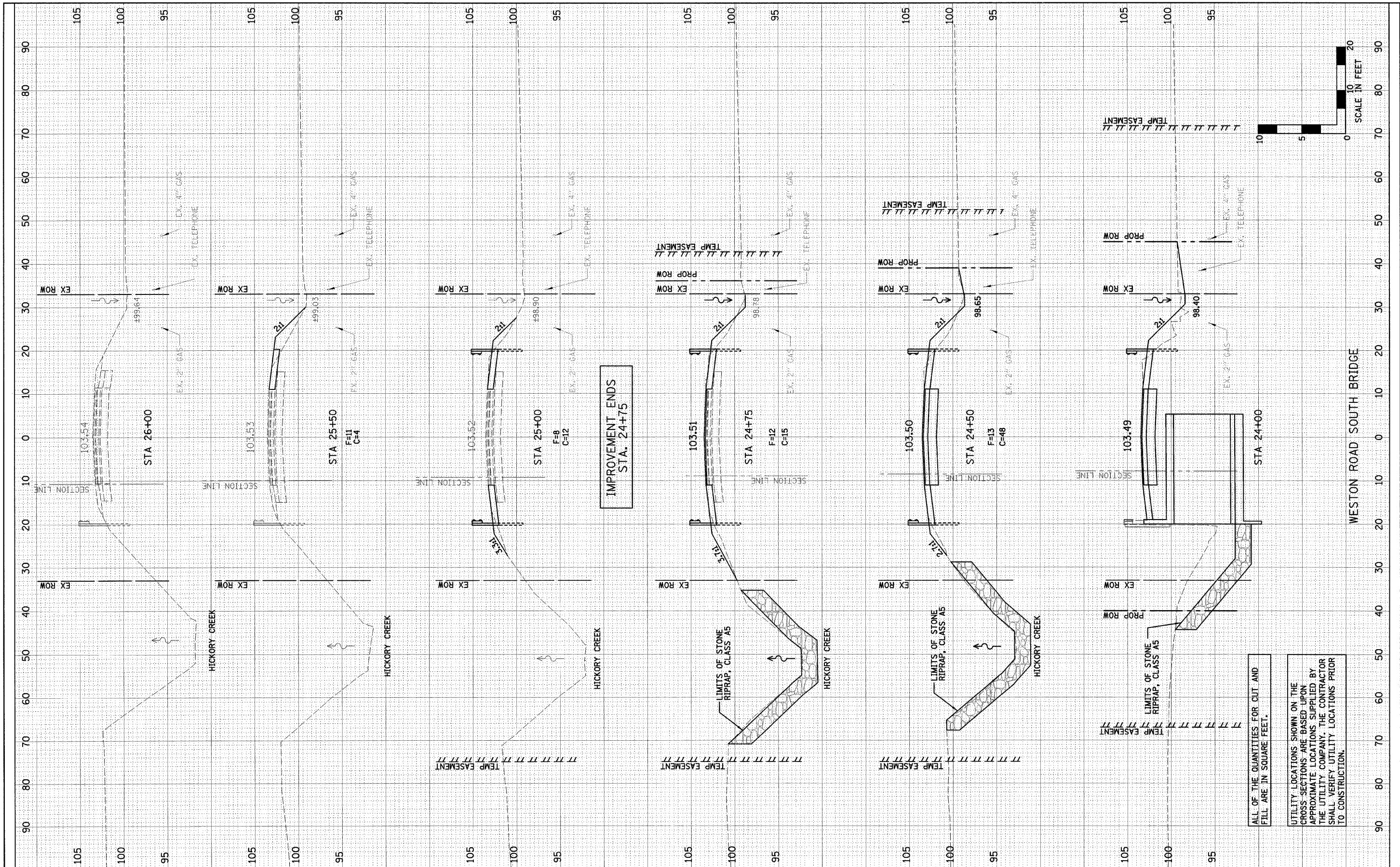

DESIGNED - JML	REVISED -
DRAWN - DRR	REVISED -
CHECKED - MSW	REVISED -
DATE - 10/21/09	REVISED -

LIVINGSTON COUNTY DEPARTMENT OF HIGHWAYS

CROSS SECTIONS		
SCALE:	SHEET NO. 32 OF 34 SHEETS	STA. 24+00 TO STA. 26+00

WESTON ROAD (C.H. 10) OVER HICKORY CREEK
SECTION 09-00120-03-BR
LIVINGSTON, COUNTY

F.A.S.	SECTION	COUNTY	TOTAL SHEETS	SHEET NO.
349	09-00120-03-BR	LIVINGSTON	34	32
FED. ROAD DIST. NO. 7 ILLINOIS FED. AID PROJECT				CONTRACT NO. 87412

ALL OF THE QUANTITIES FOR CUT AND FILL ARE IN SQUARE FEET.

UTILITY LOCATIONS SHOWN ON THE CROSS-SECTIONS ARE BASED UPON APPROXIMATE LOCATIONS SUPPLIED BY THE UTILITY COMPANY. THE CONTRACTOR SHALL VERIFY UTILITY LOCATIONS PRIOR TO CONSTRUCTION.