

**LEGEND**

- |   |  |
|---|--|
| <ul style="list-style-type: none"> <li>☼-○-☼ PROPOSED ORNAMENTAL LIGHTING UNIT COMPLETE</li> <li>☼-○-☼ EXISTING LIGHT</li> <li>□ EXISTING BURIED WIRING JUNCTION BOX</li> <li>○ EXISTING CATCH BASIN</li> <li>○ EXISTING UTILITY POLE</li> <li>○ EXISTING INLET</li> <li>○ EXISTING MANHOLE</li> <li>G EXISTING GAS</li> <li>W EXISTING WATER</li> <li>A B C DECORATIVE LIGHT TYPE A</li> <li>DECORATIVE LIGHT TYPE B</li> <li>DECORATIVE LIGHT TYPE C</li> </ul> | <ul style="list-style-type: none"> <li>T EXISTING TELEPHONE</li> <li>E EXISTING ELECTRICAL</li> <li>G EXISTING GAS</li> <li>OE EXISTING OVERHEAD ELECTRICAL</li> <li>EXISTING R.O.W.</li> <li>EXISTING PIPE CULVERT</li> <li>EXISTING STORMSEWER</li> <li>EXISTING SANITARY SEWER</li> </ul> |
|---|--|
- \* REMOVAL OF LUMINAIRE, SALVAGE & LUMINAIRE, HIGH PRESSURE SODIUM SPECIAL (310 WATT)

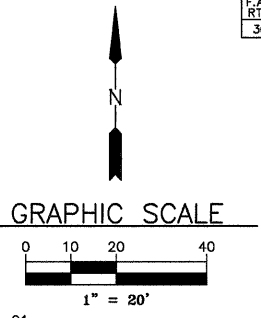

LIGHT NO. 18  
(PROPOSED)  
STA. 132+06  
24' LT.

LIGHT NO. 19  
(PROPOSED)  
STA. 133+40  
24' LT.

LIGHT NO. 20  
(PROPOSED)  
STA. 135+00  
24' LT.

LIGHT NO. 21  
(EXISTING)  
STA. 136+03  
23' LT.

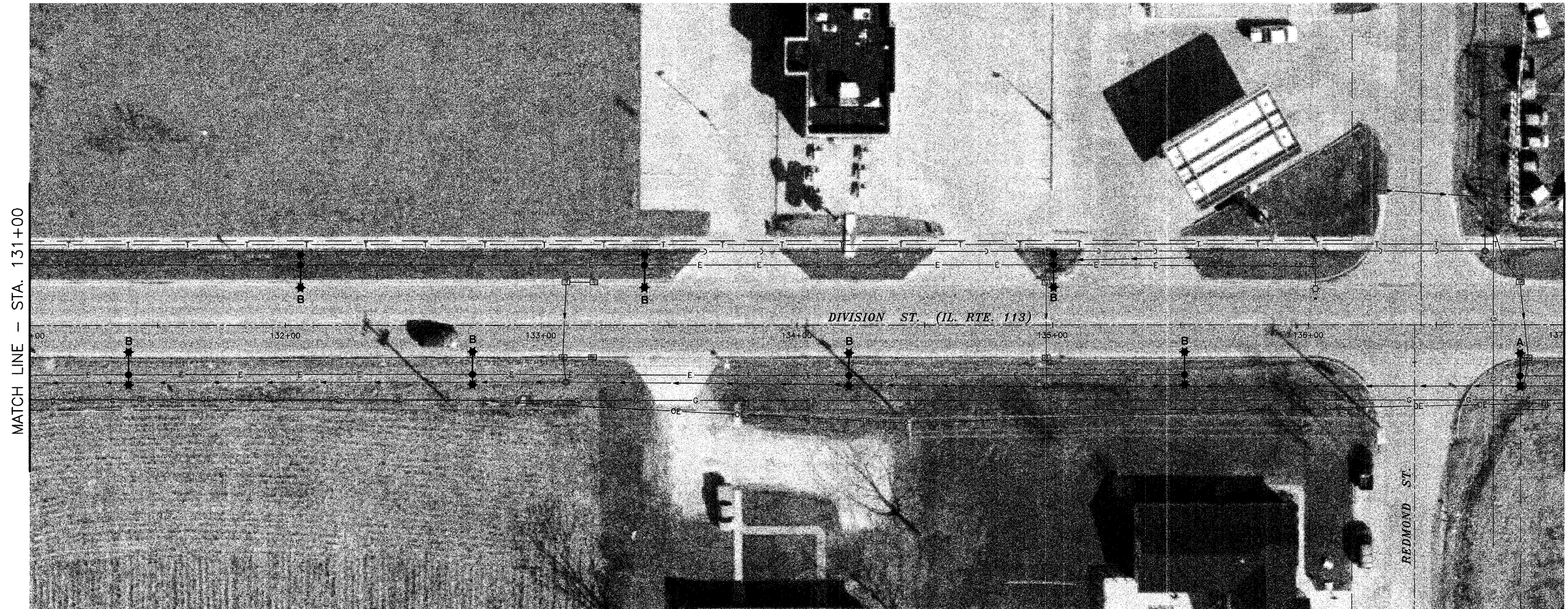

MATCH LINE - STA. 131+00

MATCH LINE - STA. 137+00

LIGHT NO. 55  
(PROPOSED)  
STA. 131+39  
19' RT.

LIGHT NO. 56  
(PROPOSED)  
STA. 132+73  
19' RT.

LIGHT NO. 57  
(PROPOSED)  
STA. 134+20  
20' RT.

LIGHT NO. 58  
(PROPOSED)  
STA. 135+52  
19' RT.

LIGHT NO. 59  
(PROPOSED)  
STA. 136+83  
20' RT.

NOTE: AERIAL PHOTOGRAPHS SUPPLIED BY THE SIDWELL COMPANY

DRAWN BY: RGP/JMT  
CHECKED BY: MWP/DJD

6978-00  
CAD/DWG: P131-137  
BASE  
DATE: 09-24-09

REVISIONS	
DATE	BY



PERU MORRIS  
ILLINOIS

**VILLAGE OF DIAMOND  
DIVISION STREET LIGHTING IMPROVEMENTS - 2010**

**PLAN SHEET - STA. 131+00 TO STA. 137+00**

SCALE: AS NOTED

SHEET 8

FILE NO.: 6978-00

OF 12