

**WEST CURB LINE OF APPROACH SLAB**

Location	Station	Offset	Theoretical Grade Elevations
End S. App. Pvmt.	3927.42	-18.00	608.69
A	3937.42	-18.00	608.85
B	3947.42	-18.00	609.02
Bk. S. Abutment	3957.42	-18.00	609.18

**WEST EDGE OF ROADWAY PAVEMENT**

Location	Station	Offset	Theoretical Grade Elevations
End S. App. Pvmt.	3927.42	-12.00	608.93
A	3937.42	-12.00	609.05
B	3947.42	-12.00	609.18
Bk. S. Abutment	3957.42	-12.00	609.30

**☉ ROADWAY & PROFILE GRADE**

Location	Station	Offset	Theoretical Grade Elevations
End S. App. Pvmt.	3927.42	0.00	609.11
A	3937.42	0.00	609.24
B	3947.42	0.00	609.36
Bk. S. Abutment	3957.42	0.00	609.49

**EAST EDGE OF ROADWAY PAVEMENT**

Location	Station	Offset	Theoretical Grade Elevations
End S. App. Pvmt.	3927.42	12.00	608.93
A	3937.42	12.00	609.05
B	3947.42	12.00	609.18
Bk. S. Abutment	3957.42	12.00	609.30

**EAST CURB LINE OF APPROACH PAVEMENT**

Location	Station	Offset	Theoretical Grade Elevations
End S. App. Pvmt.	3927.42	18.00	608.69
A	3937.42	18.00	608.85
B	3947.42	18.00	609.02
Bk. S. Abutment	3957.42	18.00	609.18

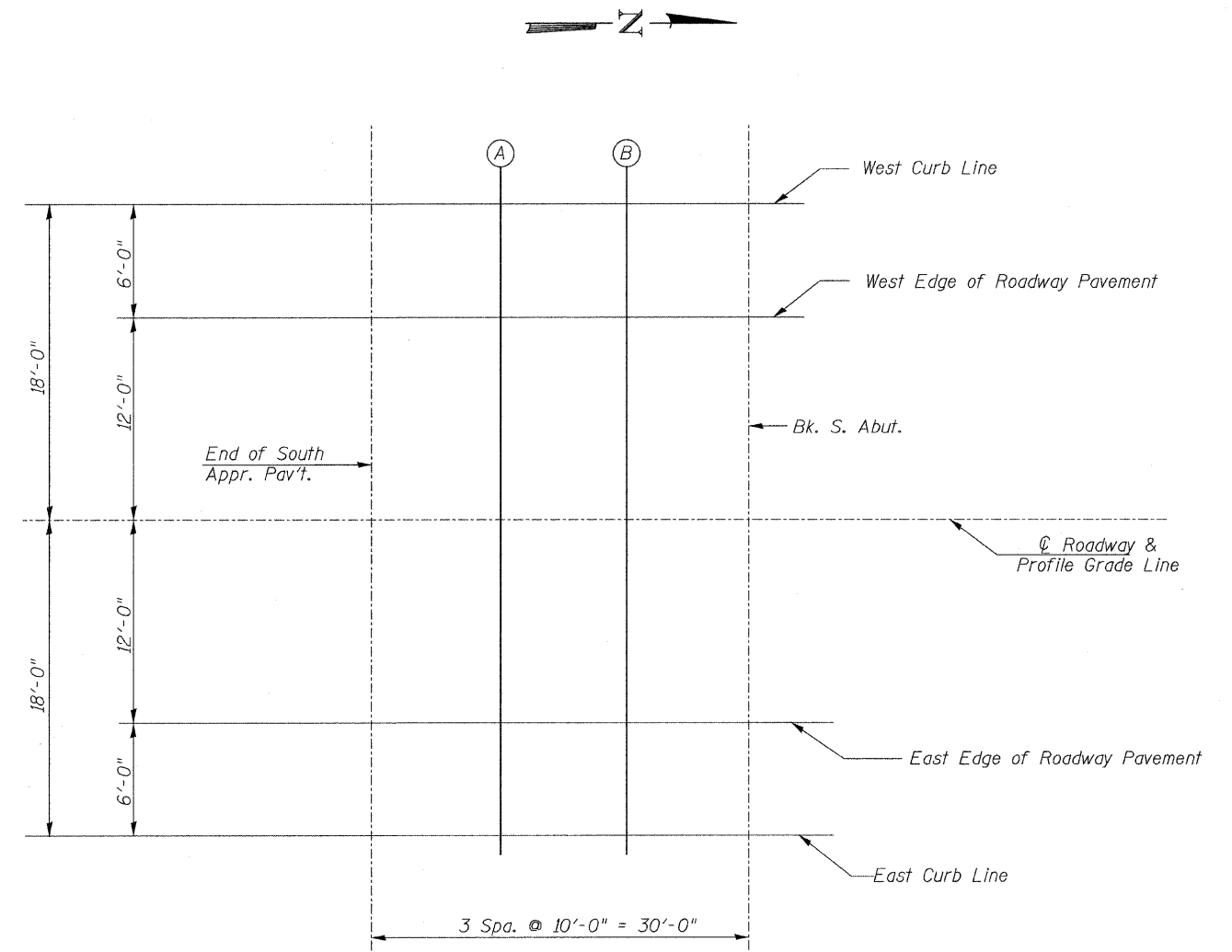

**PLAN SOUTH APPROACH PAVEMENT**

**TOP OF SOUTH APPROACH SLAB ELEVATIONS**

SHEET NO. 5 21 SHEETS	ROUTE NO.	SECTION	COUNTY	TOTAL SHEETS	SHEET NO.
	CH 29	10-00649-00-BR	LASALLE	43	12
S.N. 050-3593			CONTRACT NO. 87430		
FED. ROAD DIST. NO. 7		ILLINOIS	FED. AID PROJECT BRS-0099(043)		