

NOTE: ALL PRIVATE ENTRANCES, MAIL BOX TURNOUTS AND SIDE ROAD INTERSECTIONS SHALL BE PAID FOR AS INCIDENTAL HOT-MIX ASPHALT SURFACING TOTAL 614 TON.

NOTE: AGGREGATE AROUND ALL PRIVATE ENTRANCES, MAIL BOX TURNOUTS, SIDE ROAD INTERSECTIONS, AND FIELD ENTRANCES SHALL BE CONSIDERED INCIDENTAL TO AGGREGATE SHOULDERS, TYPE B AND PLACED AS DIRECTED BY THE ENGINEER.

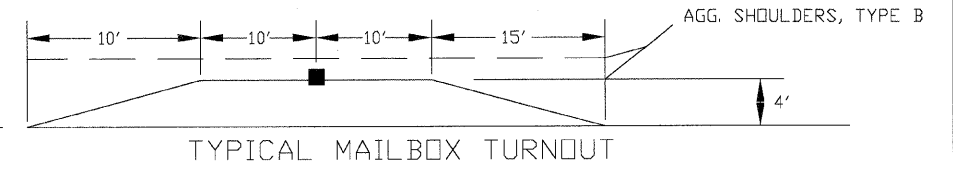

TYPICAL MAILBOX TURNOUT

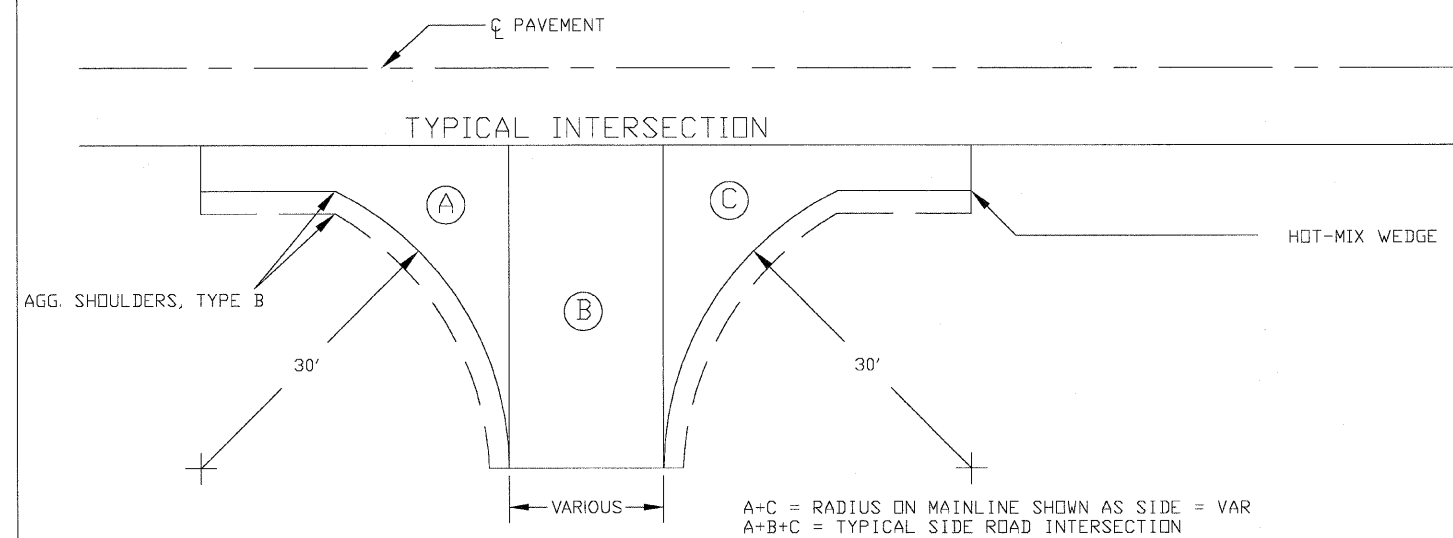

TYPICAL INTERSECTION

TYPICAL PRIVATE & FIELD ENTRANCES

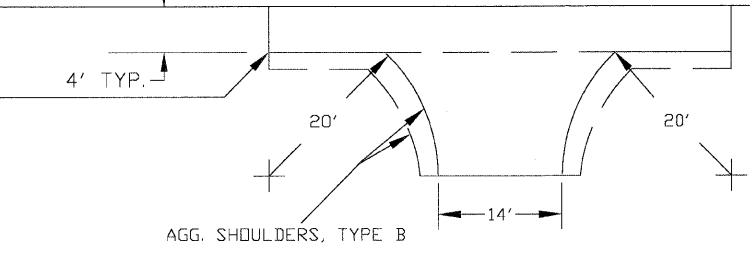

TYPICAL MAILBOX TURNOUT

TYPICAL PRIVATE ENTRANCES

STATION	SIDE	SQ. YD	TON	STATION	SIDE	SQ. YD	TON
3+51	LT	15	5	161+91	RT	15	5
3+74	LT	15	5	192+77	RT	15	5
17+09	LT	15	5	240+66	RT	15	5
18+60	LT	15	5	245+00	RT	15	5
34+40	LT	15	5	269+30	RT	15	5
52+51	LT	15	5	279+92	RT	15	5
136+08	LT	15	5	286+45	RT	15	5
TOTAL = 70 TONS							

STATION	RT/LT	TYPE	PROPOSED	SQ. YD.	TON	STATION	RT/LT	TYPE	PROPOSED	SQ. YD.	TON
*1+60	LT	PE	HMA	65	10	**18+15	LT	PE	HMA	57	8
*1+80	RT	PE	HMA	15	4	18+33	RT	PE	HMA	57	8
3+76	RT	PE	HMA	57	8	34+20	LT	PE	HMA	57	8
**3+97	LT	PE	HMA	20	5	52+49	RT	PE	HMA	57	8
5+29	RT	PE	HMA	57	8	*106+10	RT	PE	HMA	57	8
**5+84	LT	PE	HMA	20	5	*135+94	LT	PE	HMA	57	8
6+85	RT	PE	HMA	57	8	*150+83	LT	PE	HMA	15	4
**8+10	LT	PE	HMA	20	5	*163+41	RT	PE	HMA	57	8
8+37	RT	PE	HMA	57	8	192+66	RT	PE	HMA	57	8
**9+62	LT	PE	HMA	20	5	240+66	LT	PE	HMA	57	8
10+13	RT	PE	HMA	57	8	***243+77	LT	PE	HMA	89	15
10+52	LT	PE	HMA	20	5	***246+13	LT	PE	HMA	128	22
11+88	LT	PE	HMA	20	5	***248+25	LT	PE	HMA	211	36
11+95	RT	PE	HMA	57	8	269+10	RT	PE	HMA	57	8
12+37	LT	PE	HMA	20	5	279+92	LT	PE	HMA	57	8
13+41	RT	PE	HMA	57	8	*282+10	RT	PE	HMA	15	4
13+95	RT	PE	HMA	57	8	*282+20	LT	PE	HMA	15	4
14+22	LT	PE	HMA	20	5	*282+50	RT	PE	HMA	15	4
15+35	LT	PE	HMA	20	5	*282+62	LT	PE	HMA	15	4
15+40	RT	PE	HMA	57	8	287+23	RT	PE	HMA	57	4
17+09	LT	PE	HMA	57	8						
TOTAL = 324 TONS											

TYPICAL INTERSECTION - SIDE ROADS

STATION	SIDE	WIDTH	SQ. YD.	TON
33+00 RT	500N 1300E	18'	138	18
33+00 LT	500N 1300E	20'	167	22
90+47 RT	500N 1400E	24'	200	30
90+47 LT	500N 1400E	20'	167	22
143+82 RT	500N 1500E	20'	167	22
143+82 LT	500N 1500E	18'	138	18
196+60 RT	500N 1600E	20'	167	25
196+60 LT	500N 1600E	24'	200	30
222+88 RT	500N 1650E	18'	138	18
222+88 LT	500N 1650E	14'	107	15
TOTAL = 220 TONS				

\* THESE ENTRANCES SHALL RECEIVE ONLY A FOUR FOOT PAVED APRON.  
 \*\* THESE ENTRANCES SHALL RECEIVE ONLY A SEVEN FOOT PAVED APRON.  
 \*\*\* THESE ENTRANCES SHALL RECEIVE ONLY A TEN FOOT PAVED APRON.