

**LEGEND**

- |   |  |
|---|--|
| <ul style="list-style-type: none"> <li>☼-○-☼ PROPOSED ORNAMENTAL LIGHTING UNIT COMPLETE</li> <li>☼-○-☼ EXISTING LIGHT</li> <li>□ EXISTING BURIED WIRING JUNCTION BOX</li> <li>○ EXISTING CATCH BASIN</li> <li>○ EXISTING UTILITY POLE</li> <li>○ EXISTING INLET</li> <li>○ EXISTING MANHOLE</li> <li>○ EXISTING GAS</li> <li>○ EXISTING WATER</li> <li>A DECORATIVE LIGHT TYPE A</li> <li>B DECORATIVE LIGHT TYPE B</li> <li>C DECORATIVE LIGHT TYPE C</li> </ul> | <ul style="list-style-type: none"> <li>—T— EXISTING TELEPHONE</li> <li>—E— EXISTING ELECTRICAL</li> <li>—G— EXISTING GAS</li> <li>—OE— EXISTING OVERHEAD ELECTRICAL</li> <li>— EXISTING R.O.W.</li> <li>--- EXISTING PIPE CULVERT</li> <li>— EXISTING STORMSEWER</li> <li>— EXISTING SANITARY SEWER</li> </ul> |
|---|--|

\* REMOVAL OF LUMINAIRE, SALVAGE & LUMINAIRE, HIGH PRESSURE SODIUM SPECIAL (310 WATT)

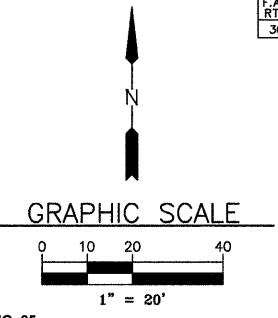

LIGHT NO. 22  
(PROPOSED)  
STA. 137+59  
24' LT.

LIGHT NO. 23  
(PROPOSED)  
STA. 139+12  
23' LT.

LIGHT NO. 24  
(EXISTING)  
STA. 140+68  
22' LT.

LIGHT NO. 25  
(PROPOSED)  
STA. 141+99  
23' LT.

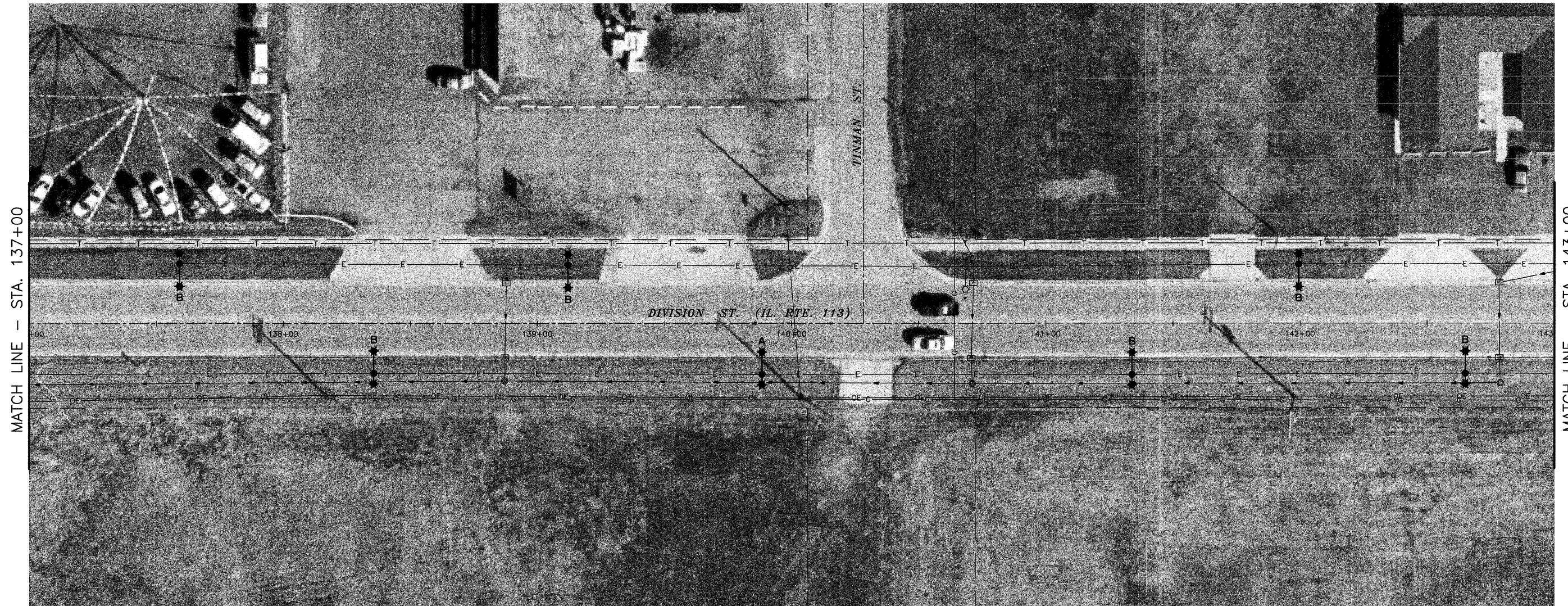

MATCH LINE - STA. 137+00

MATCH LINE - STA. 143+00

LIGHT NO. 60  
(PROPOSED)  
STA. 138+36  
20' RT.

LIGHT NO. 61  
(PROPOSED)  
STA. 139+88  
20' RT.

LIGHT NO. 62  
(PROPOSED)  
STA. 141+34  
20' RT.

LIGHT NO. 63  
(PROPOSED)  
STA. 142+65  
20' RT.

NOTE: AERIAL PHOTOGRAPHS SUPPLIED BY THE SIDWELL COMPANY

DRAWN BY: RGP/JMT  
CHECKED BY: MWP/DJD

6978-00  
CAD/DWG: P137-143  
BASE  
DATE: 09-24-09

REVISIONS	
DATE	BY



PERU MORRIS  
ILLINOIS

**VILLAGE OF DIAMOND**  
**DIVISION STREET LIGHTING IMPROVEMENTS - 2010**

**PLAN SHEET - STA. 137+00 TO STA. 143+00**

SCALE: AS NOTED  
FILE NO.: 6978-00

SHEET 9  
OF 12