

MAINTENANCE OF TRAFFIC PIPE CULVERT RELOCATION (INCLUDED IN THE COST OF PIPE CULVERT REMOVAL SPECIAL)			
LOCATION		PIPE CULVERT RELOCATION	
UPSTREAM STATION	DOWNSTREAM STATION	DIAMETER - INCH (FOR INFORMATIONAL PURPOSES ONLY)	APPROX LENGTH
NORTHMOOR ROAD			
92+03, 34' LT	91+77, 34' LT	15	26
93+40, 34' LT	93+18, 34' LT	12	22
94+88, 34' LT	94+68, 34' LT	12	20
96+43, 34' LT	96+62, 34' LT	8	19
97+11, 34' LT	97+30, 34' LT	12	19
97+59, 34' LT	98+09, 34' LT	12	40
98+80, 34' LT	99+12, 34' LT	15	32
TOTAL			178

MAINTENANCE OF TRAFFIC TYPICAL SECTION
NORTHMOOR ROAD-PHASE 2
 STATION 92+40 - STATION 107+48

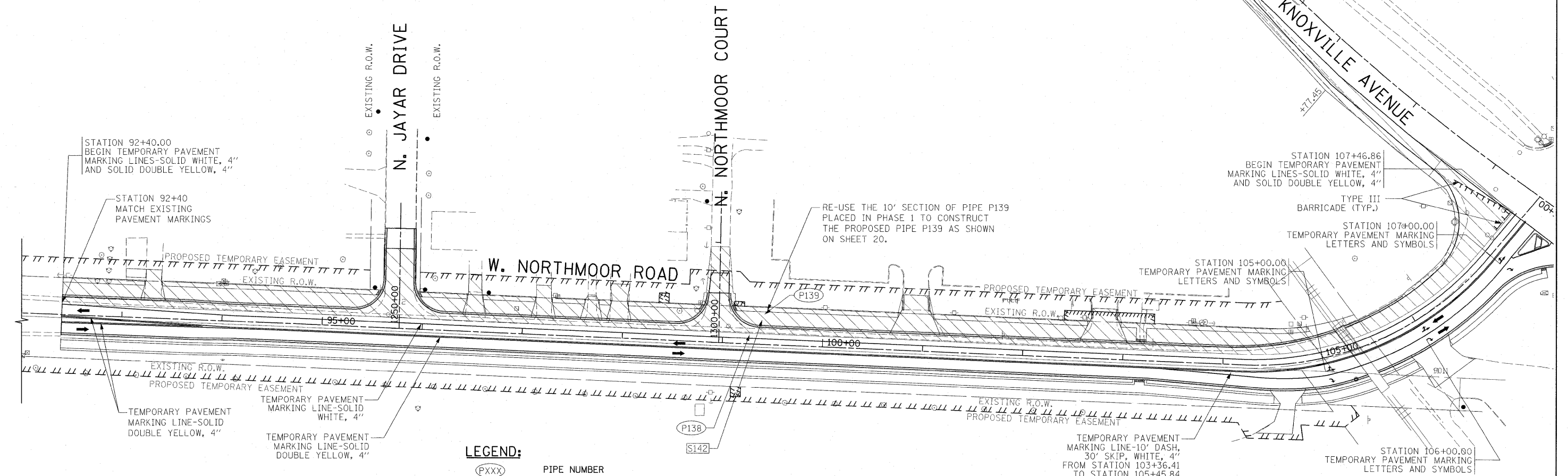

INFRASTRUCTURE ENGINEERING INCORPORATED
 456 Fulton Street | Suite 104 | Peoria, IL 61602
 P 309.637.9200 | F 309.637.9210 | www.infrastructure-eng.com

FILE NAME = I:\09Jobs\09L00278\CADD\Road\Sheet\IE1\2206_S-mot-stg111-02.dgn	USER NAME = Ander08846	DESIGNED - LC	REVISED -
PLOT SCALE = 50.0000' / in.	PLOT DATE = 11/05/2009	DRAWN - BID/LC	REVISED -
		CHECKED - CEF/DTQ	REVISED -
		DATE - 10-16-09	REVISED -

STATE OF ILLINOIS
DEPARTMENT OF TRANSPORTATION

MAINTENANCE OF TRAFFIC
STAGE 3 PHASE 2

SCALE: 1"=50'

STA. 92+00 TO STA. 107+47

F.A.U. RTE. 6647	SECTION 08-00302-00-PV	COUNTY PEORIA	TOTAL SHEETS 85	SHEET NO. 26
09-00047-01-PV		CONTRACT NO. 89526		
FED. ROAD DIST. NO. ILLINOIS		FED. AID PROJECT ARA-M-5093(139)		