

- ① WHITE THERMOPLASTIC STOP BAR PAVEMENT MARKING LINE - 24" SOLID
- ② WHITE THERMOPLASTIC PAVEMENT MARKING LINE - 8" SOLID
- ③ YELLOW THERMOPLASTIC PAVEMENT MARKING LINE - 12" (ON 45° ANGLE, 20' CTC)
- ④ WHITE THERMOPLASTIC PAVEMENT MARKING LINE - 12" (ON 45° ANGLE, 20' CTC)
- ⑤ YELLOW THERMOPLASTIC MARKING LINE - 10' LONG, 30' GAP - 4"
- ⑥ THERMOPLASTIC PAVEMENT MARKING, LETTERS AND SYMBOLS (FOR LEFT AND RIGHT TURN LANE ONE ARROW 20' FROM FRONT OF STORAGE AND ONE ARROW 20' AT BACK OF STORAGE)
- ⑦ WHITE THERMOPLASTIC PAVEMENT MARKING LINE - 8" (2' LONG, 6' GAP)
- ⑧ DOUBLE YELLOW THERMOPLASTIC PAVEMENT MARKING LINE - 4" SOLID
- ⑨ YELLOW THERMOPLASTIC PAVEMENT MARKING LINE - 4" SOLID
- ⑩ WHITE PAINT PAVEMENT MARKING LINE - 8" SOLID
- ⑪ DOUBLE YELLOW PAINT PAVEMENT MARKING LINE - 4" SOLID
- ⑫ WHITE PAINT PAVEMENT MARKING LINE - 12" (ON 45° ANGLE, 20' CTC)
- ⑬ YELLOW PAINT PAVEMENT MARKING LINE - 12" (ON 45° ANGLE, 20' CTC)
- ⑭ PREFORMED PLASTIC PAVEMENT MARKING, TYPE B - LETTERS AND SYMBOLS
- ⑮ PREFORMED PLASTIC PAVEMENT MARKING, TYPE B - LINE 24"

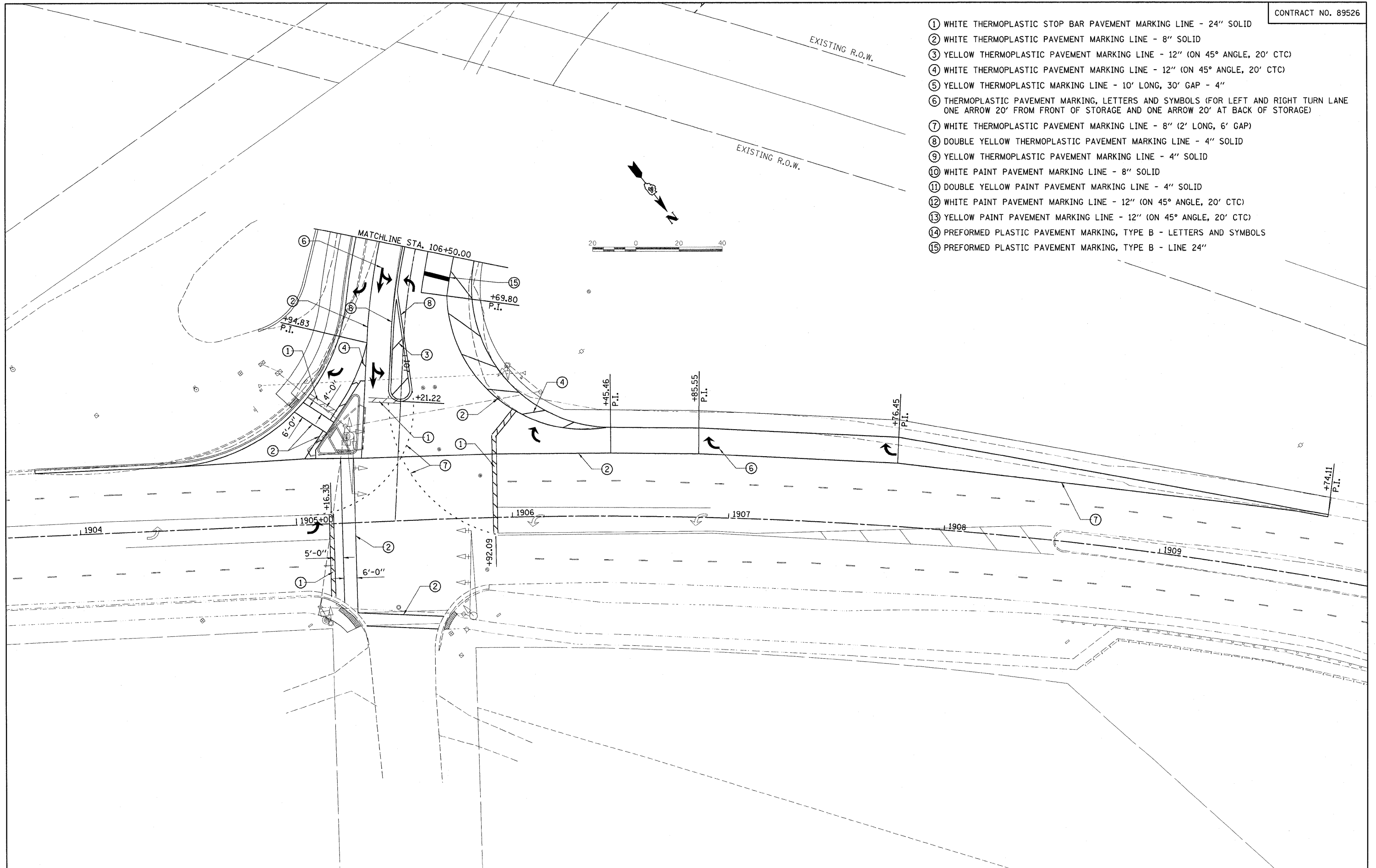

FILE NAME =	USER NAME = Ander-08846	DESIGNED - RLA	REVISED -	<b>STATE OF ILLINOIS DEPARTMENT OF TRANSPORTATION</b>	<b>NORTHMOOR RD. PAVEMENT MARKING PLAN</b>	F.A.J. RTE.	SECTION	COUNTY	TOTAL SHEETS	SHEET NO.	
It:\09\Jobs\09L0227B\CADD\Road\Sheet\c-16\mrk.dgn		DRAWN - RLA	REVISED -			6647	08-00302-00-PV	PEORIA	85	40	
PLOT SCALE = 20,0000' / in		CHECKED - CAL	REVISED -			09-00047-01-PV		CONTRACT NO. 89526			
PLOT DATE = 10\16\2009		DATE - 10/16/2009	REVISED -			SCALE: 1"=20'		SHEET NO. OF SHEETS		STA. 106+50.00 TO STA. 107+76.66	