

Pay Item #	Pay Item	Quantity	Unit
81012600	CONDUIT IN TRENCH, 2" DIA., PVC	1514	FOOT
81012700	CONDUIT IN TRENCH, 2 1/2" DIA., PVC	37	FOOT
81012800	CONDUIT IN TRENCH, 3" DIA., PVC	20	FOOT
81021330	CONDUIT PUSHED, 2" DIA., PVC	20	FOOT
81400700	HANDHOLE, PORTLAND CEMENT CONCRETE	1	EACH
81702450	ELECTRIC CABLE IN CONDUIT, 600V (XLP-TYPE USE) 3-1/C NO. 10	350	FOOT
81900200	TRENCH AND BACKFILL FOR ELECTRICAL WORK	1571	FOOT
82122400	LUMINAIRE, SODIUM VAPOR, HORIZONTAL MOUNT, 400 WATT	2	EACH
87301225	ELECTRIC CABLE IN CONDUIT, SIGNAL, NO. 14 3C	341	FOOT
87301245	ELECTRIC CABLE IN CONDUIT, SIGNAL, NO. 14 5C	2041	FOOT
87301255	ELECTRIC CABLE IN CONDUIT, SIGNAL, NO. 14 7C	790	FOOT
87301305	ELECTRIC CABLE IN CONDUIT, LEAD-IN, NO. 14 1 PAIR	93	FOOT
87502510	TRAFFIC SIGNAL POST, GALVANIZED STEEL, 17 FT.	3	EACH
87702950	STEEL COMBINATION MAST ARM ASSEMBLY AND POLE 44 FT.	1	EACH
87800100	CONCRETE FOUNDATION, TYPE A	9	FOOT
87800415	CONCRETE FOUNDATION, TYPE E, 36-INCH DIAMETER	27	FOOT
87900200	DRILL EXISTING HANDHOLE	6	EACH
88040070	SIGNAL HEAD, POLYCARBONATE, LED, 3-SECTION, BRACKET MOUNTED	4	EACH
88040090	SIGNAL HEAD, POLYCARBONATE, LED, 3-SECTION, MAST ARM MOUNTED	5	EACH
88040130	SIGNAL HEAD, POLYCARBONATE, LED, 1-FACE, 4-SECTION, WITH ONE DUAL-INDICATION SECTION, MAST ARM MOUNTED	1	EACH
88040140	SIGNAL HEAD, POLYCARBONATE, LED, 1-FACE, 4-SECTION, WITH ONE DUAL-INDICATION SECTION, BRACKET MOUNTED	2	EACH
88102717	PEDESTRIAN SIGNAL HEAD, LED, 1-FACE, BRACKET MOUNTED WITH COUNTDOWN TIMER	2	EACH
88102747	PEDESTRIAN SIGNAL HEAD, LED, 2-FACE, BRACKET MOUNTED WITH COUNTDOWN TIMER	1	EACH
88200110	TRAFFIC SIGNAL BACKPLATE, LOUVERED	12	EACH
88600100	DETECTOR LOOP, TYPE 1	331	FOOT
88800100	PEDESTRIAN PUSH BUTTON	4	EACH
89502375	REMOVE EXISTING TRAFFIC SIGNAL EQUIPMENT	1	EACH
X0324475	ELECTRIC CABLE IN CONDUIT, GROUNDING, NO 6, 1C	446	FOOT
	STEEL COMBINATION MAST ARM ASSEMBLY AND POLE WITH DUAL MAST ARMS, 48 FT. AND 30 FT.	1	EACH

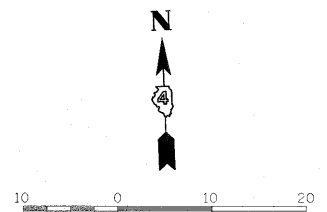
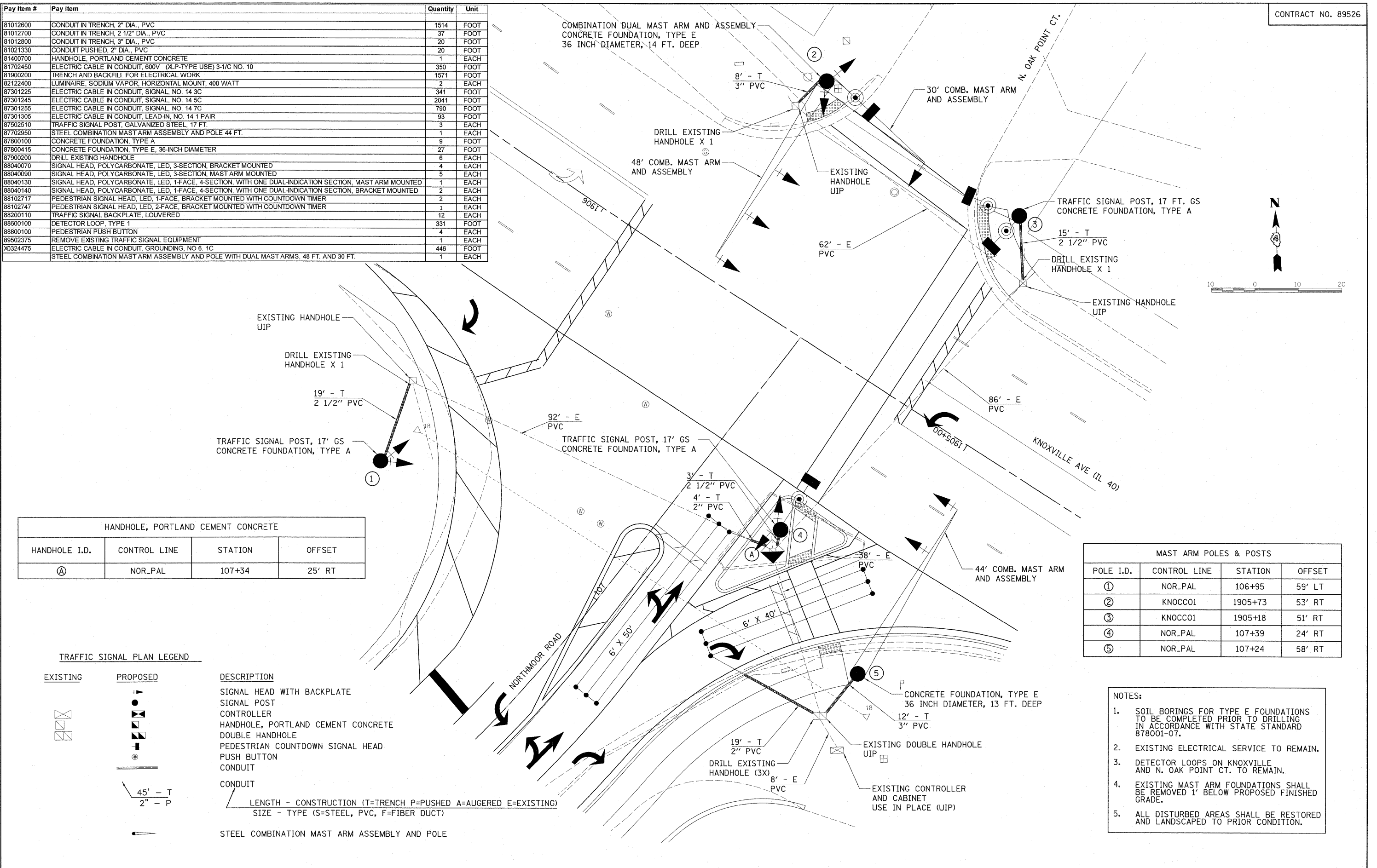

HANDHOLE, PORTLAND CEMENT CONCRETE			
HANDHOLE I.D.	CONTROL LINE	STATION	OFFSET
Ⓐ	NOR_PAL	107+34	25' RT

MAST ARM POLES & POSTS			
POLE I.D.	CONTROL LINE	STATION	OFFSET
①	NOR_PAL	106+95	59' LT
②	KNOCC01	1905+73	53' RT
③	KNOCC01	1905+18	51' RT
④	NOR_PAL	107+39	24' RT
⑤	NOR_PAL	107+24	58' RT

TRAFFIC SIGNAL PLAN LEGEND		DESCRIPTION
EXISTING	PROPOSED	SIGNAL HEAD WITH BACKPLATE
		SIGNAL POST
		CONTROLLER
		HANDHOLE, PORTLAND CEMENT CONCRETE
		DOUBLE HANDHOLE
		PEDESTRIAN COUNTDOWN SIGNAL HEAD
		PUSH BUTTON
		CONDUIT
		STEEL COMBINATION MAST ARM ASSEMBLY AND POLE

LENGTH - CONSTRUCTION (T=TRENCH P=PUSHED A=AUGERED E=EXISTING)
 SIZE - TYPE (S=STEEL, PVC, F=FIBER DUCT)

- NOTES:
- SOIL BORINGS FOR TYPE E FOUNDATIONS TO BE COMPLETED PRIOR TO DRILLING IN ACCORDANCE WITH STATE STANDARD 878001-07.
 - EXISTING ELECTRICAL SERVICE TO REMAIN.
 - DETECTOR LOOPS ON KNOXVILLE AND N. OAK POINT CT. TO REMAIN.
 - EXISTING MAST ARM FOUNDATIONS SHALL BE REMOVED 1' BELOW PROPOSED FINISHED GRADE.
 - ALL DISTURBED AREAS SHALL BE RESTORED AND LANDSCAPED TO PRIOR CONDITION.