

STATE OF ILLINOIS  
DEPARTMENT OF TRANSPORTATION

Notes:  
See sheet 12 of 17 for Sections C-C & D-D.  
a(E), and w(E) bar spacings measured perpendicular to  $\phi$  Rdwy.

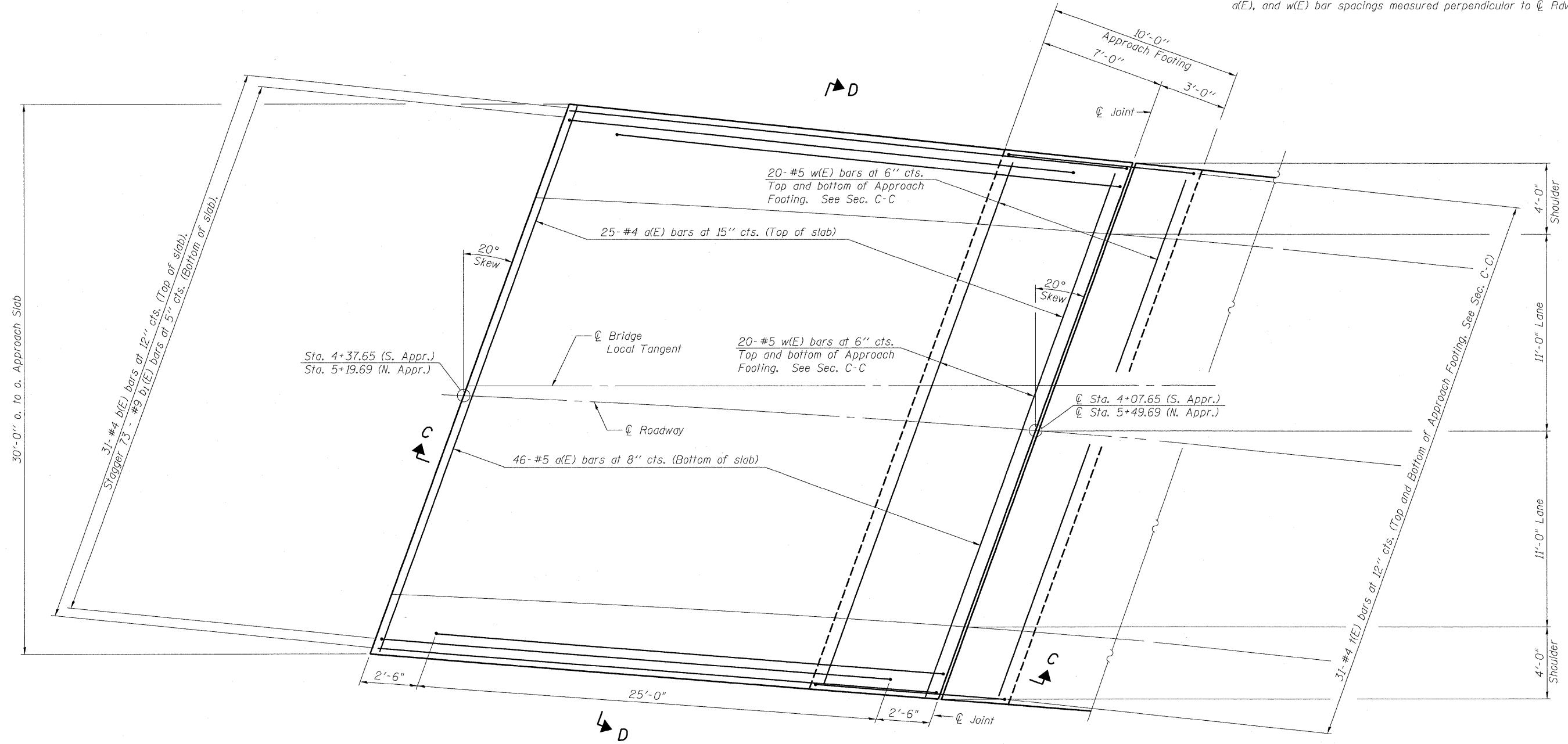

\* Tilt #9 b<sub>1</sub>(E) bars as required to maintain clearance.

PLAN

(Sheet 1 of 2)

**BRIDGE APPROACH SLAB DETAILS**  
**F.A.S. ROUTE 454**  
**SECTION 04-00070-00-BR**  
**SCHUYLER COUNTY**  
**STATION 4+79.00**  
**S.N. 085-3055**



DESIGNED NIEWINSKI  
CHECKED TRELLO  
DRAWN VERENSKI  
CHECKED TRELLO

G&B PROJECT: - PLOT DRIVER = V81.TDS700.PS.LOCAL.1007.plt to fg  
FILE NAME = J:\07258\CADD\CADsheets\SN\_085-3055\0853055-07258-Sht-Approach.dgn  
PLOT DATE = 9/18/2009 PLOT SCALE = 2x1.0000 "/>

BA-L

10-31-08

SHEET NO. 11	F.A.S. RTE.	SECTION	COUNTY	TOTAL SHEETS	SHEET NO.
17 SHEETS	454	04-00070-00-BR	SCHUYLER	30	19
			CONTRACT NO. 93499		
FED. ROAD DIST. NO. -			ILLINOIS FED. AID PROJECT		