

FINAL SURVEY	SURVEYED	BY	DATE
NOTE BOOK	PLOTTED		
AREAS CHECKED	TEMPLATE		
NO.	AREAS		

ORIGINAL SURVEY	SURVEYED	BY	DATE
NOTE BOOK	PLOTTED		
AREAS CHECKED	TEMPLATE		
NO.	AREAS		

0001364_XSECT-STH.dgn 10:46:24 AM
 9/28/2009 10:46:24 AM
 22/2028/0001364_XSECT-STH.dgn

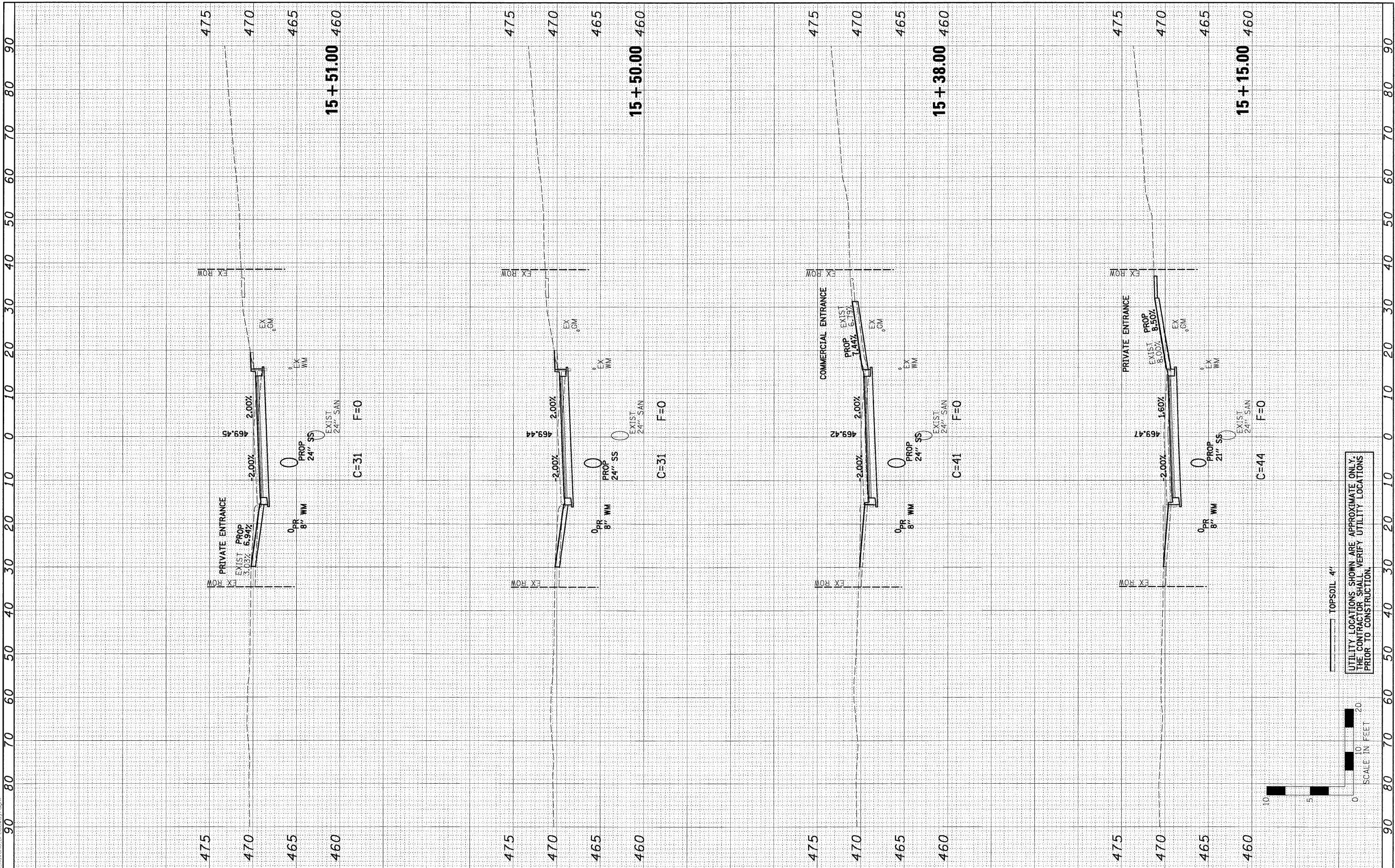

FILE NAME =	0001364_XSECT-STH.dgn
USER NAME =	
DESIGNED -	PSA
DRAWN -	JTC
CHECKED -	ERB/RDY
DATE -	09/29/09
REVISIONS	
REVISIONS	
REVISIONS	
REVISIONS	

DESIGNED -	PSA
DRAWN -	JTC
CHECKED -	ERB/RDY
DATE -	09/29/09
REVISIONS	
REVISIONS	
REVISIONS	
REVISIONS	

DESIGNED -	PSA
DRAWN -	JTC
CHECKED -	ERB/RDY
DATE -	09/29/09
REVISIONS	
REVISIONS	
REVISIONS	
REVISIONS	

DESIGNED -	PSA
DRAWN -	JTC
CHECKED -	ERB/RDY
DATE -	09/29/09
REVISIONS	
REVISIONS	
REVISIONS	
REVISIONS	

**STATE OF ILLINOIS
DEPARTMENT OF TRANSPORTATION**

SCALE: H=10, V=5

**CITY OF HAVANA - BROADWAY STREET
CROSS SECTIONS**

SCALE: H=10, V=5 SHEET NO. OF SHEETS STA. 15+15.00 TO STA. 15+15.00

F.A. RTE.	SECTION	COUNTY	TOTAL SHEETS	SHEET NO.
	05-00035-00-SS	MASON	60	40
CONTRACT NO. 93502				
FED. ROAD DIST. NO. ILLINOIS FED. AID PROJECT				

UTILITY LOCATIONS SHOWN ARE APPROXIMATE ONLY.
THE CONTRACTOR SHALL VERIFY UTILITY LOCATIONS
PRIOR TO CONSTRUCTION.

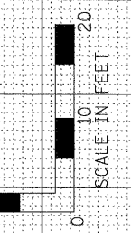

TOPSOIL 4"