

FINAL SURVEY	SURVEYED	BY	DATE
NOTE BOOK	PLOTTED		
AREAS CHECKED	TEMPLATE		
NO.	AREAS CHECKED		

ORIGINAL SURVEY	SURVEYED	BY	DATE
NOTE BOOK	PLOTTED		
AREAS CHECKED	TEMPLATE		
NO.	AREAS CHECKED		

0081364_XSECT-NTH.dgn 10:46:44 AM
 9/28/2009 10:46:44 AM
 0081364_XSECT-NTH.dgn

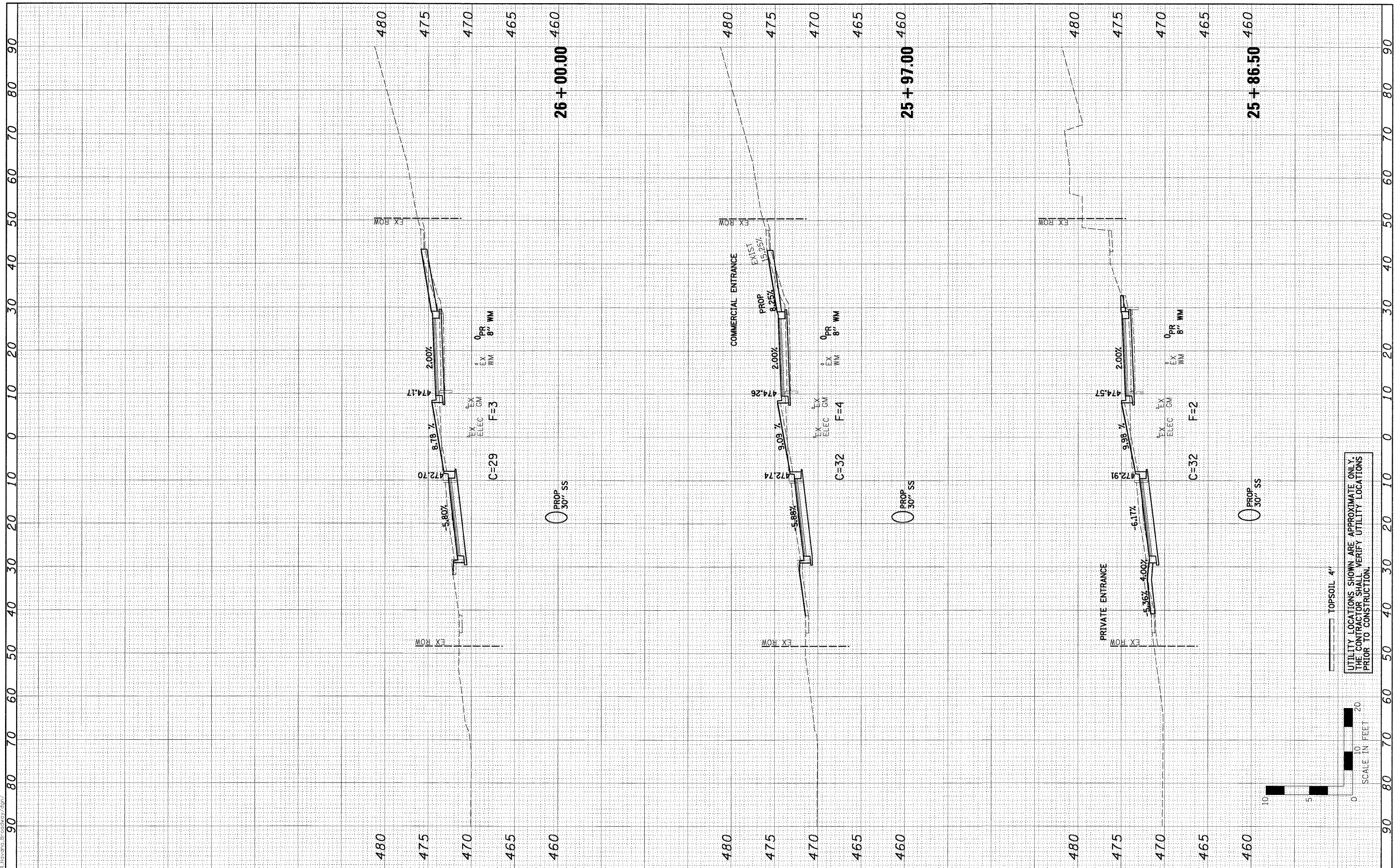

UTILITY LOCATIONS SHOWN ARE APPROXIMATE ONLY.
 THE CONTRACTOR SHALL VERIFY UTILITY LOCATIONS
 PRIOR TO CONSTRUCTION.

TOPSOIL 4'

SCALE IN FEET
 0 10 20

FILE NAME =	0081364_XSECT-NTH.dgn
USER NAME =	
DESIGNED -	PSA
DRAWN -	JTC
CHECKED -	ERB/RDY
DATE -	09/29/09
REVISIONS	
REVISED -	
REVISED -	
REVISED -	

DESIGNED -	PSA
DRAWN -	JTC
CHECKED -	ERB/RDY
DATE -	09/29/09
REVISIONS	
REVISED -	
REVISED -	
REVISED -	

DESIGNED -	PSA
DRAWN -	JTC
CHECKED -	ERB/RDY
DATE -	09/29/09
REVISIONS	
REVISED -	
REVISED -	
REVISED -	

**STATE OF ILLINOIS
 DEPARTMENT OF TRANSPORTATION**

**CITY OF HAVANA - BROADWAY STREET
 CROSS SECTIONS**

SCALE: H=10, V=5 SHEET NO. OF SHEETS STA. 25+86.50 TO STA. 26+00.00

F.A. RTE.	SECTION	COUNTY	TOTAL SHEETS	SHEET NO.
	05-00035-00-SS	MASON	60	54
CONTRACT NO. 93502				
FED. ROAD DIST. NO.	ILLINOIS FED. AID PROJECT			