

FINAL SURVEY	SURVEYED	BY	DATE
NOTE BOOK	PLOTTED		
AREAS CHECKED	TEMPLATE		
NO.	AREAS CHECKED		

ORIGINAL SURVEY	SURVEYED	BY	DATE
NOTE BOOK	PLOTTED		
AREAS CHECKED	TEMPLATE		
NO.	AREAS CHECKED		

0081354\_XSECT-NTH.dgn  
 9/28/2009 10:46:44 AM  
 0081354\_XSECT-NTH.dgn

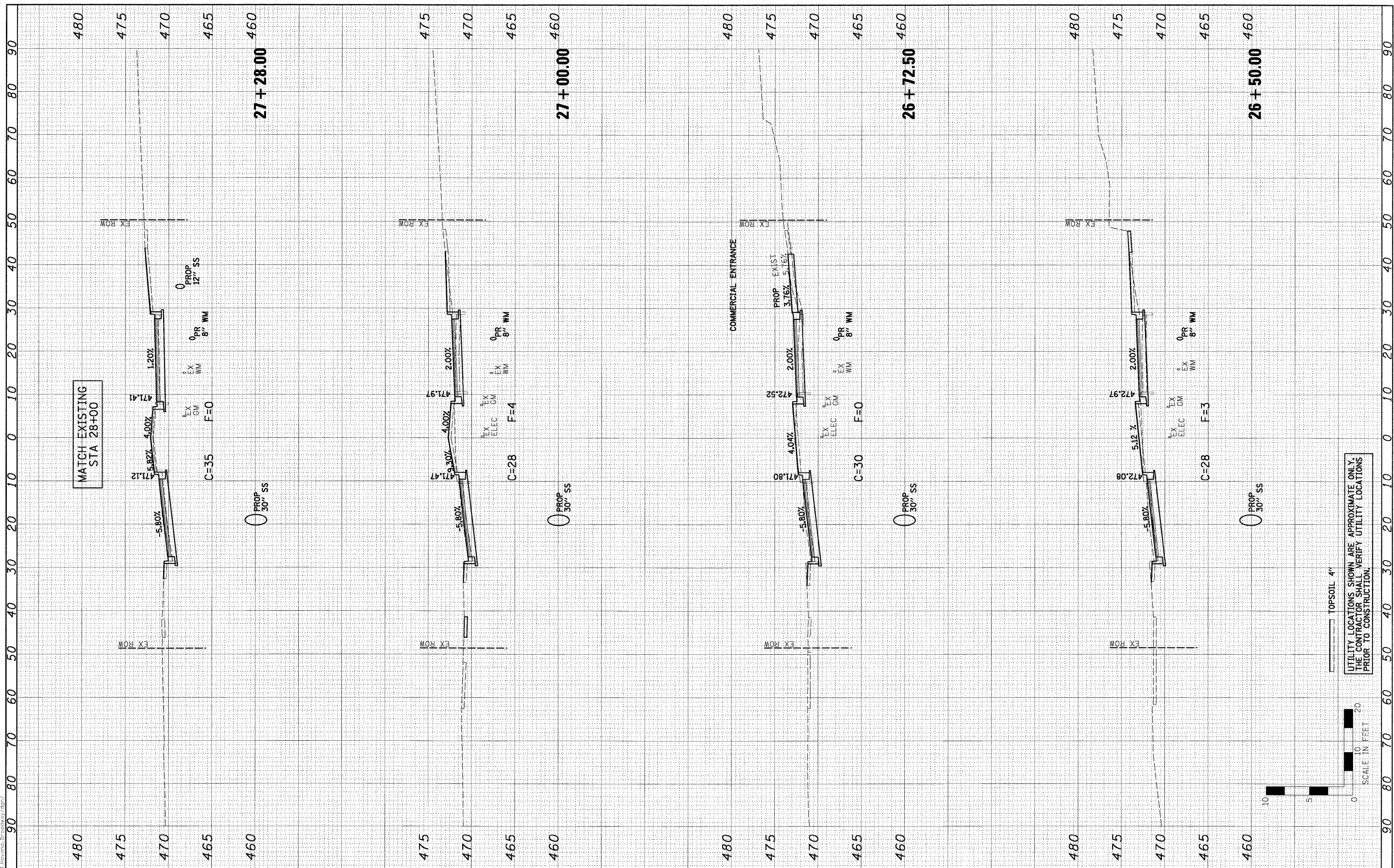

MATCH EXISTING  
STA 28+00

COMMERCIAL ENTRANCE

UTILITY LOCATIONS SHOWN ARE APPROXIMATE ONLY.  
THE CONTRACTOR SHALL VERIFY UTILITY LOCATIONS  
PRIOR TO CONSTRUCTION.

TOPSOIL - 4"

SCALE IN FEET  
0 5 10 20

FILE NAME =	0081354_XSECT-NTH.dgn
USER NAME =	
PLOT SCALE =	
PLOT DATE =	9/28/2009 10:46:44 AM

DESIGNED -	PSA	REVISED -	
DRAWN -	JTC	REVISED -	
CHECKED -	ERB/RDY	REVISED -	
DATE -	09/29/09	REVISED -	

DESIGNED -	PSA	REVISED -	
DRAWN -	JTC	REVISED -	
CHECKED -	ERB/RDY	REVISED -	
DATE -	09/29/09	REVISED -	

**STATE OF ILLINOIS  
DEPARTMENT OF TRANSPORTATION**

<b>CITY OF HAVANA - BROADWAY STREET CROSS SECTIONS</b>				
SCALE: H=10, V=5	SHEET NO.	OF	SHEETS	STA. 26+50.00 TO STA. 27+28.00

F.A. RTE.	SECTION	COUNTY	TOTAL SHEETS	SHEET NO.
	05-00035-00-SS	MASON	60	55
FED. ROAD DIST. NO.	ILLINOIS	FED. AID PROJECT	CONTRACT NO. 9 3 5 0 2	