

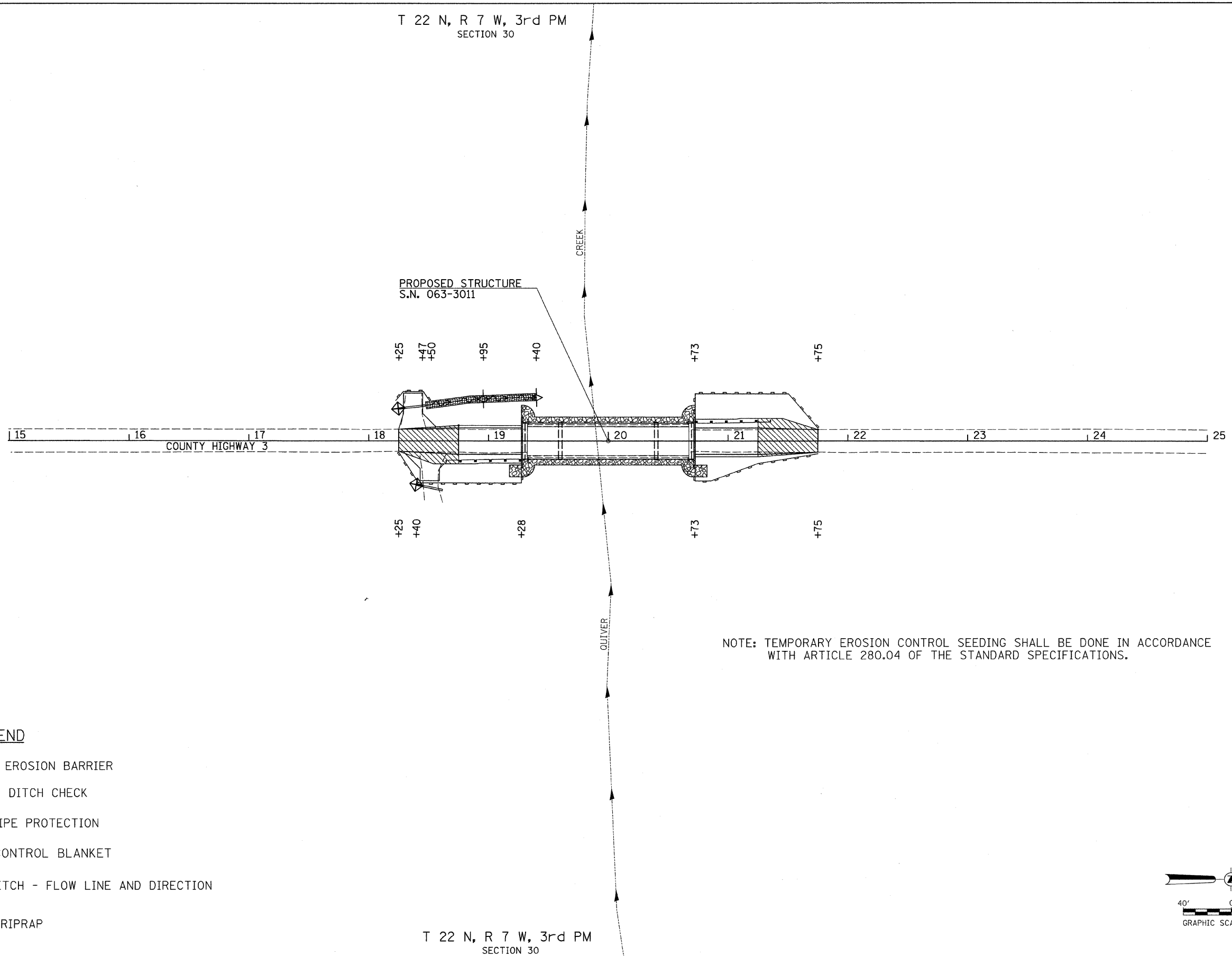





T 22 N, R 7 W, 3rd PM  
SECTION 30

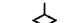

NOTE: TEMPORARY EROSION CONTROL SEEDING SHALL BE DONE IN ACCORDANCE WITH ARTICLE 280.04 OF THE STANDARD SPECIFICATIONS.

**LEGEND**

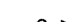
-  PERIMETER EROSION BARRIER
-  TEMPORARY DITCH CHECK
-  INLET & PIPE PROTECTION
-  EROSION CONTROL BLANKET
-  SPECIAL DITCH - FLOW LINE AND DIRECTION
-  PROPOSED RIPRAP

T 22 N, R 7 W, 3rd PM  
SECTION 30

FILE NAME = V:\Bridge\2618 Mason\2618S001.dgn	USER NAME = jwhite	DESIGNED -	REVISED -	<b>MASON COUNTY COUNTY HIGHWAY 3 OVER QUIVER CREEK</b>	<b>EROSION CONTROL PLAN</b>	F.A.S. RTE.	SECTION	COUNTY	TOTAL SHEETS	SHEET NO.
	PLOT SCALE = 40,0000' / IN.	DRAWN -	REVISED -			568	07-00032-01-BR	MASON	21	5
	PLOT DATE = 10/15/2009	CHECKED -	REVISED -			CONTRACT NO. 93505				
		DATE -	REVISED -			SCALE: 1" = 40'-0" SHEET NO. 1 OF 1 SHEETS STA. 18+25.00 TO STA. 21+75.00			FED. ROAD DIST. NO. 7 ILLINOIS FED. AID PROJECT BR5-0568102	