

STATE OF ILLINOIS
DEPARTMENT OF TRANSPORTATION

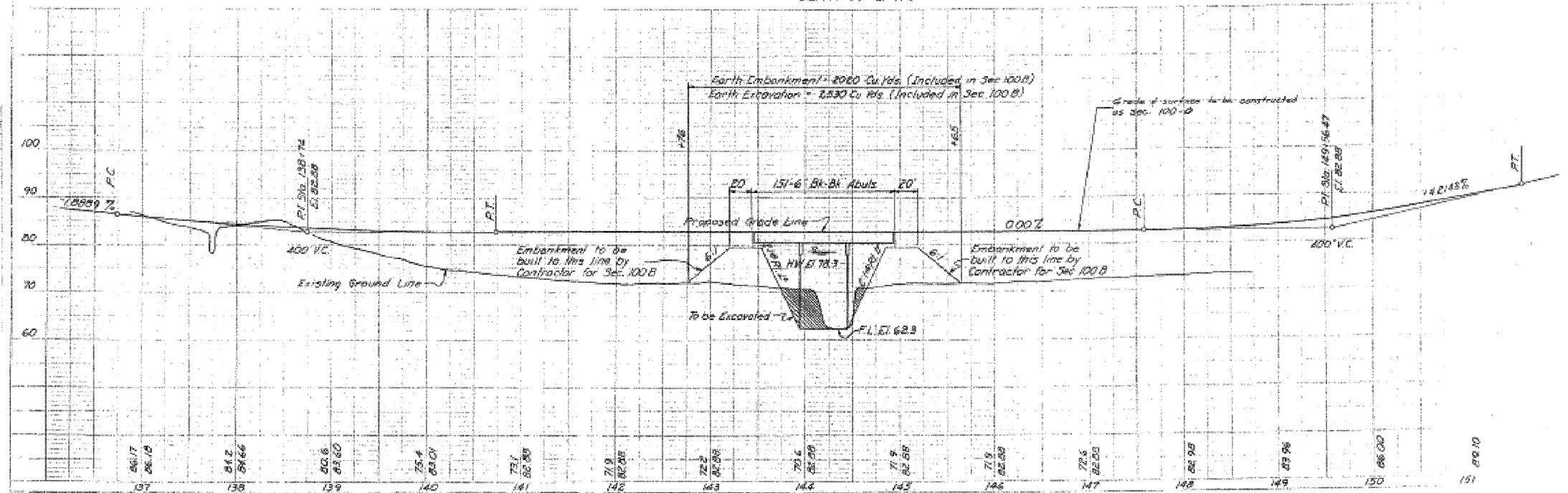
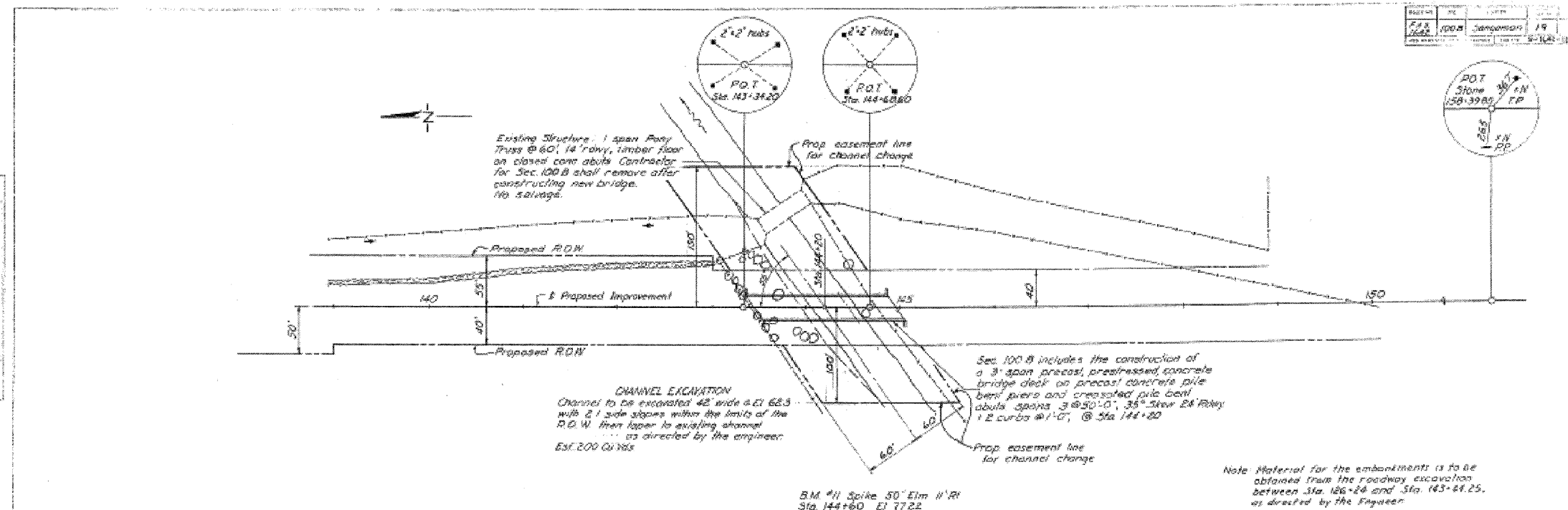

**EXISTING PLANS
PAWNEE ROAD (FAS 1622)
OVER BRUSH CREEK**

DESIGNED - CMV
CHECKED - SDS
DRAWN - DLH
CHECKED - CMV

WHKS & Co.
ENGINEERING
7018 KINGSMILL CT.
SPRINGFIELD, IL
(217) 483-9457
DESIGN FIRM #184001036

SHEET NO. 8 12 SHEETS	F.A.S. RTE.	SECTION	COUNTY	TOTAL SHEETS	SHEET NO.
	1622	07-00100-00-BR	SANGAMON	16	12
S.N. 084-3037			CONTRACT NO. 93506		
FED. ROAD DIST. NO. - ILLINOIS FED. AID PROJECT					